

RICE CREEK CORPORATE PARK 5TH ADDITION

KNOW ALL MEN BY THESE PRESENTS: That MN PROPERTIES GP, LLC, a Minnesota limited liability company, owner and BRIDGEWATER BANK, a Minnesota banking corporation, mortgagee of the following described property situated in the City of Shoreview, County of Ramsey, State of Minnesota:

Lot 1, Block 1, RICE CREEK CORPORATE PARK 4TH ADDITION.

Have caused the same to be surveyed and platted as RICE CREEK CORPORATE PARK 5TH ADDITION and do hereby dedicate to the public for public use forever the thoroughfare and the drainage easement as shown on this plat.

In witness whereof said MN PROPERTIES GP, LLC, a Minnesota limited liability company, has caused these presents to be signed by its proper officer this 10th day of Feb, 2006.

Signed: MN PROPERTIES GP, LLC
[Signature] its Chief Manager

STATE OF MINNESOTA
COUNTY OF Hennepin

The foregoing instrument was acknowledged before me this 10th day of February, 2006 by Wayne Guercino, the Chief Manager of MN PROPERTIES GP, LLC, a Minnesota limited liability company, on behalf of the company.

Rachael M. Peterson
Notary Public, Hennepin County, Minnesota
My Commission Expires _____

In witness whereof said BRIDGEWATER BANK, a Minnesota banking corporation, has caused these presents to be signed by its proper officer this 10th day of FEB, 2006.

Signed: BRIDGEWATER BANK
[Signature] its President.
Jerry Baack

STATE OF MINNESOTA
COUNTY OF Hennepin

The foregoing instrument was acknowledged before me this 10th day of February, 2006 by Jerry Baack, the President of BRIDGEWATER BANK, a Minnesota banking corporation, on behalf of the corporation.

Rachael M. Peterson
Notary Public, Hennepin County, Minnesota
My Commission Expires _____

I, Walter J. Gregory, hereby certify that I have surveyed and platted the property described on this plat as RICE CREEK CORPORATE PARK 5TH ADDITION; that this plat is a correct representation of the survey; that all distances are correctly shown on this plat in feet and hundredths of a foot; that all monuments have been correctly placed in the ground as shown; that the outside boundary lines are correctly designated on this plat; and there are no wet lands as defined in Minnesota Statutes, Section 505.02, Subdivision 1, or public highways to be designated other than as shown on this plat.

Walter J. Gregory
Walter J. Gregory, Land Surveyor
Minnesota License No. 14889



STATE OF MINNESOTA
COUNTY OF Wright

The foregoing Surveyor's Certificate was acknowledged before me this 2nd day of February, 2006, by Walter J. Gregory, a Licensed Land Surveyor.

Robert R. Wenger
Notary Public, Wright County, Minnesota
My Commission Expires 1/31/08

CITY OF SHOREVIEW, MINNESOTA

We do hereby certify that on the 1st day of January, 2006, the City Council of the City of Shoreview, Minnesota, approved this plat. Pursuant to Minnesota Statutes, Section 505.02, Subdivision 1, all monuments must be set as specified by the City Council and as stated and shown on this plat. Also, the conditions of Minnesota Statutes, Section 505.03, Subd. 2, have been fulfilled.

Sandra Martin, Mayor
TJCS, Clerk

DEPARTMENT OF PROPERTY RECORDS AND REVENUE

Taxes payable in the year 2006 on the land herein described have been paid, also there are no delinquent taxes and transfer entered this 16th day of February, 2006.

Dorothy McClung, Director
Property Records and Revenue
By Mary Kay Simpson, Deputy

COUNTY SURVEYOR

Pursuant to Minnesota Statutes, Section 383A.42, this plat is approved this 21st day of February, 2006.

David D. Claypool
David D. Claypool, P.L.S.
Ramsey County Surveyor

COUNTY RECORDER, COUNTY OF RAMSEY, STATE OF MINNESOTA

I hereby certify that this plat of RICE CREEK CORPORATE PARK 5TH ADDITION was filed in the office of the County Recorder for public record on this 21st day of February, 2006, at 4:00 o'clock P. M. and was duly filed in Book 122 of Plats, Pages 11 and 12, as Document Number 3953379.

Deputy County Recorder



RICE CREEK CORPORATE PARK 5TH ADDITION

SYMBOL LEGEND

- DENOTES 1/2 INCH IRON PIPE MONUMENT FOUND & MARKED BY MINN. LIC. NO. 18421
- DENOTES 1/2 INCH X 14 INCH IRON PIPE MONUMENT SET & MARKED BY MINN. LIC. NO. 14889

VICINITY MAP

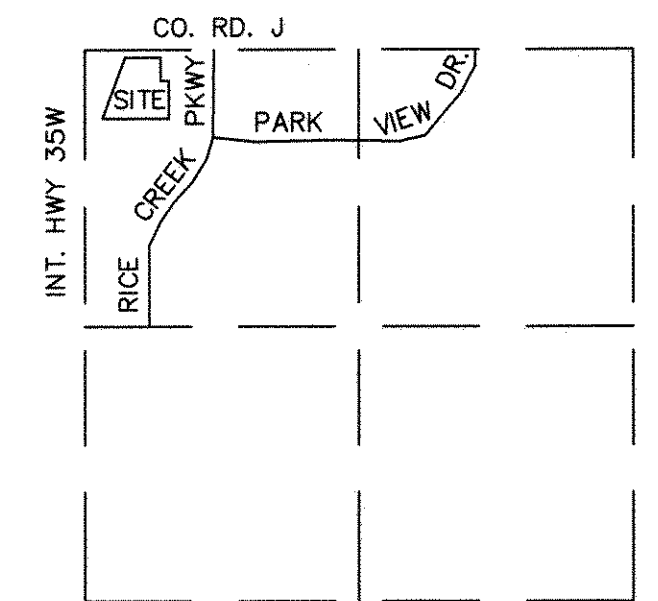

SECTION 4, T. 30, R. 23

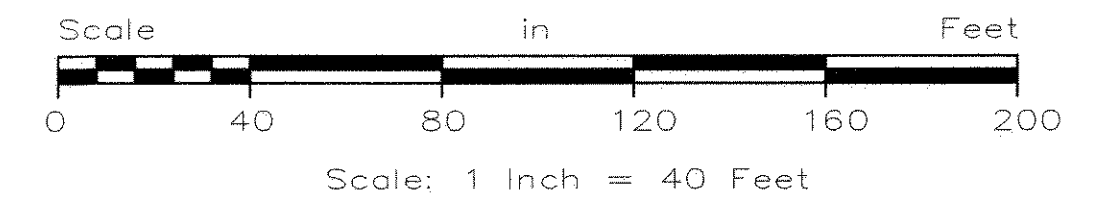

For the purposes of this plat, the South line of RICE CREEK CORPORATE PARK 4TH ADDITION, is assumed to have a bearing of North 89 degrees 56 minutes 40 seconds West.

