

SLOCUM 1ST ADDITION

Know All Persons By These Presents that Bruggeman Construction Co., a Minnesota corporation, fee owner, and Gene L. Slocum, a widow and not remarried, mortgagee of the following described property situated in the City of White Bear Lake, Ramsey County, Minnesota:

Except the North 525.0 feet thereof and except the South 880.0 feet thereof, the Northwest Quarter of Section 22, Township 30 North, Range 22 West which lies East of the West 1210.5 feet thereof, West of the West line of Majestic Pines and Northeasterly of the Northeasterly line and its southeasterly extension of Registered Land Survey No. 440.

Have caused the same to be surveyed, platted and known as SLOCUM 1ST ADDITION and do hereby dedicate to the public for public use forever the avenue, court, drainage easement and the drainage and utility easements as shown on the plat.

IN WITNESS WHEREOF, said Bruggeman Construction Co., a Minnesota corporation, has caused these presents to be signed by its proper officers this 18th day of JANUARY, 1991.

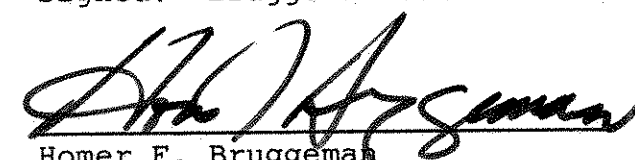
Signed: Bruggeman Construction Co.

 its President
 Homer F. Bruggeman

 Secretary-Treasurer
 Gretchen R. Bruggeman

IN WITNESS WHEREOF, said Gene L. Slocum, a widow and not remarried, has hereunto set her hand this 13th day of FEBRUARY, 1991.

Signed:

 Gene L. Slocum

STATE OF MINNESOTA
 COUNTY OF Ramsey

The foregoing instrument was acknowledged before me this 18th day of JANUARY, 1991, by Homer F. Bruggeman, President and by Gretchen R. Bruggeman, Secretary-Treasurer of Bruggeman Construction Co., a Minnesota corporation, on behalf of the corporation.

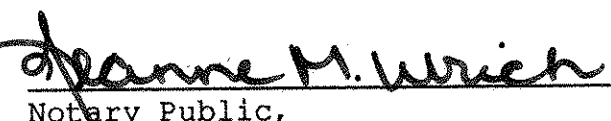



 Notary Public,
Ramsey County, Minnesota
 My Commission Expires 2/22/94

STATE OF MINNESOTA
 COUNTY OF Ramsey

The foregoing instrument was acknowledged before me this 13th day of FEBRUARY, 1991, by Gene L. Slocum, a widow and not remarried.





 Notary Public,
Ramsey County, Minnesota
 My Commission Expires 8-25-91

I, Harold C. Peterson, hereby certify that I have surveyed and platted the property described in the dedication of this plat as SLOCUM 1ST ADDITION; that this plat is a correct representation of said survey; that all distances are correctly shown on the plat; that all monuments have been correctly placed in the ground as shown; that the outside boundary lines are correctly designated on the plat; and there are no wet lands, easements or public highways other than as shown thereon.

 Harold C. Peterson, Land Surveyor
 Minnesota License No. 12294

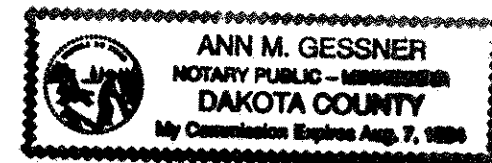

STATE OF MINNESOTA
 COUNTY OF HENDEPIN

The Surveyor's Certificate was subscribed and sworn to before me, a Notary Public, this 1st day of JANUARY, 1991.

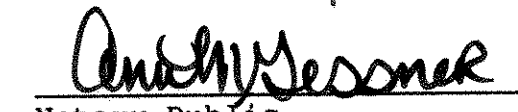

 Notary Public,
DAKOTA County, Minnesota
 My Commission Expires 8-7-94

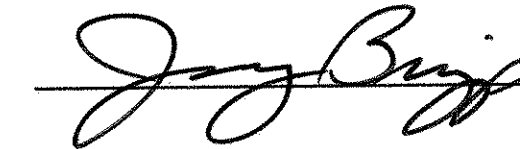
Approved and accepted by the City Council of the City of White Bear Lake, Minnesota, this 8th day of JAN, 1991.

 Mayor
 Clerk

Taxes for the year 1991 on the land described herein paid, no delinquent taxes and transfer entered, this 14th day of February, 1991.

 Director
 Department of Property Taxation

By 
 Deputy

Pursuant to Chapter 7, Minnesota Laws of 1976, this plat has been reviewed and approved, this 14th day of FEBRUARY, 1991, and the conditions of Minnesota Statutes, Section 505.03, Subdivision 2, have been fulfilled.

 David D. Claypool
 Ramsey County Surveyor

County Recorder, County of Ramsey, State of Minnesota

I hereby certify that this plat of SLOCUM 1ST ADDITION was filed in this office this 15 day of FEBRUARY, 1991, at 10:43 o'clock A.M. and was filed in Book 106 of Plats, Pages 38 and 39, as Document No. 2384714.

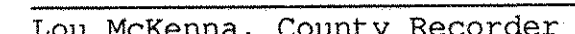
 Lou McKenna, County Recorder

By _____ Deputy

SLOCUM 1ST ADDITION

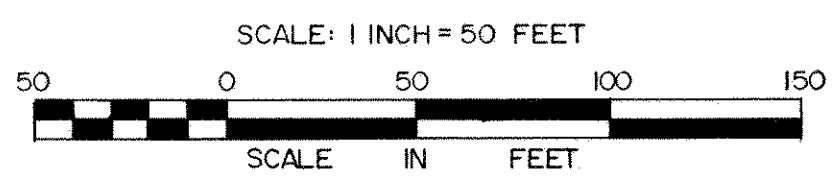
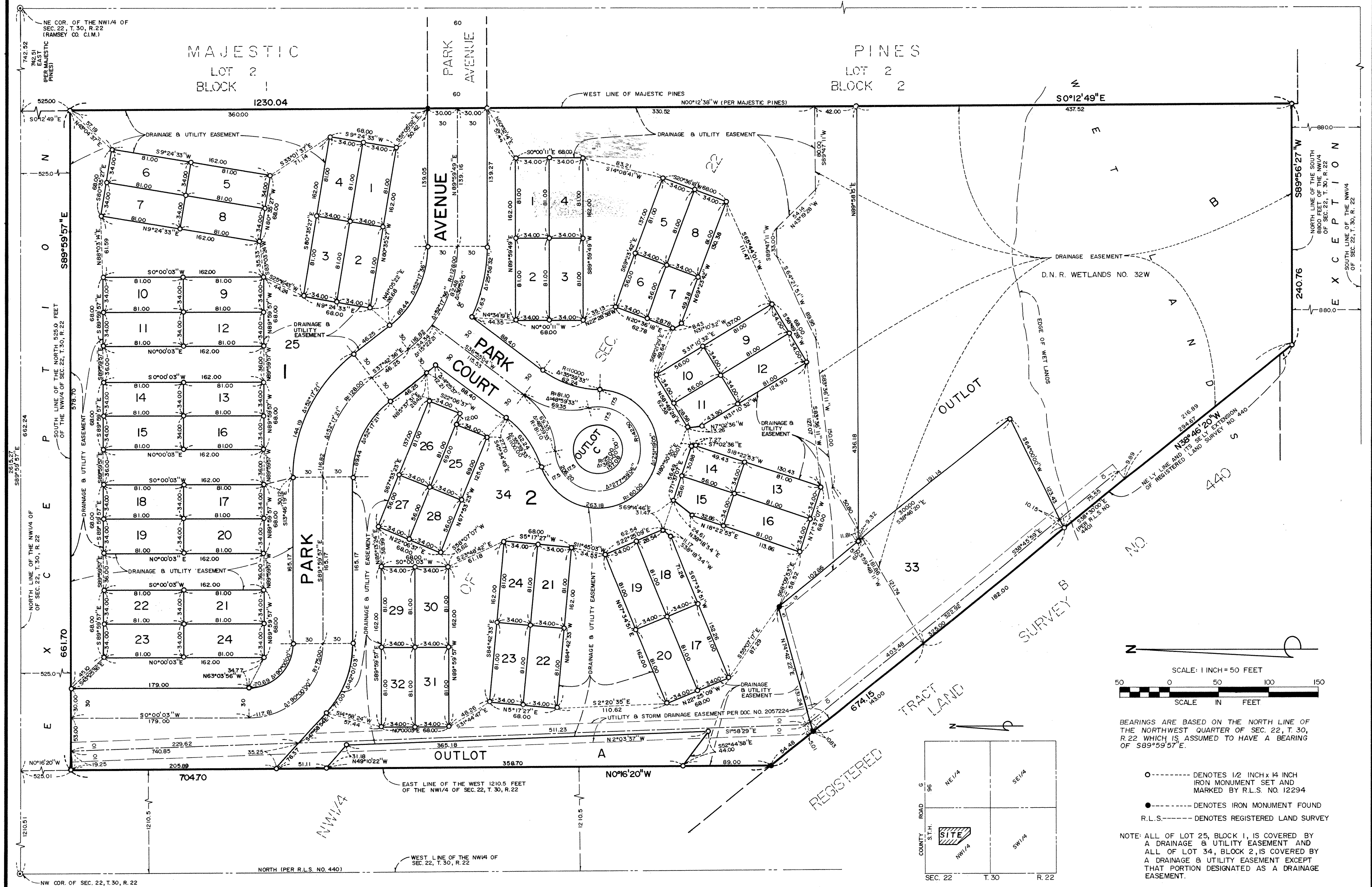

BEARINGS ARE BASED ON THE NORTH LINE OF THE NORTHWEST QUARTER OF SEC. 22, T. 30, R. 22 WHICH IS ASSUMED TO HAVE A BEARING OF S89°59'57"E.

- DENOTES 1/2 INCH x 1/4 INCH IRON MONUMENT SET AND MARKED BY R.L.S. NO. 12294
- DENOTES IRON MONUMENT FOUND
- R.L.S.----- DENOTES REGISTERED LAND SURVEY

NOTE: ALL OF LOT 25, BLOCK 1, IS COVERED BY A DRAINAGE & UTILITY EASEMENT AND ALL OF LOT 34, BLOCK 2, IS COVERED BY A DRAINAGE & UTILITY EASEMENT EXCEPT THAT PORTION DESIGNATED AS A DRAINAGE EASEMENT.

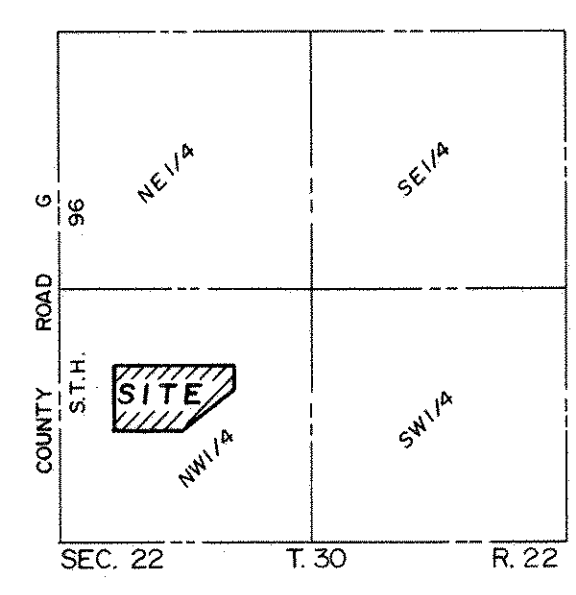

NOTE: RECORD BEARINGS SHOWN PER MAJESTIC PINES AND R.L.S. NO. 440 ARE BASED ON A DIFFERENT BEARING DATUM.