

VADNAIS LAKE PINES ADDITION

Know All Persons By These Presents that Aspen Investment Co., a Minnesota general partnership, fee owner, and First Bank Coon Rapids, a Minnesota corporation, mortgagee of the following described property situated in the City of Vadnais Heights, Ramsey County, Minnesota:

The West 204 feet of the North 165 feet of the South 330 feet of the Southeast Quarter of the Southwest Quarter of Section 29, Township 30, Range 22.

Together with the South 165 feet of the Southeast Quarter of the Southwest Quarter of said Section 29, except therefrom the East 333 feet.

Together with the North 20 acres of Government Lot 2, Section 32, Township 30, Range 22.

Except therefrom the North 100 feet of the East 333 feet. And also except that part of said North 20 acres described as following: Beginning at a point on the east line of said North 20 acres, distance 150.00 feet northerly at the southeast corner thereof; thence westerly, parallel with the south line said Government Lot 2, 260.00 feet; thence southwesterly to a point on the south line of said North 20 acres, distant 365.00 feet west of the Southeast corner of said North 20 acres; thence east, along said south line, 365.00 feet to the southeast corner of said North 20 acres; thence north, along the east line of said North 20 acres, 150.00 feet to the point of beginning and there terminating.

Have caused the same to be surveyed, platted and known as VADNAIS LAKE PINES ADDITION and do hereby dedicate to the public for public use forever the street, avenue, drive, terrace, and drainage and utility easements as shown on the plat.

Aspen Investment Co., a Minnesota general partnership, has caused these presents to be signed by its general partners this 18th day of October, 1988.

Signed: Aspen Investment Co.

George Gotwald
George Gotwald, a general partner

Blaine Edmondson
Blaine Edmondson, a general partner

First Bank Coon Rapids, a Minnesota corporation, has caused these presents to be signed by its proper officers this 18th day of October, 1988.

Signed: First Bank Coon Rapids

Jerry Wright
Jerry Wright, President

Marge Christensen
Marge Christensen, Assistant Vice-President

STATE OF MINNESOTA

COUNTY OF Anoka

The foregoing instrument was acknowledged before me this 18th day of October, 1988 by George Gotwald, a general partner and by Blaine Edmondson, a general partner of Aspen Investment Co., a Minnesota general partnership, on behalf of the partnership.

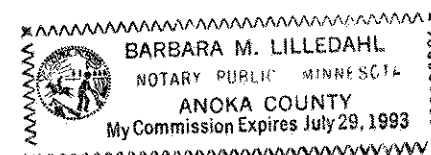

Barbara M. Lilledahl
Notary Public, Anoka County, Minnesota
My Commission Expires July 29, 1993

STATE OF MINNESOTA

COUNTY OF Anoka

The foregoing instrument was acknowledged before me this 18th day of October, 1988 by Jerry Wright, President and by Marge Christensen, Assistant Vice-President of First Bank Coon Rapids, a Minnesota corporation, on behalf of the corporation.

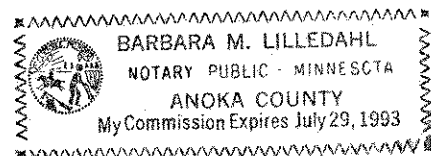

Barbara M. Lilledahl
Notary Public, Anoka County, Minnesota
My Commission Expires July 29, 1993

I, Gregory Brick, hereby certify that I have surveyed and platted the property described in the dedication of this plat as VADNAIS LAKE PINES ADDITION; that this plat is a correct representation of said survey; that all distances are correctly shown on the plat; that all monuments have been correctly placed in the ground as shown; that the outside boundary lines are correctly designated on the plat; and there are no wet lands, easements or public highways other than as shown thereon.

Gregory Brick
Gregory Brick, Land Surveyor
Minnesota Registration No. 16085

STATE OF MINNESOTA

COUNTY OF Dakota

The Surveyor's Certificate was subscribed and sworn to before me, a Notary Public, this 28th day of October, 1988.



Jo Ann Englund
Notary Public, Dakota County, Minnesota
My Commission Expires March 29, 1990

Approved and accepted by the City Council of the City of Vadnais Heights, Minnesota, this 18th day of October, 1988.

Robert J. Haberman
Mayor

Gerald Urban
Clerk

Taxes for the year 1988 on land described herein paid, no delinquent taxes and transfer entered, this 27th day of October, 1988.

Lou McKenna
Department of Property Taxation

Director By A. J. S. J. Deputy

Pursuant to Chapter 7, Minnesota Laws of 1976, this plat has been reviewed and approved, this 3rd day of November, 1988, and the conditions of Minnesota Statutes, Section 505.03, Subdivision 2, have been fulfilled.

David D. Claypool
David D. Claypool, Ramsey County Surveyor

County Recorder, County of Ramsey, State of Minnesota

I hereby certify that this plat of VADNAIS LAKE PINES ADDITION was filed in this office this 3rd day of November 1988, at 3:38 o'clock P.M. and was filed in Book 103 of Plats, Pages 47 and 48, as Document No. 2466886.

Lou McKenna, County Recorder

By _____ Deputy

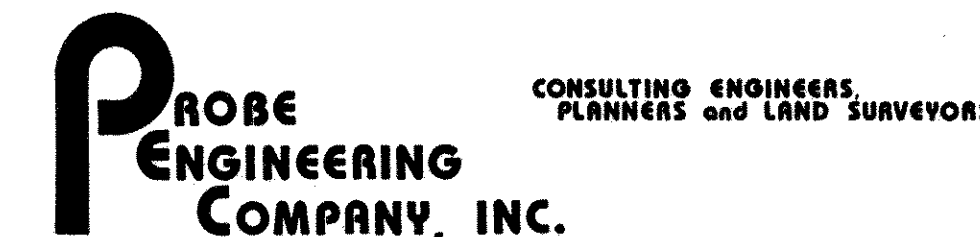

VADNAIS LAKE PINES ADDITION

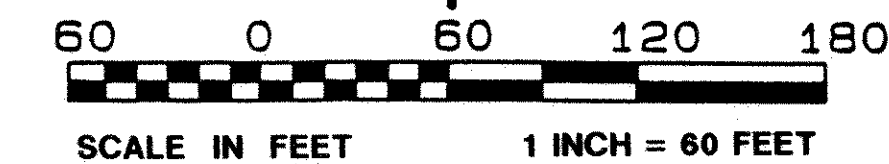
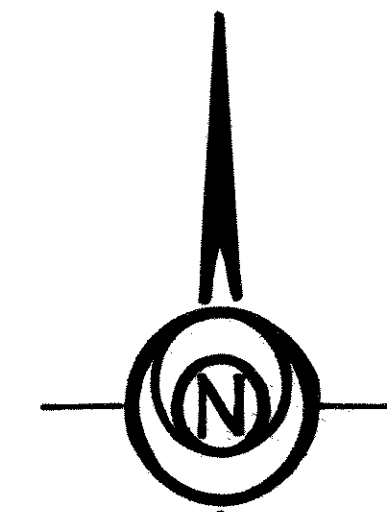

- DENOTES IRON MONUMENT FOUND
 - DENOTES 1/2 INCH BY 14 INCH IRON MONUMENT SET - MARKED WITH REGISTRATION NO. 16085
- THE EAST LINE OF THE NORTHEAST QUARTER OF THE NORTHWEST QUARTER OF SECTION 32, TOWNSHIP 30, RANGE 22 HAS AN ASSUMED BEARING OF S 00° 09' 24" E.
- NOTE: ALL DISTANCES SHOWN REPRESENT LOT LINE DISTANCE**

Southeast corner of the Southwest Quarter of Section 29 and the northeast corner of the Northwest Quarter of Section 32, T.30.R.22 (Ramsey Co. C.I.A.)

DRAINAGE AND UTILITY EASEMENTS ARE SHOWN THUS:

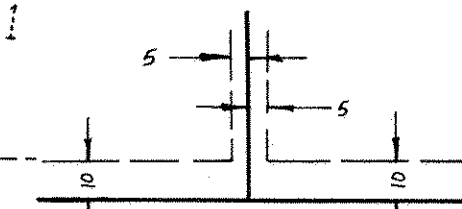

BEING 10 FEET IN WIDTH, UNLESS OTHERWISE SHOWN AND ADJOINING STREET LINES AND REAR LOT LINES, AND 5 FEET IN WIDTH, UNLESS OTHERWISE SHOWN AND ADJOINING LOT LINES WHERE SHOWN ON THE PLAT.

VICINITY MAP

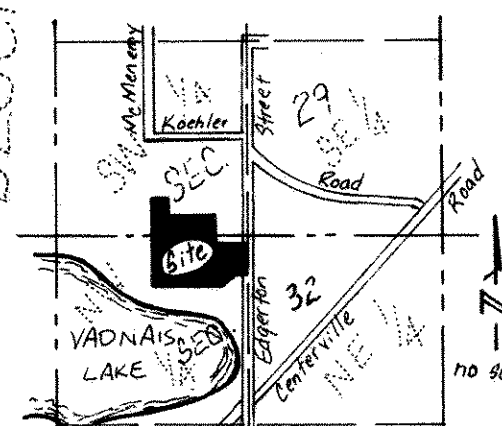

SECTION 29 AND SECTION 32, TOWNSHIP 30 NORTH, RANGE 22 WEST

PROBE ENGINEERING, INC.
CONSULTING ENGINEERS, PLANNERS and LAND SURVEYORS

