

EISENMENGER & ZASPEL'S LAKE PARK
RAMSEY CO. MINNESOTA

D.L. Curtice Surveyor 1887

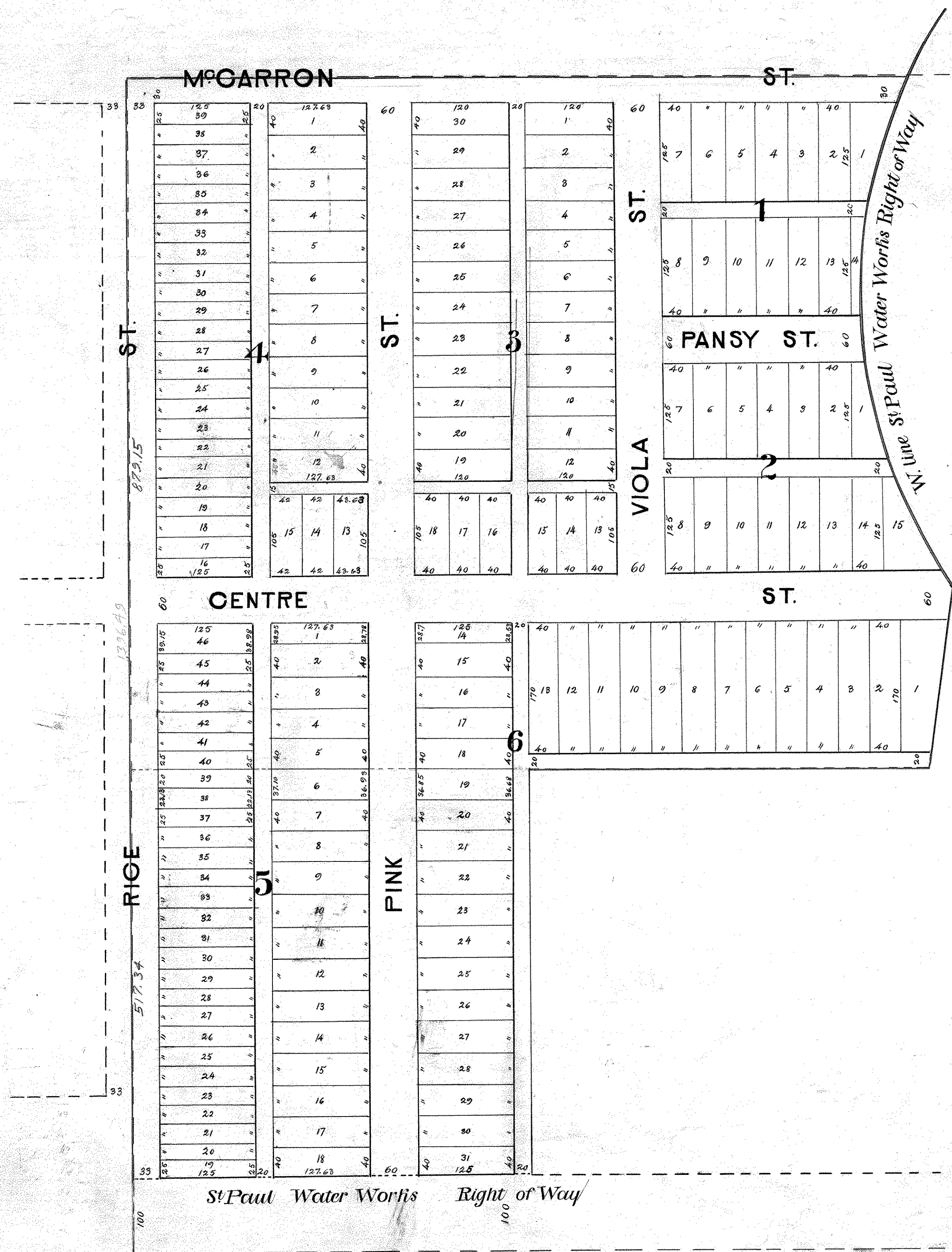

Description

Commencing at the S.W. Cor. of the N. one third of the S.W. 1/4 of Sec. 18 T. 29 N. R. 22 W. - thence N. along the W. line of said N. one third 879.15 ft. to the N.W. Cor. of said S.W. 1/4 - thence E. along the N. line of said S.W. 1/4 299.4 ft. to the W. line of the Right of Way of the St. Paul Water Works, thence S. along last named line to a point on the S. line of said N. one third, of the S.W. 1/4 - thence W. along last named line 1024.7 ft. to the point of beginning - also commencing at the S.W. Cor. of the N. one third of the S.W. 1/4 of Sec. 18 T. 29 N. R. 22 W. - thence E. along the S. line of said N. one third - 510.65 ft. - thence S. parallel to the W. line of said S.W. 1/4 - 516.65 ft. to the N. line of the Right of Way of the St. Paul Water Works - thence W. along last named line 510.65 ft. to a point on the W. line of said S.W. 1/4 - 517.34 ft. - S. from the point of beginning - thence N. 517.34 ft. to the point of beginning.