

# MACKUBIN & MARSHALL

This plat document is an UNOFFICIAL copy of a Subdivision Plat or Registered Land Survey and is made available for information purposes only.



To obtain an official copy please contact the Ramsey County Recorder's Office.

ADDITION TO

## S<sup>t</sup> Paul

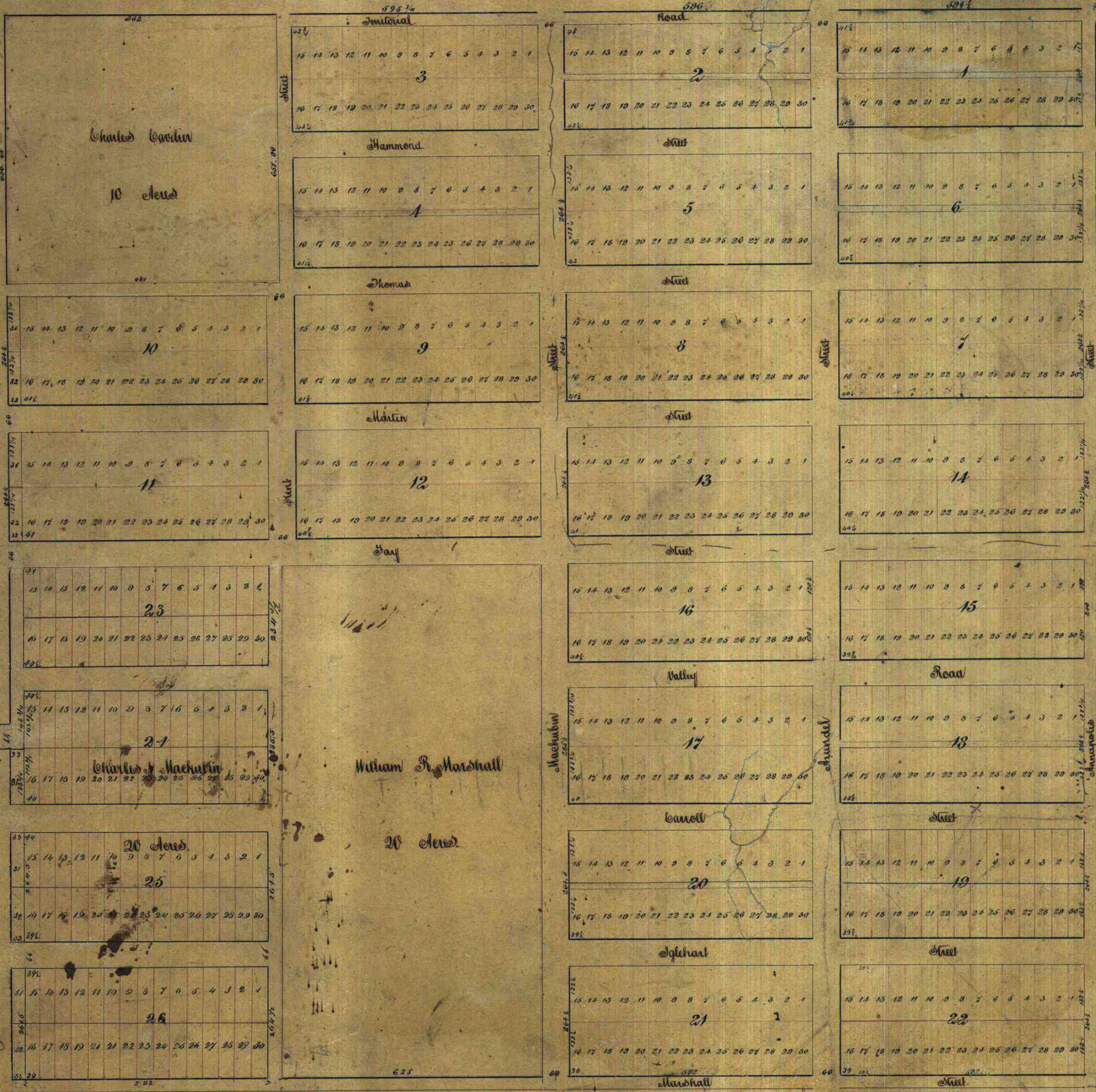

All lots will be sold, except the most westerly lots in each block. Alley's 18 feet.

*Handwritten notes on the left margin:*  
 The plat shows that Mackubin's addition to Saint Paul is a subdivision of the north half of Section 36, Township 29 North, Range 23 West, in Ramsey Co., Minnesota. The plat shows that Mackubin's addition is a subdivision of the north half of Section 36, Township 29 North, Range 23 West, in Ramsey Co., Minnesota.

*Handwritten notes on the left margin:*  
 On this tenth day of May, A.D. 1855, present the County of Ramsey, Territory of Minnesota, Charles A. Mackubin, William R. Marshall, and Harwood Sjohart, the parties to the above instrument, to be their returning act & deed for the uses & purposes herein stated.

Known all men by these presents, that S. Charles A. Mackubin, being the owner of the North East quarter of the South West quarter, containing 40 Acres of land, the East half and South West quarter of the North East quarter of the South West quarter, containing 30 Acres of land, the West half of the South West quarter, containing 20 Acres, and the West half and the North East quarter of the South East quarter of the South West quarter, containing 30 Acres of land, also the undivided one half of the South East quarter of the South East quarter, containing 10 Acres of land, All the above tracts of land being in and a part of the South West quarter of Section 36, Township 29 North, Range 23 West, in Ramsey Co., Minnesota Territory, and S. W. R. Marshall being the owner of the East half of the South West quarter of the South West quarter of Section 36, Township 29 North, Range 23 West, and S. Harwood Sjohart being the owner of the undivided one half of the S. E. 1/4 of the S. E. 1/4 of the S. W. 1/4 of Section 36, Township 29 North, Range 23 West, do hereby certify that we have laid out the same for town purposes, under the name of Mackubin and Marshall's addition to Saint Paul. And we do hereby give the streets herein named for the use of the public.

*Signatures:*  
 Charles A. Mackubin  
 William R. Marshall  
 Harwood Sjohart

*Footnote:*  
 The books containing the plat from accurate survey we made the above plat of Mackubin & Marshall's addition to Saint Paul. And that the same survey was made from actual measurement, and that the distances & areas of lots and tracts are correctly stated in said plat.

*Emerson House*