

WALCOTT'S

15

21

ADDITION TO COTTAGE HOMES'S

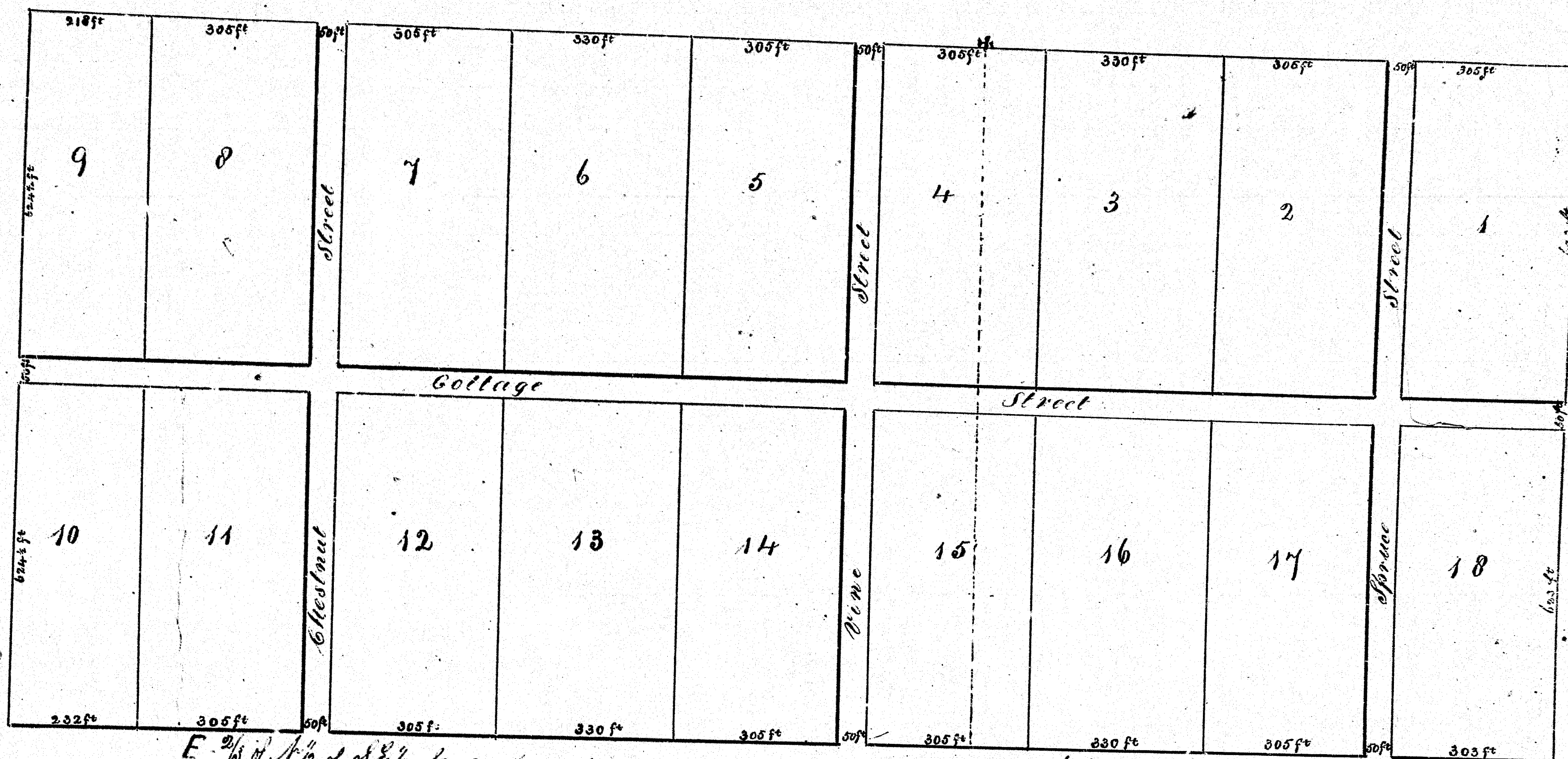

E. 1/2 of N. 1/2 of S. 1/4 Sec 24 Township 29 Range 23

N. 1/2 of S. 1/4 Sec 19 Township 29 Range 23

We hereby certify that the annexed is a correct plat of Walcott's Addition to Cottage Homes as surveyed by us in the month of July 1856 the same consisting of the east two thirds of the North half of the South east quarter of section No twenty four in Township No twenty nine North of Range No twenty three West, and the North West quarter of the South East quarter of section No nineteen in Township No twenty nine North of Range No twenty two West, containing altogether according to Gov Survey eight seven 7/100 acres. All lots contain according to Gov Survey five acres including streets, except lots No 9 & 10 which contain three 7/100 acres.

Wellman & Johnson
Civil Engineers & Surveyors

Office of Register of Deeds
County of Ramsey
I hereby certify that the above is a true copy of the certificate of the Original plat of Walcott's addition to Cottage Homes as filed in this office according to the day of August A.D. 56. It is recorded here as a portion of the first record.
Dated this 10th day of August A.D. 1856
Edw. H. Hallinan Reg. of Deeds
per Thomas Lyons cler. party

Office of Register of Deeds
County of Ramsey
I hereby certify that the above is a true copy of the certificate of the Original plat of Walcott's addition to Cottage Homes as filed in this office according to the day of August A.D. 56. It is recorded here as a portion of the first record.
Dated this 10th day of August A.D. 1856
Edw. H. Hallinan Reg. of Deeds
per Thomas Lyons cler. party

We hereby certify that the annexed is a correct plat of Walcott's addition to Cottage Homes as surveyed by us in the month of July 1856, the same consisting of the east two thirds of the North half of the South east quarter of section No twenty four in Township No twenty nine North of Range No twenty three West, containing altogether according to Gov. Survey Eight seven 7/100 Acres.

All lots contain according to Gov. Survey five acres including streets, except lots No 9 & 10 which contain three 7/100 Acres.

Wellman & Johnson
Civil Engineers and Surveyors.

Know all men by these presents that I Henry H. Kenty of Saint Paul in the County of Ramsey & Territory of Minnesota, did on the 23rd day of July A.D. 1856, authorize Wellman Johnson, Surveyor who sign the foregoing plat, to survey & plat a tract of land situated in the County of Ramsey aforesaid, to be called Walcott's addition to Cottage Homes, as hereon appears, and I do hereby release all my right title, interest and claim in and to the Roadways or Avenues as laid out on the foregoing plat, and give the same for public use.

Dated Saint Paul }
August 4th 1856 }
Attest:
L. A. LaRocque }
P. Lucey } Henry H. Kenty

Territory of Minnesota }
County of Ramsey }
Be it known that on this 4th day of August 1856, before me the undersigned personally came Henry H. Kenty, whose signature appears to the above instrument of writing, and who is personally known to me, he acknowledged that he signed the same freely & voluntarily for the uses & purposes therein expressed.

E. J. Way
Notary Public, Minnesota.

Henry H. Kenty's Addition to Cottage Homes as shown in section 24, Township 29, Range 23, containing 87 7/100 acres, surveyed July 1856, and recorded in the Register of Deeds of Ramsey County, Minnesota, on August 10, 1856.

Office of Register of Deeds
County of Ramsey
I hereby certify that the above is a true copy of the certificate of the Original plat of Walcott's addition to Cottage Homes as filed in this office according to the day of August A.D. 56. It is recorded here as a portion of the first record.
Dated this 10th day of August A.D. 1856
Edw. H. Hallinan Reg. of Deeds
per Thomas Lyons cler. party