

# Buel and Mackubin's Out Lots

Town 29 Range 23

This plat document is an UNOFFICIAL copy of a Subdivision Plat or Registered Land Survey and is made available for information purposes only.

To obtain an official copy please contact the Ramsey County Recorder's Office.

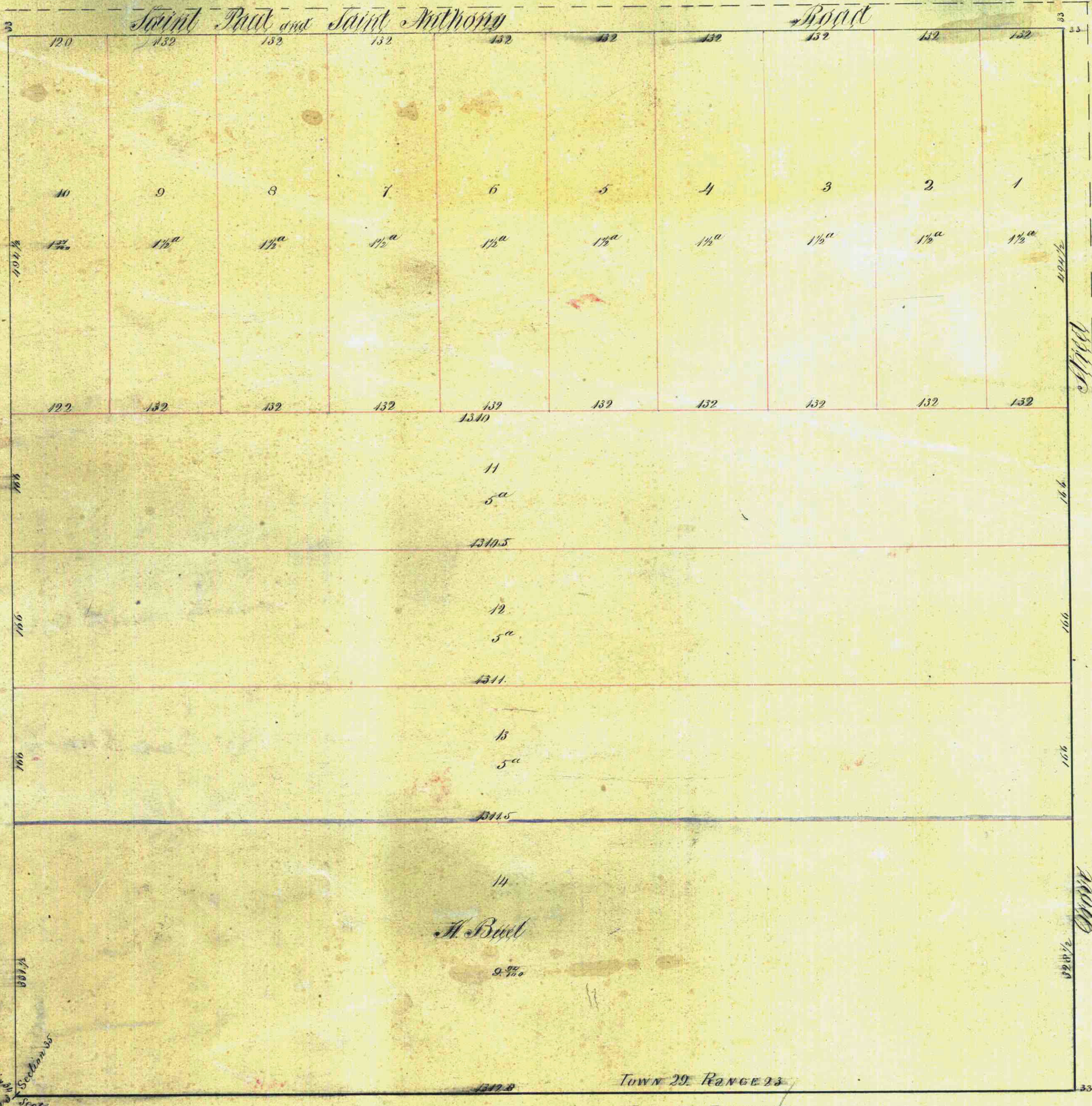

We Henry Buel, & Charles F. Mackubin proprietors of Buel & Mackubin's out lots in Town 29, Range 23 do hereby certify that we caused the same to be laid out as indicated on this map, to the end that the same may be recorded as the law directs and we do hereby give the streets therein designated for public use.

St. Paul, Aug 9<sup>th</sup> 1856. Henry Buel  
Charles F. Mackubin

Office of Register of Deeds  
Ramsey County Minn.  
I hereby certify that this map was filed in this Office for record on the ninth day of August A.D. 1856 at 3 1/4 o'clock P.M. and was duly recorded.

Louis W. Oliver  
Register of Deeds  
Geo. S. DeWitt Deputy

I do hereby certify that this is a correct plat of Buel & Mackubin's out lots in Town 29, Range 23 as surveyed by me in the month of July A.D. 1856.

James W. Case  
City Engineer St. Paul

Territory of Minnesota  
County of Ramsey  
I do hereby certify that on this 9<sup>th</sup> day of August A.D. 1856, personally appeared before me Henry Buel & Charles F. Mackubin the signers and Deeds of the above certificate and acknowledged the same to be their own act and deed for the purposes and intent therein expressed.

E. J. Gray  
Notary Public  
Minnesota

Note  
Buel & Mackubin's out lots in Town 29, Range 23 lying in the SW 1/4 of Sec 23. On the east side of this plat consist of 14 lots.