

WEST END SECOND ADDITION

KNOW ALL PERSONS BY THESE PRESENTS: That Independent School District Number 625, a Minnesota public school district, fee owner of the following described property situated in the City of Saint Paul, County of Ramsey, State of Minnesota:

Except Seventh Street, all of Block 22, WEST END

Has caused the same to be surveyed and platted as WEST END SECOND ADDITION

In witness whereof said Independent School District Number 625, a Minnesota public school district, has caused these presents to be signed by its proper officers this 26th day of December, 2018.

SIGNED: Independent School District Number 625, a Minnesota public school district

[Signature] as Board Chair
[Signature] as Clerk

STATE OF MINNESOTA
COUNTY OF Ramsey

The foregoing instrument was acknowledged before me this 26th day of December, 2018, by Zuki Ellis, Chair and by Jeanette Foster, Clerk of Independent School District Number 625, a Minnesota public school district, on behalf of the district.

[Signature]
Notary Public, Ramsey County, Minnesota
My Commission Expires January 31, 2022

[Signature]
Notary Printed Name

I, Mark R. Salo, Professional Land Surveyor, do hereby certify that I have surveyed or directly supervised the survey of the property described on this plat; prepared this plat or directly supervised the preparation of this plat; that this plat is a correct representation of the boundary survey; that all mathematical data and labels are correctly designated on this plat; that all monuments depicted on this plat have been correctly set; that all water boundaries and wet lands, as defined in Minnesota Statutes, Section 505.01, Subd. 3, as of the date of the surveyor's certification are shown and labeled on this plat; and all public ways are shown and labeled on this plat.

Dated this 9th day of November, 2018.

[Signature]
Mark R. Salo, Licensed Land Surveyor,
Minnesota License No. 43933

STATE OF MINNESOTA
COUNTY OF Hennepin

The foregoing instrument was acknowledged before me this 9th day of November, 2018, by Mark R. Salo, a Licensed Land Surveyor.

[Signature]
Notary Public, Hennepin County, Minnesota
My Commission Expires January 31, 2023

[Signature]
Notary Printed Name

City of Saint Paul, Minnesota

I do hereby certify that on the 17 day of October, 2018 the City Council of the City of Saint Paul, Minnesota, approved this plat and is in compliance with the provisions of Minnesota Statutes, Section 505.03, Subd. 2.

[Signature] Clerk

Property Tax, Records and Election Services Department

Pursuant to Minnesota Statutes, Section 505.021, Subd. 9, taxes payable in the year 2019 on the land hereinbefore described have been paid. Also, pursuant to Minnesota Statutes, Section 272.12, there are no delinquent taxes and transfer entered this 9 day of JANUARY, 2019.

Christopher A. Samuel, Ramsey County Auditor/Treasurer

By _____, Deputy

County Surveyor

Pursuant to Minnesota Statutes, Section 383A.42, this plat is approved this 9th day of January, 2019.

[Signature]
Craig W. Hirfman, L.S.,
Ramsey County Surveyor

County Recorder, County of Ramsey, State of Minnesota

I hereby certify that this plat of WEST END SECOND ADDITION was filed in the office of the County Recorder for public record on this 9th day of JANUARY, 2019, at 11 o'clock A.M. and was duly filed in Book 128 of Plats, Page 27, as Document Number A742380.

_____, Deputy County Recorder

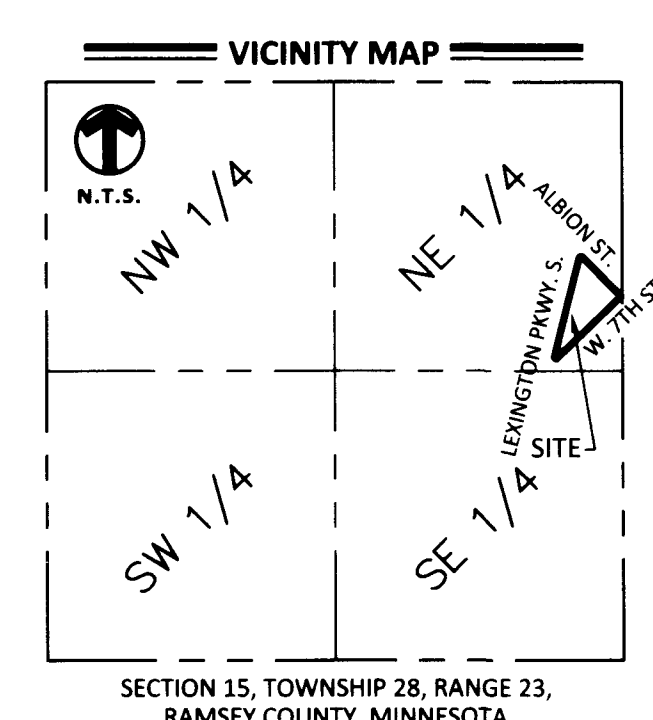
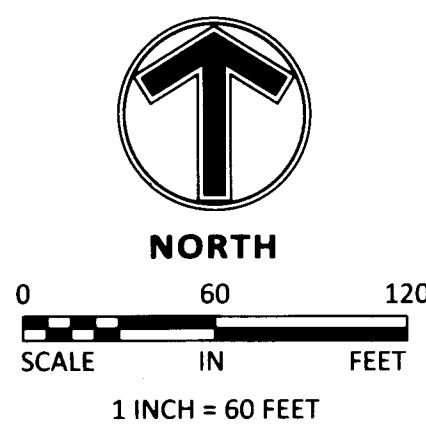

- DENOTES 1/2 INCH BY 14 INCH IRON PIPE SET AND MARKED BY LICENSE NO. 43933.
 - DENOTES 1/2 INCH IRON PIPE FOUND, R.L.S. NO. 15480, UNLESS NOTED OTHERWISE.
- THE NORTHWESTERLY LINE OF BLOCK 22, WEST END, IS ASSUMED TO HAVE A BEARING OF SOUTH 14 DEGREES 18 MINUTES 43 SECONDS WEST.

