

BRYANT'S



ADDITION.

SCALE 1 INCH = 50 FEET.

This plat document is an UNOFFICIAL copy of a Subdivision Plat or Registered Land Survey and is made available for information purposes only.



To obtain an official copy please contact the Ramsey County Recorder's Office.

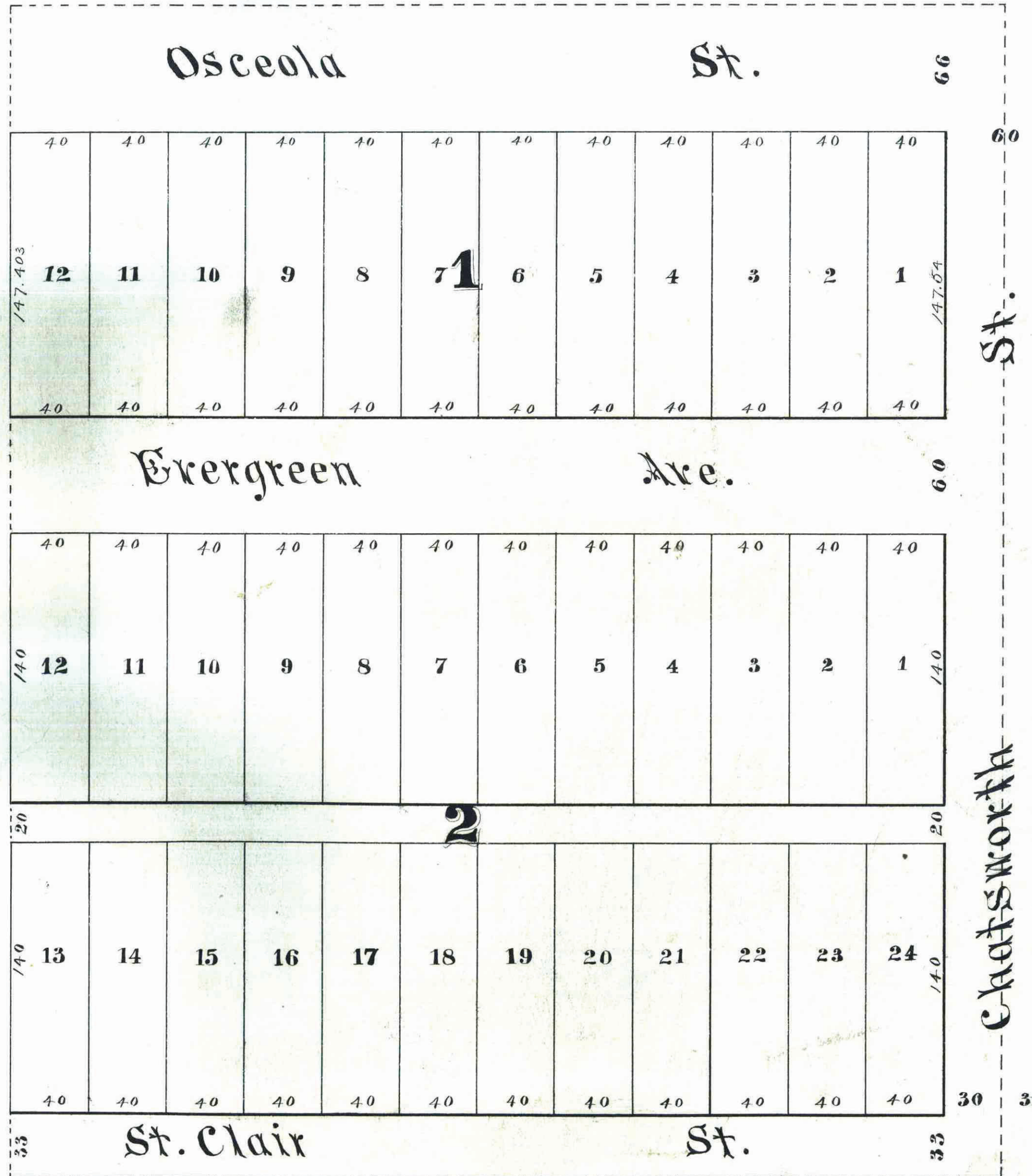

St.

Chatsworth

ADD.

HALDMAN'S

Drawn by L.M. BURGESS

We, John A. Bryant and C. Anna Bryant his wife hereby certify that we are the owners of the following described property to wit: Commencing at the southeast corner of the south west 1/4 of the southwest 1/4 of Section 2, Town 28 North Range 23 West; Thence west 510 feet along the south line of said 1/4 section; Thence north 606.403 feet; Thence east 510 feet to the east line of the said 1/4 section; Thence along last named line 606.54 feet south to the point of beginning and that we have caused the same to be surveyed and platted as BRYANT'S PARK ADDITION as herein and hereon indicated, and we do hereby give and dedicate to the public and for the public use forever all the streets and alleys as on this map or plat laid out, and designated.

In witness whereof we have hereunto set our hands and seals this twenty ninth day of March A. D. 1884.

In Presence of
D. L. Justice
Louise M. Burgess

John A. Bryant
C. Anna Bryant



State of Minnesota, } ss. Be it known That on this 29th day of March A. D. 1884 before me personally came John A. Bryant and C. Anna Bryant his wife to me known to be the identical persons described in and who executed the foregoing instrument and who acknowledged that they executed the same freely and voluntarily for the uses and purposes therein expressed.

Edward Swinton
Notary Public
Ramsey Co., Minn

St. Paul Minn March 29th 1884.

I certify to having surveyed and platted the property as described on this map as Bryant's Park Addition and have placed iron monuments at the corners of each and every Block as shown on this map and the same is correct.

D. L. Justice

Surveyor

State of Minnesota, } ss. Personally appeared before the undersigned D. L. Justice to County of Ramsey, } me well known to be the identical person who surveyed and platted the herein designated and described piece or parcel of land and who executed the certificate of the survey thereof, and he acknowledged the same to be true and correct and his free act and deed for the uses and purposes therein expressed, witness my hand and seal this 29th day of March A. D. 1884

Edward Swinton
Notary Public
Ramsey Co., Minn

Approved March 29th 1884. } Jas. Starkey } PLAT. COMMISSIONER.
Wm. A. Rausley

I have examined the within plat and recommend its approval.

Dated St. Paul, Minn April 1st 1884 W. A. Evans
City Engineer.

Accepted by the Common Council April 1st 1884.
W. A. Evans
City Clerk.

May 8th 1884.
Taxes Paid J. M. Candy
County Auditor.
Ramsey County.
Minnesota.

STATE OF MINNESOTA, } ss.
County of Ramsey, }
OFFICE OF THE REGISTER OF DEEDS.
This is to certify that the within instrument was filed for Record in this office, at St. Paul, on the 8 day of May A. D. 1884 at 4:30 o'clock P. M., and that the same was duly recorded in Book 26 of Plats pages 24
R. C. Wiley
Register of Deeds.
By _____ Deputy.