

THE COTTAGES AT SILVER LAKE VILLAGE

KNOW ALL MEN BY THESE PRESENTS: That Pratt Construction Inc., a Minnesota corporation, fee owner and Alliance Bank, a Minnesota corporation, mortgagee of the following described property situated in the City of St. Anthony, County of Ramsey, State of Minnesota:

- LOT 2, BLOCK 1, WIRTH ADDITION, RAMSEY COUNTY, MINNESOTA
- AND
- LOT 2, BLOCK 1, BEUTZ ADDITION, RAMSEY COUNTY, MINNESOTA
- AND
- LOT 3, BLOCK 2, APACHE PLAZA, RAMSEY COUNTY, MINNESOTA

Have caused the same to be surveyed and platted as THE COTTAGES AT SILVER LAKE VILLAGE and do hereby dedicate to the public for public use forever the drainage and utility easement throughout OUTLOT A, as shown on this plat.

In witness whereof said Pratt Construction Inc., a Minnesota corporation, has caused these presents to be signed by its proper officer this 19th day of March, 2007.

Signed: Pratt Construction Inc.
Leonard W. Pratt
Leonard W. Pratt, President

STATE OF MINNESOTA
COUNTY OF RAMSEY

The foregoing instrument was acknowledged before me this 19th day of March, 2007, by Leonard W. Pratt, the President of Pratt Construction Inc., a Minnesota corporation, on behalf of the corporation.

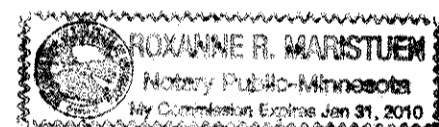

Rosanne B. Maristuen
Notary Public, Chisago County, Minnesota.
My Commission Expires Jan 31, 2010

In witness whereof said Alliance Bank, a Minnesota corporation, has caused these presents to be signed by its proper officer this 30th day of March, 2007.

Signed: Alliance Bank
T. T. T.
T. T. T. Vice President

STATE OF MINNESOTA
COUNTY OF Ramsey

The foregoing instrument was acknowledged before me this 30th day of March, 2007, by Tim Fallon, the Vice President of Alliance Bank, a Minnesota corporation, on behalf of the corporation.

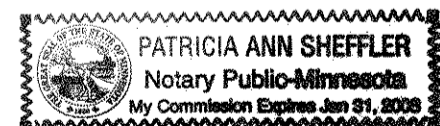

Patricia A. Sheffler
Notary Public, Ramsey County, Minnesota.
My Commission Expires 1-31-08

I, Ronald P. Alwin, hereby certify that I have surveyed and platted the property described on this plat as THE COTTAGES AT SILVER LAKE VILLAGE; that this plat is a correct representation of the survey; that all distances are correctly shown on this plat in feet and hundredths of a foot; that all monuments have been correctly placed in the ground as shown; that the outside boundary lines are correctly designated on this plat; and there are no wet lands as defined in Minnesota Statutes, Section 505.02, Subd. 1, or public highways to be designated other than as shown on this plat.

Ronald P. Alwin
Ronald P. Alwin, Land Surveyor
Minnesota License No. 17765

STATE OF MINNESOTA
COUNTY OF RAMSEY

The foregoing Surveyor's Certificate was acknowledged before me this 30th day of NOVEMBER, 2006, by Ronald P. Alwin, a Licensed Land Surveyor.

James Anderson
Notary Public, Ramsey County, Minnesota
My Commission Expires January 31, 2010

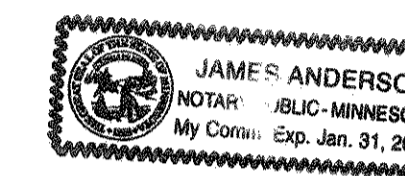

City of St. Anthony

We do hereby certify that on the 27th day of March, 2006, the City Council of the City of St. Anthony, Minnesota, approved this plat. Pursuant to Minnesota Statutes, Section 505.02, Subd. 1, all monuments must be set as specified by the City Council and as stated and shown on this plat. Also, the conditions of Minnesota Statutes, Section 505.03, Subd. 2, have been fulfilled.

James D. Taut
Mayor
Barbara J. Blain
Clerk

Department of Property Records and Revenue

Taxes payable in the year 2007 on the land herein described have been paid, also there are no delinquent taxes and transfer entered this 27th day of April, 2007.

David Twa, Director
Property Records and Revenue
By [Signature], Deputy

County Surveyor

Pursuant to Minnesota Statutes, Section 383A.42, this plat is approved this 27th day of APRIL, 2007.

David D. Claypool
David D. Claypool, P.L.S.
Ramsey County Surveyor

County Recorder, County of Ramsey, State of Minnesota

I hereby certify that this plat of THE COTTAGES AT SILVER LAKE VILLAGE was filed in the office of the County Recorder for public record on this _____ day of _____, 20____, at _____ o'clock _____ .M. and was duly filed in Book _____ of Plats, Pages _____ and _____ as Document Number _____.

Deputy County Recorder

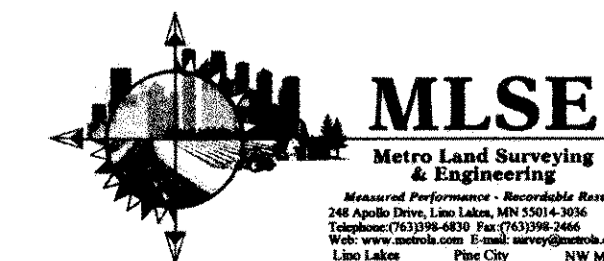

THE COTTAGES AT SILVER LAKE VILLAGE

Witness Monument to West Quarter Corner of Sec.31, T.30, R.23 Found Granite Monument

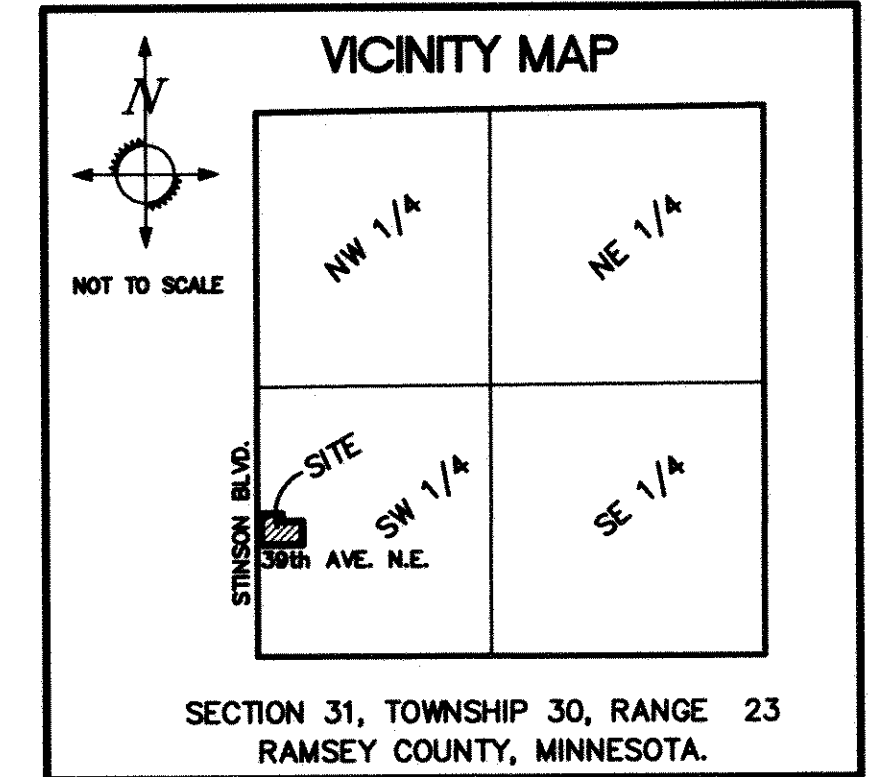
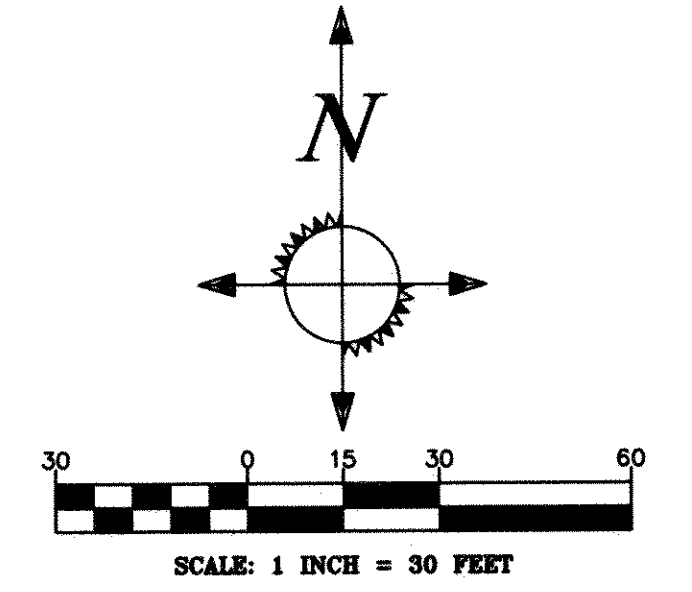

- Denotes 1/2 inch by 14 inch iron pipe, set and marked by R.L.S. No. 17765.
- Denotes found 1/2 inch iron pipe (unless noted otherwise)
- ⊙ Ramsey County Cast Iron Monument

THE ORIENTATION OF THIS BEARING SYSTEM IS BASED UPON THE WEST LINE OF THE SW 1/4 OF SECTION 31, TOWNSHIP 30, RANGE 23, WHICH IS ASSUMED TO BEAR N00°23'18"W.

SW Cor. SEC. 31, T.30, R.23, Found Ramsey County Cast Iron Monument

