

Know all Men that we **William Dawson**, **Robert A. Smith**, and **John C. Terry** the proprietors of Terry's Addition to the City of Saint Paul, County of Ramsey, and State of Minnesota, do hereby certify that we have caused the same to be surveyed and subdivided into Lots and Blocks as indicated in the foregoing Plat for the purpose of having the same recorded according to Law; and we hereby release our right, title, interest and claim in and to the Streets and Alleys as laid out in said Plat, and we give the same for public use; but said proprietors do not hereby dedicate any part of said land above described for railroad tracks, or railroad purposes, nor release hereby to any railroad now located or hereafter to be located upon or across said land any right of way, easement or any estate or interest therein; and especially reserves herefrom that portion of said land occupied by the line of the Saint Paul, Stillwater, and Taylor's Falls Rail Road as indicated in said Plat.

Witness our hands and seals this Eleventh day of August A.D. 1875.

William Dawson (Seal)
Robert A. Smith (Seal)
John C. Terry (Seal)

I certify that this is an accurate plat of Terry's Addition to the City of Saint Paul, in the County of Ramsey, and State of Minnesota, as surveyed by me Twenty-eight (28) Town Twenty-nine (29) Range Twenty-two (22) West, in Ramsey County, and State of Minnesota.

Charles R. Stone
 Civil Engineer

Office of Register of Deeds
 Ramsey County
 State of Minnesota

I hereby certify that the within Plat of Terry's Addition was filed in this Office on the 11th day of August A.D. 1875, at 5 o'clock P.M., and duly recorded on page 9 of Book 2 of town plats.

W. M. Manger
 Register of Deeds.

Office of County Auditor
 Ramsey County
 State of Minnesota

Taxes paid and transferred
 day of August A.D. 1875

J. B. Oliver
 County Auditor

Office of City Clerk
 City of Saint Paul

I certify that the foregoing Addition was adopted by the Common Council of the City of Saint Paul, on the 12th day of August A.D. 1875.

W. A. Connor
 City Clerk

M.A.P.

TERRY'S ADDITION TO THE CITY OF ST. PAUL.

1875

I Certify, that the Streets in Terry's Addition to the City of Saint Paul, as shown by this Plat, conform with the streets in adjoining additions.

D. L. Justice
 City Surveyor

Scale, 100 Feet to 1 Inch

This plat document is an UNOFFICIAL copy of a Subdivision Plat or Registered Land Survey and is made available for information purposes only.

To obtain an official copy please contact the Ramsey County Recorder's Office.

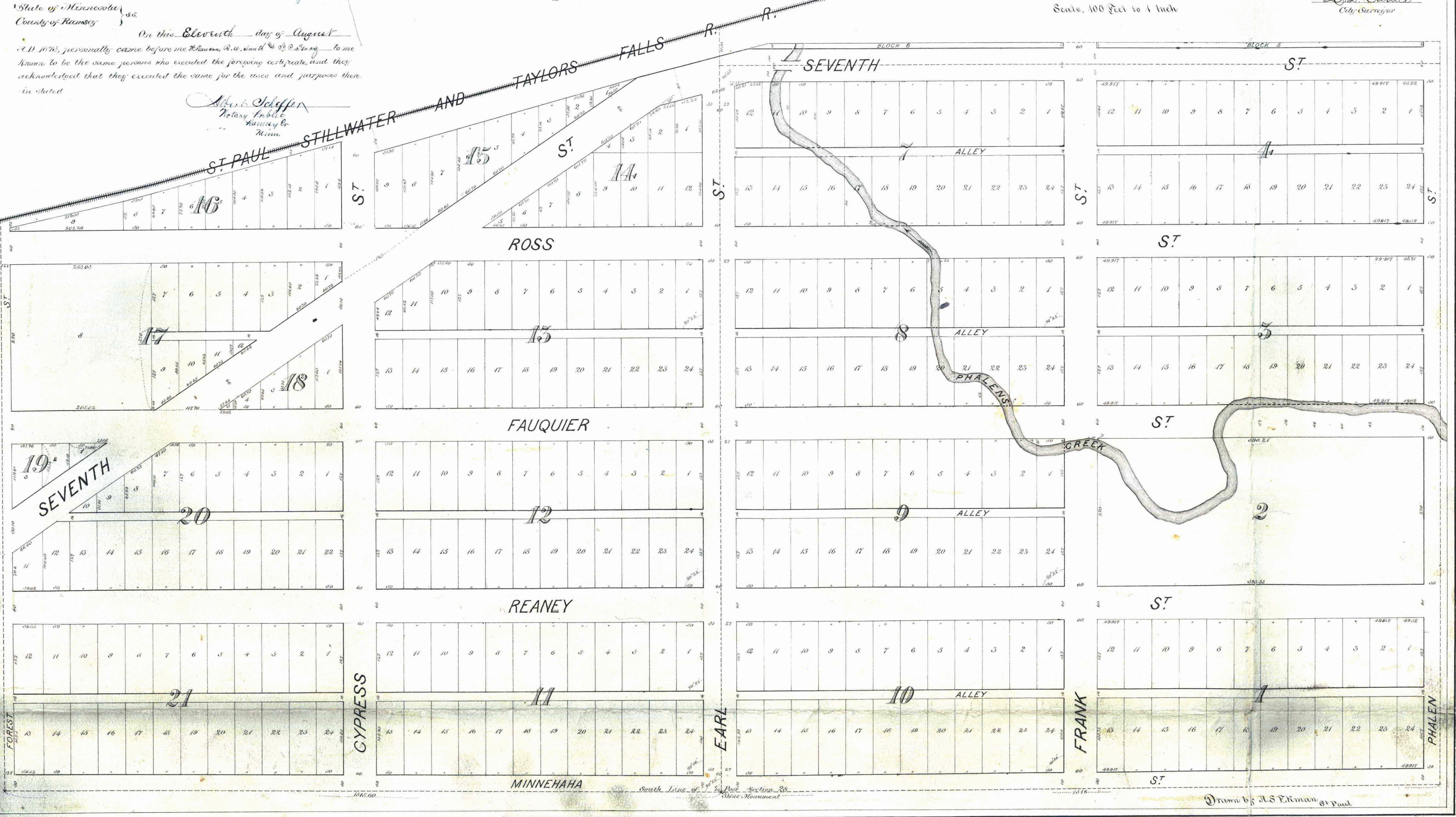

Drawn by J. S. Ekman St. Paul