

Approved July 5/82
 S. D. Nelson
 J. P. Vanduyke

Examined and approved
 L. W. Turnbull Esq. Esq.
 July 13th 1882

C. W. TURNBULL'S

SUBDIVISION.

This plat document is an UNOFFICIAL copy of a Subdivision Plat or Registered Land Survey and is made available for information purposes only.

To obtain an official copy please contact the Ramsey County Recorder's Office.



STATE OF MINNESOTA, ss.
 County of Ramsey,
 OFFICE OF THE REGISTER OF DEEDS.
 This is to certify that the within instrument was filed for Record in this office, at St. Paul, on the 22nd day of July, A. D. 1882 at 10:30 clock A. M., and that the same was duly recorded in Book 8 of Plats page 29.

By W. Whienain Register of Deeds.
 Deputy.

29



We certify that we are the owners of the within Subdivision as shown shown that they are conveyed to the persons to whom they are dedicated for public use.

State of Minnesota
 County of Ramsey
 BE it known that on this 9th day of June 1882 personally came before me Amanda Turnbull and Geo. W. Turnbull and they acknowledged that they executed the foregoing plat for the uses and purposes there expressed.

Geo. W. Turnbull
 Amanda Turnbull

Subscribed and attested in presence of
 Notary Public Ramsey Co
 St. Minn.

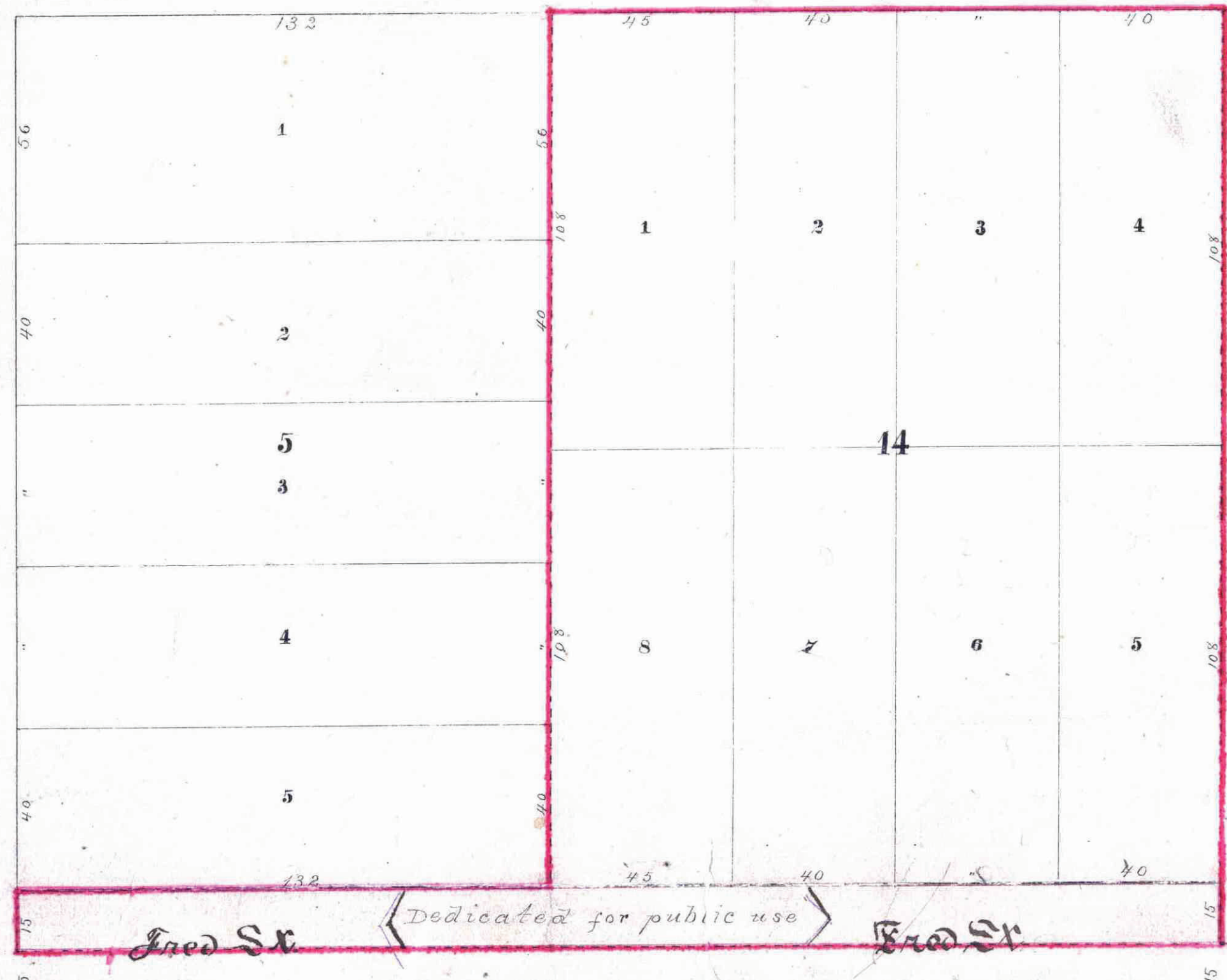

Taxes Paid July 21/82
 J. M. Cardy
 O. Aughr
 per Subd. Plat

City Treasurers' Office,
 ST. PAUL, MINN.
 JUL 20 1882
 ASSES PAID
 Geo. Reis City Treas.

I certify that this diagram correctly represents Turnbull's Subdivision, and that said Subdivision embraces part Block 5 of Subdivision of and Addition to Irwin's Addition of Out Lots, also Lot 14 of Irwin's Out Lots as enclosed by full red line.

St. Paul, Minn. Oct 26th 1880
 D. S. Curtiss, C. E.

Accepted by Common Council July 18 1882
 W. H. ...