

TERRACE PARK

ADDITION TO St Paul.

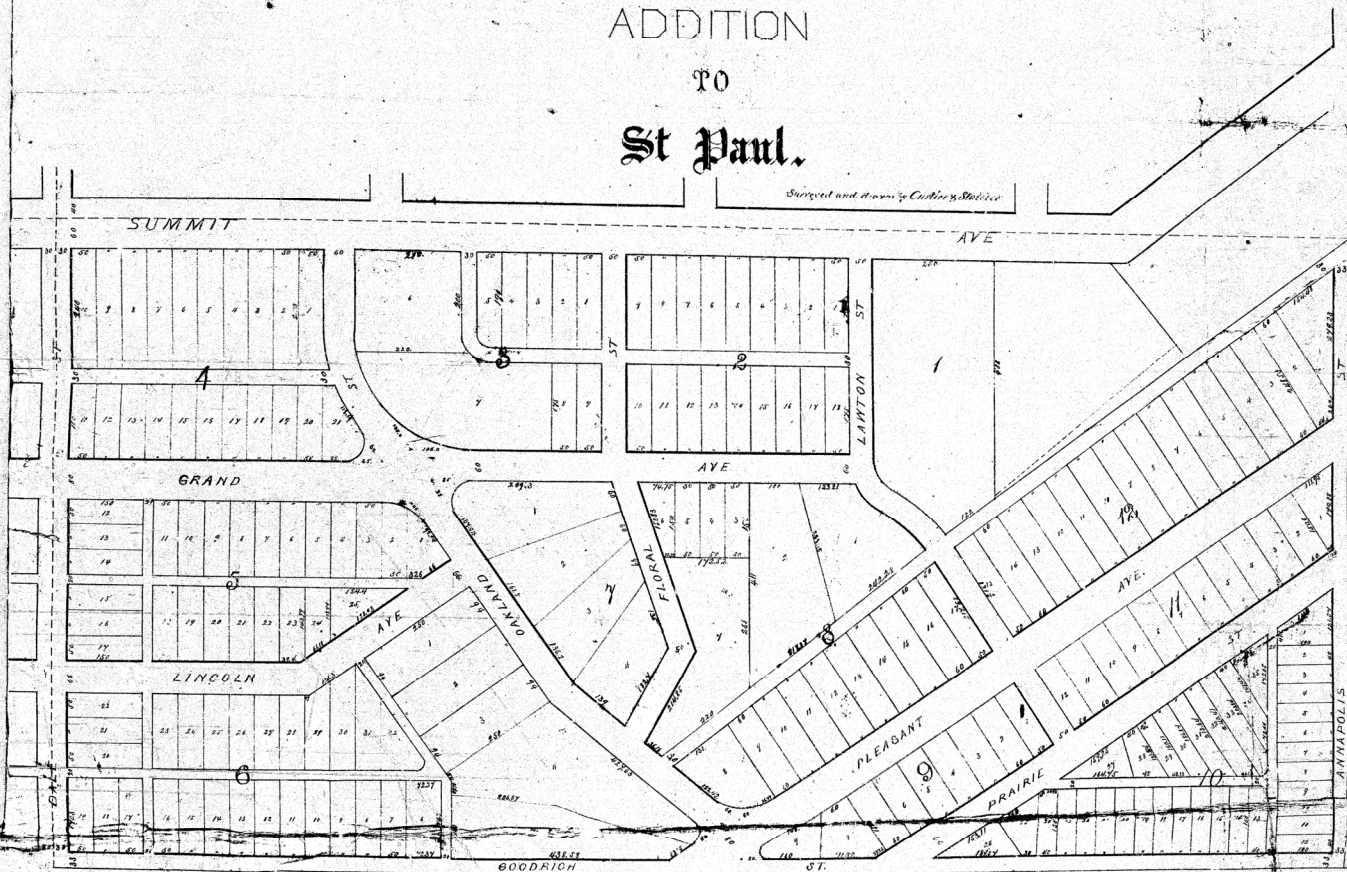

State of Minnesota

County of Ramsey

We the undersigned Surveyor of Terrace Park Addition to the City of St Paul Ramsey County State of Minnesota do hereby certify that the foregoing plat was conveyed and plotted by us in pursuance of the laws of this State and we do hereby give to the public use the streets and alleys as designated thereon. Witness our hands and seals this twentieth day of September 1871.

[Signature]
Surveyor

We certify that this is a correct plat of Terrace Park Addition to the City of St Paul Ramsey County State of Minnesota as shown and drawn by us in pursuance of the laws of this State. Witness our hands and seals this twentieth day of September 1871.

[Signature]
Cuthbert & Stiles

Scale 100 feet = 1 inch

[Handwritten notes and signatures]