

# BRAYTON'S ADDITION

TO THE

## CITY OF ST. PAUL

Scale: 1 in. = 40 ft.

Surveyed and Drawn by,

**ELMER, NEWELL, & MORRISON,**

Civil Engineers.

STATE OF MINNESOTA,  
County of Ramsey,  
OFFICE OF THE REGISTER OF DEEDS.  
This is to certify that the within  
instrument was filed for record  
in this office, at St. Paul, on the  
23rd day of March, A. D.  
1885 - at 9 o'clock P. M., and  
that the same was duly recorded  
in Book W of Page  
R. C. Carley  
REGISTER OF DEEDS.  
RAMSEY COUNTY.

This plat document is an UNOFFICIAL copy of a Subdivision Plat or Registered Land Survey and is made available for information purposes only.  
To obtain an official copy please contact the Ramsey County Recorder's Office.

George M. Brayton & Elizabeth B. Brayton his wife - both of Cleveland Ohio owners of the following described property, viz: Commencing at a point stone monument on the north section line of section twenty five (25) Township twenty nine (29), north range twenty three (23) west, in the County of Ramsey, State of Minnesota, nine hundred and ninety (990) feet west of the northeast corner of said section twenty five (25), thence south on a line parallel with east section line of said section twenty five (25), six hundred and sixty (660) feet; thence east on line parallel with north section line of said section twenty five (25), three hundred and thirty (330) feet; thence north on a line parallel with east section line of said section twenty five (25), six hundred and sixty (660) feet to a point on north section line of said section twenty five (25); thence west on last described line, three hundred and thirty (330) feet, to point of beginning; do hereby certify that we have caused the same to be surveyed and plotted under the title of "Brayton's Addition to the City of St. Paul"; and that we do hereby give and dedicate to the public use and for the public use forever all streets and alleys as shown on this map. In witness whereof we hereunto set our hands and seals this 27th day of January A. D. 1885.  
In presence of George M. Brayton Elizabeth B. Brayton  
C. F. Hall  
C. W. Wright

State of Arkansas } S.S.  
County of Garland }  
On this 27th day of January A. D. 1885, personally appeared before me George M. Brayton & Elizabeth B. Brayton to me known to be the identical person described in, and who executed the foregoing certificate; and acknowledged having executed the same of their own free will and accord. Witness my hand and Notarial seal.  
Chas. Dix  
Notary Public  
County

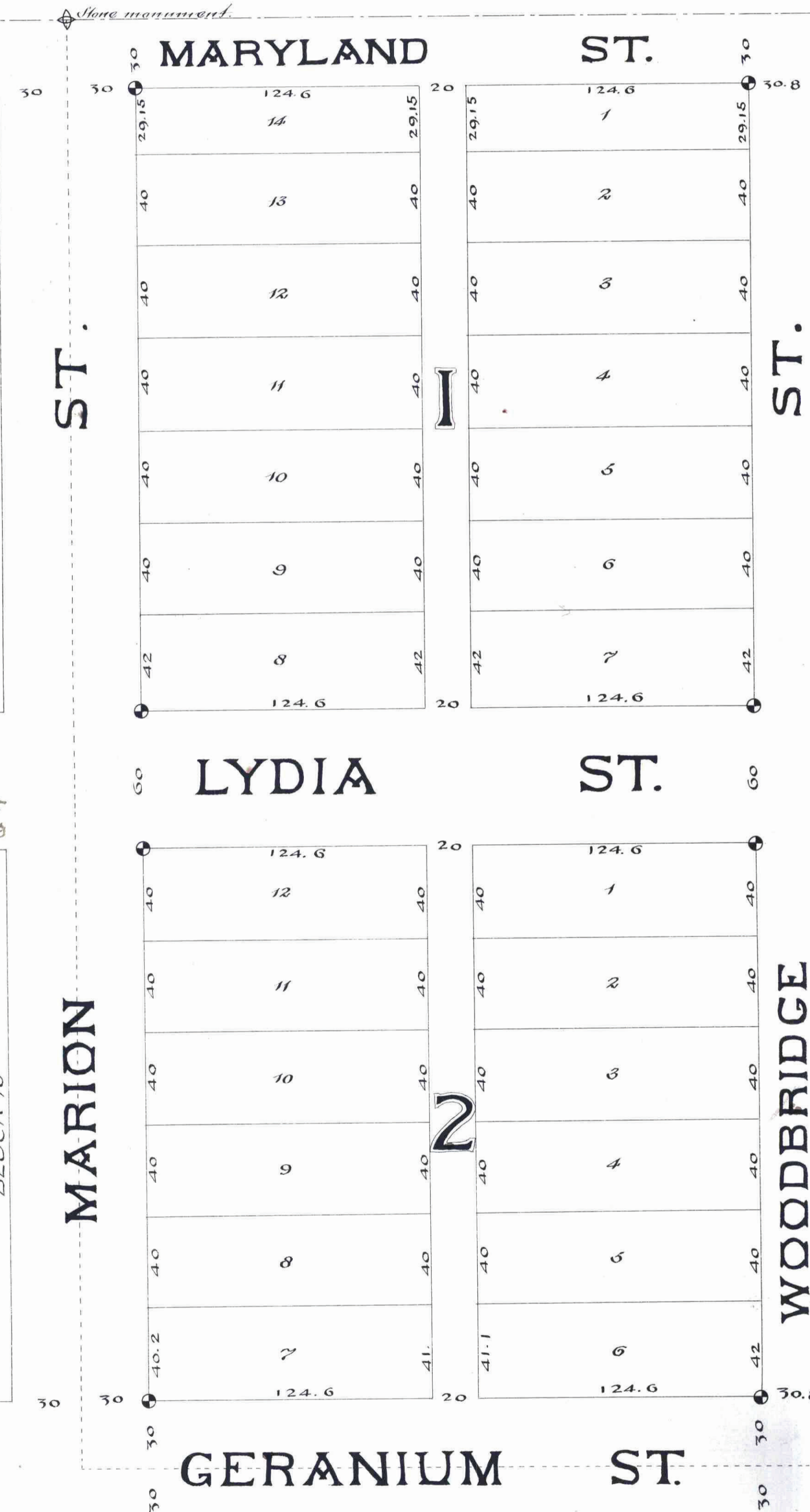

State of Minnesota } S.S.  
County of Ramsey }  
On this 19th day of January A. D. 1885, personally appeared before me J. M. Morrison to me known to be a member of the firm of "Emmer, Kenell, and Morrison", Civil Engineers; who, being duly sworn as knowledgeable having surveyed and plotted the within described property as shown on this plat and having placed iron monuments at all block corners as the law directs, and that the same is correct. Witness my hand and notarial seal.  
Robert A. Dougan  
Notary Public  
Ramsey County.

Examined and Approved  
March 6 - 1885  
W. A. Emmer  
City Engineer.

Approved  
St. Paul 21st day of Feb. A. D. 1885  
J. P. Tolson  
Jas. Starkey } Not. Commission.

Approved by the City Council of the City of St. Paul March 17th 1885  
Wm. H. Stewart  
City Clerk.

We, the undersigned Civil Engineers do hereby certify to having surveyed and plotted the within described property and placed iron monuments at all block corners and the same is correct.  
Elmer, Newell & Morrison  
Civil Engineers

BLK. 13. AUERBACH & HAND'S ADD.

CITY TREASURER'S OFFICE  
ST. PAUL, MINN.  
MAR 23 1885  
ASSESSMENTS PAID  
Chapman Peck  
CITY TREAS.

Indicates Iron monument.

March 23rd 1885  
Taxes paid and transfer returned  
James O'Brien  
Co. Auditor  
Peoples