

SKIDMORE & CASSEY'S

PARK Addition To The

City of Saint Paul,
Ramsey Co., Minn.
Scale: 1 in. 60 ft.

HAWLEY & NEWELL,
Civil Engineers and Landscape
ARCHITECTS,
Rooms 36 37 Chamber of Commerce Building,
ST. PAUL, - MINN.

284007 Dec 4, Sec. 4, T. 28, R. 23
1/4 Sect.

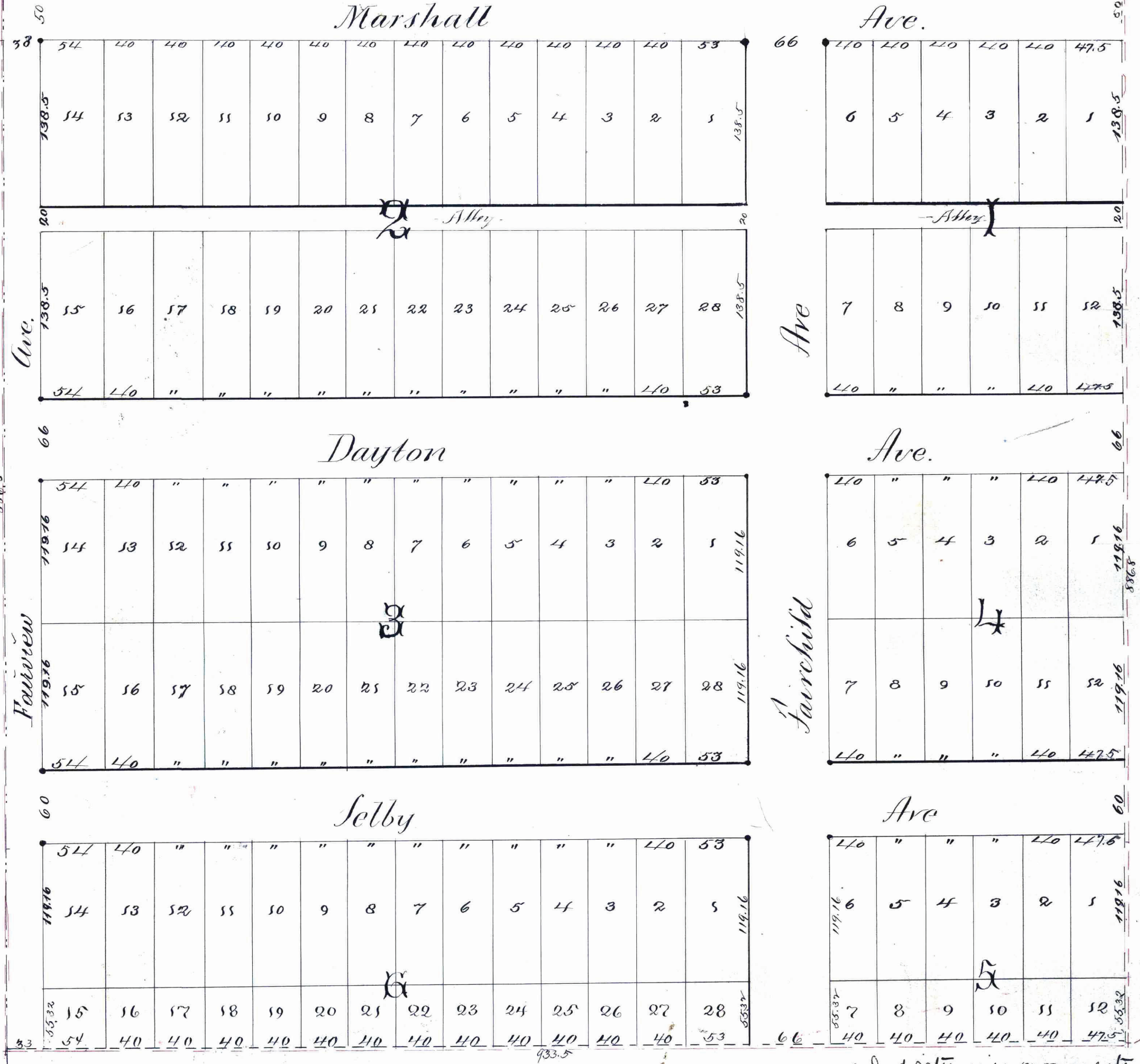

This plat document is an UNOFFICIAL copy of a Subdivision Plat or Registered Land Survey and is made available for information purposes only.

To obtain an official copy please contact the Ramsey County Recorder's Office.

HAWLEY & NEWELL,
Civil Engineers and Landscape
ARCHITECTS,
Rooms 36 37 Chamber of Commerce Building,
ST. PAUL, - MINN.

STATE OF MINNESOTA)
County of Ramsey)
Office of the Registrar of Deeds)
This is to certify that the within)
instrument was filed for record)
in my office, at St. Paul, on the)
18th day of August, A. D. 1886,)
at 10 o'clock A. M., and)
that the same was recorded in)
Book No. 10, page 101.)
By: *R. S. Wiley*)
Registrar of Deeds.

CITY TREASURER'S OFFICE
SEP 13 1886
ASSESSMENTS PAID
Geo. W. ...
CITY TREAS.

This is to certify that Edwin S. Skidmore and Emma D. Skidmore, his wife; Abram S. Cassidy and Margaret J. Cassidy, his wife, owners and promoters of the following described property, beginning at the N.W. Cor. of the N.E. 1/4 of section four (4) Township Twenty Eight (28) North Range Twenty Three (23) west of the 4th. Principal Meridian, thence east along section line north of said section four (4) nine hundred and thirty three and 7/10 (933 7/10) feet to a point which said point is the north west corner of Oakland Park Addition to the City of St Paul on file in the Register of Deeds Office of Ramsey County, Minnesota; thence, - southerly and parallel to west line of said quarter section eight hundred and eighty six and 7/10 (886 7/10) feet; thence, westerly and parallel to north line of said quarter section nine hundred and thirty three and 7/10 (933 7/10) feet to a point in westerly line of said quarter section; thence, north along west line of said quarter section eight hundred and eighty six and 7/10 (886 7/10) feet to place of beginning - have caused the same to be surveyed and platted as shown hereon and do give and dedicate to the public and for the public use forever all the Avenues & Alleys as indicated.

Witness our hands & seals this 22nd day of June A.D. 1886
In presence of
W. S. Cassidy
R. S. Fleming

Edwin S. Skidmore (Seal)
Emma D. Skidmore (Seal)
Abram S. Cassidy (Seal)
Margaret J. Cassidy (Seal)

County of Orange)
State of New York) s.s.
On this twenty second day of June
A. D. 1886, personally came before the undersigned Edwin J. - Skidmore and Emma D. Skidmore, his wife; and Abram S. Cassidy and Margaret J. Cassidy, his wife
to me well known, and acknowledged that they executed the foregoing certificate as their own free act and deed.
W. S. Cassidy
Notary Public
Orange County,
State of New York



We hereby certify to having surveyed and platted the within described property and have placed iron monuments at the corners of each and every block as shown hereon and the same is correct.
Hawley & Newell
Civil Engineers

County of Ramsey)
State of Minnesota) s.s.
On this 17th day of August
A. D. 1886, personally came before the undersigned W. J. Newell
to me well known, and acknowledged that he executed the foregoing certificate as his own free act and deed.
W. J. Newell
Notary
Ramsey County,
State of Minnesota

ACCEPTED AND APPROVED THIS
17th day of August
A. D. 1886
S. W. ...
J. P. ...
Plat Commissioners.

I hereby recommend the acceptance of the within plat by the Common Council.
S. W. ...
City Engineer.

Accepted and Approved by the Common Council of the City of St Paul, on the 7th day of August A. D. 1886
...
City Clerk.

Taxes paid Sept 13 1886 *av* *O'Brien*
County Auditor,
Ramsey Co. Minn.
Assessments
City Treasurer, St. Paul.