

This plat document is an UNOFFICIAL copy of a Subdivision Plat or Registered Land Survey and is made available for information purposes only.

To obtain an official copy please contact the Ramsey County Recorder's Office.



BORUP and PAYNE'S

Addition to

ST. PAUL.

Charles W. Borup } Proprietors.
 Rice H. Payne }
 Charles H. Cook

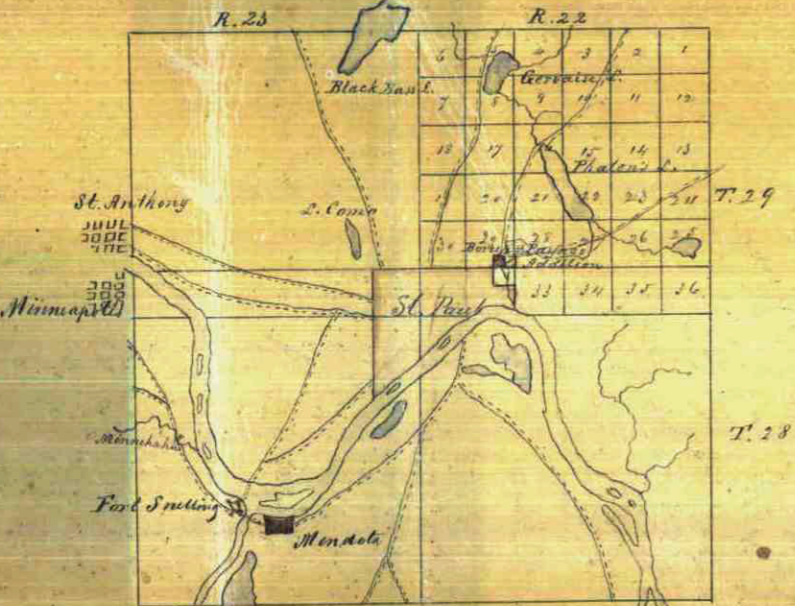
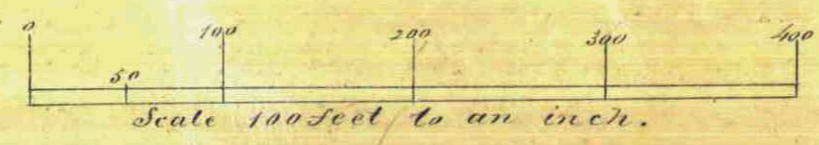

Territory of Minnesota
 Ramsey County

Before me the undersigned authority personally appeared Rice H. Payne one of the proprietors of "Borup and Payne's Addition to St. Paul" which is situated on and includes the south half of the south west quarter of the south east quarter of section 29, in Township No. 29 south and Range No. 22 West of the 5th principal Meridian and acknowledged the annexed plat of the survey thereof of the northern line (10) acres to be his act and deed for the purpose therein contained; and as a dedication of the streets marked thereon to the public use.

Taken and acknowledged before me
 This 5th day of June A.D. 1857.

J. Gay Kewee
 Notary Public
 Minnesota

J. Gay Kewee
 H. McKee

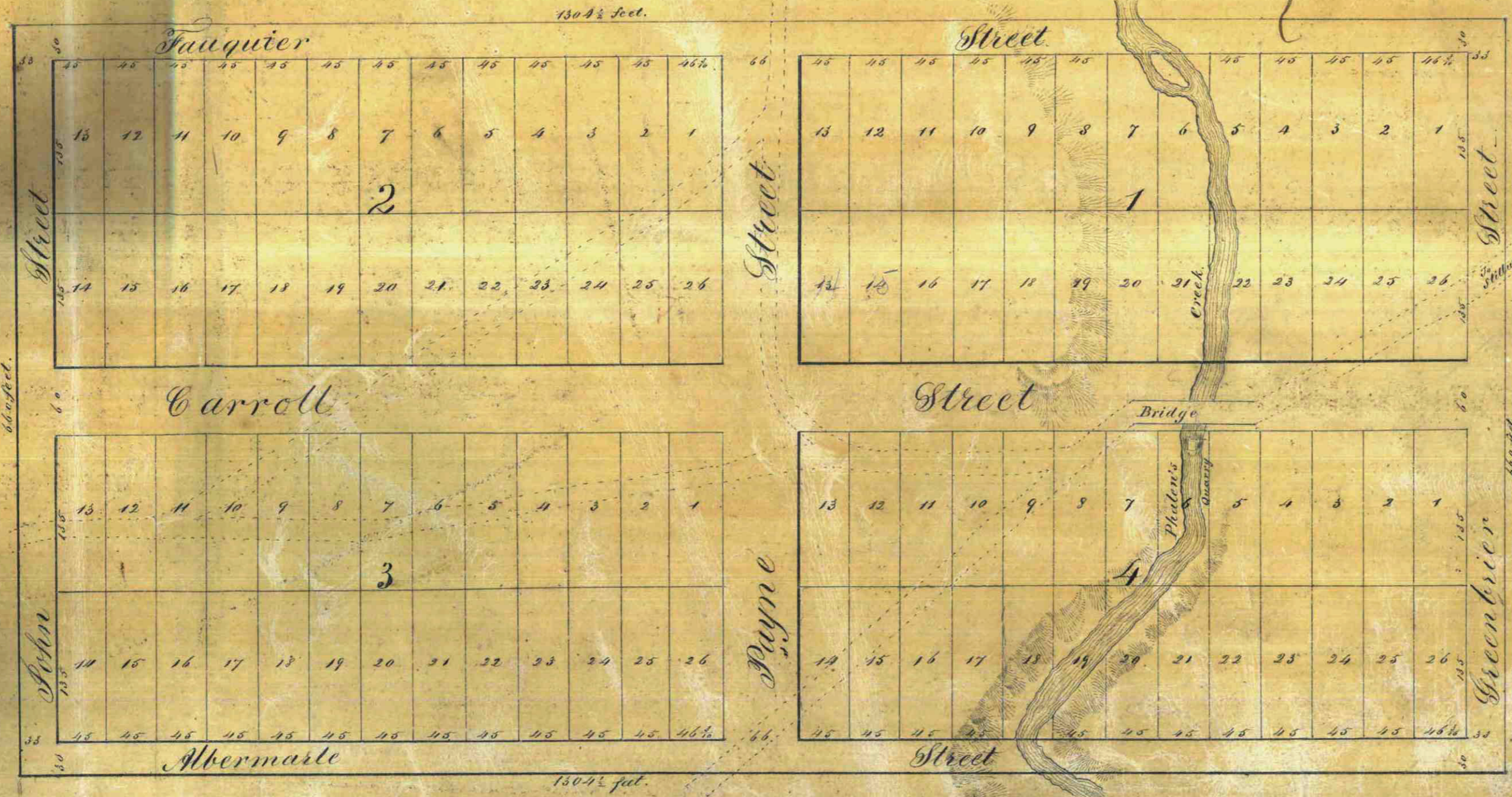

Territory of Minnesota
 Ramsey County

Before me the undersigned authority, personally appeared Charles W. Borup one of the proprietors of "Borup & Payne's Addition to St. Paul" which is situated on and includes the south half of the south west quarter of the south east quarter of section 29, in Township No. 29 south and Range No. 22 West of the 5th principal Meridian and acknowledged the annexed plat of the survey thereof of the southern line (10) acres to be his act and deed for the purpose therein contained; and as a dedication of the streets marked thereon to the public use.

Taken and acknowledged before me
 This 15 day of August A.D. 1857.

W. H. Belden
 Notary Public
 Minn.

I certify that this is a correct diagram of "Borup and Payne's Addition to St. Paul" surveyed by me June 1857.

St. Paul June 5th 1857. W. H. Belden
 Surveyor

Attest
 I, Charles H. Cook, one of the proprietors of the above described plat, do hereby certify that the same is a true and correct copy of the original plat as the same appears on file in the office of the Ramsey County Recorder.

Charles H. Cook
 Recorder

State of Minnesota
 On this 5th day of October A.D. 1869 I, the undersigned authority, personally appeared Charles H. Cook one of the proprietors of "Borup & Payne's Addition to St. Paul" which is situated on and includes the south half of the south west quarter of the south east quarter of section 29, in Township No. 29 south and Range No. 22 West of the 5th principal Meridian and acknowledged the annexed plat of the survey thereof of the southern line (10) acres to be his act and deed for the purpose therein contained; and as a dedication of the streets marked thereon to the public use.

Charles H. Cook
 Notary Public
 Minnesota