

12

MAP OF SCHEFFER'S

Addition to St. Paul.

This plat document is an UNOFFICIAL copy of a Subdivision Plat or Registered Land Survey and is made available for information purposes only.

To obtain an official copy please contact the Ramsey County Recorder's Office.

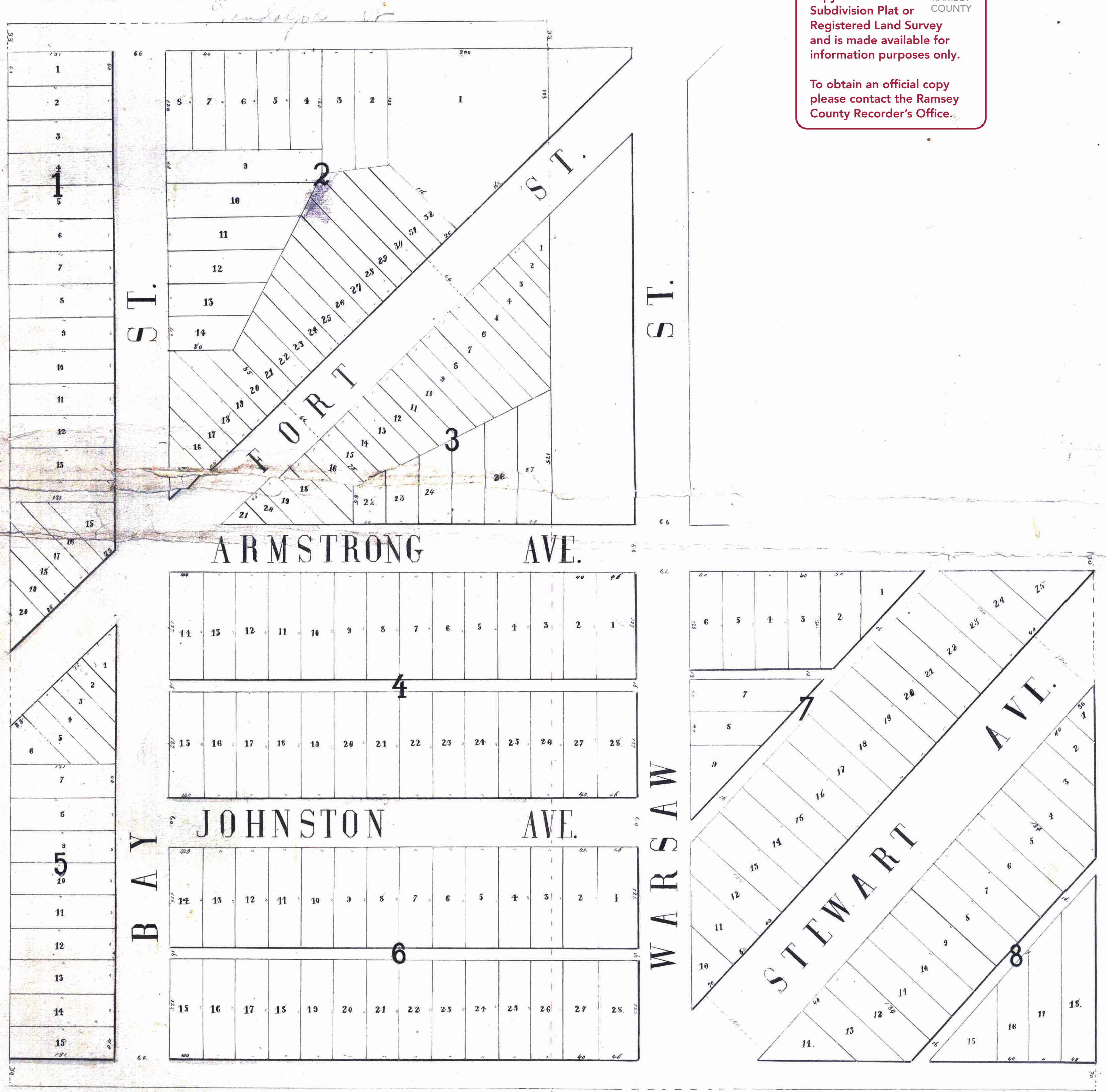

State of Minnesota }
 County of Ramsey } ss. We the undersigned, R. A. Smith, and Mary E. Smith his wife; W. Dawson and Mary S. Dawson his wife; and A. H. Merrick, and Anna L. Merrick his wife, proprietors of Scheffer's Addition to St. Paul, described as follows, to wit:
 The West 1/2 of the North East 1/4 of the South East 1/4, and the South East 1/4 of the North East 1/4 of the South East 1/4 of Section 11, Town 28, Range 25, containing 30 acres. Do hereby certify that we have caused the same to be surveyed and plotted, as per accompanying Diagram and we hereby give the streets therein for public use.

Witness
 Albert Scheffer
 W. Moore

Robert A. Smith
 Mary E. Smith
 William Dawson
 Mary S. Dawson
 A. H. Merrick
 Anna L. Merrick

County Auditor Office
 Ramsey Co. Minn.
 St. Paul Jan 11, 73
 Inces paid
 H. J. Gray to
 Co. Clerk

Official Register of Deeds of Ramsey Co. Minn.
 Rec'd for record on the 9th day of January A.D. 1873 at 2 o'clock P.M. & recorded in book No. of Town plat on page 12 - J. Manager Reg. of Deeds

State of Minnesota }
 County of Ramsey } ss.

I, Albert Scheffer, a Notary Public, within and for said County, do hereby certify that on this Seventh day of January A.D. 1873 personally came before me, Robert A. Smith, and Mary E. Smith, William Dawson, Mary S. Dawson, A. H. Merrick, and Anna L. Merrick, who are well known as the same persons described in and who executed the foregoing Instrument and they acknowledged that they executed the same freely & voluntarily. Albert Scheffer Notary Public Ramsey County, Minn.

I hereby certify that this is a correct diagram of Scheffer's Addition to St. Paul, described as follows, to wit: The West 1/2 of the North East 1/4 of the South East 1/4, and the South East 1/4 of the North East 1/4 of the South East 1/4 of Section 11, Town 28, Range 25, containing 30 acres.

St. Paul Minn.
 Jan. 11, 1873.

Chas. M. Boyle
 Surveyor

I certify that the streets as shown upon the foregoing Plat conform with the streets in adjoining Additions
 St. Paul Minn Jan 7, 1873
 C. S. Kuetzing
 City Surveyor

I Certify that this plat of Scheffer's Addition was adopted by the Common Council on the 7th day of January, 1873. Witness my hand and the Official Seal of the City of St. Paul this 8th day of January 1873
 W. J. Connor
 City Clerk