

LOCATION MAP

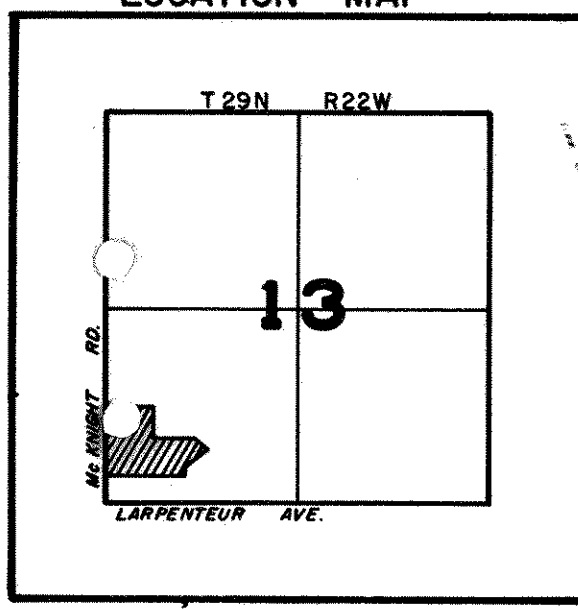

# MAPLE WOODS TOWNHOUSES

KNOW ALL MEN BY THESE PRESENTS: that Maplewood Properties, Inc., a Minnesota corporation, owner and proprietor, and the First National Bank of St. Paul, a United States corporation, mortgagee, of the following described property, situated in the County of Ramsey and State of Minnesota, to-wit:

All that part of the S 1/2 of the SW 1/4, Section 13, Township 29, Range 22, described as follows:

Beginning at a point in the west line of said S 1/2 distant 422.00 feet north of the SW corner thereof; thence N 0° 22' 40" E, (assumed basis for bearings) along said west line 848.00 feet; thence N 88° 39' 38" E, 310.00 feet; thence S 0° 22' 40" W, 487.02 feet; thence S 89° 37' 20" E, 501.93 feet; thence S 44° 54' 59" E, 121.76 feet; thence S 50° 02' 40" W, 312.59 feet; thence S 0° 22' 40" W, along the east line of the west 660.00 feet of said S 1/2 of the SW 1/4, a distance of 63.00 feet; thence S 88° 42' W, parallel with the south line of said SW 1/4, a distance of 660.29 feet to the point of beginning.

have caused the same to be surveyed and platted as MAPLE WOODS TOWNHOUSES and do hereby donate and dedicate to the public, for public use forever, the Road Easement as shown on the plat. In witness whereof, Maplewood Properties, Inc. has caused these presents to be signed by its proper officers this 13th day of September A.D., 1972, and the First National Bank of St. Paul has caused these presents to be signed by its proper officers and its corporate seal to be hereunto affixed this 13th day of September A.D., 1972.

IN PRESENCE OF:

	and		<u>Maplewood Properties, Inc.</u> Charles A. Cox, President
	and		Thomas R. King, Secretary
	and		<u>The First National Bank of St. Paul</u> C. G. Frame, Executive Vice-President
	and		J. T. Pearson, Comm. Loan Officer

STATE OF MINNESOTA }  
COUNTY OF Hennepin }  
On this 13th day of September A.D., 1972, before me, a Notary Public, within and for said County and State personally appeared Charles A. Cox and Thomas R. King, who being each by me duly sworn did say that they are respectively the President and Secretary of Maplewood Properties, Inc., the Corporation named in the foregoing instrument, and that said Corporation does not have a Corporate Seal; and that said instrument was signed in behalf of said Corporation by authority of its Board of Directors and said Charles A. Cox and Thomas R. King, acknowledge said instrument to be the free act and deed of said Corporation.

Linda L. Hiller \_\_\_\_\_  
Notary Public  
My Commission Expires: December 13, 1978  
Hennepin County, Minnesota

STATE OF MINNESOTA }  
COUNTY OF Ramsey }  
On this 3rd day of October A.D., 1972, before Me, a Notary Public, within and for said County and State personally appeared C. G. Frame and J. T. Pearson who being each by me duly sworn, did say that they are respectively the Executive Vice-President and Commercial Loan Officer of The First National Bank of St. Paul, a United States Corporation named in the foregoing instrument; that the seal affixed to said instrument is the Seal of said Corporation; and that said instrument was signed and sealed in behalf of said Corporation by authority of its Board of Directors and said C. G. Frame and J. T. Pearson, acknowledge said instrument to be the free act and deed of said Corporation.

Gail M. Spence \_\_\_\_\_  
Notary Public  
My Commission Expires: May 11, 1976  
Anoka County, Minnesota

I, James E. Boerhave, hereby certify that I have surveyed and platted the property described on this plat as MAPLE WOODS TOWNHOUSES that this plat is a correct representation of said survey; that all distances are correctly shown on the plat in feet and decimals of a foot; all monuments have been correctly placed in the ground as shown on the plat; that the outside boundary lines are correctly designated on the plat; and that there are no wet lands, public highways, or easements on or across said plat other than as shown hereon.

James E. Boerhave \_\_\_\_\_  
Surveyor - Minnesota Registration No. 7095

STATE OF MINNESOTA }  
COUNTY OF Hennepin }  
Surveyor's certificate subscribed and sworn to before Me, a Notary Public, this 11th day of SEPTEMBER A.D., 1972.

Lawrence J. Gardner \_\_\_\_\_  
Notary Public  
My Commission Expires: SEPT. 10, 1975  
Hennepin County, Minnesota

We hereby certify that this plat was accepted and approved by the Ramsey County Plat Commission this 26th day of October A.D., 1972.

Accepted and approved by the Village of Maplewood this 19th day of October A.D., 1972.

Plat Commission  
Raymond W. Ryan  
Walter A. Hurstley

City Engineer of St. Paul  
Richard B. Olson

James E. Boerhave  
Mayor

Attest: Louise E. Mueller  
Village Clerk



Abstract # 1840323

Label Martha

RECORDED OCT. 27, 1972