

ANNA E. RAMSEY'S ADDITION

CITY OF ST. PAUL

Scale: 1/4" = 100 ft.

Surveyed & Drawn by
ELMER AND NEWELL
Civil Engineers

This plat document is an UNOFFICIAL copy of a Subdivision Plat or Registered Land Survey and is made available for information purposes only.



To obtain an official copy please contact the Ramsey County Recorder's Office.

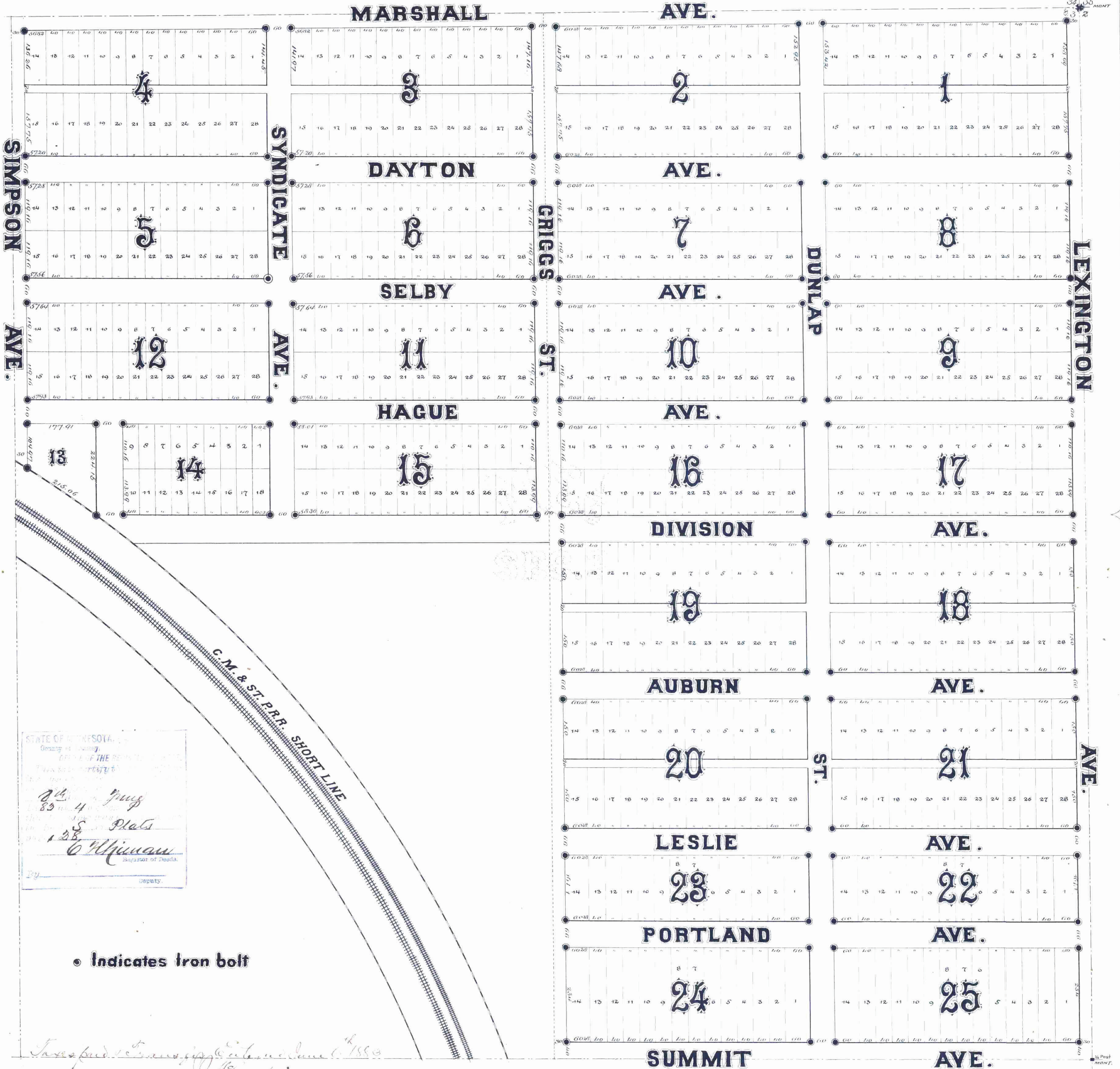

STATE OF MINNESOTA
County of Ramsey
City of St. Paul
I, *John J. [Signature]*
Deputy
do hereby certify that the above is a true and correct copy of the original plat as filed in my office on the 4th day of May, 1883.

● Indicates iron bolt

We hereby certify that we have surveyed and platted the within described property and have placed iron monuments as required by law; and that the same is correct.
Elmer & Newell
Civil Engineers

In Presence of
James H. Lightner
William H. Lightner
County of Ramsey
State of Minnesota

Anna E. Ramsey
Mr. Ramsey

Approved
St. Paul, day of May A.D. 1883

Approved by the City Council of the City of St. Paul

City Clerk

In this 18th day of May A.D. 1883, personally appeared before me *Anna E. Ramsey* and *William H. Lightner*, both of whom are known to be the identical persons who executed the foregoing certificate, and acknowledged that they executed the same as their free act and deed. Witness my hand and seal of office this 18th day of May, 1883.

William H. Lightner
Notary Public
Ramsey Co.

Examined & Approved
St. Paul, day of May A.D. 1883

City Engineer

28