

"MILTON" ADDITION
 Go Che
CITY OF ST. PAUL
 SURVEYED AND DRAWN BY
 CHAS. A. FORBES, C.E.
 FOR
ANNICE G. BARTEAU.

This plat document is an UNOFFICIAL copy of a Subdivision Plat or Registered Land Survey and is made available for information purposes only.

To obtain an official copy please contact the Ramsey County Recorder's Office.

STATE OF MINNESOTA, } ss.
 County of Ramsey,
 OFFICE OF THE REGISTER OF DEEDS.
 This is to certify that the within instrument was filed for Record in this office, at St. Paul, on the 20th day of June, A. D. 1885, at 2 o'clock P. M., and that the same was duly recorded in Book X of Plats, pages 28.

R. A. Riley
 Register of Deeds
 Deputy

I hereby certify to having surveyed and platted the property as described on this map as "Milton Addition" and have placed iron monuments at the corner of each and every block as shown on this map and the same is correct.

Chas. A. Forbes
 SURVEYOR

STATE OF MINNESOTA } On this 29th day of May, AD 1885 personally came before me the undersigned *Charles A. Forbes* Notary Public, County of Ramsey, to me well known and acknowledged that he executed the foregoing certificate as his own free act and deed.

William Barrett
 NOTARY PUBLIC
 RAMSEY CO. MINN.

This is to certify that *William L. Barteau* and *Annice G. Barteau* are the proprietors of the following described property being the E 1/2 of NE 1/4 of S 1/2 of Sec 35 T 29 N Range 23 bounded by following streets: University N. Victoria E. St. Anthony S. Milton W. and have caused the same to be surveyed and platted and hereafter known as "MILTON ADDITION" as shown by this plat and hereby dedicate to the public forever all the streets parks and alleys and boulevards as herein indicated - witness our hands and seals, this 29th day of May, 1885.

In Presence of
Richard Loffmann
William Barrett

William L. Barteau
Annice G. Barteau
 by *Josiah Fairchild*
 his Attorney in fact

STATE OF MINNESOTA } On this 29th day of May, AD 1885 personally came before me the undersigned, *William L. Barteau* and *Annice G. Barteau* by his attorney, *Josiah Fairchild*, to me well known and acknowledged that they executed the foregoing certificate for the uses and purposes therein expressed.

William Barrett
 NOTARY PUBLIC
 RAMSEY CO. MINN.

Accepted and approved this 1st day of June, AD 1885

S. P. Holson
James Starkey
Wm A. Van Slyke
 PLAT Commissioners

S. P. Holson
James Starkey
Wm A. Van Slyke
 PLAT Commission

We hereby certify that this plat or map is a true and correct copy of an original plat or map of above described property this day accepted and approved by this Commission.

Dated June 1st 1885.

They recommend the acceptance of the within plat by the Common Council
 Dated June 7, 1885

Accepted by the common council of the City of St Paul on the 16 day of June 1885

L. W. Rundlett
 City Engineer

Anna A. Drewesack
 City Clerk

Taxes _____

Assessments _____

County Auditor
 Ramsey Co. Minn

City Treasurer
 St Paul

CITY TREASURER'S OFFICE
 ST. PAUL, MINN.
 JUN. 20 1885
 ASSESSMENTS PAID
Chas. A. Forbes
 CITY TREASURER

1884 TAX PAID
W. E. Burton
 County Treasurer

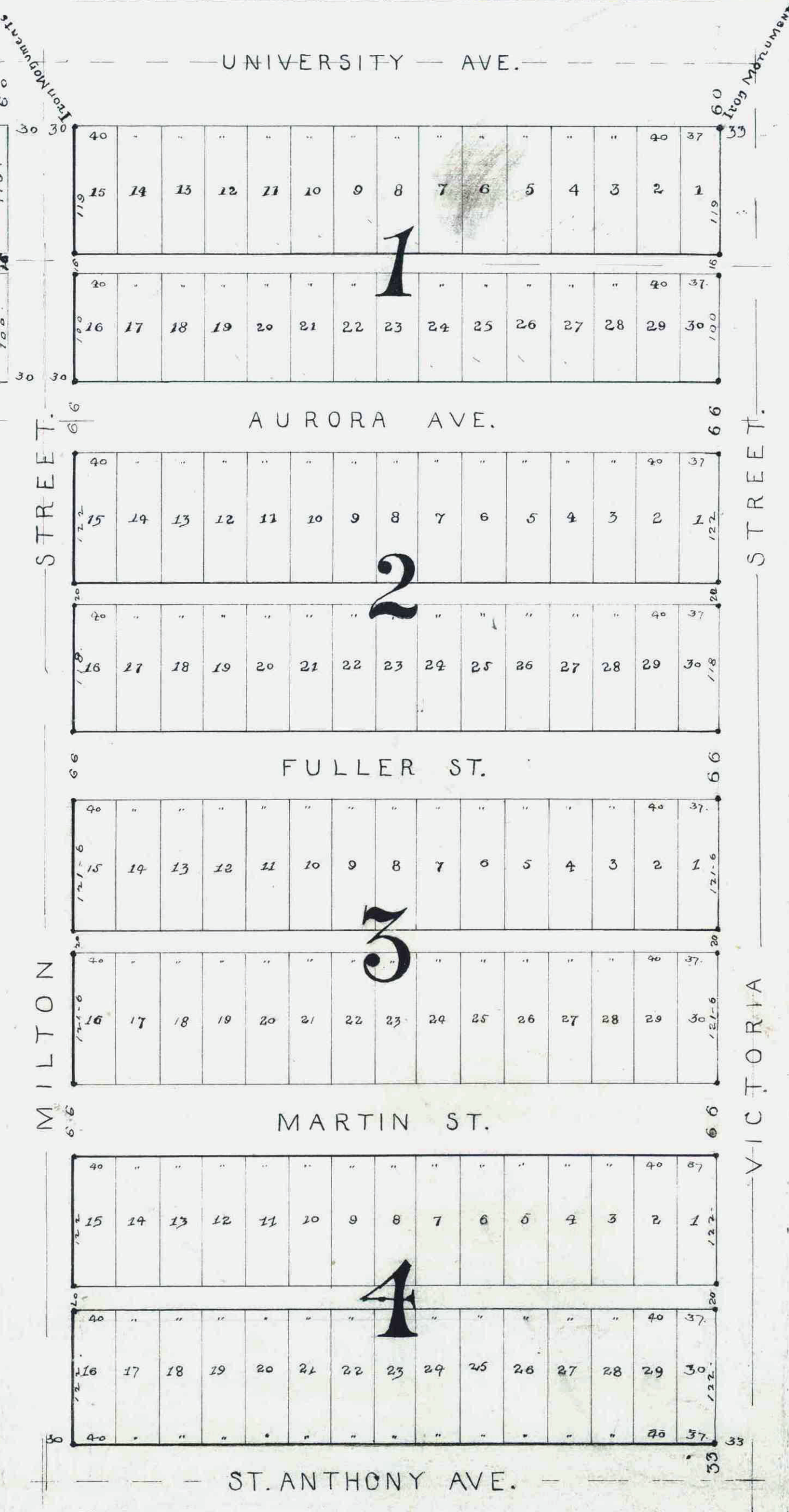

June 10th 1885
 Taxes paid and transfer returned
James O. Drury
 County Auditor
Per J. D. Dingsley
 Deputy