

METCALF AND WILDERS

This plat document is an UNOFFICIAL copy of a Subdivision Plat or Registered Land Survey and is made available for information purposes only.

To obtain an official copy please contact the Ramsey County Recorder's Office.



SUBDIVISION OF LOTS 24 AND 25 OF BLOCK 68 OF DAYTON AND IRVINE'S ADDITION TO ST PAUL

State of Minnesota }
 County of Ramsey } I hereby certify that this plat of Metcalf and Wilder's Subdivision of Lots 24 & 25 of Block 68 of Dayton & Irvine's Addition to Saint Paul Minnesota is made from an accurate survey by me, and correctly represents the dimensions of the Streets and Lots, said Addition is located on the North East quarter of Section one of Township 28 North, of Range 23 West in Ramsey County Minnesota.

John T. Halsted
 Civ. Eng'r

I, Amherst H. Wilder, the proprietor of Metcalf and Wilder's Subdivision of Lots 24 & 25 of Block 68 of Dayton & Irvine's Addition to Saint Paul in Ramsey County, do hereby certify that I have caused the same to be surveyed & subdivided into Lots, numbered respectively, 1, 2, 3, 4, 5 & 6 as indicated in the subjoined diagram, for the purpose of having the same recorded according to law.

Dated Saint Paul, October 24, 1870

Amherst H. Wilder

State of Minnesota }
 County of Ramsey } On this 24th day of October A.D. 1870, before me personally came Amherst H. Wilder to me known to be the same person who executed the certificate, and he acknowledged that he executed the same for the use & purpose therein stated.

Edwin J. Christensen
 Notary Public
 Ramsey County
 Minnesota

Office of Reg. of Deeds }
 Ramsey Co. Minnesota } I hereby certify that the subjoined plat was filed in this office on the 25th day of October A.D. 1870 at 2 o'clock, and duly recorded in Book 17 of Town Plats on page 25.

Register of Deeds
 Scale 1 inch = 30 ft.

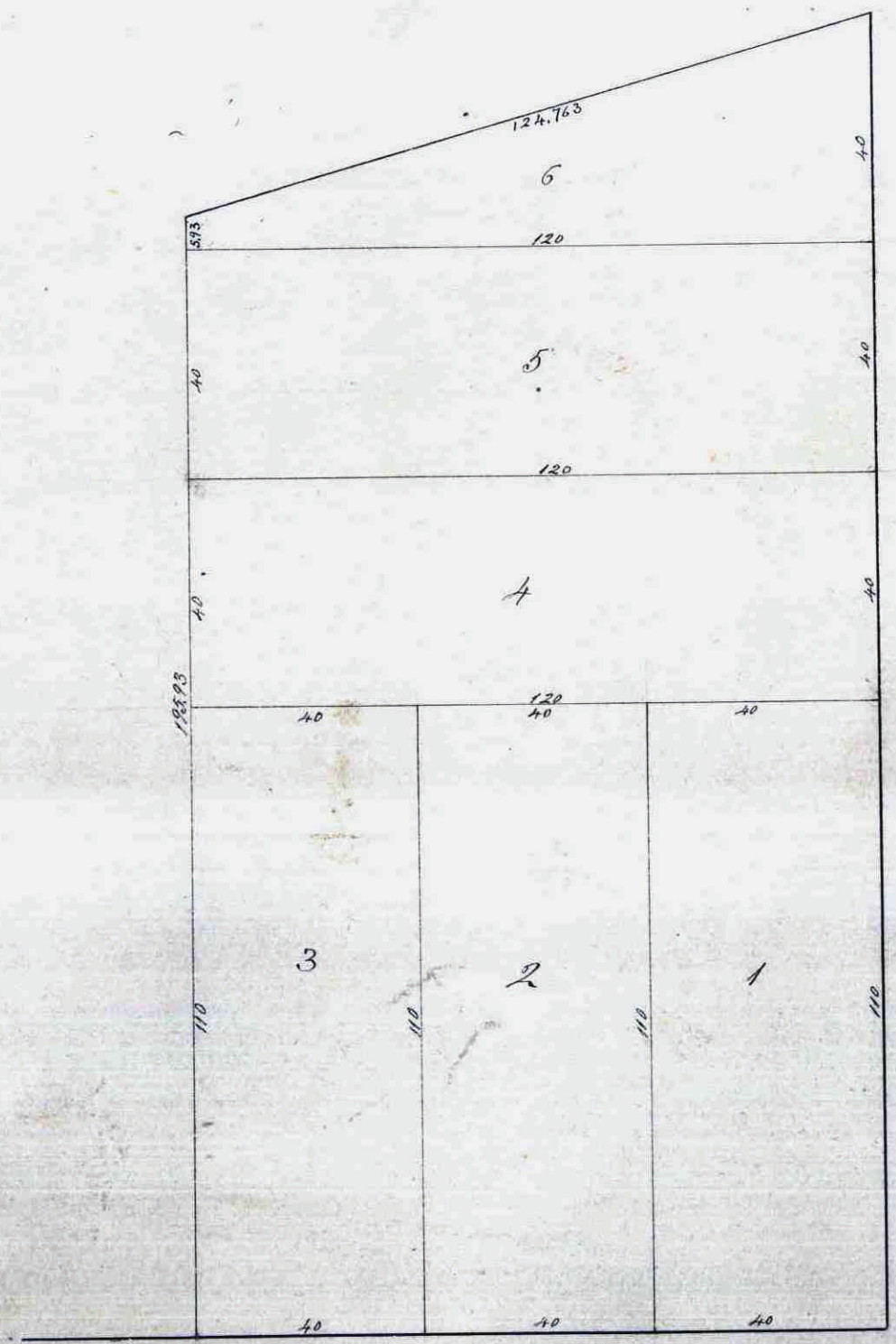

FORBES ST

RAMSEY ST