

16

# LAKE PARK ADDITION SAINT PAUL SECOND DIVISION.

STATE OF MINNESOTA, ss.  
County of Ramsey }  
OFFICE OF THE REGISTER OF DEEDS.  
This is to certify that the within  
instrument was filed for Record  
in my office, at St. Paul, on the  
18th day of April, A.D. 1885,  
1885, at a clock, P.M., and  
that the same was duly recorded  
in Book V of 27 etc.

This plat document  
is an UNOFFICIAL  
copy of a  
Subdivision Plat or  
Registered Land Survey  
and is made available for  
information purposes only.

RAMSEY  
COUNTY

To obtain an official copy  
please contact the Ramsey  
County Recorder's Office.

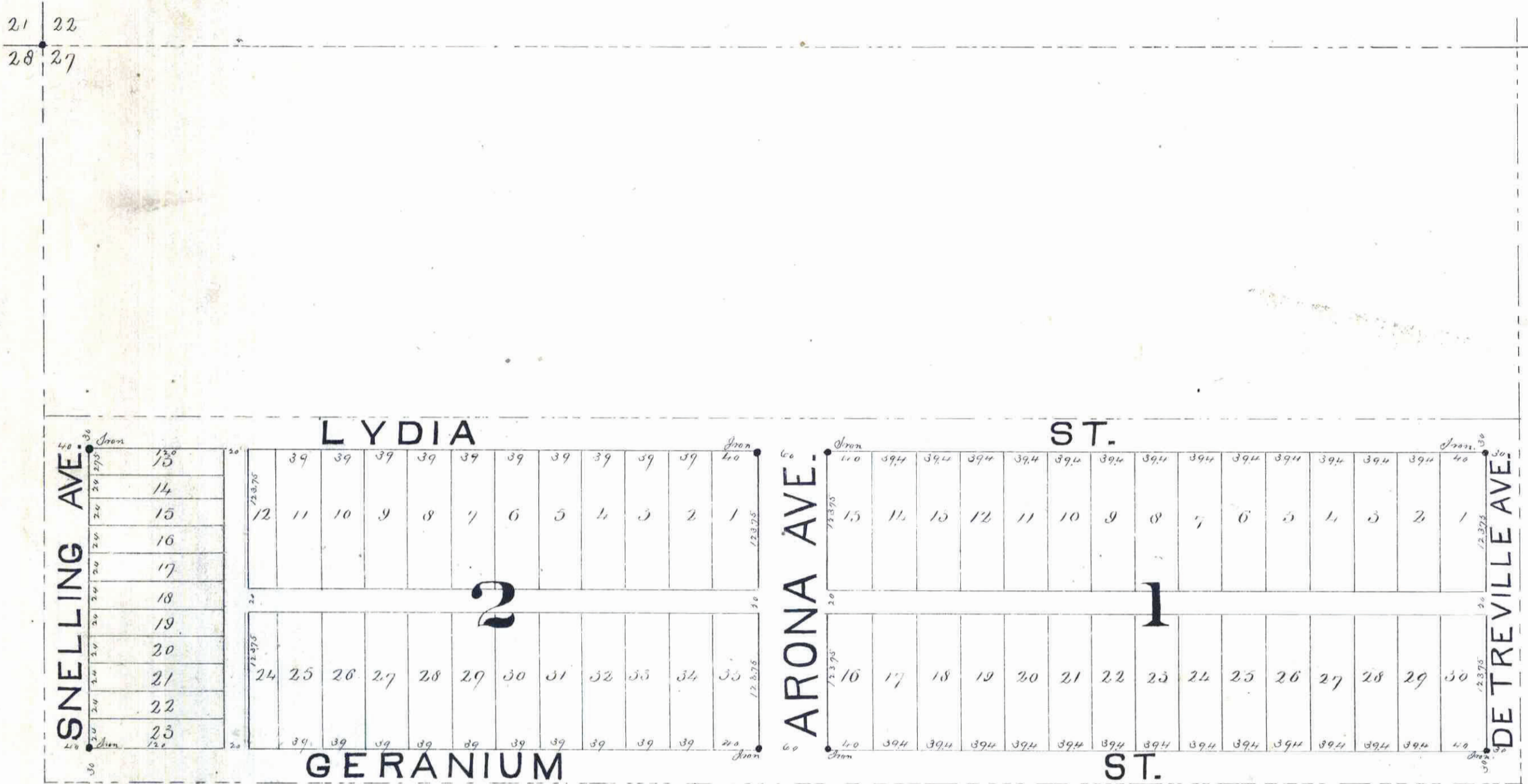

I certify that I have surveyed the South 1/2 of the North 1/2 of the North West 1/4 of the North West 1/4 of section 27 Township 29 Range 23 West. and have placed iron monuments at the corners of each and every Block as shown on this plat that this is a correct plat of said Survey.

J. B. Rowley,  
Surveyor.

State of Minnesota }  
County of Ramsey }  
On the 18 day of April 1885 personally appeared before me J. B. Rowley to me well known to be the identical person who surveyed the above described piece of land and executed the above certificate and acknowledged said certificate to be correct and his free act and deed.

W. B. Bourne Notary Public

Approved by the Plat Commission on the 19 day of May 1885

S. J. Folsom } Plat Commission  
Wm. A. Lamberton }  
J. A. Key }

Accepted by the Common Council on the 19 day of May 1885

City Clerk.

Examined and approved on the 19 day of May 1885

City Engineer.

We the undersigned owners of the South 1/2 of the North 1/2 of the North West 1/4 of the North West 1/4 of section 27 Township 29 Range 23 West. hereby certify that we have caused the same to be surveyed and platted as Lake Park Addition to Saint Paul Second Division and we hereby dedicate to the public and for the public use forever the streets and alleys as on this plat laid out and indicated. In witness whereof we have placed our hands and seals on the 18 day of April 1885.

In the presence of

Saml M. Murrant }  
W. B. Bourne }  
J. Royall M. Murrant }  
Edward S. Libby (Mortgage) }

Taxes paid and taxes for interest  
Sept 9 1885  
Jas. E. Burton  
City Treasurer

CITY TREASURER'S OFFICE  
ST. PAUL, MINN.  
SEP 9 1885  
ASSESSMENTS PAID  
Jas. E. Burton  
CITY TREAS.  
1884 TAX PAID  
W. E. Burton  
County Treasurer.

State of Minnesota }  
County of Ramsey }  
On the 18 day of April 1885 personally appeared before me Lawrence S. Washington and J. Royall M. Murrant to me well known to be the identical persons who executed the above certificate and acknowledged the same to be their free act and deed.

W. B. Bourne, Notary Public

State of Minnesota }  
County of Ramsey }  
On this 28 day of April A.D. 1885 personally appeared before me Edward G. Libby, to me well known to be the identical person who executed the above certificate of ownership and dedication and acknowledged that he executed the same for the uses and purposes therein expressed and as his own free act and deed.

James Starkey  
Notary Public  
Ramsey County,  
Minnesota.