

# CHESTER PARK

Scale 1' to 100'

Edward R. Schafer  
Surveyor

408886 520

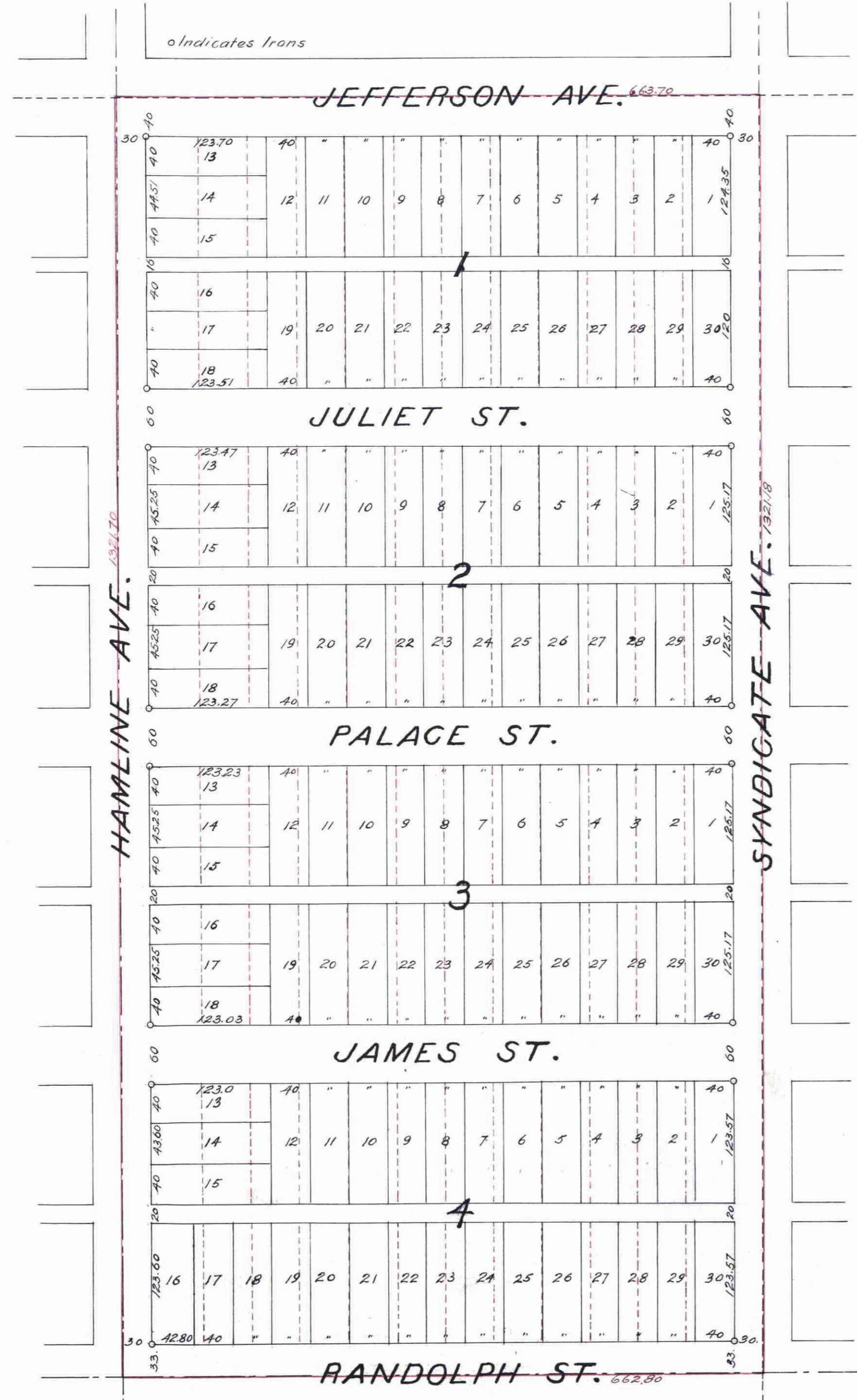

I hereby certify to having surveyed and platted the property as described on this map as CHESTER PARK, and have placed iron monuments at the corners of each and every block as shown on this map, and the same is correct.

Edward R. Schafer  
Surveyor

State of Minnesota }  
County of Ramsey } ss.  
On this 29 day of May, A.D. 1911, before me personally appeared Edward R. Schafer, to me known to be the person described in and who executed the foregoing certificate, and acknowledged that he executed the same as his free act and deed.

Delas C. Foreman  
Notary Public, Ramsey County, Minn.  
My commission expires January 27, 1914

This is to certify that James S. Simonton and Jane Le Mayne Simonton, his wife, and Sarah K. Simonton, a widow, proprietors of Lexington Park Plat N° 9, have caused the same to be surveyed and platted, and hereafter known as CHESTER PARK, as shown on this map, and hereby dedicate to the public, and for the public use forever, all the streets, avenues and alleys hereon indicated.

Witness our hands and seals this 6th day of June A.D. 1911

In presence of James S. Simonton  
Jane LeMayne Simonton  
Sarah K. Simonton  
L. F. Kirchner  
Eleanor B. Mitchell  
Paul A. Kunkel  
as to Sarah K. Simonton

State of Pennsylvania }  
County of Washington } ss.  
On this 6th day of June A.D. 1911, before me personally appeared James S. Simonton and Jane Le Mayne Simonton, his wife, to me known to be the persons described in and who executed the foregoing instrument, and acknowledged that they executed the same as their free act and deed.

Eleanor B. Mitchell  
Notary Public, Washington County, Penn.  
My commission expires January 18th, 1913.

State of Pennsylvania }  
County of Dauphin } ss.  
On this 8th day of June A.D. 1911, before me personally appeared Sarah K. Simonton, a widow, to me known to be the person described in and who executed the foregoing instrument, and acknowledged that she executed the same as her free act and deed.

Paul A. Kunkel  
Notary Public, Dauphin County, Penn.  
My commission expires  
January 25, 1915.

Accepted and approved this 26th day of June A.D. 1911

Jordan  
Harvey } Plat Commissioners  
O. Clausen City Engineer

Accepted by the Assembly July 6 1911  
" " " Board of Aldermen July 5 1911  
Approved July 14 1911  
Geo. J. Redington  
City Clerk

We hereby certify that this plat or map is a true and correct copy of an original plat or map of Chester Park this day accepted and approved June 26 1911

Jordan  
Harvey } Plat Commissioners  
O. Clausen City Engineer

STATE OF MINNESOTA }  
County of Ramsey } ss.  
Office of the Register of Deeds.  
This is to certify that the within instrument was filed for record in my office at St. Paul, on the 20th day of July A. D. 1911, at 2:00 P.M., and that the same was duly reported in Book 28 of Deeds, Page 13

Register of Deeds.  
Deputy.

4088936

CITY TREASURER'S OFFICE,  
ST. PAUL, MINN.  
JUL 20 1911  
Assessment PAID  
S. A. PARKWORTH, City Treas.  
P. C. Schneider

Taxes for the year 1910 on the lands described within PAID  
JUL 20 1911  
ST. PAUL, MINN.  
JESSE J. GUEN, County Treasurer,  
For J. Panger

TAXES PAID  
AND TRANSFER ENTERED  
JUL 20 1911  
GEO. J. BIES, County Auditor.  
By [Signature] Deputy.

This plat document is an UNOFFICIAL copy of a Subdivision Plat or Registered Land Survey and is made available for information purposes only.

RAMSEY COUNTY

To obtain an official copy please contact the Ramsey County Recorder's Office.