

WIFELBURG HILLS

ST. PAUL.—MINN.

SCALE, 100 FT. PER. INCH.

JOHN B. IRVINE, SURVEYOR.

Irons at all lot & block corners.

390538

State of Pennsylvania, } On this tenth day of
 County of Washington } January A.D. 1909-1910,
 before me the undersigned personally came
 Morgan and Carrie F. Morgan, as
 Administratrix of the Estate of
 David T. Morgan, and acknowledged
 that they executed the foregoing certificate
 as their own free act and deed.

Eleanore B. Mitchell
 Notary Public
 My Commission Expires, Washington County, Pennsylvania
 January 18th, 1913

We the undersigned owners and holders of a
 certain mortgage on the property described
 on this plat, do hereby assign to the platting
 of said property by A. Martinson
 Witness our hands and seals this tenth day of
 January A.D. 1909-1910.
 In presence of } Thomas Morgan
 A. W. Smith } Carrie B. Wilson
 Eleanore B. Mitchell }

as Administratrix of the
 Estate of David T. Morgan,
 deceased.

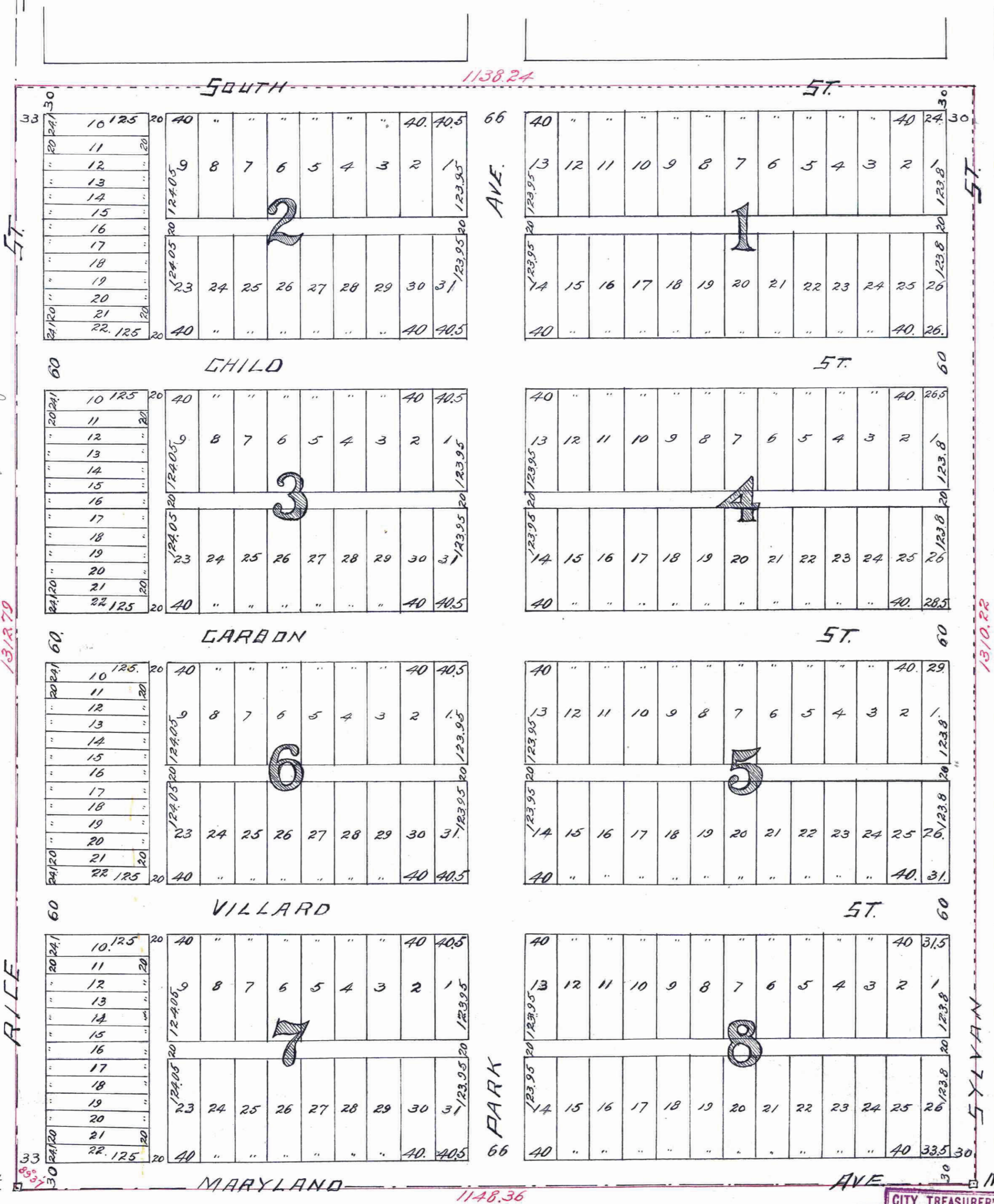

I hereby certify to having surveyed and platted the property as described
 on this map as Wifelburg Hills and have placed iron monuments at the
 corners of each and every lot and the same is correct.

John B. Irvine, Surveyor.

State of Minnesota } On this 6th day of December A.D. 1909,
 County of Ramsey } personally appeared before me the undersigned
 John B. Irvine, to me well known and acknowledged that he executed the
 foregoing certificate as his own free act and deed.

Jos. J. Guadagnoli
 Notary Public.

My Commission Expires May 19th 1911.

Ramsey Co. Minn.

This is to certify that A. Martinson unmarried is the
 owner of the Southwest quarter of the Southwest quarter of Section
 Nineteen (19) Town Twenty-nine (29) Range Twenty-two (22) has caused the
 same to be surveyed and platted and here after known as Wifelburg Hills
 as shown by this plat and hereby dedicates to the public and for the public use
 forever, all the streets, avenues and alleys as herein indicated.
 Witness her hand and seal this 17th day of May A.D. 1910.

In presence of
 Eliza Evans,
 J. R. Child

A. Martinson

State of Minnesota } On this 17th day of May A.D. 1910,
 County of Hennepin } personally came before me the undersigned
 A. Martinson unmarried, to me well known and
 acknowledged that she executed the foregoing certificate as her own
 free act and deed.

Eliza Evans,
 Notary Public.

My Commission Expires May 11th 1916.

Hennepin Co. Minn.

Accepted and Approved this Fourth day of June A.D. 1910.

J. Aman } Plat Commission.
 Jas. V. Jordan }
 L. W. Sanders } City Engineer.

Accepted by the Board of Aldermen June 7 - A.D. 1910.
 Accepted by the Assembly June 9 - A.D. 1910.

Approved June 11 - 1910

Geo. L. Redington
 City Clerk.

390538
 952
 STATE OF MINNESOTA,
 County of Ramsey, Minn.
 Office of the Registrar of Deeds.
 This is to certify that the within instrument
 was filed for record in my office on the 16th day of June
 A. D. 1910 at 10:40 A.M. and that the
 same were duly recorded in Book 26
 of said County Deeds at page 20
 By _____
 Registrar

CITY TREASURER'S OFFICE,
 ST. PAUL, MINN.
 JUN 16 1910
 Assessment PAID
 S. A. FANSWORTH, City Treas.

Taxes for the year 1909 on the
 lands described within paid.
 JUN 15 1910
 S. A. FANSWORTH, City Treas.

TAXES PAID
 AND TRANSFER ENTERED
 JUN 15 1910
 EDW. G. KRANER, Co. Auditor,
 Ramsey County

This plat document
 is an UNOFFICIAL
 copy of a
 Subdivision Plat or
 Registered Land Survey
 and is made available for
 information purposes only.
 To obtain an official copy
 please contact the Ramsey
 County Recorder's Office.