

# ROBLYN PARK ADDITION

St. Paul Minn.

137606

Scale 100. Feet per inch.

J.H. Armstrong Surveyor.

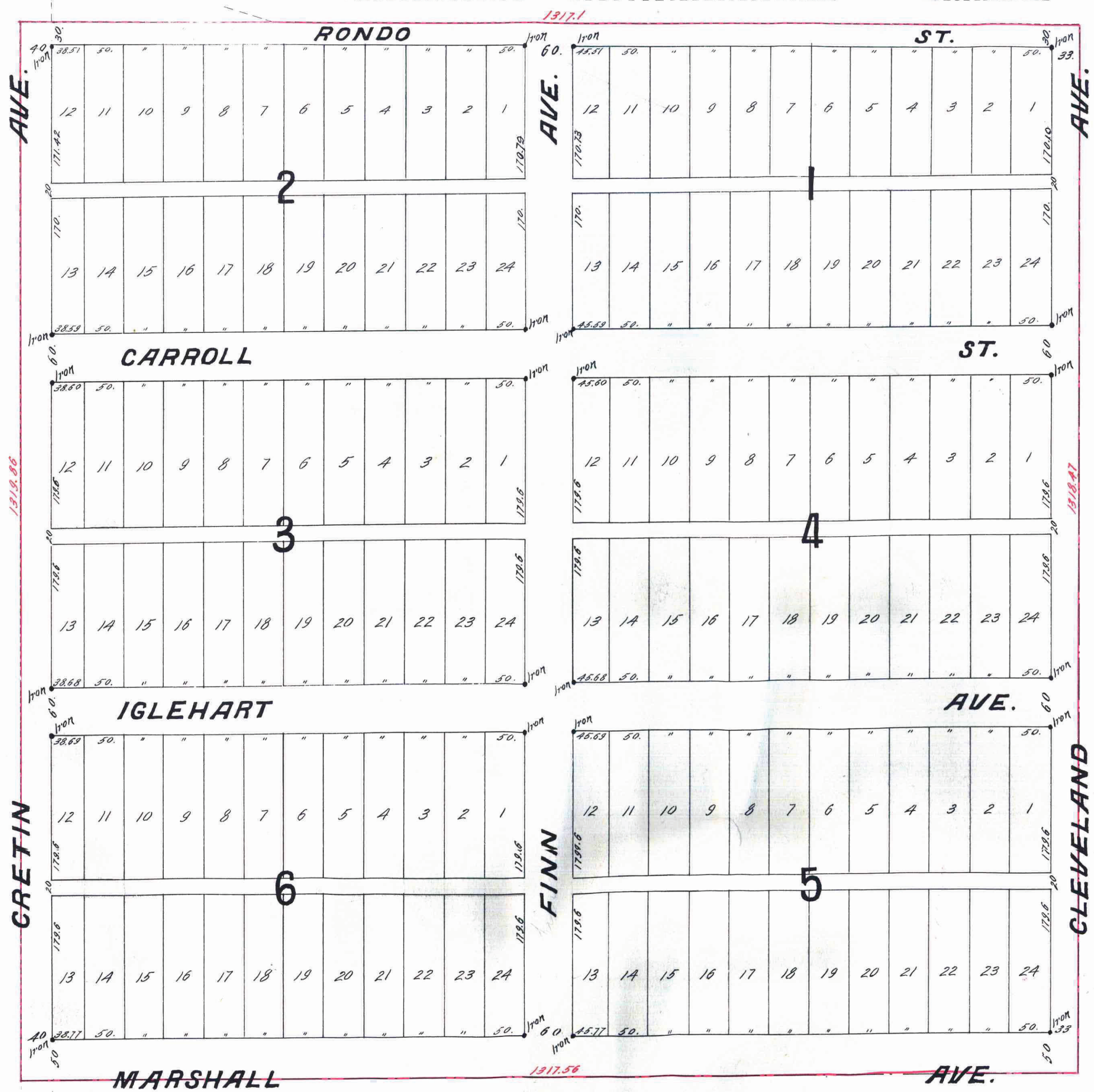

I, hereby certify to having surveyed and platted the property as described on this map as Roblyn Park Addition, St. Paul Minn., and have placed monuments at the corners of each and every block as shown on this map, and the same is correct.

J.H. Armstrong  
Surveyor

State of Minnesota }  
County of Ramsey } On this 13<sup>th</sup> day of February, A.D. 1907, personally appeared before me the undersigned, J.H. Armstrong, to me well known, and acknowledged that he executed the foregoing certificate as his own free act and deed.

Frederick B. Lynch  
Notary Public  
Ramsey Co., Minn.

This is to certify that, Frederick B. Lynch and Isabel C. Lynch his wife proprietors of, The S.E. 1/4 of the S.E. 1/4 of Sec. 32, T. 29, R. 23, have caused the same to be surveyed and platted, and hereafter known as, Roblyn Park Addition, St. Paul, Minn. as shown by this plat and hereby dedicate to the public, and for the public use forever, all the streets, avenues and alleys as herein indicated.

Witness our hands and seals this 13<sup>th</sup> day of February 1907.

In presence of  
G. De Laurent  
D. J. F. Adams

Frederick B. Lynch  
Isabel C. Lynch

State of Minnesota }  
County of Ramsey } On this 13<sup>th</sup> day of February, A.D. 1907, personally came before me, the undersigned, Frederick B. Lynch and Isabel C. Lynch his wife, to me well known, and they each acknowledged that they executed the foregoing certificate as their own free act and deed.

G. De Laurent  
Notary Public  
NOTARY PUBLIC, RAMSEY COUNTY, MINN.  
My Commission Expires August 18th 1914 Ramsey Co. Minn.

Accepted and approved this 18<sup>th</sup> day of February A.D. 1907.

J. Aman  
J. J. Jordan } Plat  
City Engineer } Commissioners.

Accepted by the Assembly, Feb 21 - 1907  
Accepted by the board of Aldermen, Feb 19/1907

Approved, Feb 26 - 1907  
City Clerk

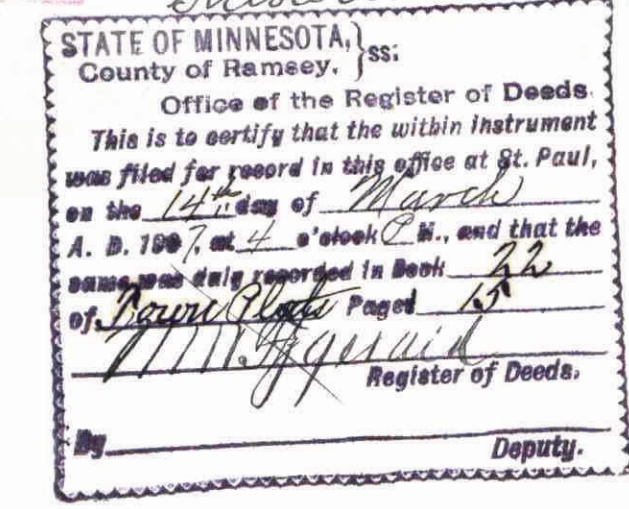
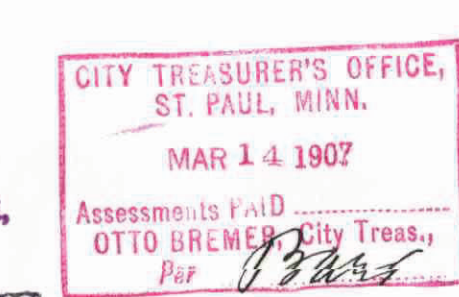
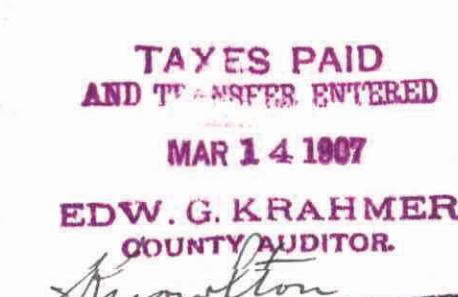
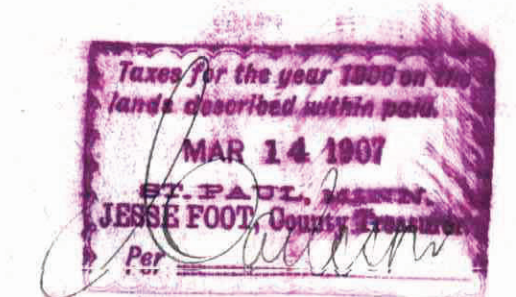

This plat document is an UNOFFICIAL copy of a Subdivision Plat or Registered Land Survey and is made available for information purposes only.

To obtain an official copy please contact the Ramsey County Recorder's Office.