

SCHWABE'S REAR^t OF LOTS 1 TO 24 BLK. 4. LAKE VIEW ADD. N^o 1 TO ST. PAUL.

SCALE 60' = 1"
• indicates Iron Monuments.

This plat document is an UNOFFICIAL copy of a Subdivision Plat or Registered Land Survey and is made available for information purposes only.
To obtain an official copy please contact the Ramsey County Recorder's Office.

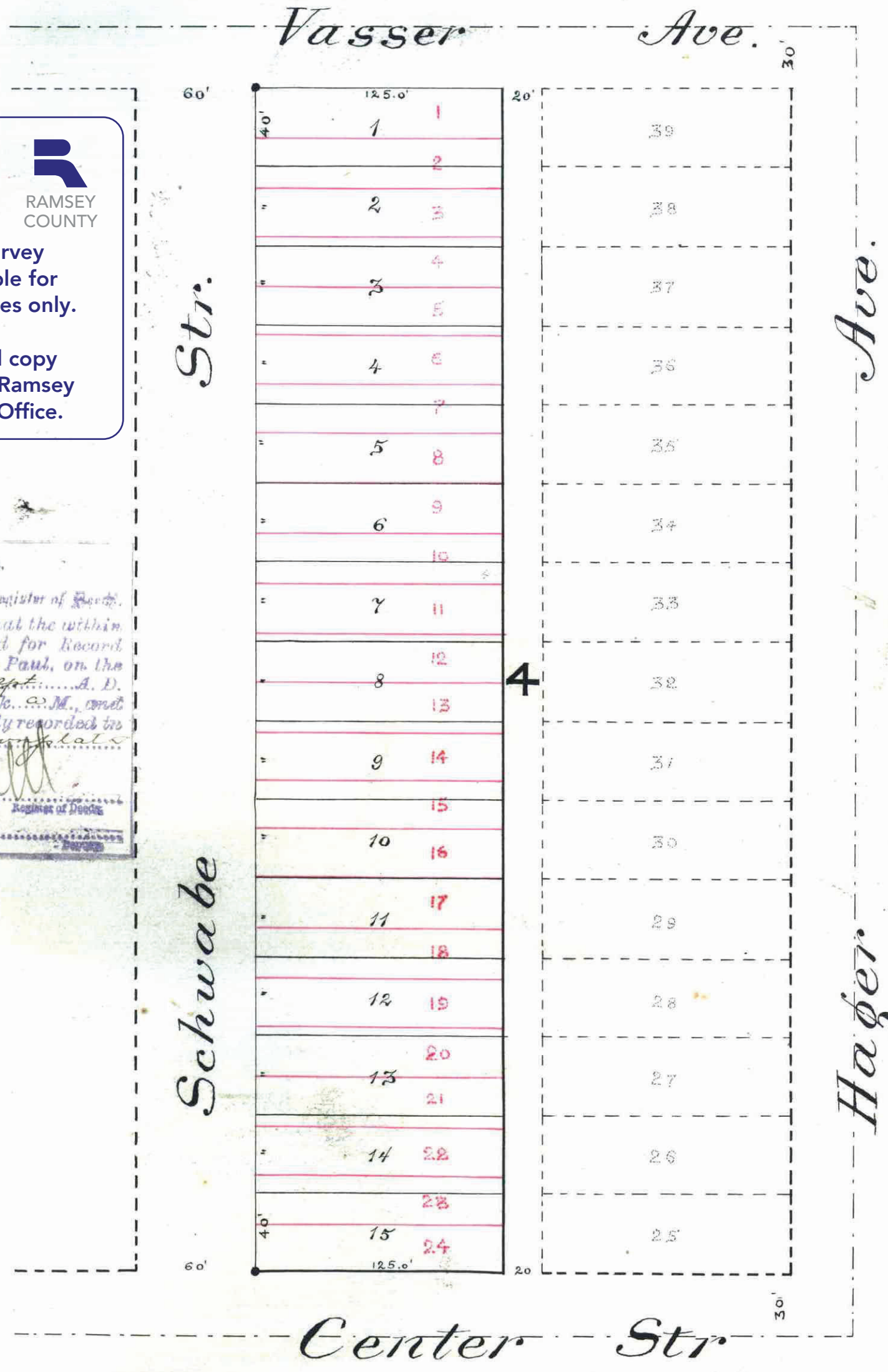

I hereby certify to having surveyed and platted the property as described on this map as Schwabe's Rear^t and have placed iron monuments at the corners as shown on this map, and the same is correct.
Frederick Steeg
Surveyor.

State of Minnesota, County of Ramsey. On this 19th day of September A. D. 1887, personally appeared before the undersigned Frederick Steeg to me well known and acknowledged that he executed the foregoing certificate as his own free act and deed.
Charles Rudolph
Notary Public,
Ramsey Co., Minn.

This is to certify that Henry F. Schwabe and Clara Schwabe his wife proprietors of Lots 1 to 24 including Blk 4 Lake View Add. N^o 1 to St. Paul have caused the same to be surveyed and platted, and hereafter known as Schwabe's Rear^t as shown by this plat and hereby dedicate to the public and for the public use forever all the streets and alley, as herein indicated.
Witness our hands and seals, this 19th day of September 1887.
In presence of:

State of Minnesota, County of Ramsey
On this 19th day of September A. D. 1887, personally came before me Henry F. Schwabe and Clara Schwabe his wife to me well known and they acknowledged that they executed the foregoing certificate for the uses and purposes therein expressed.
C. A. St. John
Notary Public,
Ramsey County, Minnesota

Accepted and approved this 20th day of September A. D. 1887.
S. C. Holcomb
W. Starkey Plat Commissioners.
Wm. H. S. S. S.
L. W. Lundell

Accepted by the common council of the City of St Paul on the 20th day of Sept 1887.
Wm. H. S. S. S.
City Clerk.
Taxes Paid and Transfer Entered
SEP 24 1887
M. F. KAIN, County Auditor.
Per *Warron* Deputy

