

STINSON'S SUBDIVISION of Block 44 of ARLINGTON HILLS Add. to St. PAUL.

This plat document is an UNOFFICIAL copy of a Subdivision Plat or Registered Land Survey and is made available for information purposes only.

To obtain an official copy please contact the Ramsey County Recorder's Office.



16

STATE OF MINNESOTA, } ss.
County of Ramsey.
OFFICE OF THE REGISTER OF DEEDS.
This is to certify that the within instrument was filed for Record in this office, at St. Paul on the 6th day of October A. D. 1882 at 4 o'clock P. M., and that the same was duly recorded in Book 16 of Plats page 16
W. J. Minnan
Register of Deeds.
By _____ Deputy.

I hereby certify that this is a correct Plat of Stinson's Subdivision of Block 44 of Arlington Hills Addition to St. Paul as surveyed and platted by me in the Month of September 1882.

St. Paul, September 23rd 1882
E. Hoenck
Surveyor.

I the undersigned James Stinson proprietor of Stinson's Subdivision of Block 44 of Arlington Hills Addition to St. Paul do hereby certify that I have caused the same to be surveyed and platted as represented by this plat.

St. Paul this 26th Day of September 1882
James Stinson

State of Minnesota }
County of Ramsey } S. S.

Before me *Henry P. Goodenow*
a notary public in and for Ramsey County State of Minnesota this 26 Day of September 1882 in person appeared James Stinson to me personally known to be the party described in and who signed the above certificate and acknowledged that he executed the same freely and voluntarily for the uses and purposes therein expressed

St. Paul, September 26 1882
Henry P. Goodenow
Notary public.
Ramsey County Minn.

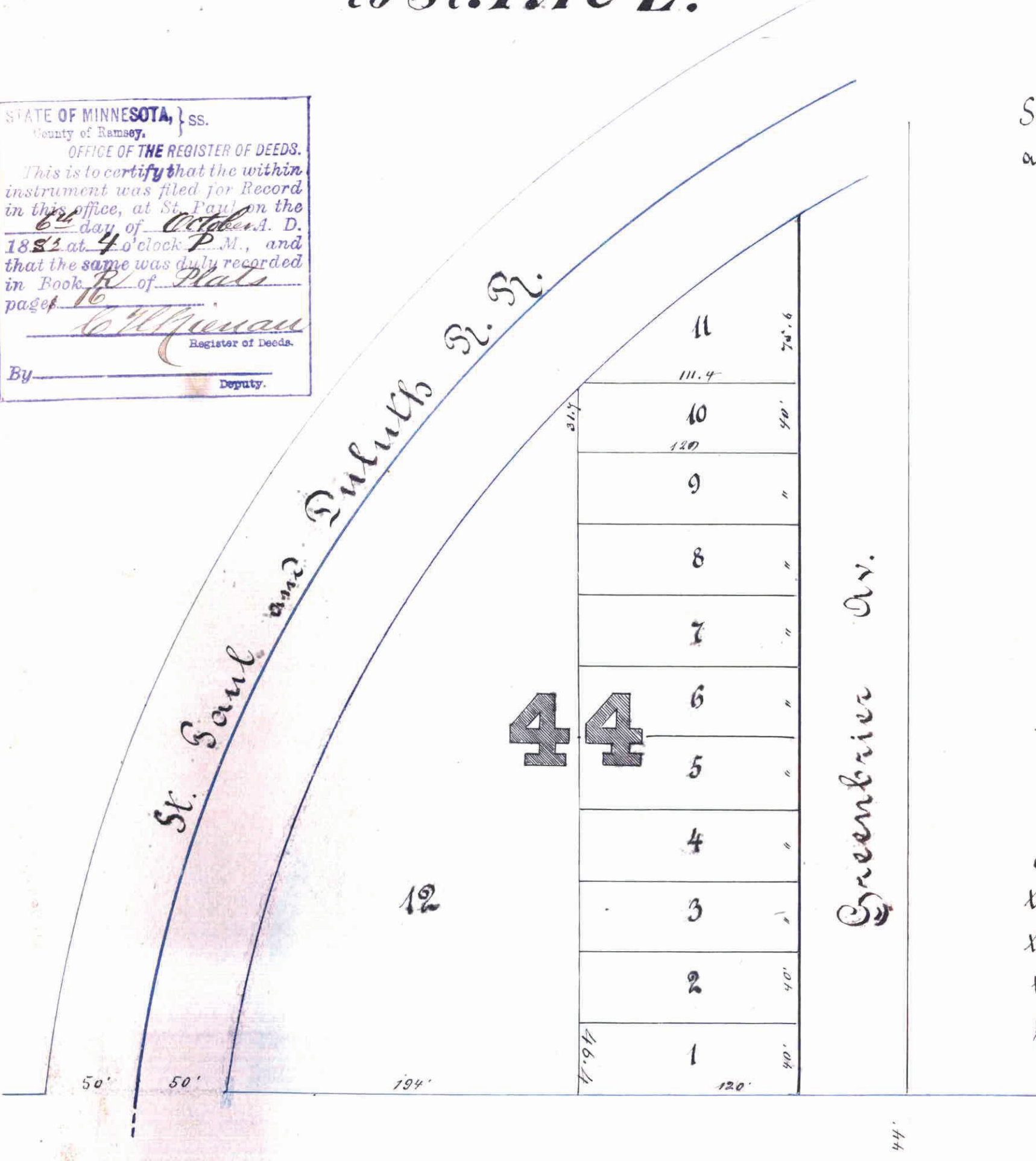

Chi. St. Paul, Minn. and Omaha R. R.

Taxes Paid Oct 6/82
J. M. Card
Auditor

City Treasurers' Office,
ST. PAUL, MINN.
OCT 5 1882
ASSESSMENT PAID.
George Reis City Treas.

Examined & approved
L. W. Rundlett
Oct 22 1882 City Engr

St. Paul, September 30 1882

approved:

J. M. Vanduyke
James Starkey
J. O. Holson

Platcom mission

Accepted by Commr
Council Oct 3 1882
W. H. Wendigall
City Clk.