

See survey map in ...
in ... of 31-32

This plat document is an UNOFFICIAL copy of a Subdivision Plat or Registered Land Survey and is made available for information purposes only.
To obtain an official copy please contact the Ramsey County Recorder's Office.

DEWEY BASS and ROHRER'S addition to ST. PAUL.

We the undersigned John J. Dewey, M. Bass and Daniel Rohrer proprietors of Dewey Bass and Rohrer's addition to the City of Saint Paul hereby certify that we have had the same laid out and divided into blocks and lots as shown in this plat and we do hereby give the streets therein designated for public use.

Daniel Rohrer
M. Bass
John J. Dewey

For testimony of the undersigned
Ramsey County, ss. Before the undersigned, personally appeared John J. Dewey, M. Bass and Daniel Rohrer this 23rd day of October A.D. 1856, to me, notary public, to be the parties who signed and executed the foregoing certificate, and who acknowledged that they executed the same freely, and voluntarily, for the uses and purposes therein specified.

C. L. Hart
Notary Public
Minnesota

I hereby certify that on the month of August 1856, I surveyed into blocks, streets and lots the land of Dewey, Bass and Rohrer the addition designated as Dewey Bass & Rohrer's according to the annexed plat, and that the same are correctly done.
Dated Saint Paul October 15th 1856
C. L. Emerson
Surveyor

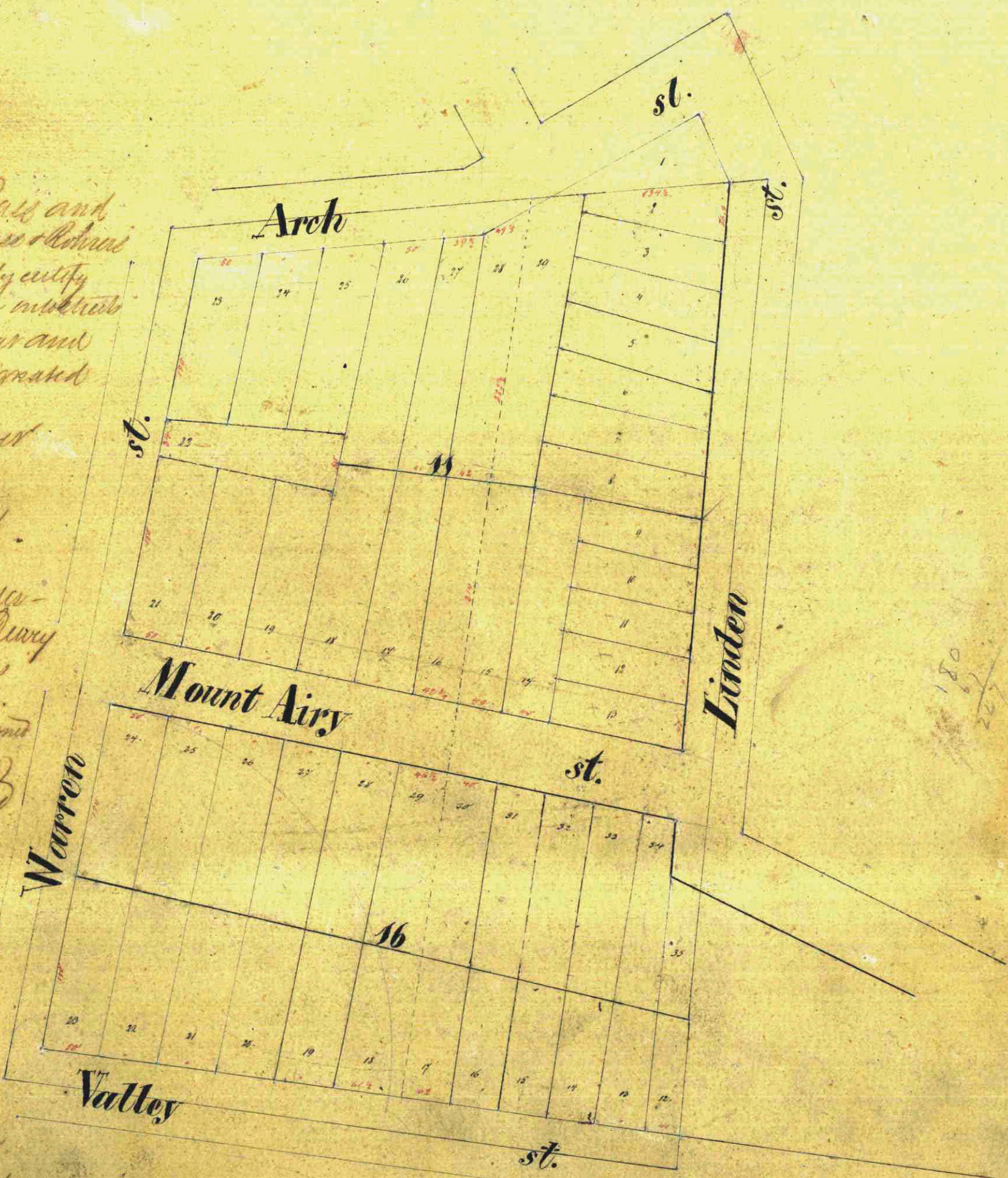

Office of Reg. of Deeds
Ramsey County
I hereby certify that this is a correct copy of the original map of Dewey Bass & Rohrer's addition to Saint Paul filed in this office pursuant to Act of 23rd A.D. 1856 of Geo. W. Adams and was duly recorded in book ...
L. M. ...
per J. B. ...