

TSI ADDITION

NW Cor. Of NW 1/4, Sec. 36, Twp. 30, Rng. 23 (Ramsey County Monument)
 N. Line Of NW 1/4, Sec. 36
 W. Line Of NW 1/4, Sec. 36

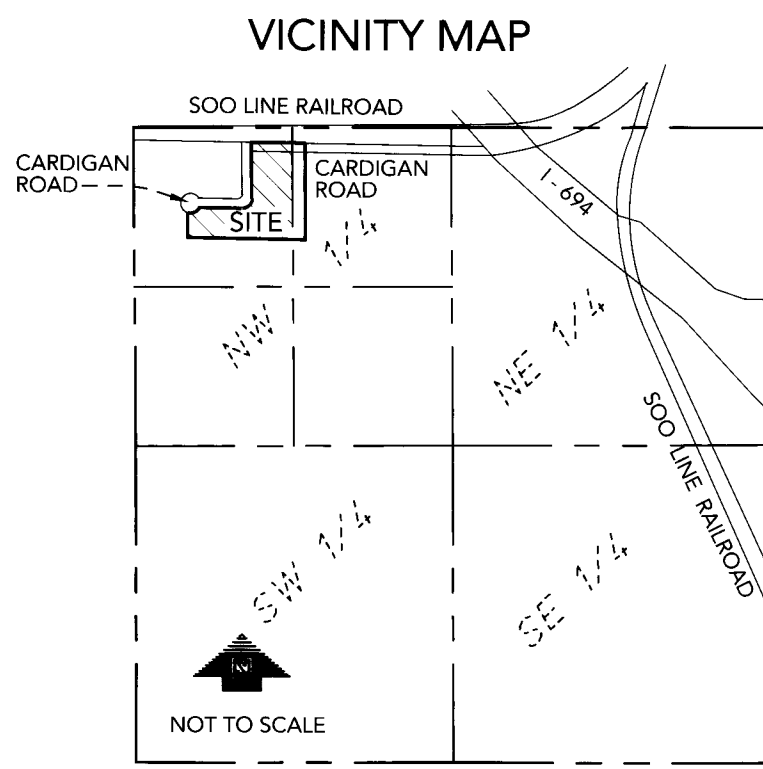

SECTION 36, TOWNSHIP 30, RANGE 23, RAMSEY COUNTY, MINNESOTA

SCALE IN FEET
 SCALE: 1 INCH = 50 FEET

BEARINGS ARE BASED ON THE WEST LINE OF THE NW 1/4 OF SEC. 36, T. 30, R. 23 HAVING A BEARING OF S 00° 38' 51" E.

- DENOTES 1/2 INCH X 14 INCH IRON PIPE MONUMENT SET, MARKED "LS 17255"
- DENOTES 1/2 INCH IRON PIPE MONUMENT FOUND, UNLESS OTHERWISE SHOWN
- ▲ DENOTES "PK NAIL" FOUND
- DENOTES FOUND GRANITE MONUMENT
- DESC. DENOTES DESCRIBED BEARING

W 1/4 Cor. Of Sec. 36, Twp. 30, Rng. 23 (Ramsey County Monument)

N 89° 14' 39" W 1420.00
 (N 88° 35' 48" W - Desc.)

(S 88° 35' 48" E - Desc.)
 S 89° 14' 39" E 1420.00

Soo Line Railroad

Cardigan Road

Cardigan Road

KROISS

NW 1/4

SEC 36

INDUSTRIAL

PARK

TWP 30

(formerly Industrial Blvd.)
 Cardigan Road

KROISS INDUSTRIAL PARK NO. 2

KROISS INDUSTRIAL Block

PARK NO. 3

Lot 1 Lot 2 Lot 3
 KROISS INDUSTRIAL Block 1

Block 1

Lot 2

RNG

ADDITION NO. 2

OAKS

LAKESHORE

LAKE OWASSO TOWNHOMES

