

EMJA GUNDERSON ADDITION

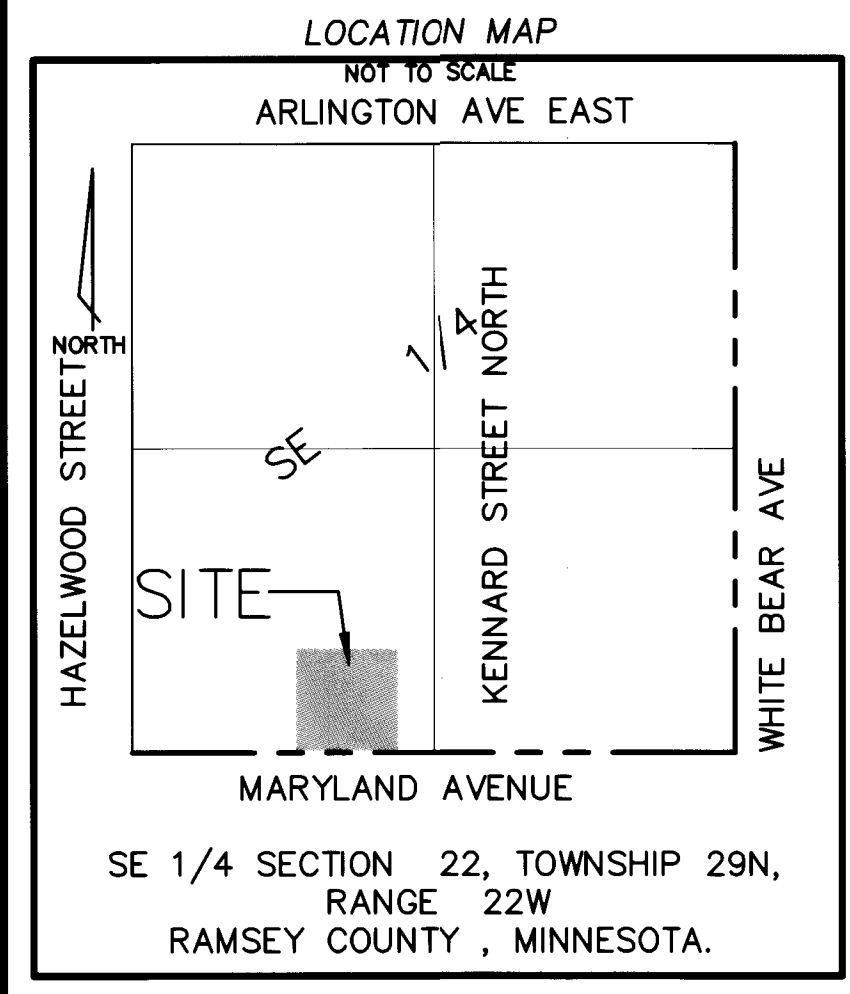

KNOW ALL MEN BY THESE PRESENTS: That Drie Tulpen LLC, a Minnesota Limited Liability Company, owner of the following described property situated in the City of Saint Paul, County of Ramsey, State of Minnesota:

Commencing at the Southeast corner of the Southwest Quarter of the Southeast Quarter of Section 22, Township 29, Range 22, which is in the center of Maryland Street; thence west along the center of Maryland Street 90 feet; thence north at right angles to the center line of Maryland Street 33 feet to a point in the north line of Maryland Street, which is the point of beginning of the land to be described; running thence north at right angles to Maryland Street 262.16 feet to a point; running thence west at right angles 205.16 feet to a point; running thence south at right angles 262.16 feet to the north line of Maryland Street; running thence east at right angles along the north line of Maryland Street 205.16 feet to the place of beginning, except the North 100 feet thereof.
Has caused the same to be surveyed and platted as EMJA GUNDERSON ADDITION.

In witness whereof said Drie Tulpen LLC, a Minnesota Limited Liability Company, has caused these presents to be signed by its proper officer this 14th day of August, 2018.

Signed: Drie Tulpen LLC
Eric Gunderson
Eric Gunderson, President

STATE OF MINNESOTA
COUNTY OF Ramsey
The foregoing instrument was acknowledged before me this 14th day of Aug., 2018 by Eric Gunderson, President of Drie Tulpen LLC, a Minnesota Limited Liability Company, on behalf of the company.

Arti Sandeep Chandak
ARTI SANDEEP CHANDAK
Notary Public, Ramsey County, Minnesota.
My Commission Expires 01/31/2020

I, Allen C. Schlipp, Licensed Land Surveyor, do hereby certify that I have surveyed or directly supervised the survey of the property described on this plat; prepared this plat or directly supervised the preparation of this plat; that this plat is a correct representation of the boundary survey; that all mathematical data and labels are correctly designated on this plat; that all monuments depicted on this plat have been correctly set; that all water boundaries and wet lands, as defined in Minnesota Statutes, Section 505.01, Subd. 3, as of the date of the surveyor's certification are shown and labeled on this plat; and all public ways are shown and labeled on this plat.

Dated this 27th day of JULY, 2018.

Allen Schlipp
Allen C. Schlipp, Land Surveyor
Minnesota License No. 21292

STATE OF MINNESOTA
COUNTY OF RAMSEY
The foregoing Surveyor's Certificate was acknowledged before me this 27 day of July, 2018 by Allen C. Schlipp, a Licensed Land Surveyor.

Rocio Gomez
Rocio Gomez
Notary Public, Ramsey County, Minnesota.
My Commission Expires Jan 2, 2021

City of Saint Paul
I do hereby certify that on the 28 day of March, 2018, the City Council of the City of Saint Paul, Minnesota, approved this plat. Also, the conditions of Minnesota Statutes, Section 505.03, Subd. 2, have been fulfilled.

Shari Moore
Shari Moore
Clerk

Property Tax, Records and Election Services
Pursuant to Minnesota Statutes, Section 505.021, Subd. 9, taxes payable in the year 2018 on the land hereinbefore described have been paid. Also, pursuant to Minnesota Statutes, Section 272.12, there are no delinquent taxes and transfer entered this 19 day of August, 2018.

Christopher A. Samuel, Ramsey County Auditor/Treasurer

By _____, Deputy

County Surveyor
Pursuant to Minnesota Statutes, Section 383A.42, this plat is approved this 15th day of August, 2018.

Craig W. Hinzman
Craig W. Hinzman, L.S.
Ramsey County Surveyor

Daniel D. Baer
Daniel D. Baer, L.S.
Deputy Ramsey County Surveyor

Registrar of Titles
County of Ramsey, State of Minnesota
I hereby certify that this plat of EMJA GUNDERSON ADDITION was filed in the office of the Registrar of Titles for public record on this 15th day of August, 2018, at 1 o'clock P.M. as duly filed in Book 515th of Plats, Page 32 as Document Number 20181479.

Deputy Registrar of Titles

LEGEND

- DENOTES CAST IRON MONUMENT
- DENOTES 1/2 INCH BY 14 INCH IRON PIPE MONUMENTS, MARKED BY LICENSE NO. 21292 SHOWN HAVE ALL BEEN CORRECTLY SET PRIOR TO THE RECORDING OF THIS PLAT.
- (DEED) DENOTES BEARING PER CERTIFICATE OF TITLE 616623

FOR THE PURPOSES OF THIS SURVEY, THE SOUTH LINE OF THE SE 1/4, SECTION 22, TWP 29 N., RNG 22 W. HAS AN ASSUMED BEARING OF SOUTH 89° 48' 27" WEST

Source of right of way for Herbert Street: Doc #1647777
No source of right of way for Maryland Avenue was found.

SCALE: 1 INCH = 20 FEET

