

REGISTERED LAND SURVEY NO. 563

I, Michael E. Cannon, Land Surveyor, do hereby certify that, in accordance with the provisions of Minnesota Statutes, Section 508.47, I have surveyed the following described property situated in the County of Ramsey, State of Minnesota:

Tract "A", Registered Land Survey No. 289, files of Registrar of Titles, County of Ramsey.

I hereby certify that this Registered Land Survey is a correct delineation of Certificate of Title No. 262814.

Dated this 7th day of July, 2000.

Michael E. Cannon
Michael E. Cannon, Land Surveyor
Minnesota License No. 40035

City of Saint Paul

I do hereby certify that on the 10th day of July, 2000, the Planning Administrator of the City of Saint Paul, Minnesota, approved this Registered Land Survey. All monuments will be set as specified by the City Council and as stated on this Registered Land Survey, according to Minnesota Statutes, Section 508.47.

[Signature]
Planning Administrator

Taxes payable in the year 2000 on the land herein described have been paid, also there are no delinquent taxes and transfer entered this 10th day of July, 2000.

Dorothy McCleung, Director
Department of Property Taxation

By [Signature], Deputy

Pursuant to Minnesota Statutes, Section 383A.42, this Registered Land Survey has been examined and is approved this 10th day of July, 2000 and the conditions of Minnesota Statutes, Section 505.03, Subdivision 2, have been fulfilled.

Ronald F. Meyer, DEPUTY
David D. Claypool, L.S.
Ramsey County Surveyor

Registrar of Titles, County of Ramsey, State of Minnesota

I hereby certify that this Registered Land Survey No. 563 was filed in this office this 17th day of July, 2000, at 8:00 o'clock A.M., as Document No. 1606543.

Deputy Registrar of Titles



MINNESOTA REGISTERED LAND SURVEYORS

REGISTERED LAND SURVEY NO. 563

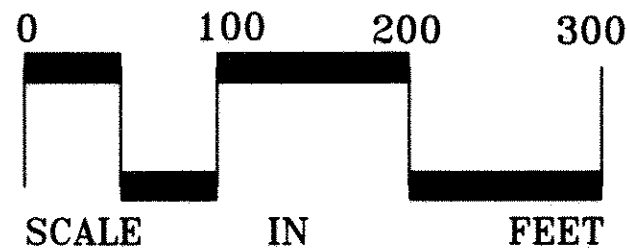

SCALE: 1 INCH = 100 FEET

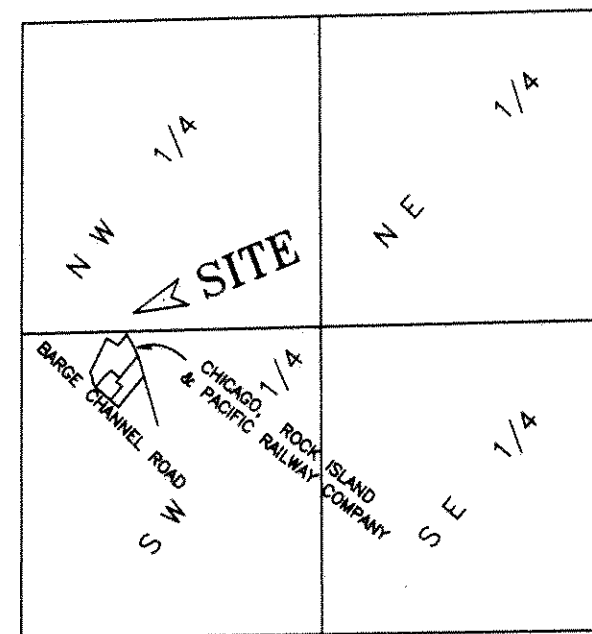
THE SOUTHEASTERY LINE OF TRACT A RLS No. 289
IS ASSUMED TO HAVE A BEARING OF N39°19'00"E.

VICINITY MAP

SECTION 9, T28N, R22W
(NO SCALE)