

# OVERVIEW

KNOW ALL MEN BY THESE PRESENTS: That Masterpiece Homes, Inc., a Minnesota Corporation, owner and Premier Bank, a Minnesota Corporation, mortgagee of the following described property situated in the City of Maplewood, County of Ramsey, State of Minnesota:

That part of the Northeast Quarter of the Southeast Quarter of Section 18, Township 29, Range 22, Ramsey County, Minnesota, lying east of the easterly right of way line of Interstate Highway No. 35E and south of De Mars 4th Addition and De Mars 2nd Addition. Except the southerly 378 feet thereof.

Have caused the same to be surveyed and platted as OVERVIEW and do hereby dedicate to the public for public use forever the thoroughfare, cul-de-sac, utility easements and drainage and utility easement as shown on this plat.

In witness whereof said Masterpiece Homes, Inc., a Minnesota Corporation, has caused these presents to be signed by M. Gordie Howe, Chief Executive Officer, this 12<sup>th</sup> day of July, 2005.

Signed: Masterpiece Homes, Inc.  
  
M. Gordie Howe, Chief Executive Officer

State of Minnesota  
County of Ramsey

The foregoing instrument was acknowledged before me this 12<sup>th</sup> day of July, 2005, by M. Gordie Howe, Chief Executive Officer of Masterpiece Homes, Inc., a Minnesota Corporation, on behalf of the corporation.

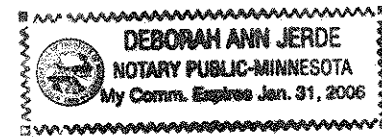

Deborah Ann Jerde  
Notary Public, Ramsey County, Minnesota  
My Commission Expires Jan 31, 2006

In witness whereof said Premier Bank, a Minnesota Corporation, has caused these presents to be signed by Michael Ruether, President of the White Bear Branch of Premier Bank, a Minnesota Corporation, this 12 day of July, 2005.

Signed: Premier Bank  
  
Michael Ruether, President of the White Bear Branch of Premier Bank

State of Minnesota  
County of Ramsey

The foregoing instrument was acknowledged before me this 12<sup>th</sup> day of July, 2005, by Michael Ruether, President of the White Bear Branch of Premier Bank, a Minnesota Corporation, on behalf of the corporation.

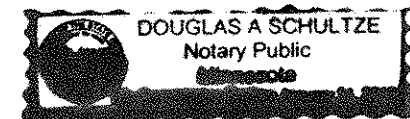

Douglas A. Schultze  
Notary Public, Ramsey County, Minnesota  
My Commission Expires 1/31/2010

I hereby certify that I have surveyed and platted the property described on this plat as OVERVIEW; that this plat is a correct representation of the survey; that all distances are correctly shown on the plat in feet and hundredths of a foot; that all monuments will be correctly placed in the ground as shown; that the outside boundary lines are correctly designated on the plat; and there are no wet lands as defined in Minnesota Statutes, Section 505.02, Subd. 1, or public highways to be designated other than as shown on this plat.

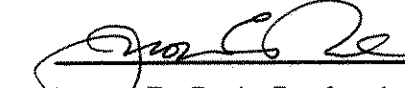
  
Jason E. Rud, Professional Land Surveyor  
Minnesota License No. 41578

State of Minnesota  
County of Minnesota

The foregoing Surveyor's Certificate was acknowledged before me this 11<sup>th</sup> day of July, 2005, by Jason E. Rud, a Licensed Land Surveyor.

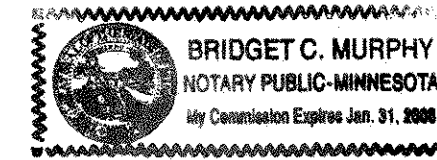

Bridget C. Murphy  
Notary Public, Minnesota County, Minnesota  
My Commission Expires January 31, 2006

City of Maplewood

We do hereby certify that on the 8<sup>th</sup> day of AUGUST, 2005.

the City Council of the City of Maplewood, Minnesota approved this plat. Pursuant to Minnesota Statutes, Section 505.02, Subd.1, all monuments must be set as specified by the City Council and as stated and shown on this plat. Also, the conditions of Minnesota Statutes, Section 505.03, Subd.2, have been fulfilled.

Bob Cardinal Mayor  
Karen E. Caulfield Clerk

Taxes payable in the year 2005 on the land herein described have been paid also there are no delinquent taxes and transfer entered this 19<sup>th</sup> day of August, 2005.

Dorothy Mellung Director  
Department of Property Taxation  
By Sharon Ophip Deputy

County Surveyor

Pursuant to Minnesota Statutes, Section 383A.42, this plat has been examined and is approved this 25<sup>th</sup> day of August, 2005.

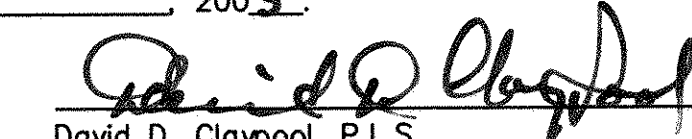
  
David D. Claypool, P.L.S.  
Ramsey County Surveyor

County Recorder  
County of Ramsey, State of Minnesota

I hereby certify that this plat of OVERVIEW was filed in the office of the County Recorder for public record on this 25 day of August, 2005 at 4 o'clock P.M. and was duly filed in Book 121 of Plats, Pages 34 and 35, as Document Number 3883036.

Deputy County Recorder



# OVERVIEW

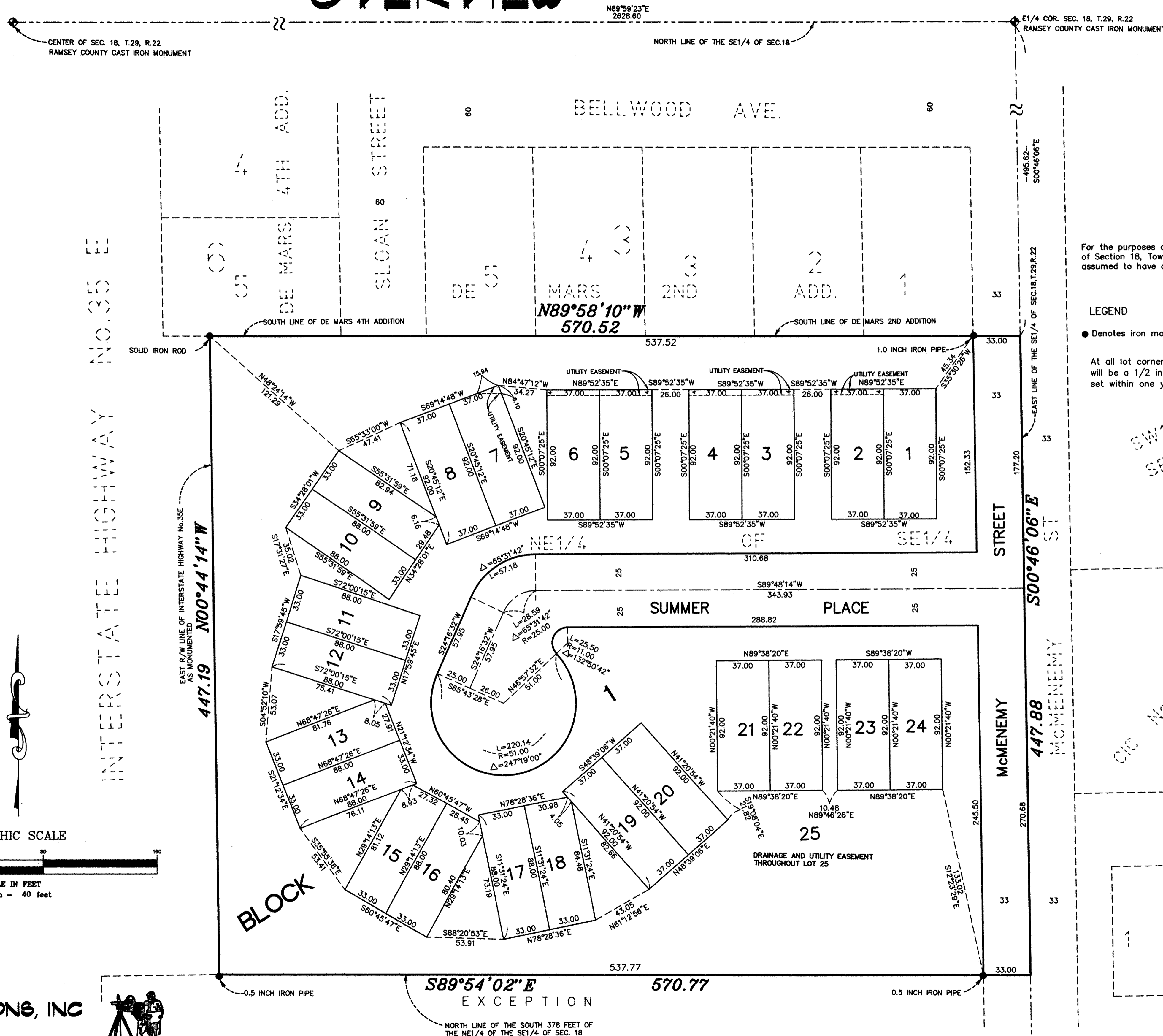

For the purposes of this plat the east line of the Southeast Quarter of Section 18, Township 29, Range 22, Ramsey County, Minnesota is assumed to have a bearing of S 00°46'06" E.

### LEGEND

● Denotes iron monument found

At all lot corners with no monument symbol shown will be a 1/2 inch by 18 inch iron pipe marked R.L.S.41578 set within one year of the recording of this plat.

SW 1/4  
SEC. 17 - T. 29 - R. 22

C/O No. 472

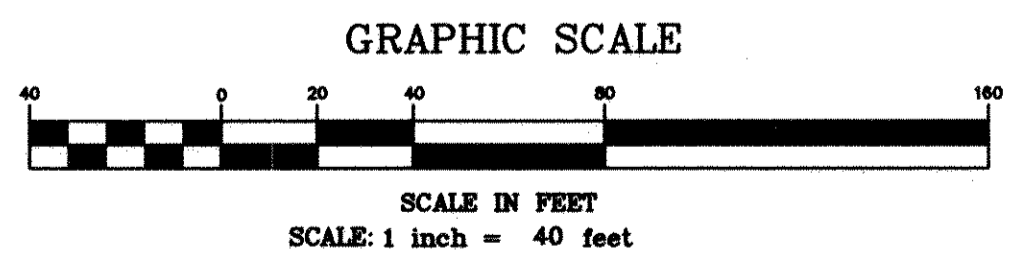
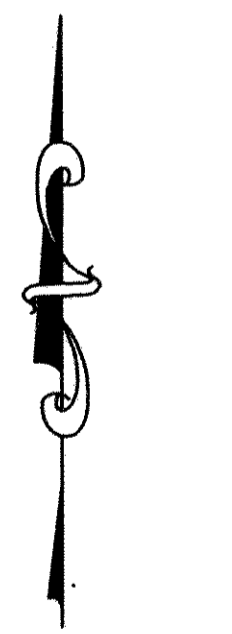
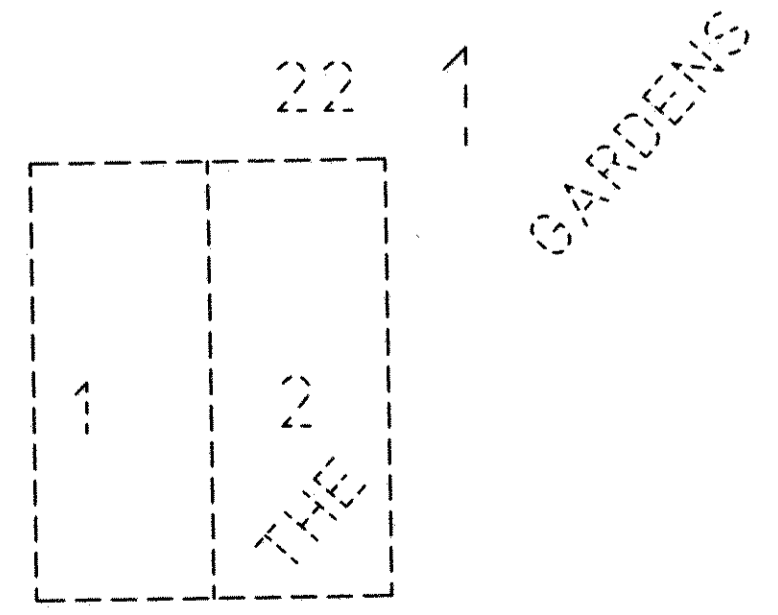

E. G. RUD & SONS, INC  
LAND SURVEYORS

