

# SCHROEDER'S RICE STREET 2ND ADDITION

KNOW ALL MEN BY THESE PRESENTS: That Schroeder Development Co., a Minnesota partnership, fee owner of the following described property situated in the City of Little Canada, County of Ramsey, State of Minnesota:

Outlot A, SCHROEDER'S RICE STREET ADDITION and that part of Tract A, Registered Land Survey No. 300, Ramsey County, Minnesota, lying north of a line parallel with and 150 feet south of the most northerly line of said Tract A and its easterly extension.

Has caused the same to be surveyed and platted as SCHROEDER'S RICE STREET 2ND ADDITION and does hereby dedicate to the public for public use forever the thoroughfare and the drainage and utility easements as shown on this plat.

In witness whereof said Schroeder Development Co., a Minnesota partnership, has caused these presents to be signed by its proper partners this 12<sup>th</sup> day of September, 2003.

Signed: Schroeder Development Co.

Robert J. Schroeder its Managing Partner Ernst D. Schroeder its Partner

STATE OF MINNESOTA  
COUNTY OF RAMSEY

The foregoing instrument was acknowledged before me this 12<sup>th</sup> day of September, 2003 by ERNEST D. Schroeder partner and by Robert J. Schroeder, partner of Schroeder Development Co., a Minnesota partnership, on behalf of the partnership.

Karen M. Torgersen  
Notary Public, Ramsey County, Minnesota  
My Commission Expires 1-31-2005

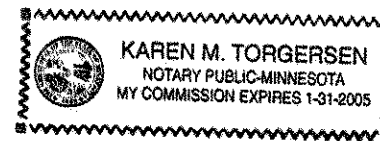

I hereby certify that I have surveyed and platted the property described on this plat as SCHROEDER'S RICE STREET 2ND ADDITION; that this plat is a correct representation of the survey; that all distances are correctly shown on the plat in feet and hundredths of a foot; that all monuments have been correctly placed in the ground as shown; that the outside boundary lines are correctly designated on the plat; and there are no wet lands as defined in Minnesota Statutes, Section 505.02, Subd. 1, or public highways to be designated other than as shown on this plat.

David E. Torgersen  
David E. Torgersen, Licensed Land Surveyor  
Minnesota License No. 17551

STATE OF MINNESOTA  
COUNTY OF RAMSEY

The foregoing Surveyor's Certificate was acknowledged before me this 10<sup>th</sup> day of September, 2003 by David E. Torgersen, a Licensed Land Surveyor.

Karen M. Torgersen  
Notary Public, Ramsey County, Minnesota  
My Commission Expires January 31, 2005

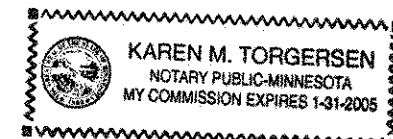

City of Little Canada

We do hereby certify that on the 23<sup>rd</sup> day of July, 2003, the City Council of the City of Little Canada, Minnesota, approved this plat. All monuments will be set as specified by the City Council and as stated on this plat, according to Minnesota Statutes, Section 505.02, Subd. 1.

Michael D. Fahy Mayor  
Paul C. Abner City Administrator

Taxes payable in the year 2003 on the land herein described have been paid, also there are no delinquent taxes and transfer entered this 17<sup>th</sup> day of September, 2003.

Dorothy McClung Director  
Department of Property Taxation

By Mary Kay Simpson Deputy

Pursuant to Minnesota Statutes, Section 383A.42, this plat has been examined and is approved this 17<sup>th</sup> day of September, 2003 and the conditions of Minnesota Statutes, Section 505.03, Subdivision 2, have been fulfilled.

David D. Claypool  
David D. Claypool, L.S.  
Ramsey County Surveyor

Registrar of Titles, County of Ramsey, State of Minnesota

I hereby certify that this plat of SCHROEDER'S RICE STREET 2ND ADDITION was filed in the office of the Registrar of Titles for public record on this 17<sup>th</sup> day of September, 2003, at 12 o'clock P.M. and was duly filed in Book 44 of Plats, Pages 50 and 51, as Document Number 1377035.

Deputy Registrar of Titles

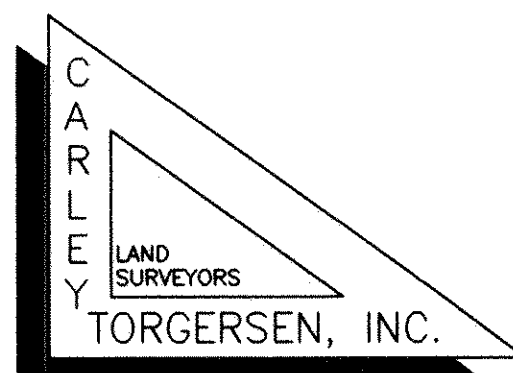

# SCHROEDER'S RICE STREET 2ND ADDITION

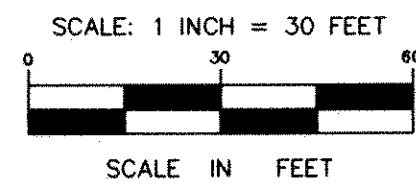
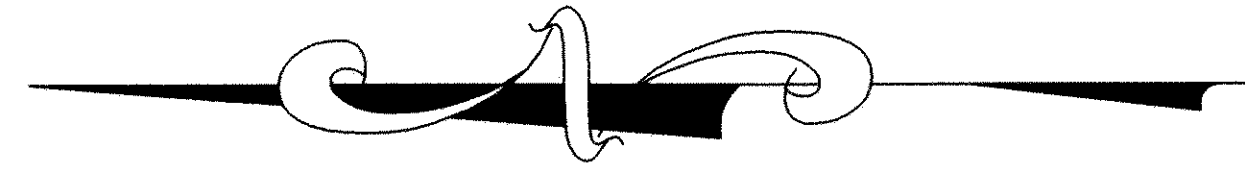

THE WEST LINE OF THE S.W. 1/4 OF SEC. 7, T. 29, R. 22, IS ASSUMED TO HAVE A BEARING OF NORTH

- DENOTES 1/2 INCH X 14 INCH IRON PIPE FOUND AND MARKED WITH MINNESOTA LIC. NO. 17551
- DENOTES 1/2 INCH X 14 INCH IRON PIPE SET MARKED WITH MINNESOTA LIC. NO. 17551

REGISTERED LAND SURVEY NO. 300

TRACT A

EAST LINE OF OUTLOT A

NORTH 275.91

225.91

6 FT. DRAINAGE AND UTILITY EASEMENT

## LOT 1

OUTLOT A  
SCHROEDER'S RICE STREET  
ADDITION

## BLOCK 1

### OUTLOT A

N89°38'04"W 199.98

LOT 1  
BLOCK 1  
SCHROEDER'S  
RICE STREET ADDITION

NORTH 150 FT.

MOST NORTHERLY LINE OF TRACT A, REGISTERED LAND SURVEY NO. 300

S89°37'27"E 267.00

6 FT. DRAINAGE AND UTILITY EASEMENT

S89°37'27"E 34.00

NORTH 150.00  
RICE STREET  
(C.S.A.H. NO. 49)

WEST LINE OF TRACT A  
REGISTERED LAND SURVEY NO. 300

NORTH 150.00

NORTH LINE OF OUTLOT A

S89°37'27"E 34.00

34.00

33

67

67

33

67

67

67

67

67

67

67

67

67

67

67

67

67

67

67

67

67

67

67

67

67

67

67

67

67

67

67

67

67

67

67

67

67

67

67

67

67

67

67

67

67

67

67

67

67

67

67

67

67

67

67

67

67

67

67

67

67

67

67

67

67

67

67

67

67

67

67

67

67

67

67

67

67

67

67

67

67

67

67

67

67

67

67

67

67

67

67

67

67

67

67

67

67

67

67

67

67

67

67

67

67

67

67

67

67

67

67

67

67

67

67

67

67

67

67

67

67

67

67

67

67

67

67

67

67

67

67

67

67

67

67

67

67

67

67

67

67

67

67

67

67

67

67

67

67

67

67

67

67

67

67

67

67

67

67

67

67

67

67

67

67

67

67

67

67

67

67

67

67

67

67

67

67

67

67

67

67

67

67

67

67

67

67

67

67

67

67

67

67

67

67

67

67

67

67

67

67

67

67

67

67

67

67

67

67

67

67

67

67

67

67

67

67

67

67

67

67

67

67

67

67

67

67

67

67

67

67

67

67

67

67

67

67

67

67

67

67

67

67

67

67

67

67

67

67

67

67

67

67

67

67

67

67

67

67

67

67

67

67

67

67

67

67

67

67

67

67

67

67

67

67

67

67

67

67

67

67

67

67

67

67

67

67

67

67

67

67

67

67

67

67

67

67

67

67

67

67

67