

TORCHWOOD ADDITION

KNOW ALL MEN BY THESE PRESENTS: That Torchwood Property Company Limited Partnership, a limited partnership under the laws of the State of Minnesota, owner of the following described property situated in the City of Shoreview, County of Ramsey, State of Minnesota:

Lots 1, 2, 3 and 4, Block 10, OWASSO, together with that part of the east half of the vacated alley running north and south in said Block 10, accruing to said lots;

And

Lots 6, 7, 8, 9, 10, 11, 12 and 13, Block 10, OWASSO, together with that part of the vacated alley accruing south of said lots and the west half of the vacated alley, running north and south in said Block 10, accruing to said Lot 6;

And

Lot 14, except the north 3 feet thereof, Block 10, OWASSO.

Has caused the same to be surveyed and platted as TORCHWOOD ADDITION, and does hereby dedicate to the public for public use forever the thoroughfares and utility easements as shown on this plat.

In witness whereof said Torchwood Property Company Limited Partnership, a limited partnership under the laws of the State of Minnesota, has caused these presents to be signed by its general partners this 15th day of July, 1993.

Signed: Torchwood Property Company Limited Partnership

Mahendra Nath

Mahendra Nath, General Partner

Ashok Mehta

Ashok Mehta, General Partner

STATE OF MINNESOTA
COUNTY OF Hennepin

The foregoing instrument was acknowledged before me this 15th day of July, 1993 by Mahendra Nath and by Ashok Mehta, General Partners of Torchwood Property Company Limited Partnership, a limited partnership under the laws of the State of Minnesota, on behalf of the partnership.

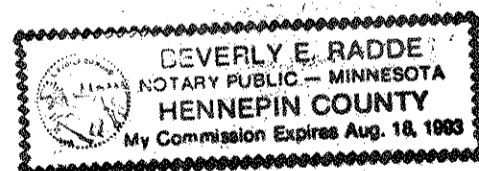

Beverly E. Radde
Notary Public, Hennepin County, Minnesota
My Commission Expires August 18, 1993

I hereby certify that I have surveyed and platted the property described on this plat as TORCHWOOD ADDITION; that this plat is a correct representation of the survey; that all distances are correctly shown on the plat in feet and hundredths of a foot; that all monuments have been correctly placed in the ground as shown; that the outside boundary lines are correctly designated on the plat; and there are no wet lands as defined in Minnesota Statutes, Section 505.02, Subd. 1, or public highways to be designated other than as shown on this plat.

David E. Torgersen
David E. Torgersen, Land Surveyor
Minnesota License No. 17551

STATE OF MINNESOTA
COUNTY OF RAMSEY

The foregoing Surveyor's Certificate was acknowledged before me this 28th day of June, 1993, by David E. Torgersen, a Licensed Land Surveyor.

Karen M. Torgersen
Notary Public, Ramsey County, Minnesota
My Commission Expires October 12, 1994

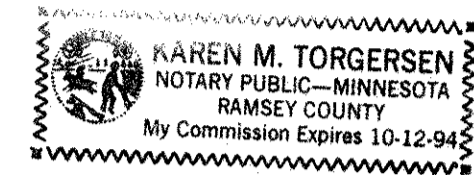

City of Shoreview

We do hereby certify that on the 14th day of July, 1993, the City Council of the City of Shoreview, Minnesota, approved this plat. All monuments will be set as specified by the City Council and as stated on this plat, according to Minnesota Statutes, Section 505.02, Subd. 1.

James Chalmers
Mayor

Terry C. Schwan
City Manager

Taxes payable in the year 1993 on the land herein described have been paid, also there are no delinquent taxes and transfer entered this 15th day of July, 1993.

Lou McKenna, Director
Department of Property Taxation

By Jennifer Adria Deputy

Pursuant to Minnesota Statutes, Section 383A.42, this plat has been examined and is approved this 16th day of July, 1993 and the conditions of Minnesota Statutes, Section 505.03, Subdivision 2, have been fulfilled.

David D. Claypool
David D. Claypool, R.L.S.
Ramsey County Surveyor

County Recorder, County of Ramsey, State of Minnesota

I hereby certify that this plat of TORCHWOOD ADDITION was filed in the office of the County Recorder for public record on this _____ day of _____, 19____, at _____ o'clock _____ M. and was duly filed in Book _____ of Plats, Pages _____ and _____, as Document Number _____.

Lou McKenna, County Recorder

By _____, Deputy

TORRENS:
BOOK No. 39, PAGES 38 AND 39, ON THIS 22ND DAY OF JULY 1993,
AT 1:00 O'CLOCK P.M. AS DOCUMENT NO. 1020343.

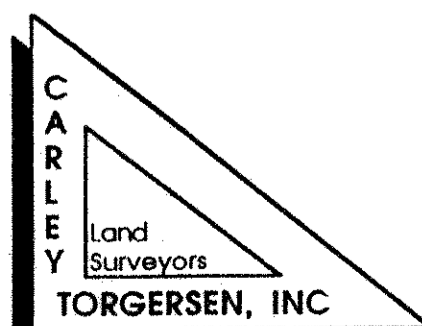

TORCHWOOD ADDITION

SCALE: 1 INCH = 30 FEET

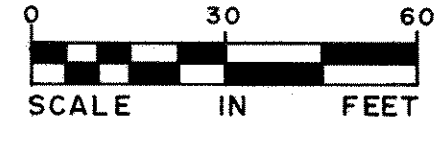

- DENOTES MONUMENT FOUND NOT MARKED BY A LICENSE NO. 1/2 INCH IRON PIPE, UNLESS OTHERWISE SHOWN.
- DENOTES 1/2 INCH BY 18 INCH IRON MONUMENT SET AND MARKED BY LICENSE NO. 17551.

THE EAST LINE OF THE SE 1/4 OF SEC. 36, TWP. 30, RGE. 23 IS ASSUMED TO HAVE A BEARING OF N 0° 35' 36" W

EAST 1/4 COR. OF SEC. 36, TWP. 30, RGE. 23
R.C.M. (C.I.M.)
RAMSEY CO. COORDINATES 12-17-91
X - 571617.097
Y - 192003.669

EAST LINE OF SE 1/4, SEC. 36, TWP. 30, RGE. 23

N 0° 35' 36" W 2630.18

SE. COR. OF SEC. 36, TWP. 30, RGE. 23
R.C.M. (C.I.M.)
RAMSEY CO. COORDINATES 12-17-91
X - 571644.336
Y - 189373.523

