

KNOSPE SECOND ADDITION

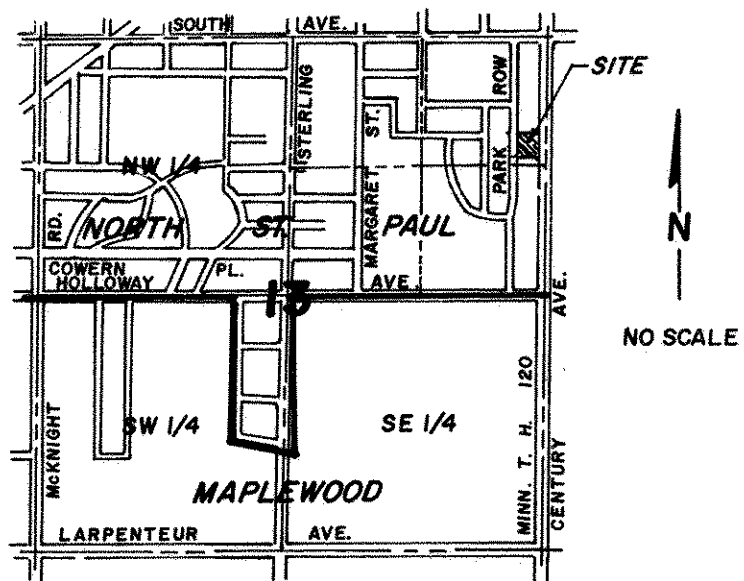

Vicinity Map
Section 13, T 29N, R 22W
City of North St. Paul

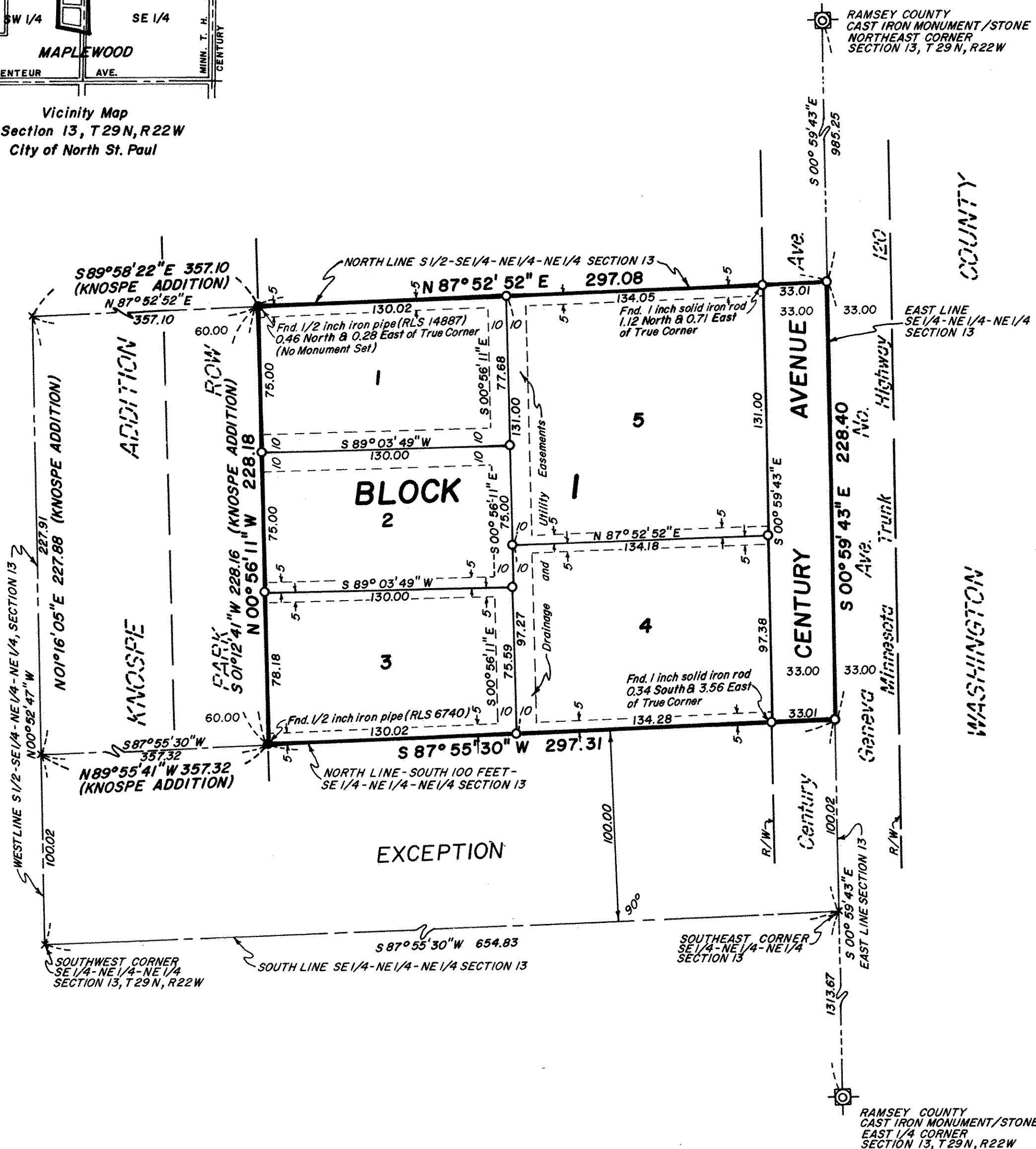

- Denotes 1/2 inch iron pipe monument set, marked with a plastic cap inscribed FREEMAN RLS 16989.
- Denotes iron monument found, size and markings as shown.

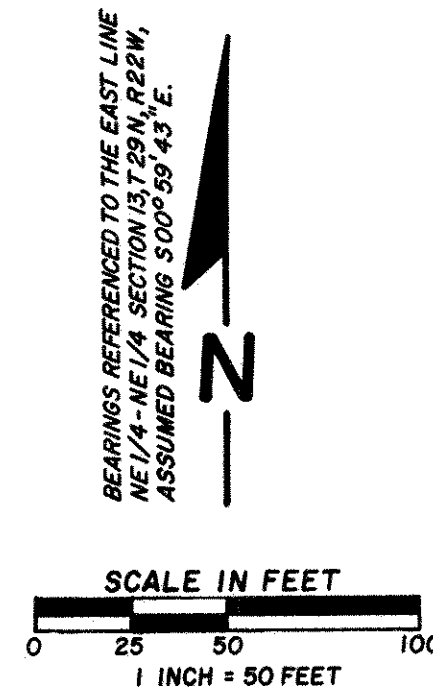

Know All Persons By These Presents that Max O. Knospe, a widower, owner of the following described property situated in the City of North St. Paul, Ramsey County, Minnesota:

That part of the South 1/2 of the Southeast quarter of the Northeast quarter of the Northeast quarter of Section 13, Township 29, Range 22, except the South 100 feet thereof; that lies Easterly of a line described as follows: Beginning at a point on the North line of the said South 1/2 that is 357.10 feet, as measured along said North line, East of the West line of said South 1/2 and run Southerly to a point on the North line of the said South 100 feet thereof that is 357.32 feet, as measured along said North line, East of the West line of said South 1/2.

Has caused the same to be surveyed, platted and known as KNOSPE SECOND ADDITION and does hereby dedicate to the public for public use forever Century Avenue and the drainage and utility easements as shown on the plat.

Has hereunto set his hand this 13th day of October, 1987.

Signed:
Max O. Knospe
Max O. Knospe

State of Minnesota)
County of Washington

The foregoing instrument was acknowledged before me this 13th day of October 1987, by Max O. Knospe, a widower.

Beverly M. Peterson
NOTARY PUBLIC - MINNESOTA
WASHINGTON COUNTY
My commission expires Mar. 5, 1988

Beverly M. Peterson
Notary Public, Washington County, Minnesota
My Commission Expires March 5, 1988

I, Timothy J. Freeman, hereby certify that I have surveyed and platted the property described in the dedication of this plat as KNOSPE SECOND ADDITION; that this plat is a correct representation of said survey; that all distances are correctly shown on the plat; that all monuments have been correctly placed in the ground as shown; that the outside boundary lines are correctly designated on the plat; and there are no wetlands, easements, or public highways other than as shown thereon.

Timothy J. Freeman
Timothy J. Freeman, Land Surveyor
Minnesota Registration No. 16989

State of Minnesota)
County of Washington

The Surveyor's Certificate was subscribed and sworn to before me, a Notary Public, this 13th day of October, 1987.

Beverly M. Peterson
NOTARY PUBLIC - MINNESOTA
WASHINGTON COUNTY
My commission expires Mar. 5, 1988

Beverly M. Peterson
Notary Public, Washington County, Minnesota
My Commission Expires March 5, 1988

Approved and accepted by the City Council of the City of North St. Paul, Minnesota, this 19th day of OCTOBER, 1987.

Karen Sandberg Draft
Acting Mayor

Robert J. Batti
Clerk

Taxes for the year 1987 on the land described herein paid, no delinquent taxes and transfer entered, this 30th day of October, 1987.

Jon McKenna, Director
Department of Property Taxation

By Cindy Lewand, Deputy

Pursuant to Chapter 7, Minnesota Laws of 1976, this plat has been reviewed and approved, this 30th day of October, 1987, and the conditions of Minnesota Statutes, Section 505.03, Subdivision 2, have been fulfilled.

David D. Claypool
David D. Claypool
Acting Ramsey County Surveyor

Registrar of Titles, County of Ramsey, State of Minnesota

I hereby certify that this plat of KNOSPE SECOND ADDITION was filed in this office this 5th day of November, 1987, at 9:00 o'clock A.M. and was filed in Book 36 of Plats, Page 48, as Document No. B53940.

John C. McLaughlin, Registrar of Titles

By _____, Deputy