

CTR. SEC 8, T29N R22W
B.M. ELEV. 889.42 MONUMENT
266.65

EDGERTON

COUNTY ROAD B-2

EXCEPTION

COUNTY PROPERTY

BATHING BEACH

LAKE

GERVAIS

W.S. ELEV. 858.90
FEB. 7, 1961

0+28 BEG. 7 FT. FENCE
(6 FT. HIGH MESH)

PROPOSED FENCE
(1.0' N. OF S. PROP. LINE)

2+90 END 7 FT. FENCE

TOILETS

PARKING AREA

ENTRANCE ROADWAY

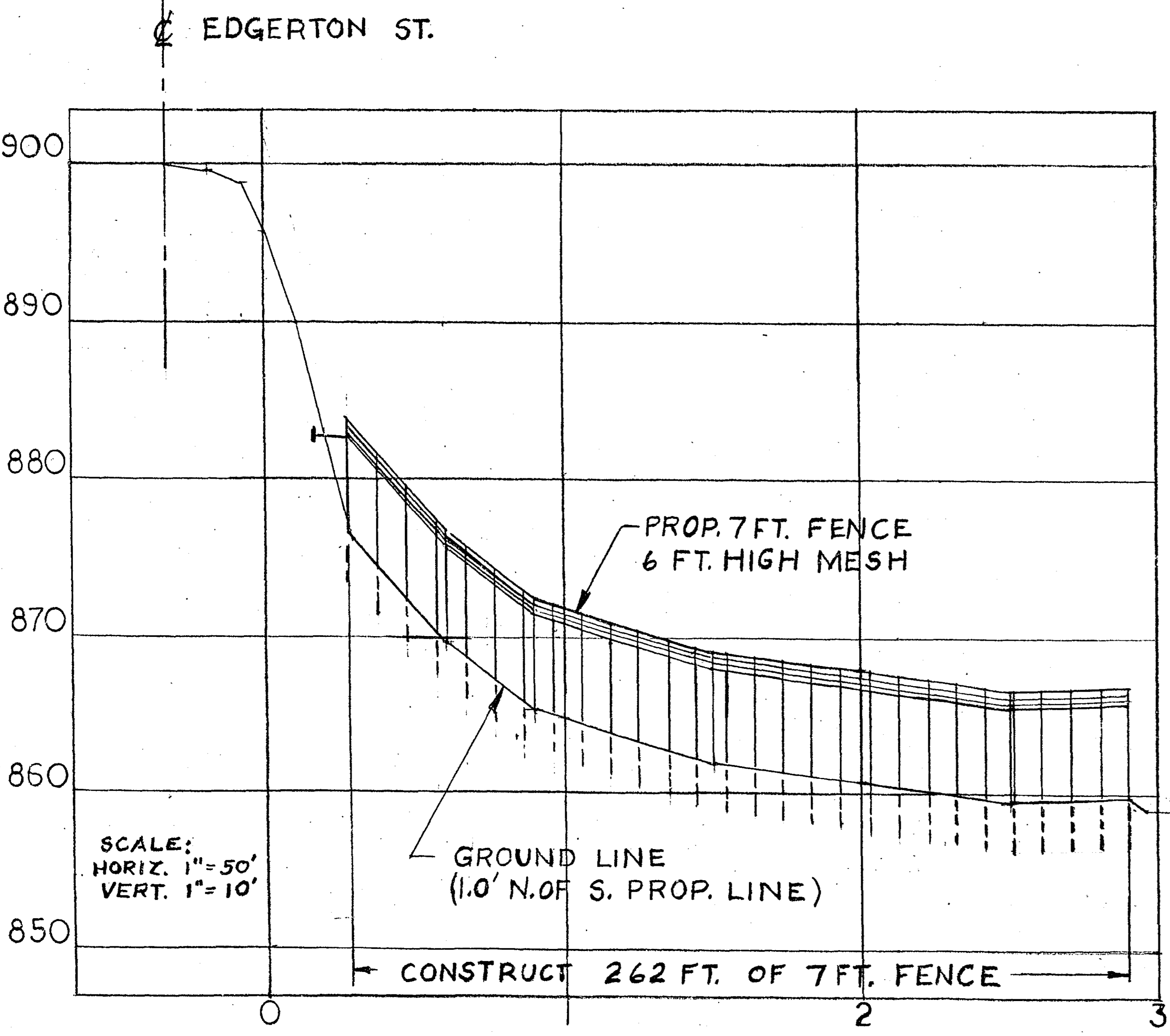
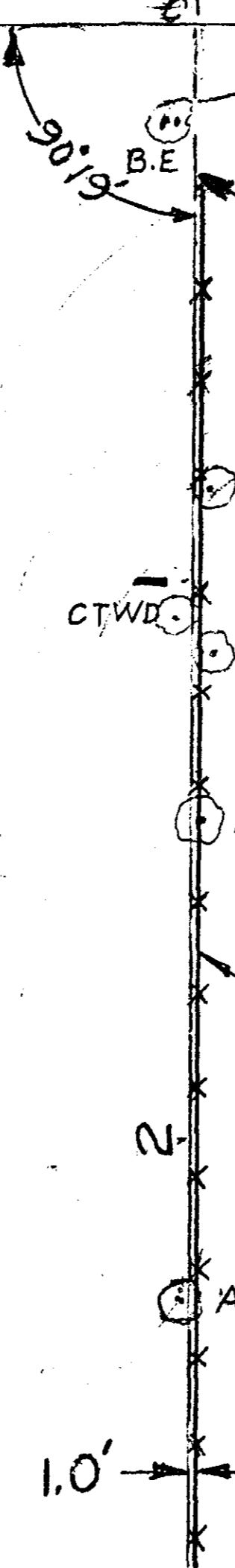

PROFILE PROPOSED FENCE

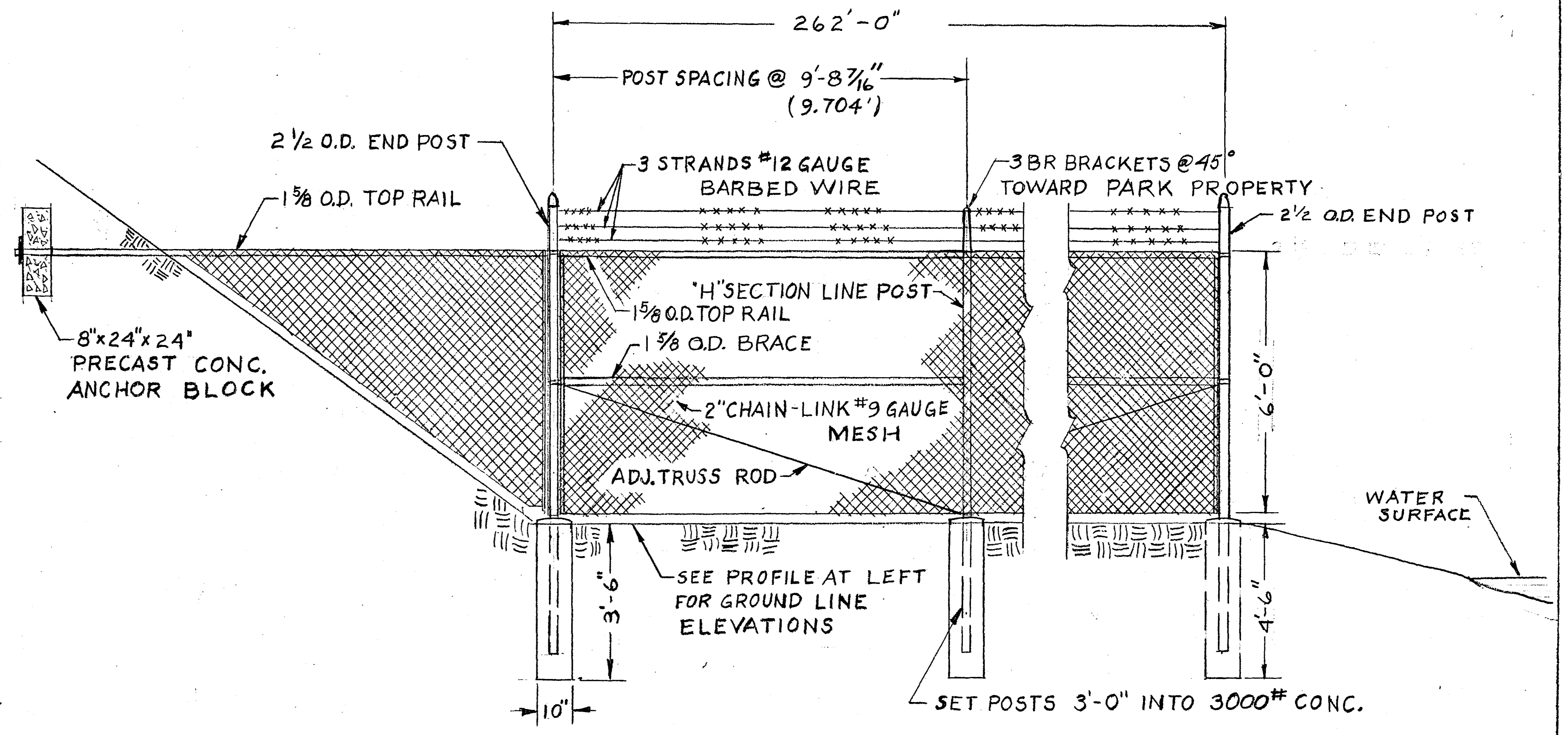

TYPICAL ELEVATION OF PROPOSED FENCE
SCALE: 3/8" = 1'-0"

PROPOSED CHAIN LINK FENCE
FOR
GERVAIS PARK
RAMSEY COUNTY ENGINEERING DEPT.
BY G.H.J. SCALE: 1"=50.0' 6-19-62