

OFFICE OF
 RAMSEY COUNTY ENGINEER
 HARRY S. BRONSON
 PROFILE LEVELS
 DITCH NO. 17

MAY 1958 SCALE AS SHOWN

(Original profile R660)

R-738

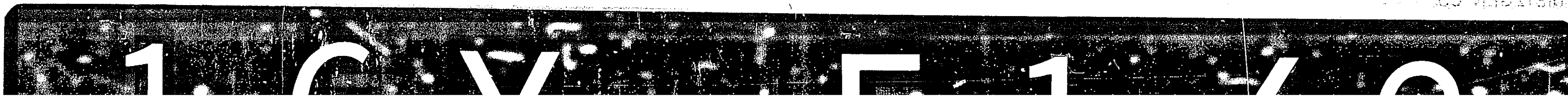

*Plan of
with Runway*

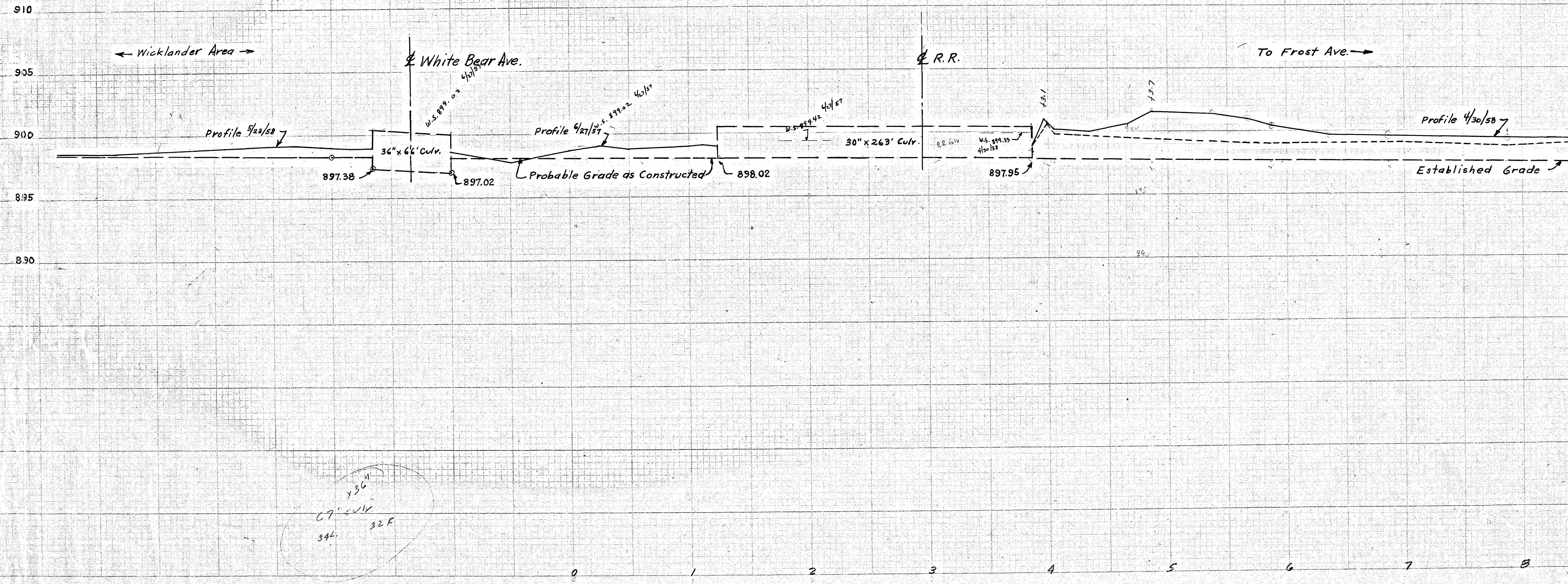

*36" x 36"
C7' SWIV.
34L 32 F*



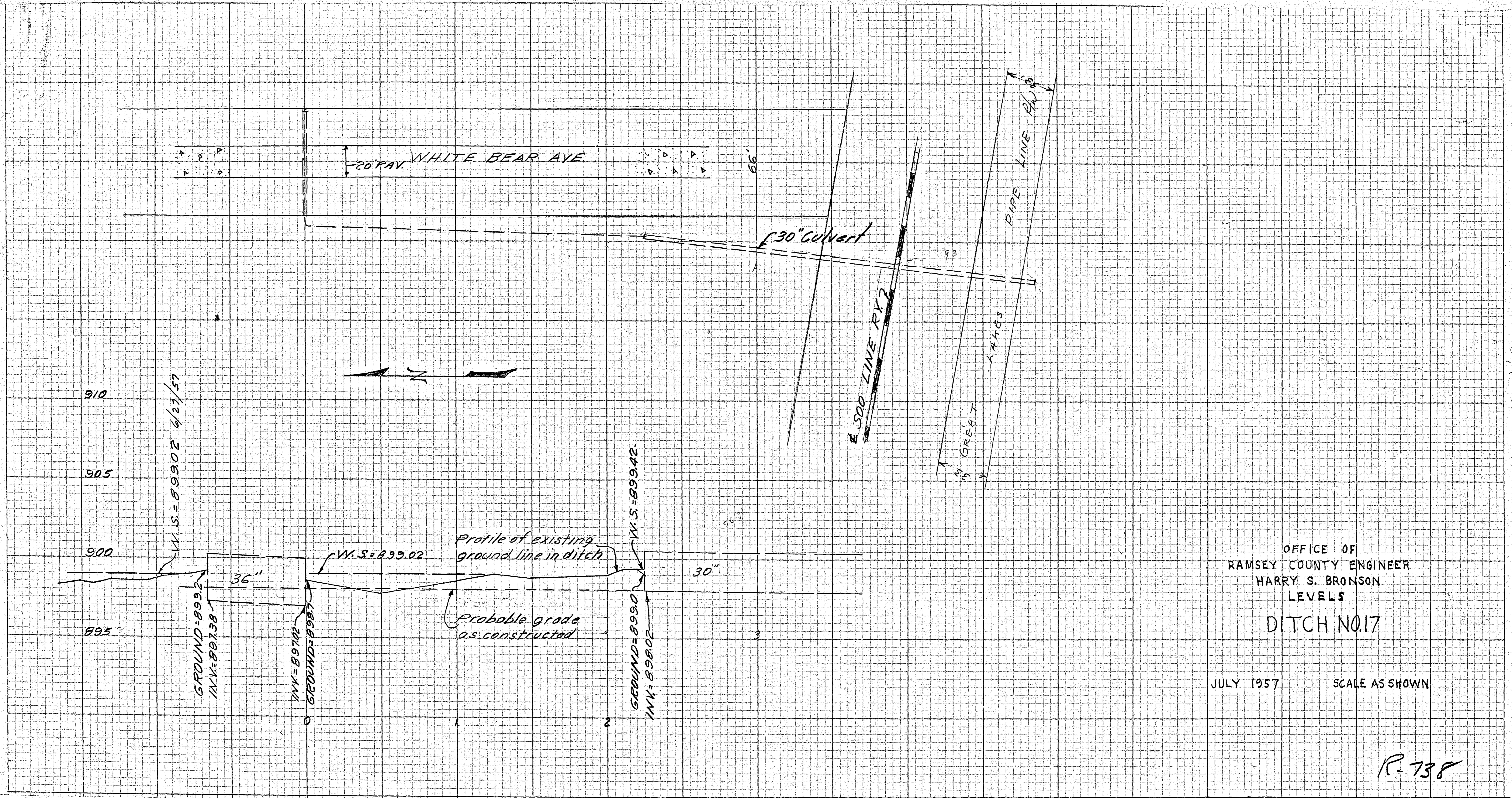

OFFICE OF
 RAMSEY COUNTY ENGINEER
 HARRY S. BRONSON
 LEVELS
 DITCH NO. 17

JULY 1957

SCALE AS SHOWN

R-738

R-738
 Ditch #17
 R-738

5279

NO.	DATE	BY
1	4-30-58	J.M.
SURVEY		
LIMIT		

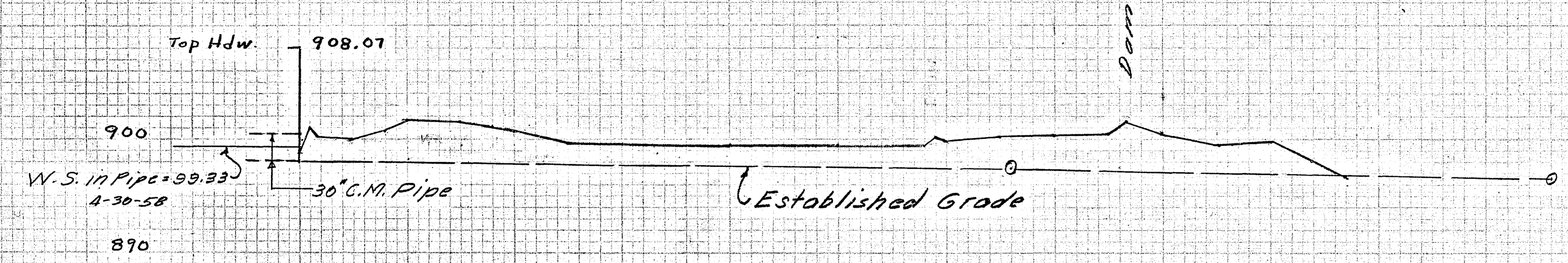

Ground = 98.9

897.95	+1.0	+79
898.0	+1.0	
898.5	+1.4	+80
00.6	01.6	+50
00.6	01.4	+80
00.7	01.0	+50
00.7	00.4	
99.7		
99.6		
99.4		
99.3		
99.5	+1.8	
99.4		
00.1	+50	
00.2		
00.5	+50	
01.48	+68	
00.5		
99.6		+50
99.8		
98.0		+38
96.81		+70

R-738

FROST AVE.

MARYKNOLL AVE.

PROSPERITY AVE.

W.S. Wakefield Lake

OFFICE OF
RAMSEY COUNTY ENGINEER
HARRY S. BRONSON
LEVELS

DITCH NO. 17

MAR. 1954

SCALE AS SHOWN

R-738

R-738

R-738

R-738

MAP
CROSS SECTION
SCALE 1" = 20'

MADE IN U.S.A.
100% RAYON
CROSS SECTION
SCALE 1" = 20'



16 Y E 272



STANDARD MARK
KENTZEL & ESSER CO.
NEW YORK

KENTZEL & ESSER CO.
NEW YORK

STANDARD MARK
KENTZEL & ESSER CO.
NEW YORK

R-738