

487-9

OFFICE OF  
RAMSEY COUNTY SURVEYOR  
HARRY S. BRONSON

SKETCH SHOWING PRESENT BUILDING SET-BACKS  
ALONG EAST SIDE OF SNELLING AVENUE

SCALE 1 IN. = 60 FT.

JANUARY 1953

SNELLING

AVENUE

EAST RIGHT OF WAY LINE

AVE.

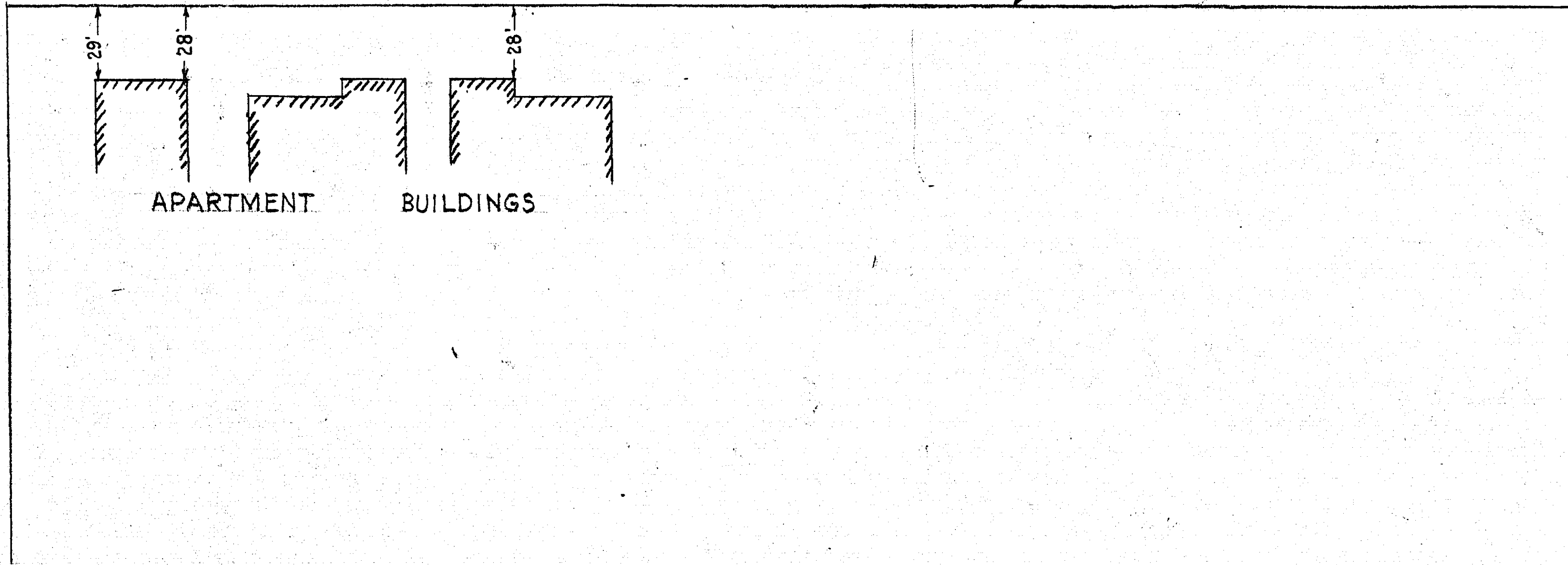

IDAHO

AVE.

LARPEUR

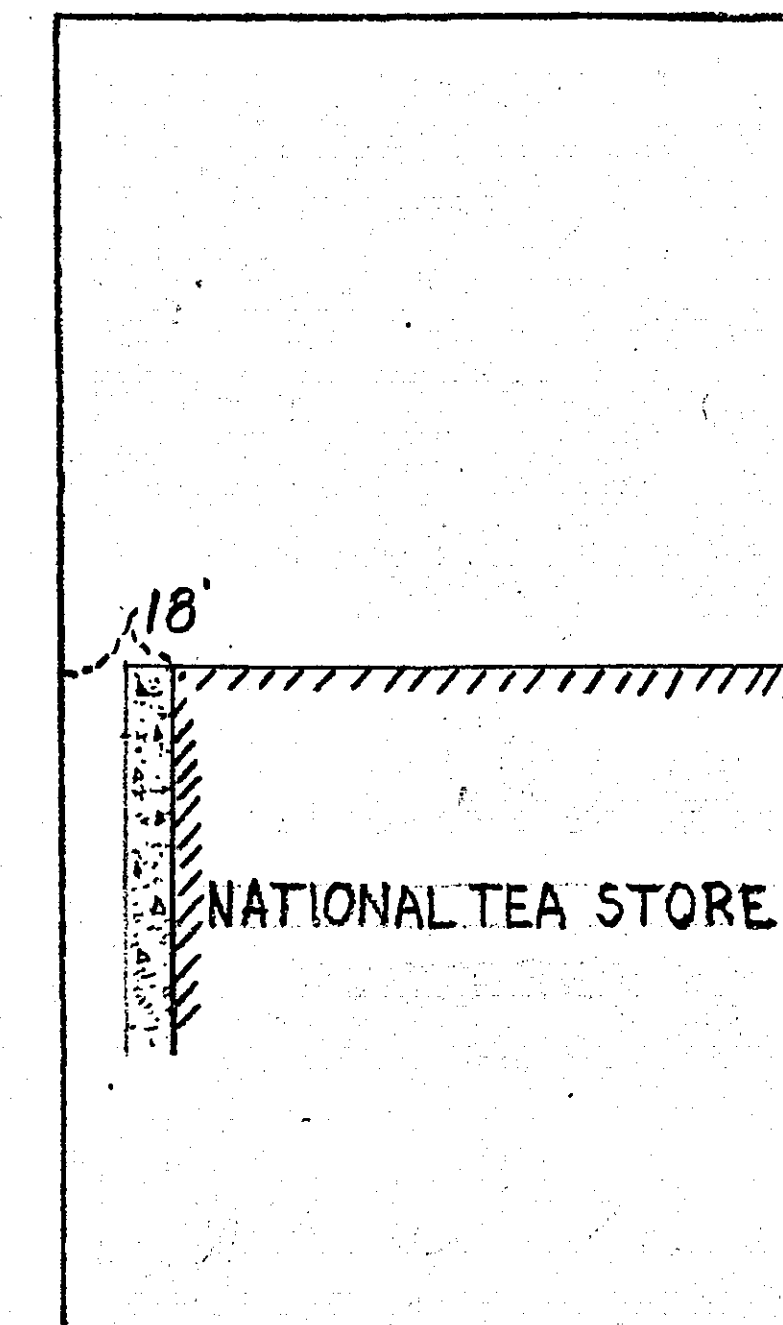

AVE.

CRAWFORD

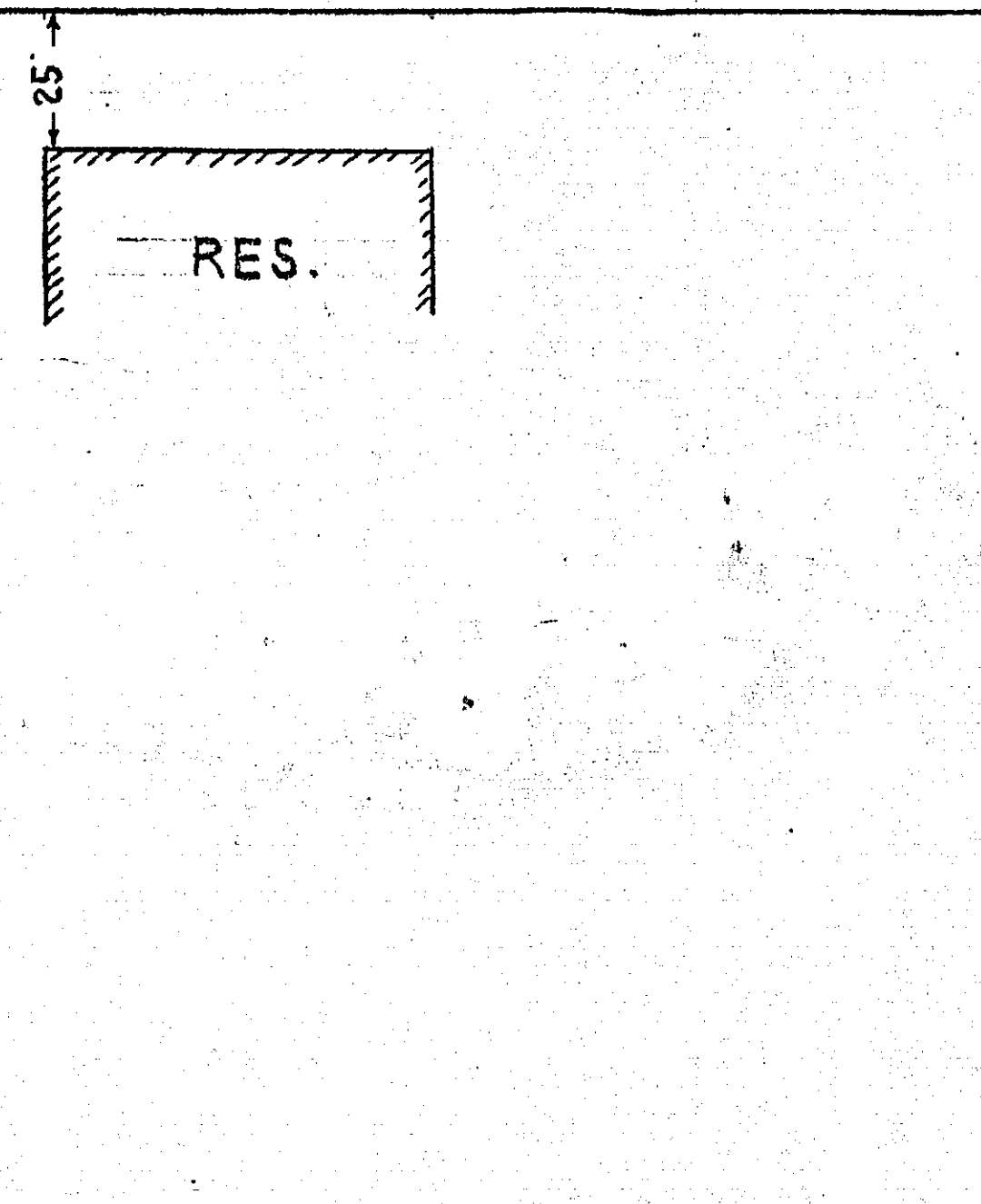
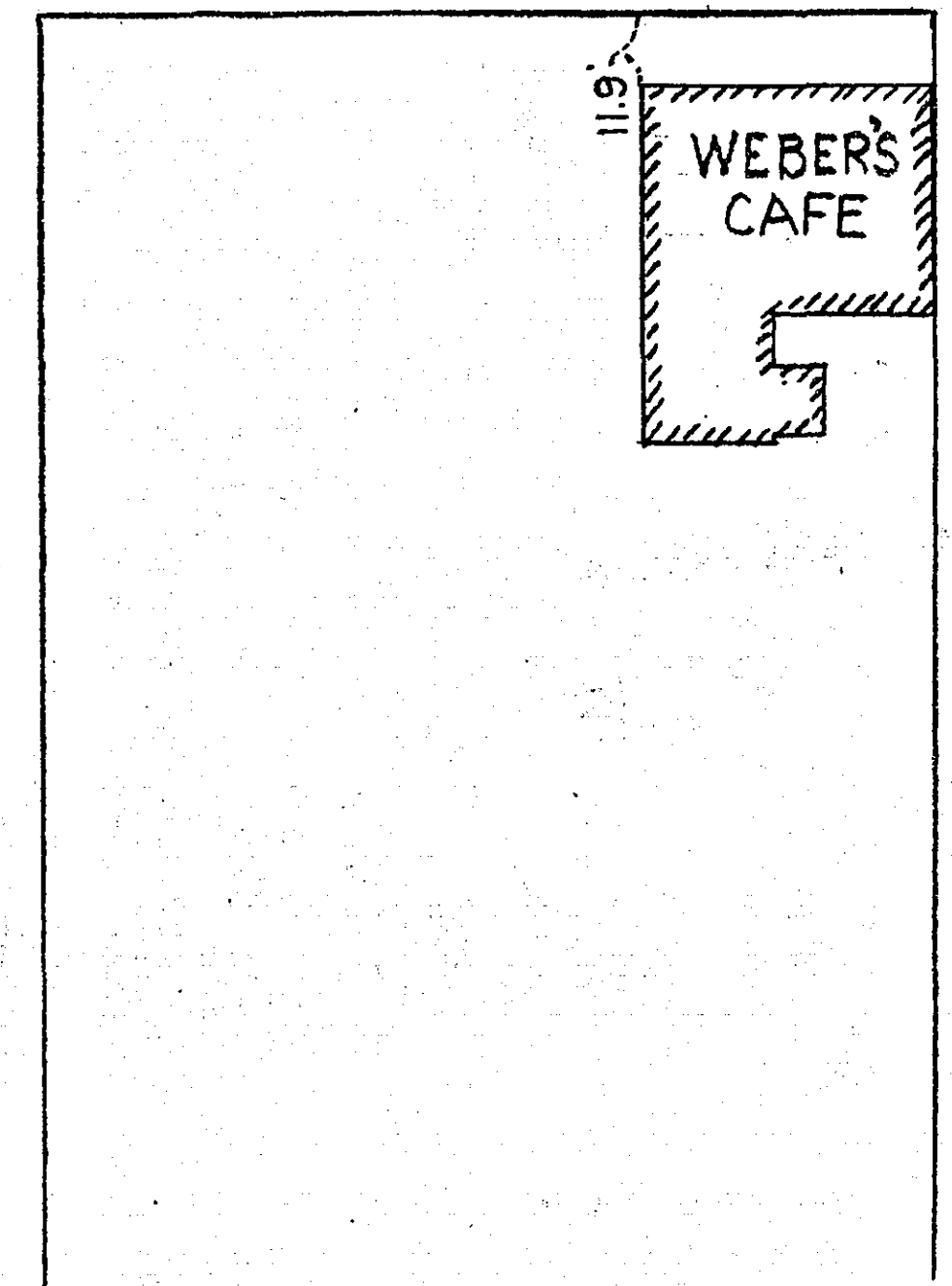

R-734