

SOUTH-EASTERN PORTION
RAMSEY COUNTY

1860

MICROFILMED
RAMSEY CO. ENGR.

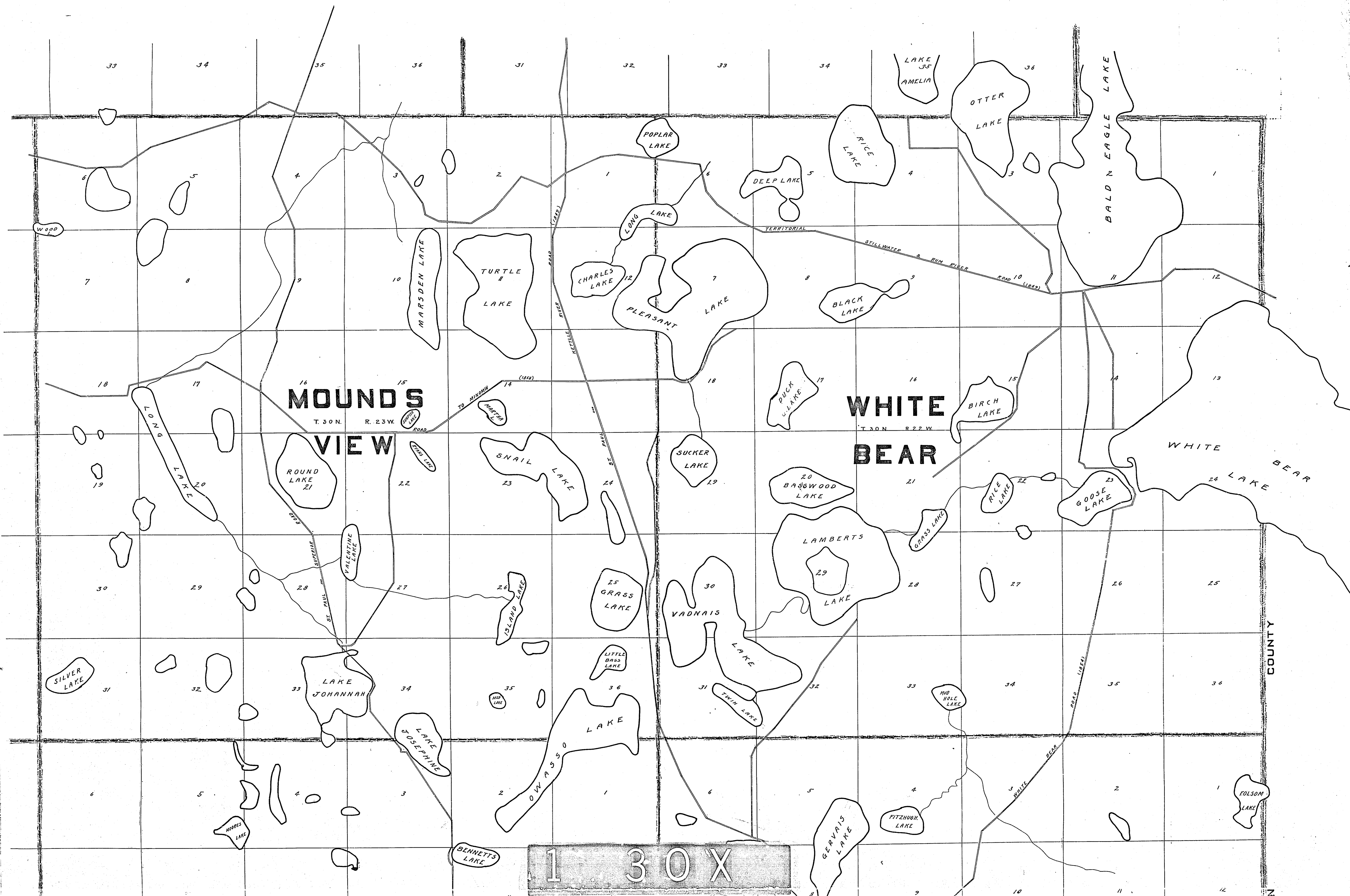

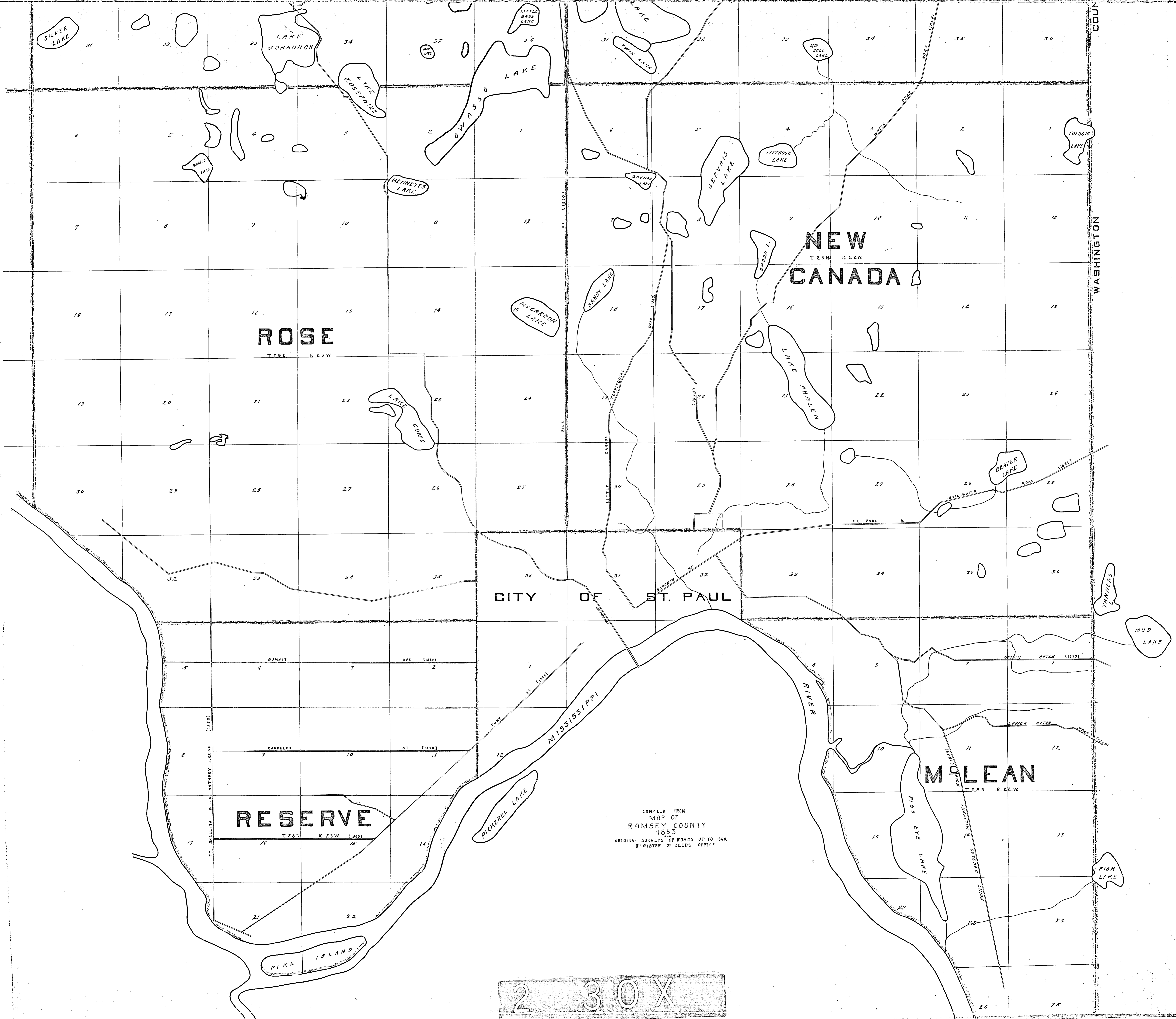

WASHINGTON COUNTY

NEW CANADA
T. 29N. R. 22W.

ROSE
T. 29N. R. 23W.

CITY OF ST. PAUL

RESERVE
T. 28N. R. 23W. (1860)

McLEAN
T. 28N. R. 22W.

COMPILED FROM
MAP OF
RAMSEY COUNTY
1853
ORIGINAL SURVEYS OF ROADS UP TO 1860.
REGISTER OF DEEDS OFFICE.

2 30 X