

KOHLMAN
LAKE

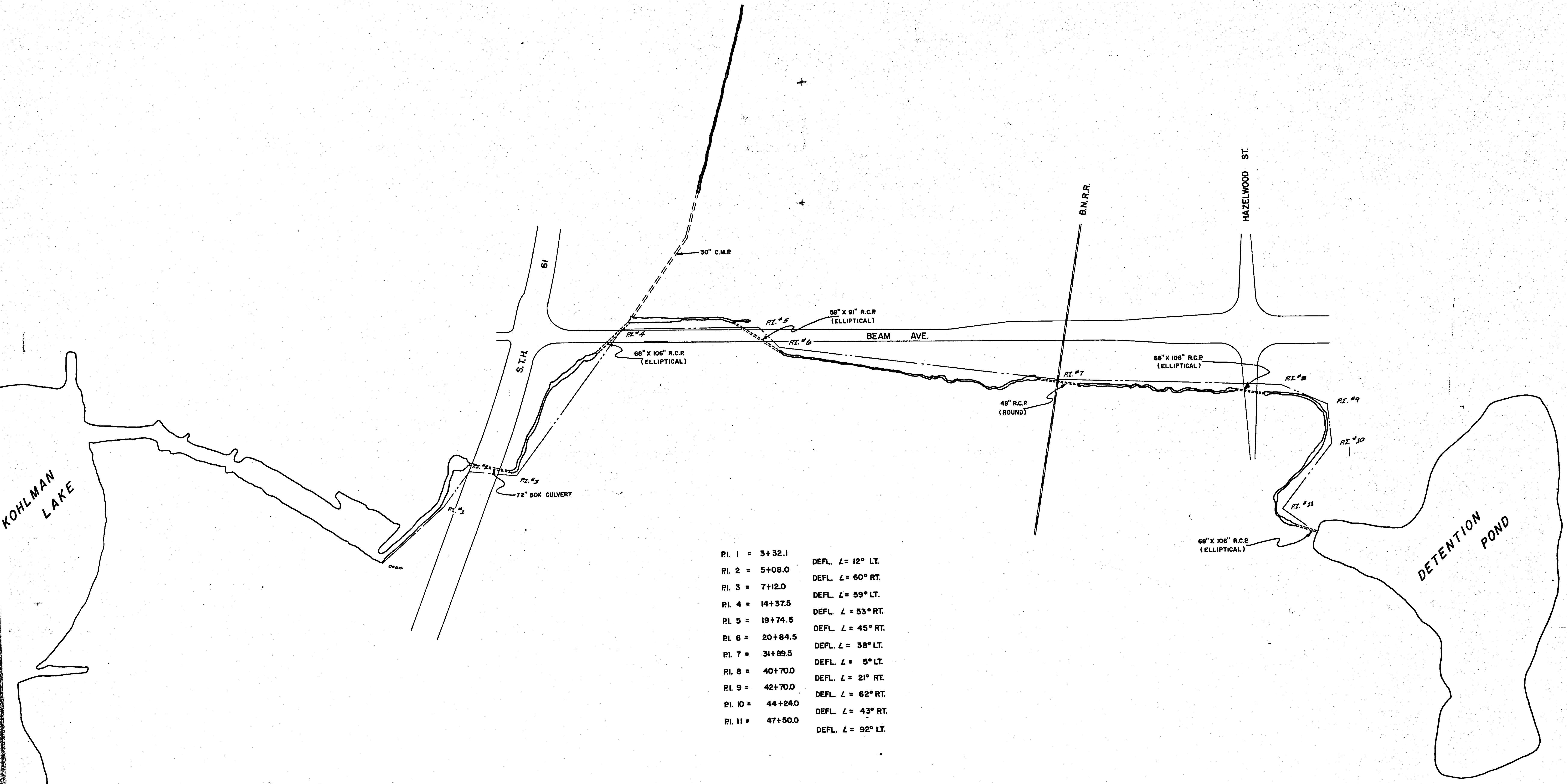

PI. 1 = 3+32.1	DEFL. \angle = 12° LT.
PI. 2 = 5+08.0	DEFL. \angle = 60° RT.
PI. 3 = 7+12.0	DEFL. \angle = 59° LT.
PI. 4 = 14+37.5	DEFL. \angle = 53° RT.
PI. 5 = 19+74.5	DEFL. \angle = 45° RT.
PI. 6 = 20+84.5	DEFL. \angle = 38° LT.
PI. 7 = 31+89.5	DEFL. \angle = 5° LT.
PI. 8 = 40+70.0	DEFL. \angle = 21° RT.
PI. 9 = 42+70.0	DEFL. \angle = 62° RT.
PI. 10 = 44+24.0	DEFL. \angle = 43° RT.
PI. 11 = 47+50.0	DEFL. \angle = 92° LT.

ENV 10
1 of 16

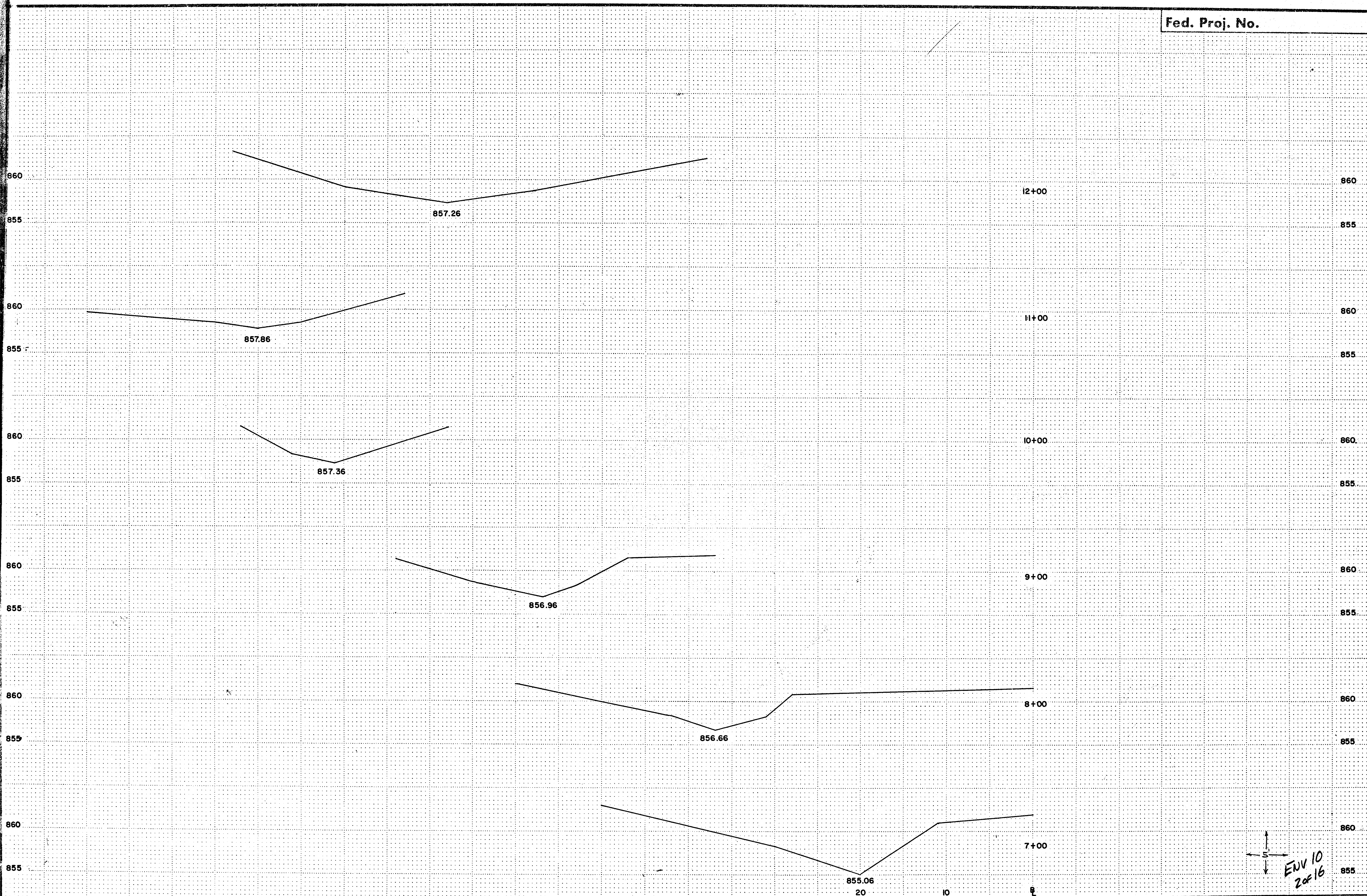

5' ↑
↓
ENV 10
2 of 16

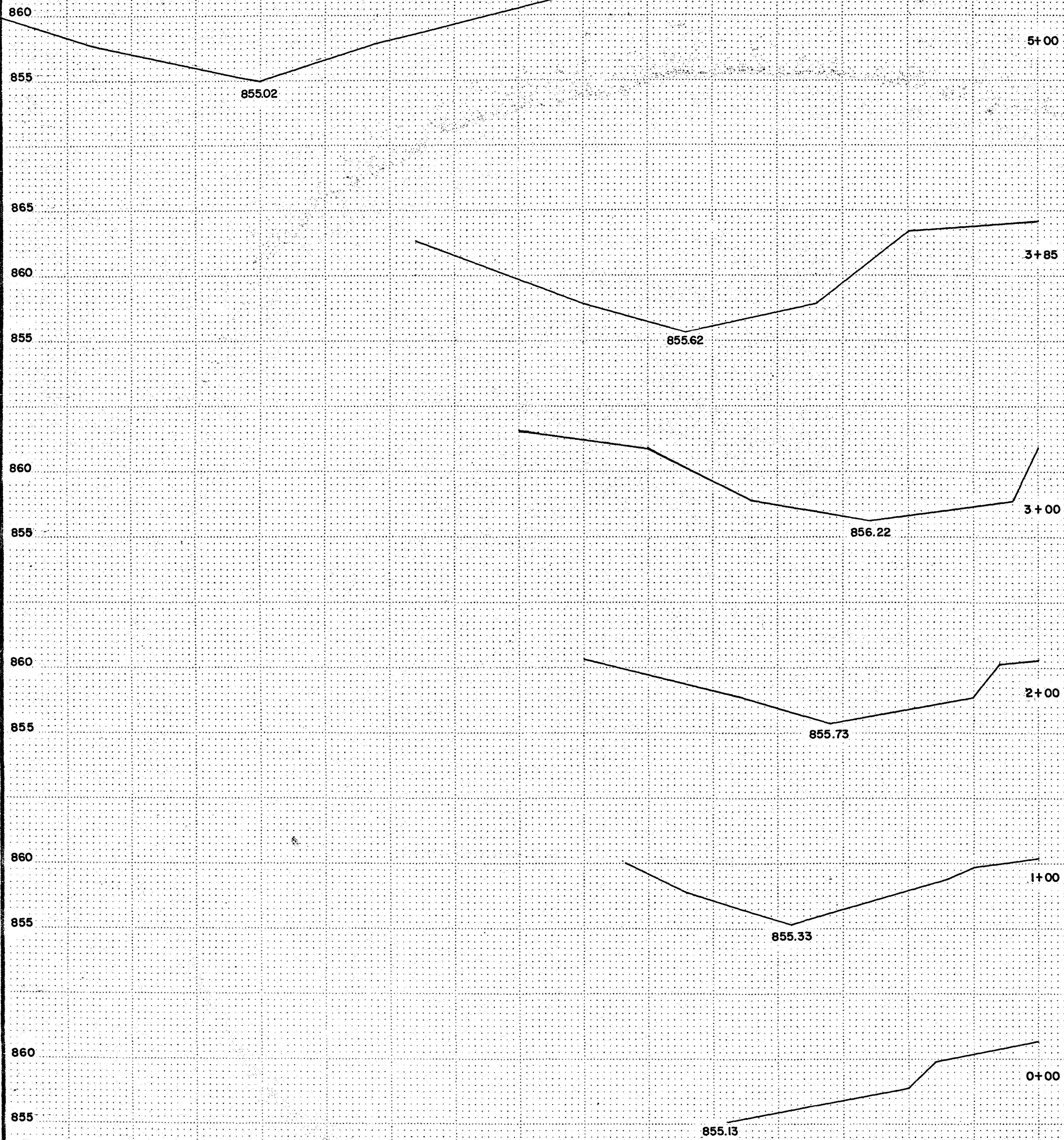

ENV 10
3 of 16

City Equipment Form #1

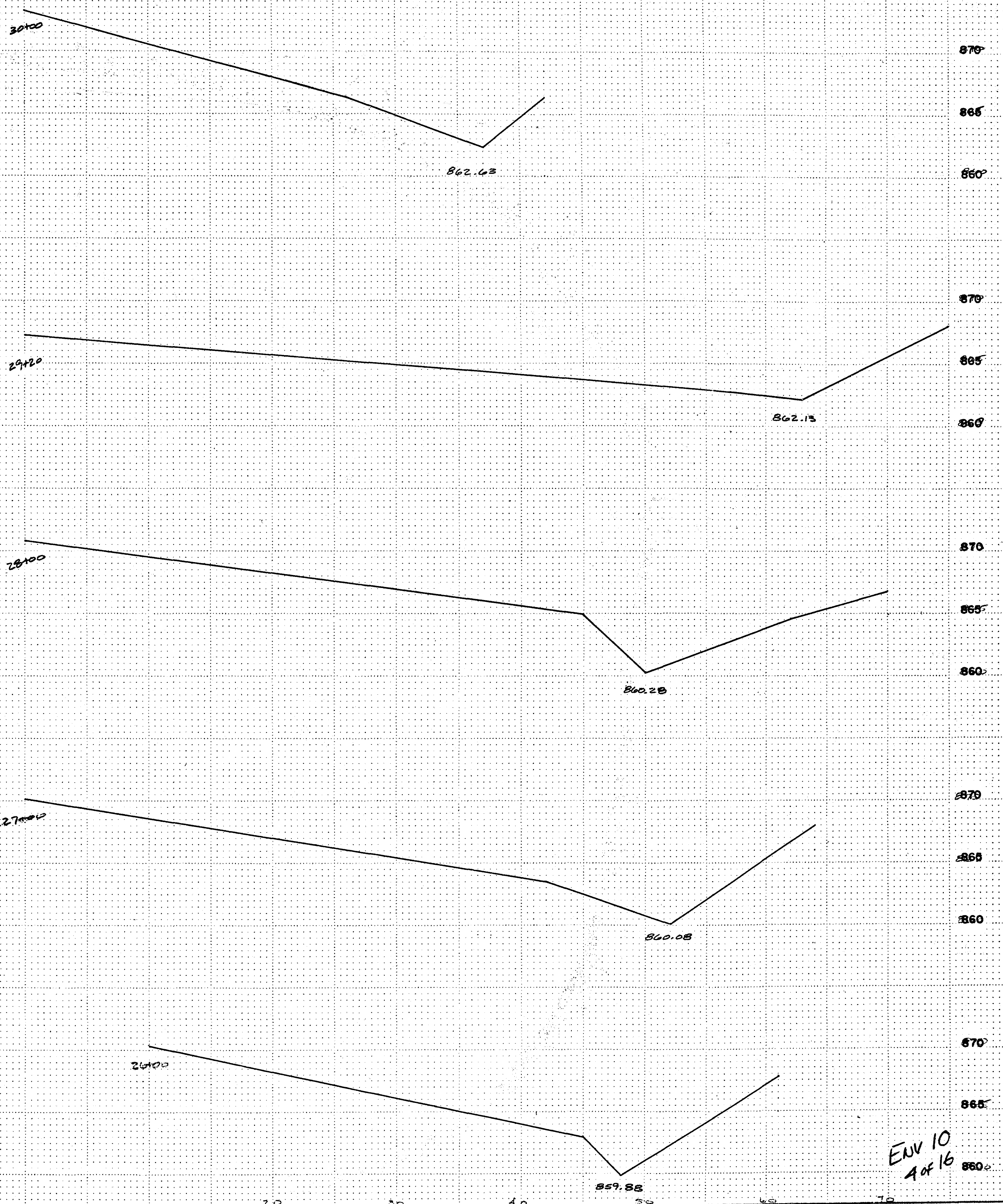

ENV 10
4 of 16

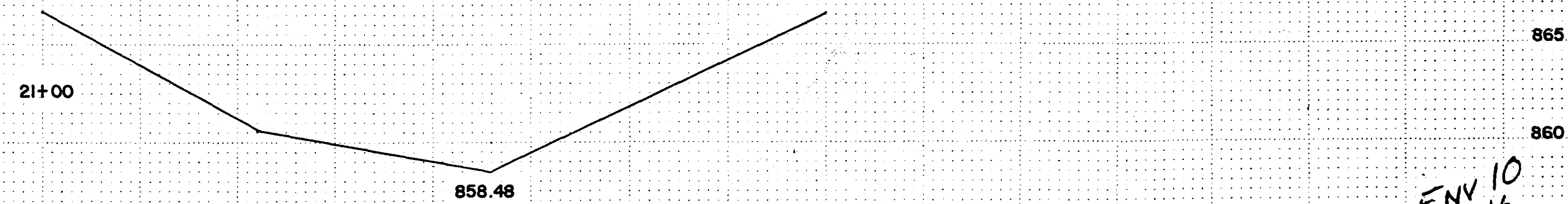
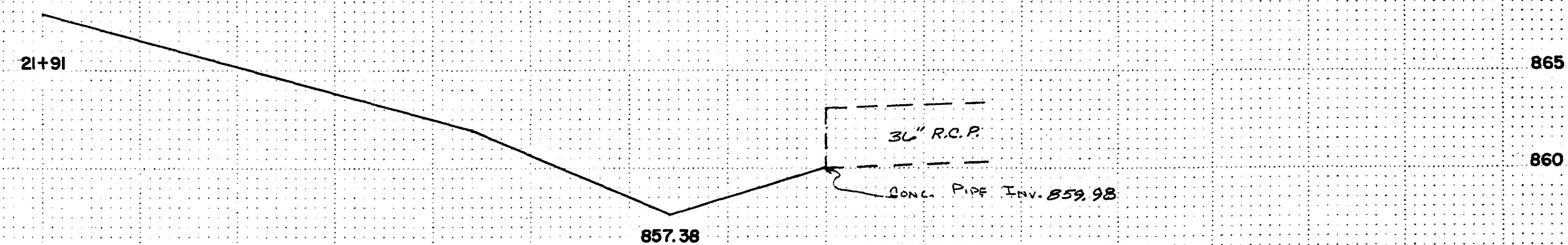
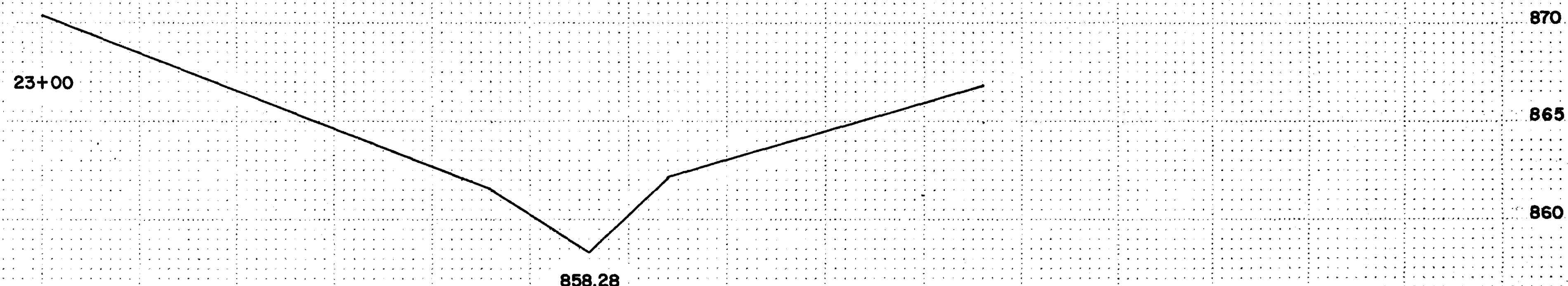
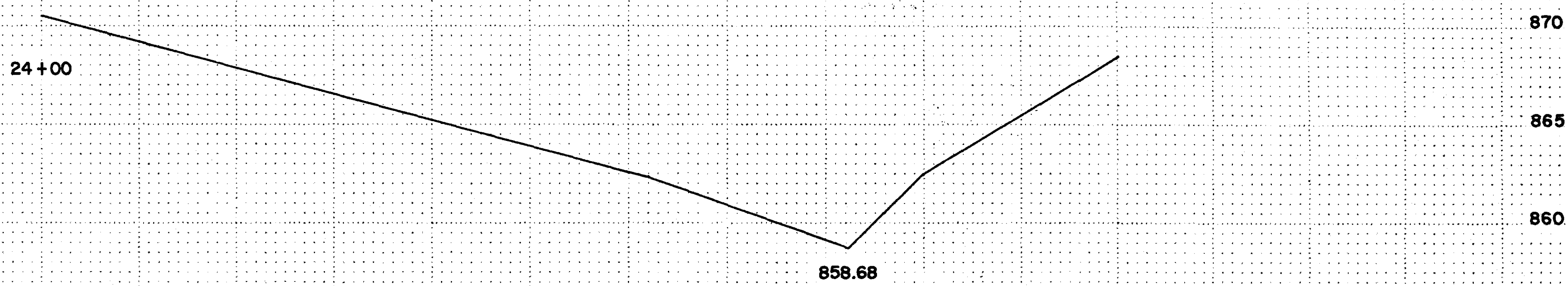

ENV 10
5 OF 16

City Engineer Form 21

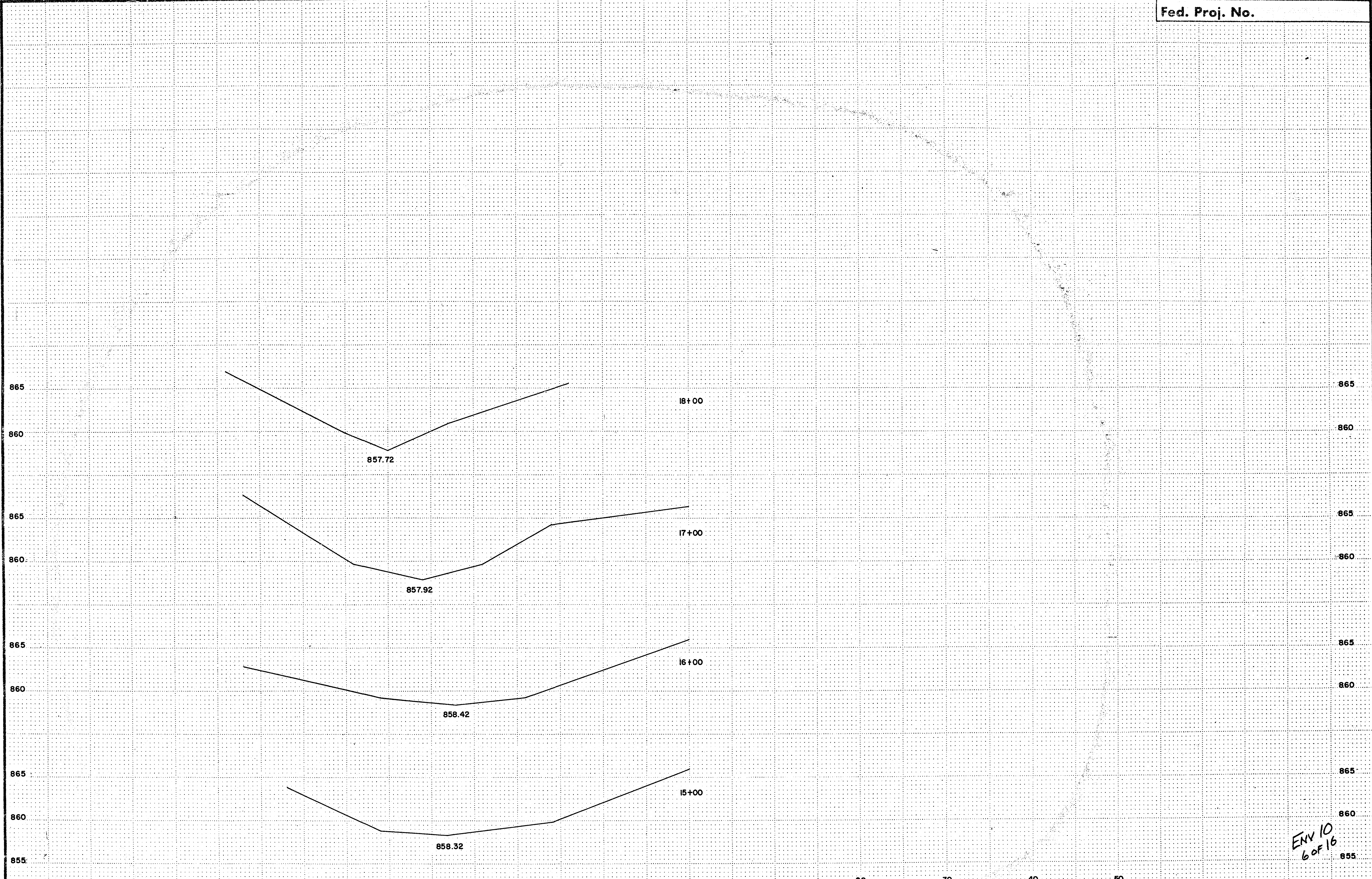

ENV 10
6 of 16

Low Equipment Form #1

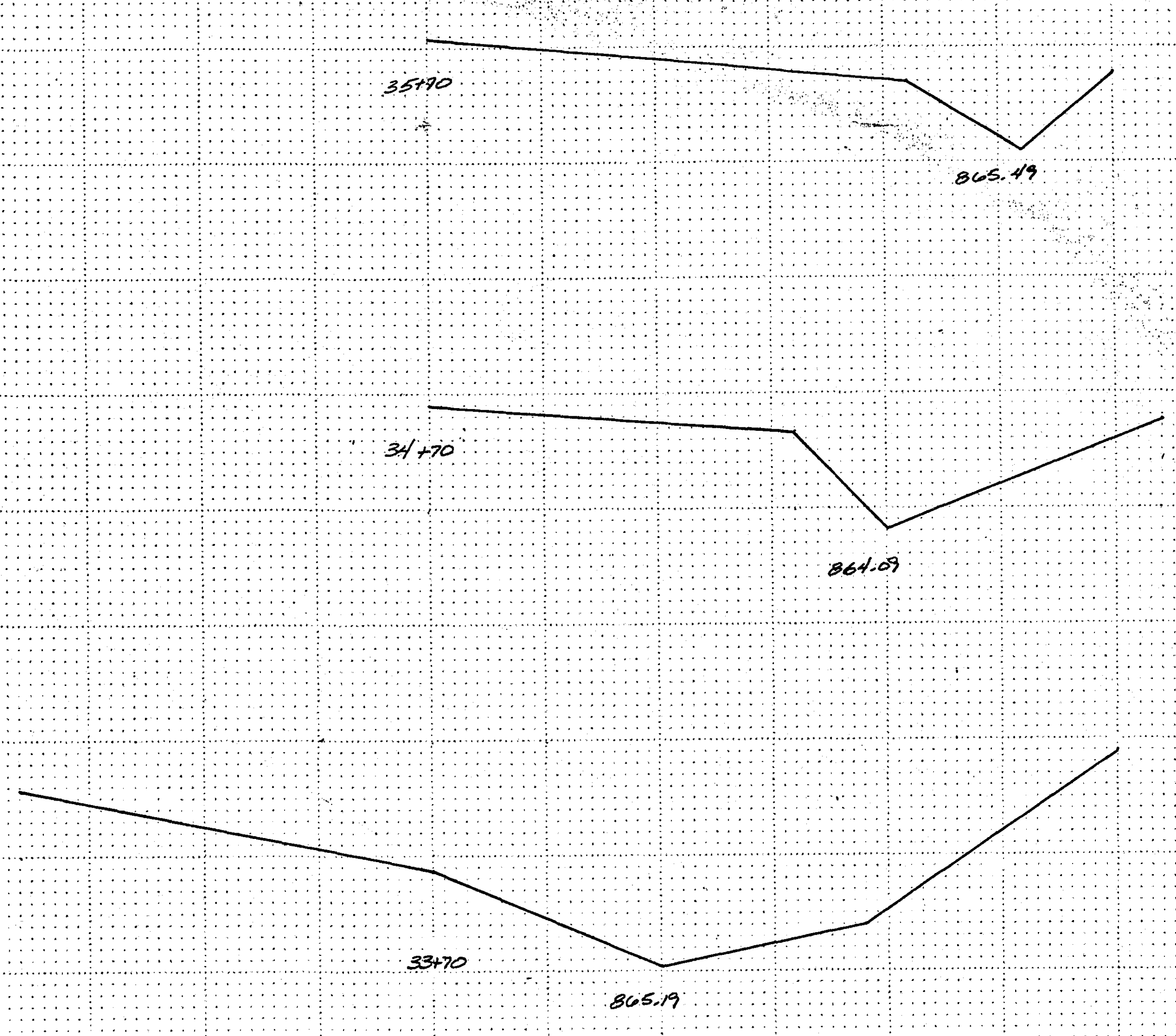

870
865
870
865
875
875
865

ENV 10
7 of 16

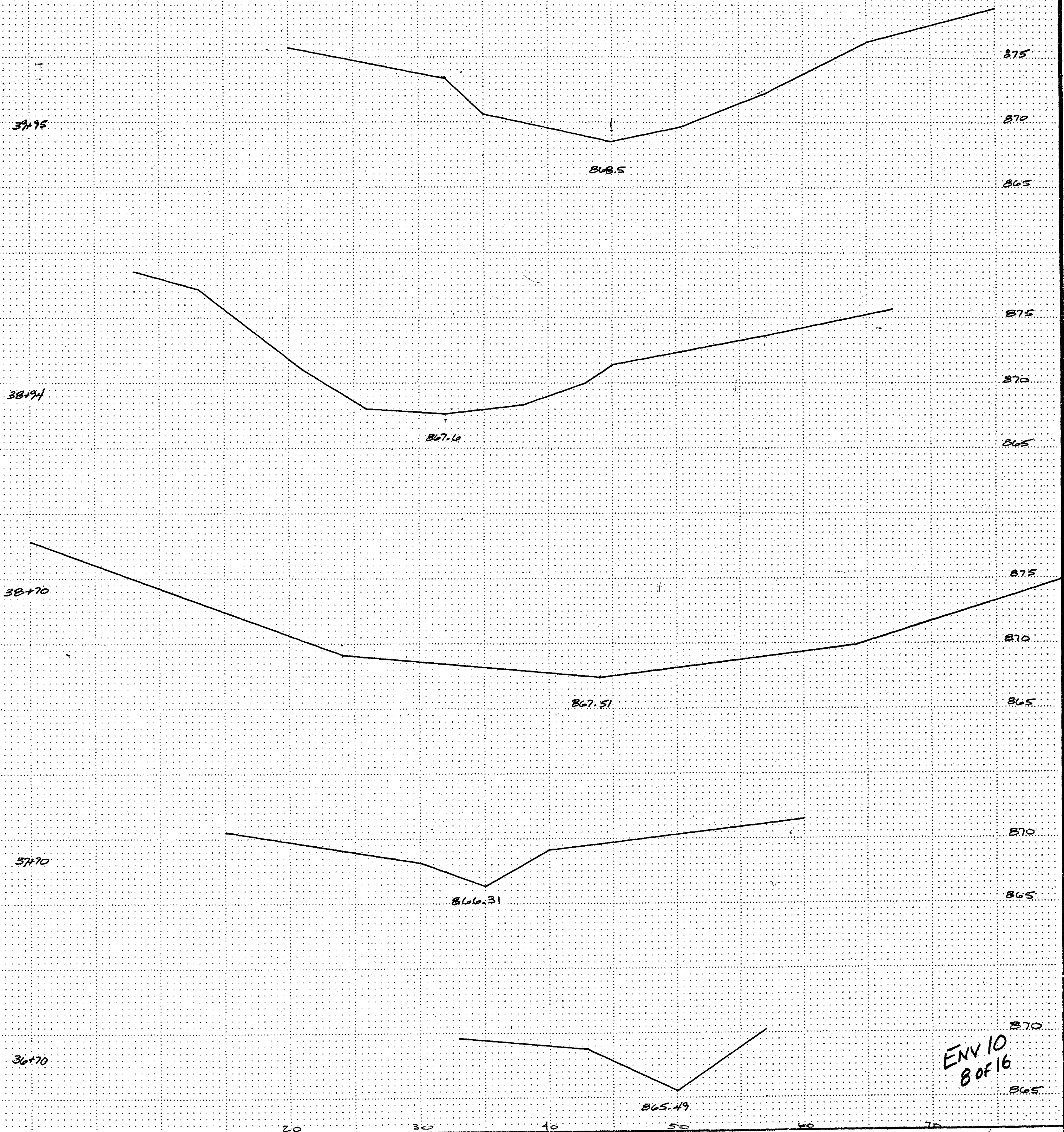

ENV 10
B0F16

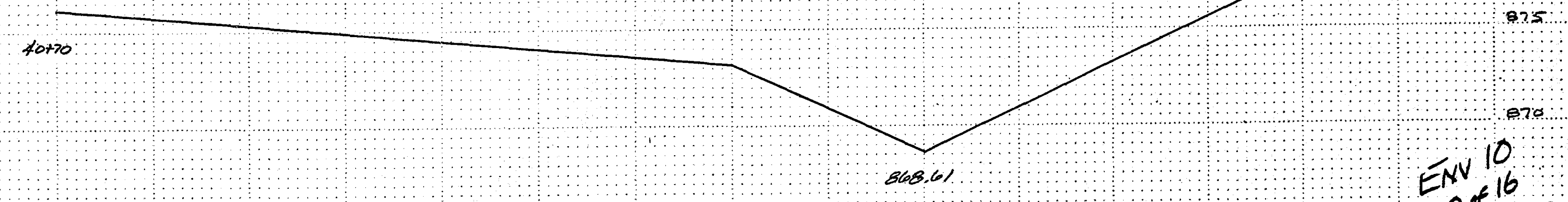
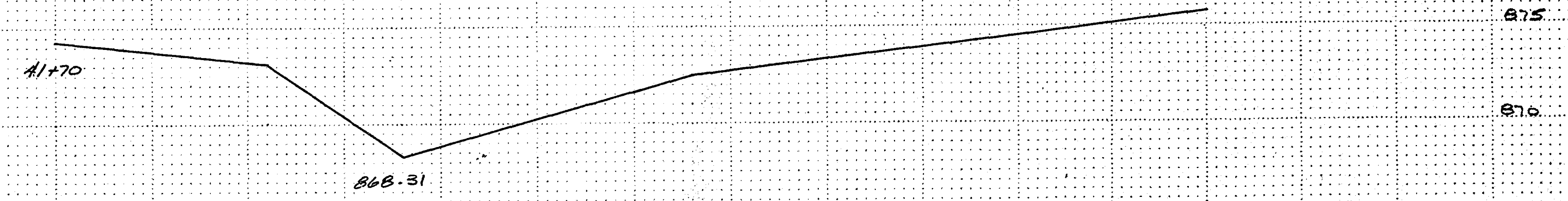
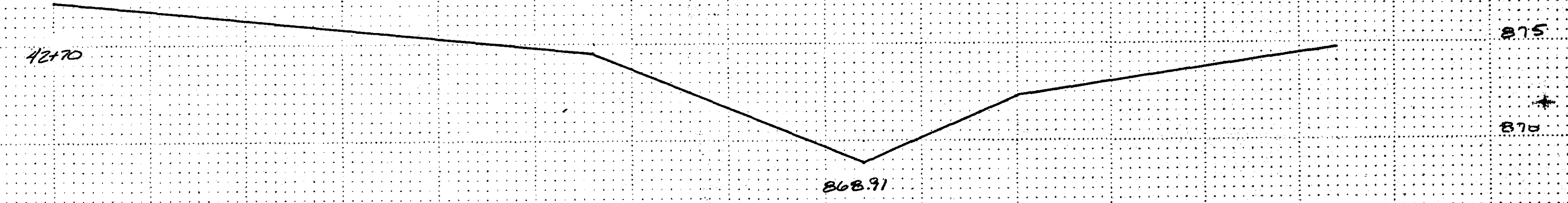
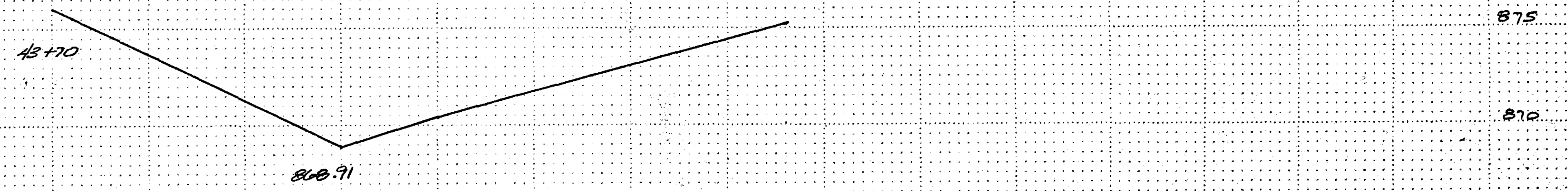
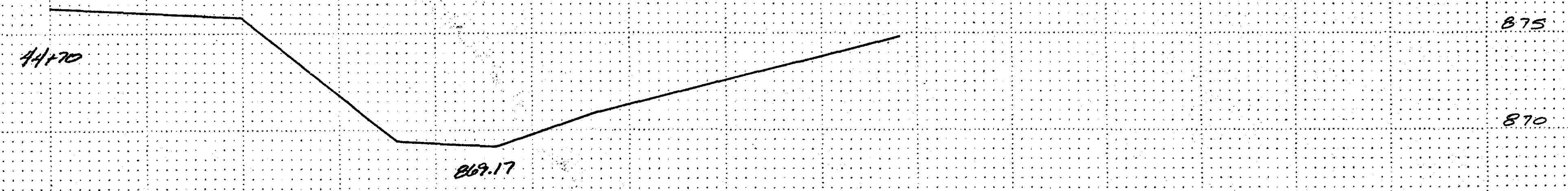
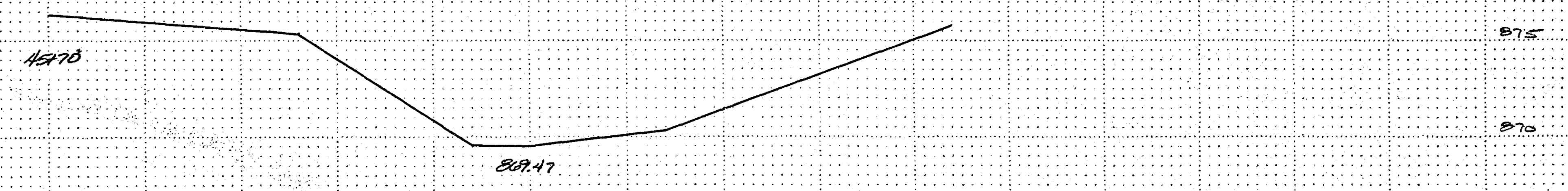

ENV 10
9 of 16
805

City Engineer's Sign 21

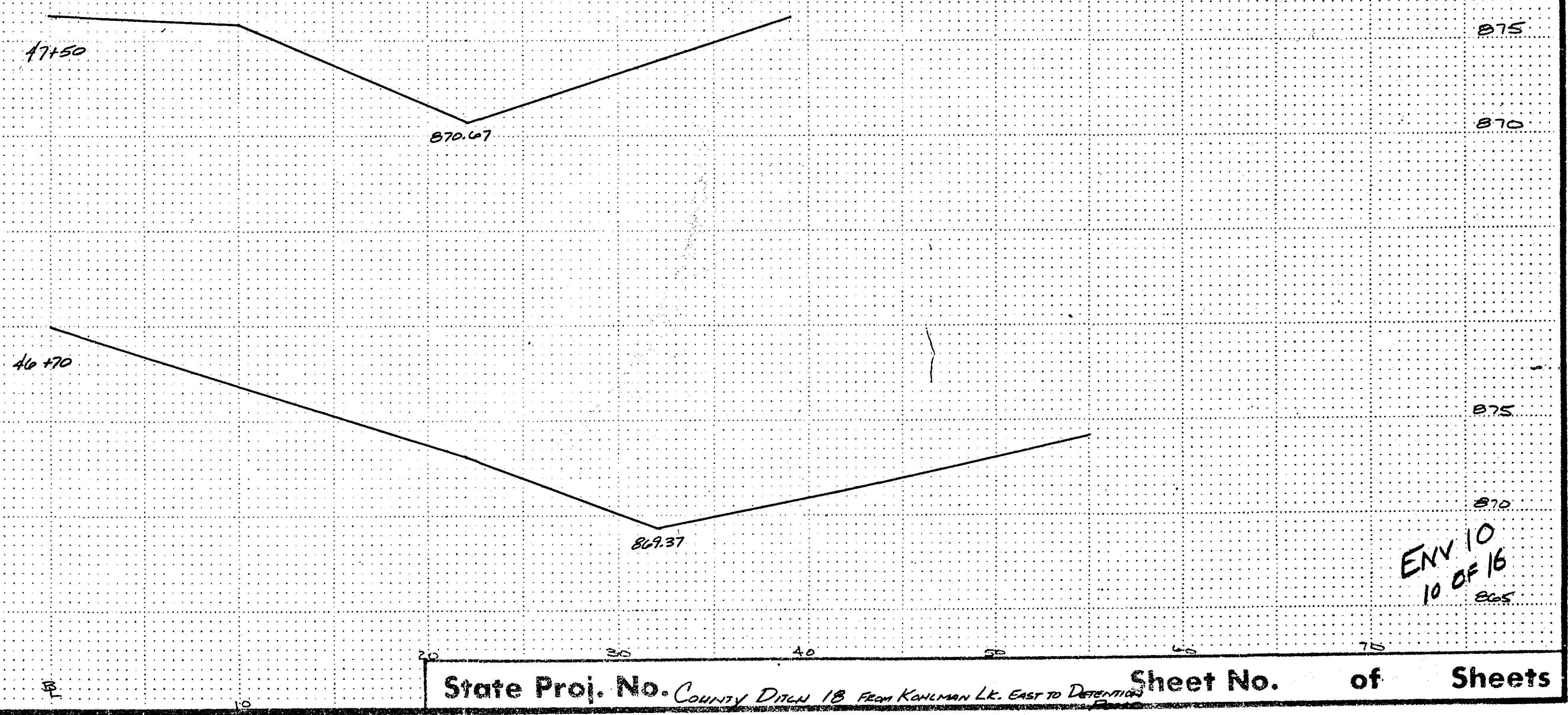

ENV 10
10 OF 16
865

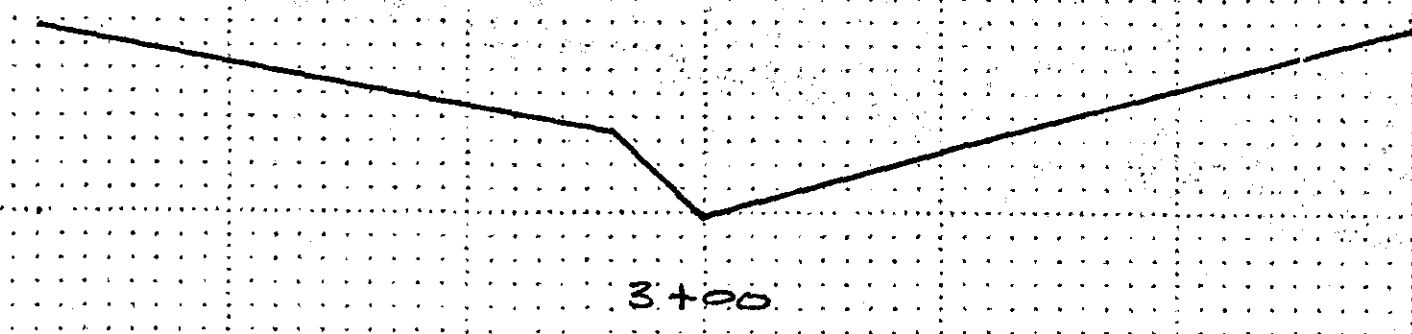

865
860
855

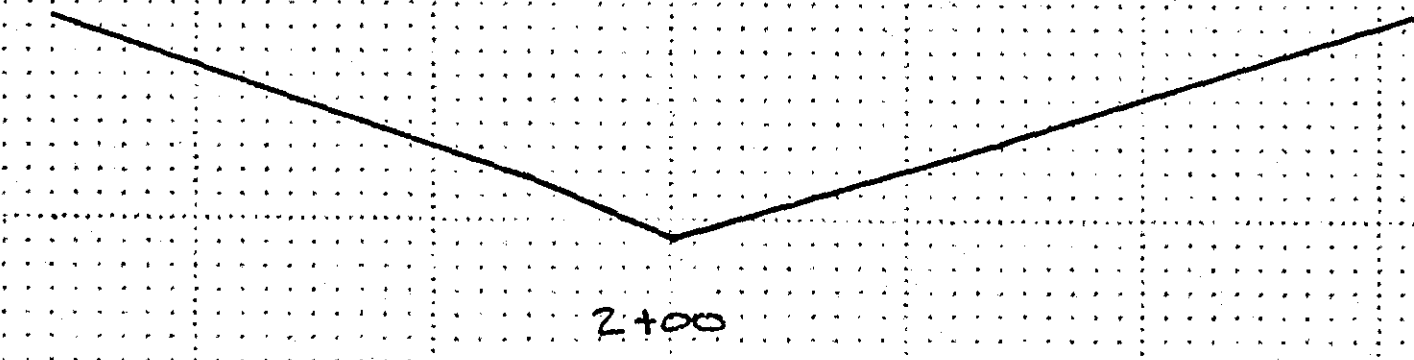

865
860
855

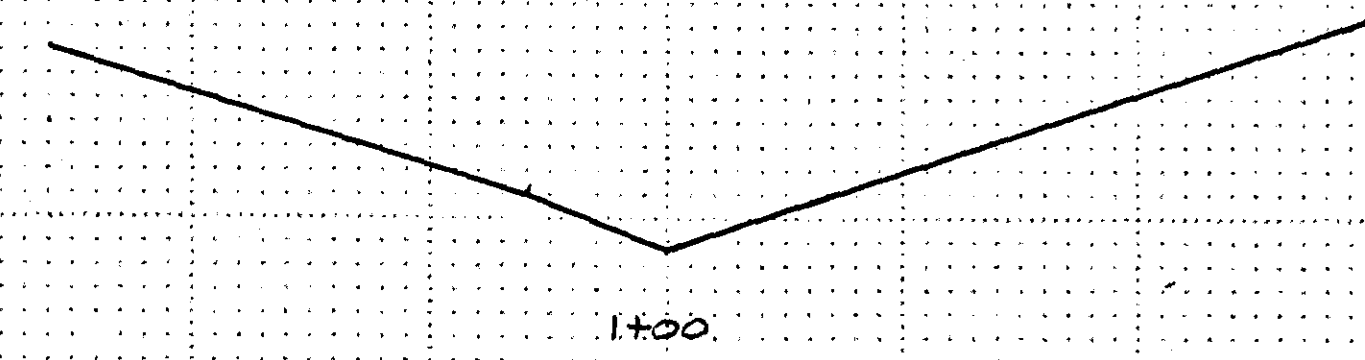

865
860
855

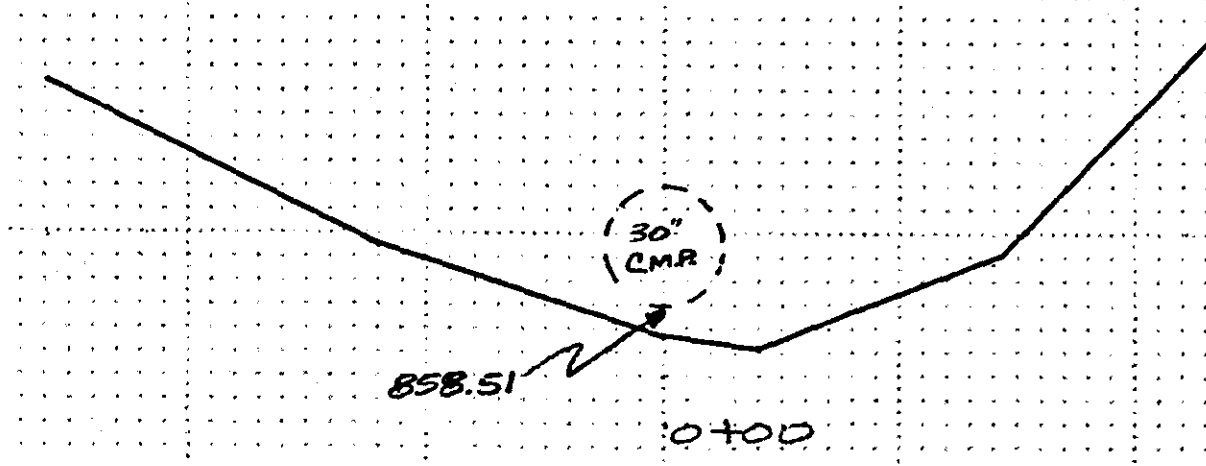

865
860
855

ENV 10
11 of 16

30 20 10 0 10 20 30

905

900

895

905

900

895

900

895

890

900

895

890

900

895

890

2+00

1+50

1+00

0+50

0+03

ENV 10
12 of 16

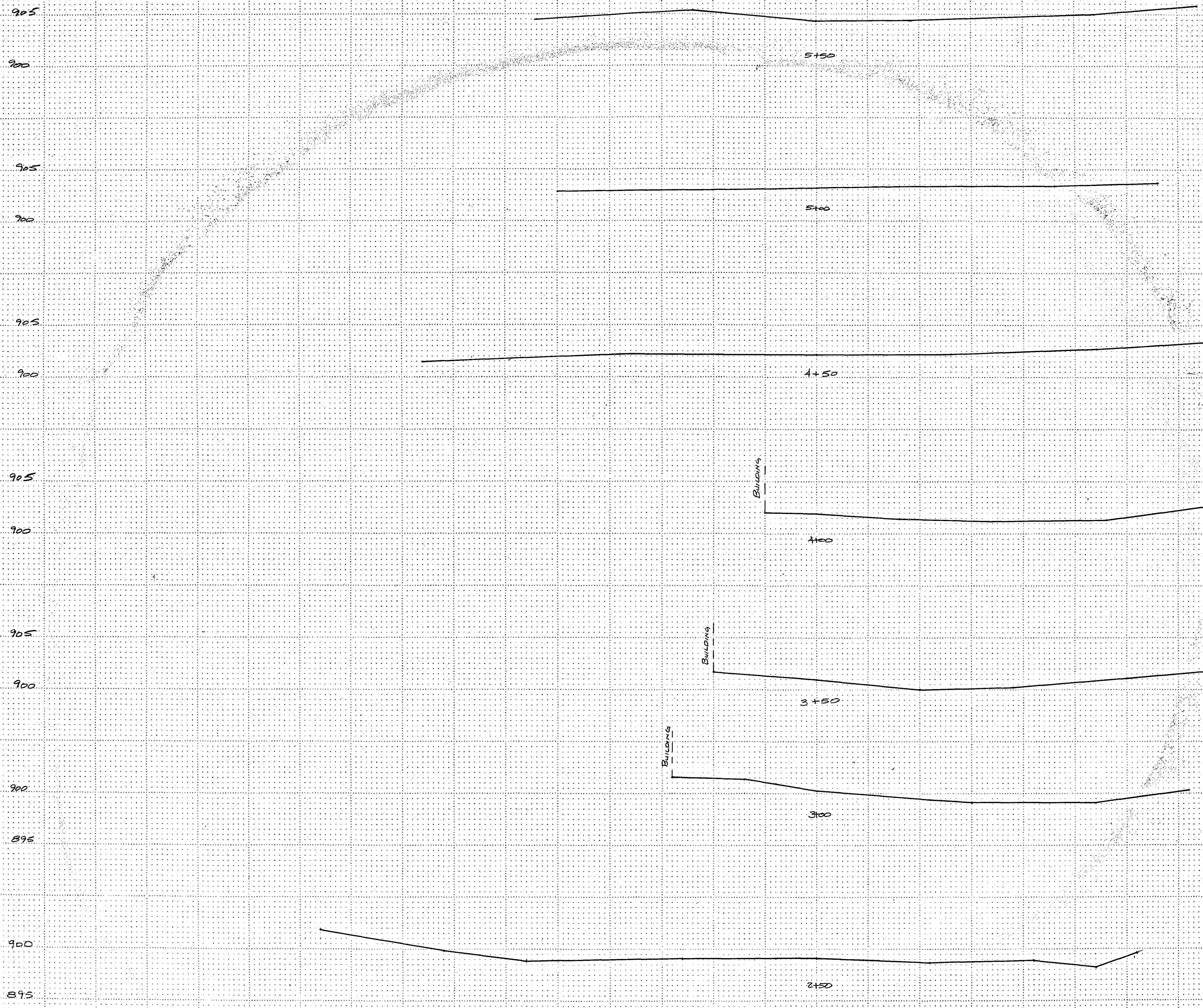

EM 10
13 of 16

910
905
910
905
910
905
910
905
910
905
910
905

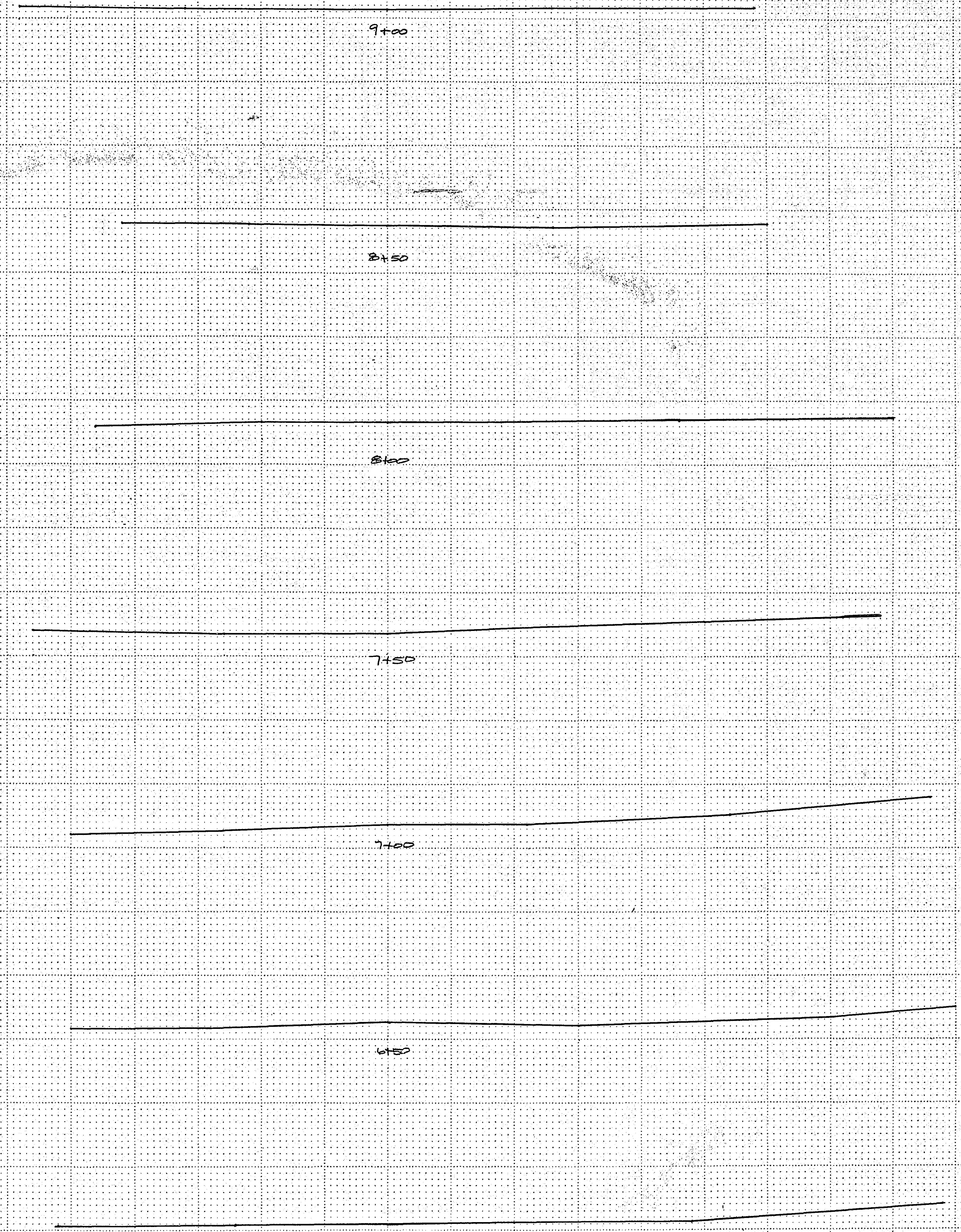

ENV 10
1A OF 16

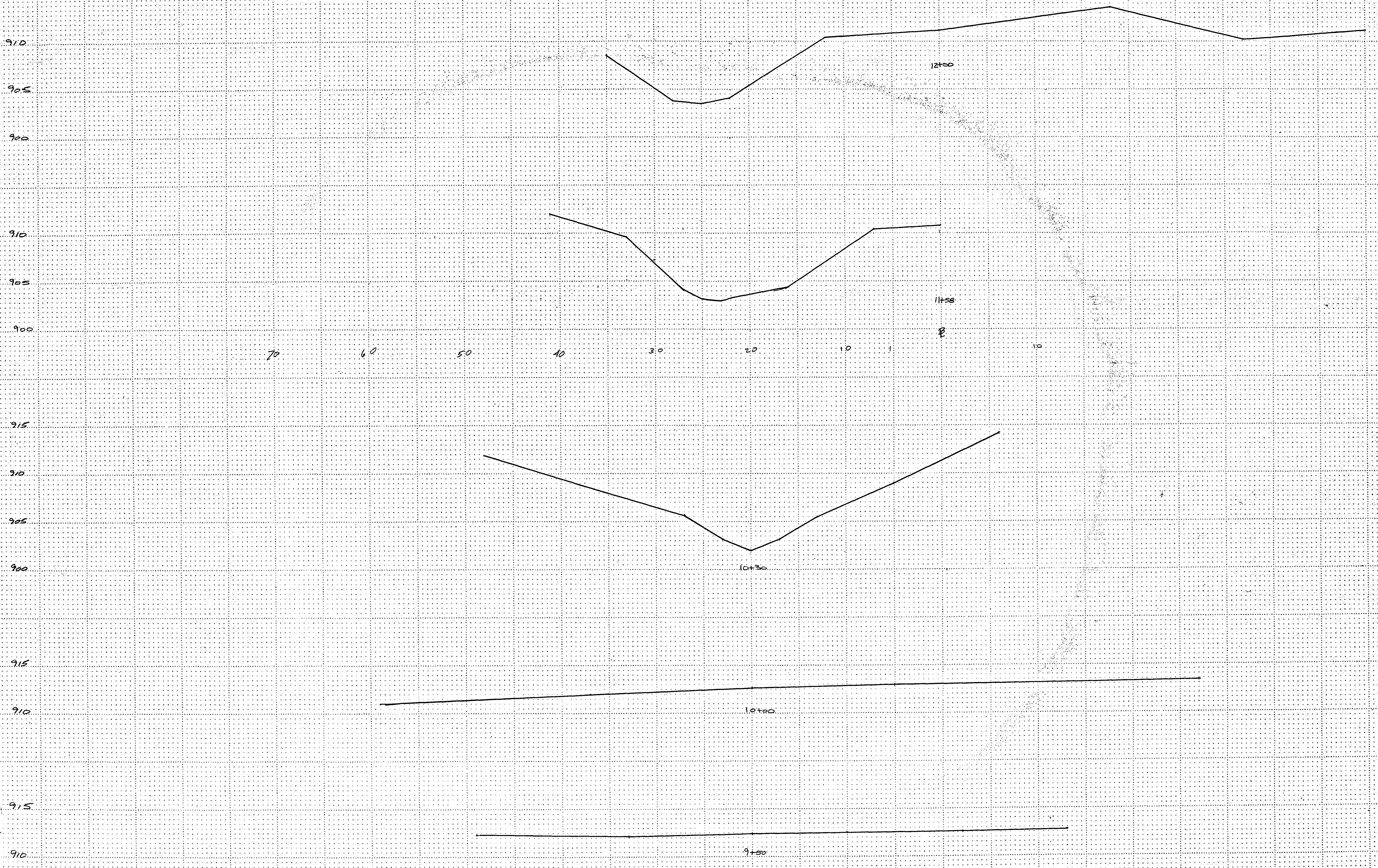

EN 10
15 of 16

910
905
900
910
905
900
910
905
900
910
905
900
910
905
900

MARSH

15+50

15+00

14+00

13+00

12+50

MARSH

70 60 50 40 30 20 10 0 10 20 30 40 50 60 70

ENV 10
16 of 16