

NOTE
Surface entire present asphalt pavement from E Hamline Ave. to Oxford St. with asphalt. See Typical Grading & Paving Section and Special Provisions.

GRADING & PAVING PLANS WIDENING ROADWAY ON UNIVERSITY AVE. FROM HAMLINE AVE. TO OXFORD ST.

Scale: 1" = 40'
Field Books No 1312-1321-1322-1330.
Sheet 1 of 3 Sheets.

- EXPLANATION OF CONVENTIONAL SIGNS USED ON ATTACHED PLANS**
- Construct 2" Asphalt Paving and new Concrete Base where shown on plans by hatched areas.
 - Construct 2 1/2" Brick Paving - 3/4" Oiled Sand Cushion and new Concrete Base where shown on plans by Shaded Areas.
 - Construct 6" Monolithic Concrete Driveways where shown on plans thus.
 - Construct 4" Monolithic Concrete Sidewalk where shown on plans thus.
 - Existing trees.

Book 1312 P.48.

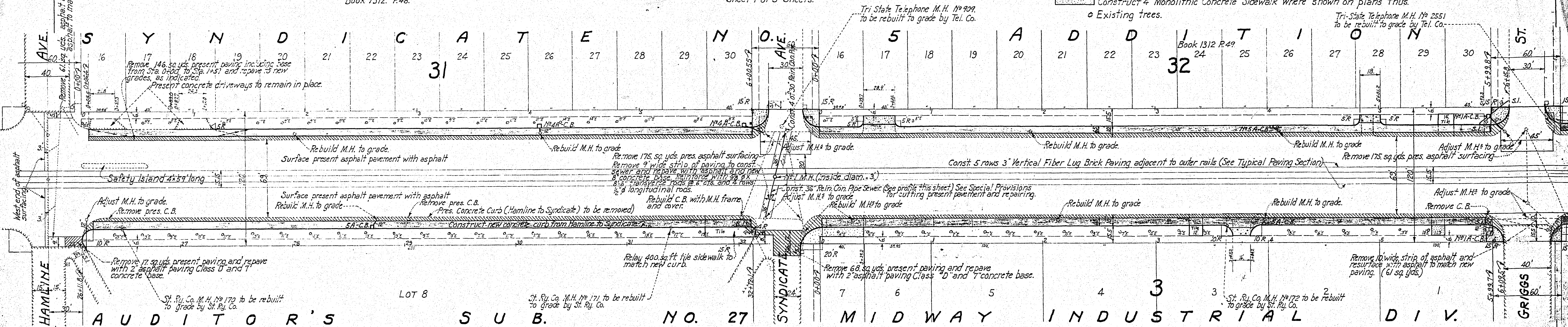

LOT 8

AUDITOR'S SUB. NO. 27 MIDWAY INDUSTRIAL DIV. GRIGGS

Book 1312 P.44.

Book 1312 P.45.

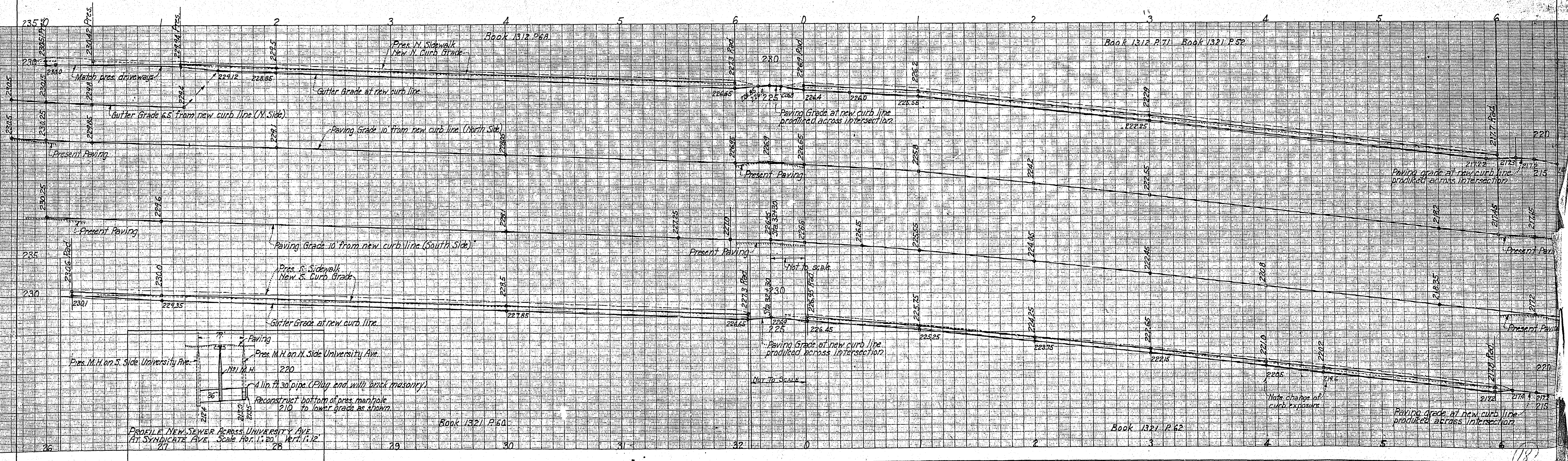

PROFILE NEW SEWER ACROSS UNIVERSITY AVE. AT SYNDICATE AVE. Scale: Hor. 1" = 20' Vert. 1" = 12'

Book 1321 P.60

Book 1321 P.62

GRADING & PAVING PLANS WIDENING ROADWAY ON UNIVERSITY AVE.

FROM HAMLINE AVE. TO OXFORD ST.

Scale: 1"=40' Field Books No 1312-1321-1322-1330.
Sheet 2 of 3 Sheets.

Book 1321 P.47

Book 1321 P.46

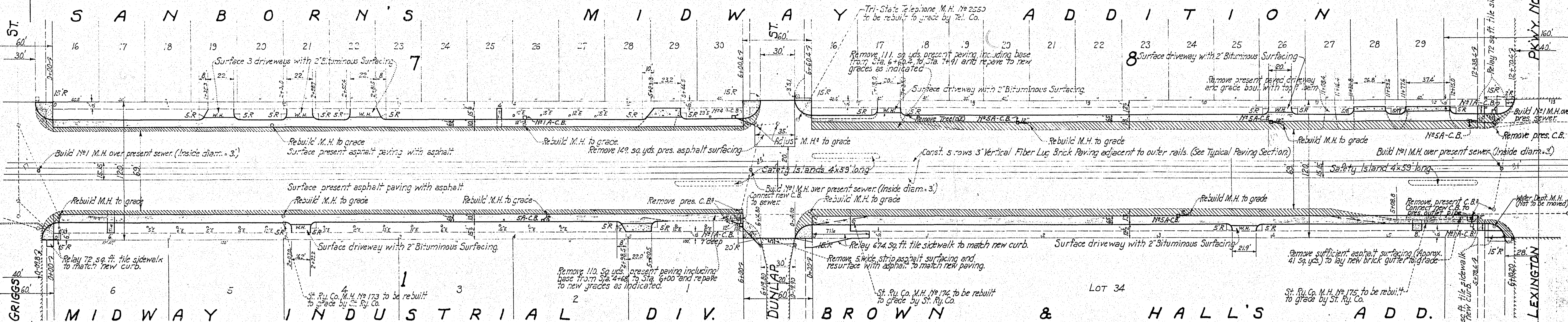

Book 1312 P.46

Book 1321 P.45

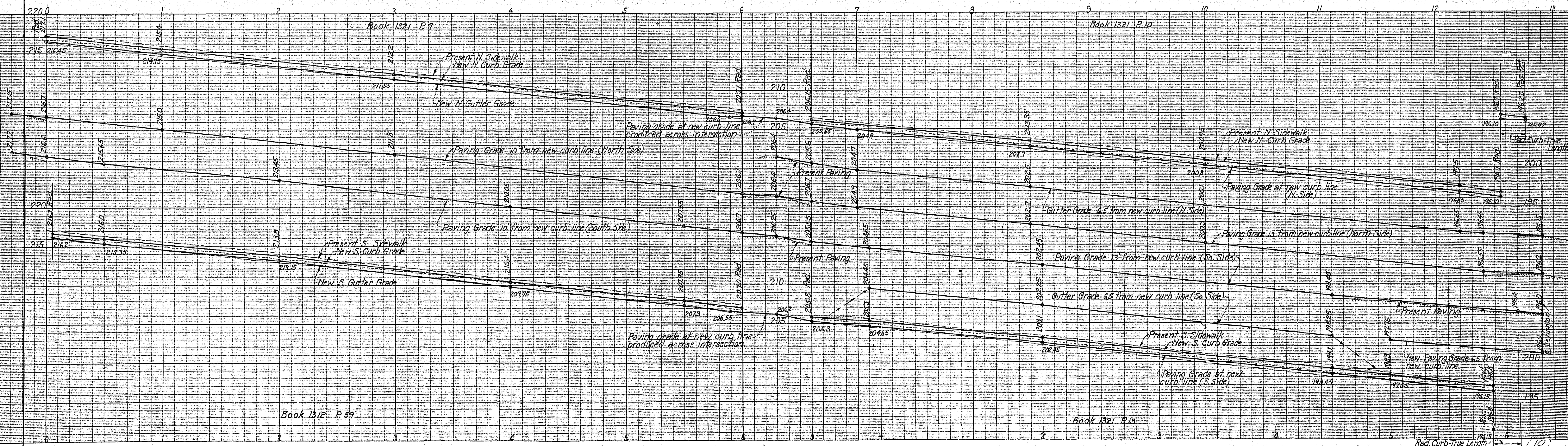

Book 1321 P.19

University Ave. Hamline to Oxford St. D.R. No. 13544 Sheet 2 of 3

NEW YORK ENGINEERING CORPORATION, 110 NASSAU ST., NEW YORK, N.Y. 10038. ARCHITECT: S.P.6208. SHEET: 2 OF 3. DATE: 1965.

GRADING & PAVING PLANS WIDENING ROADWAY ON UNIVERSITY AVE.

FROM HAMLIN AVE. TO OXFORD ST.
Scale: 1" = 40' Field Books No 1312-1321-1322-1330.
Sheet 3 of 3 Sheets.

Book 1312 P.55.

Book 1312 P.56.

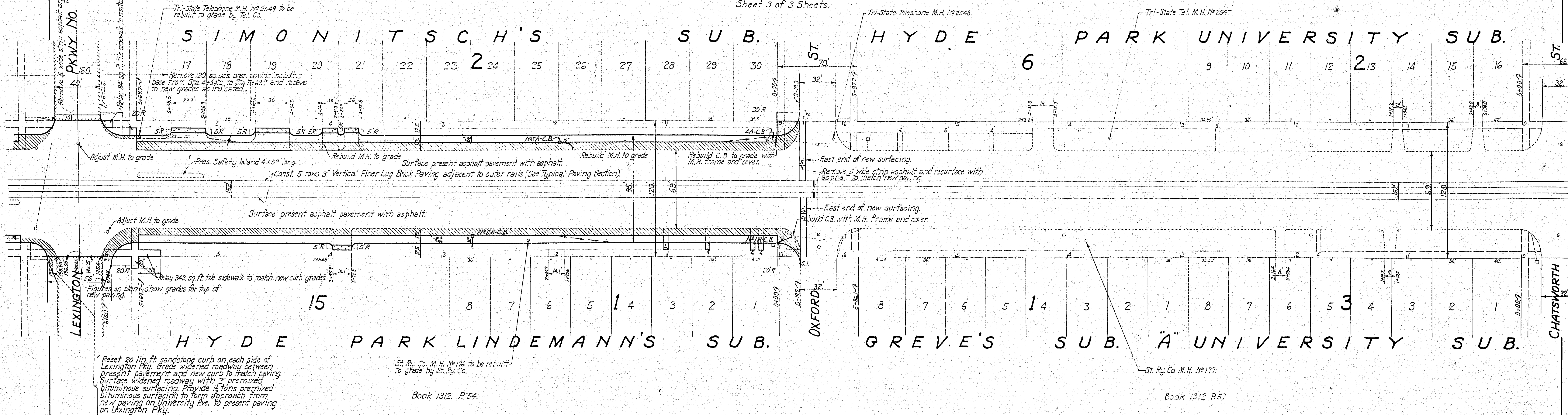

St. Ry. Co. M.H. No 176 to be rebuilt to grade by St. Ry. Co.

St. Ry. Co. M.H. No 177.

Book 1312 P.54.

Book 1312 P.57.

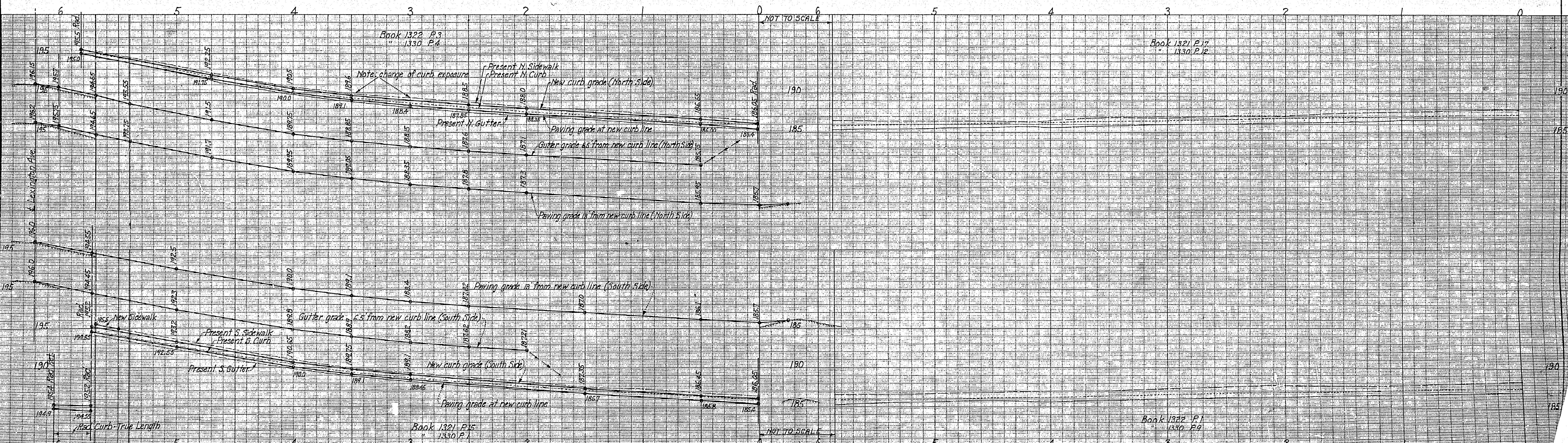

Book 1321 P.15
1330 P.1

Book 1322 P.1
1330 P.2