

H:\Land Projects\305-OLAY\dwg\larp BEEBE 120 211c.dwg  
11/1/2006 10:58:10 AM  
User: jk  
Plot: 11/1/2006 10:58:10 AM

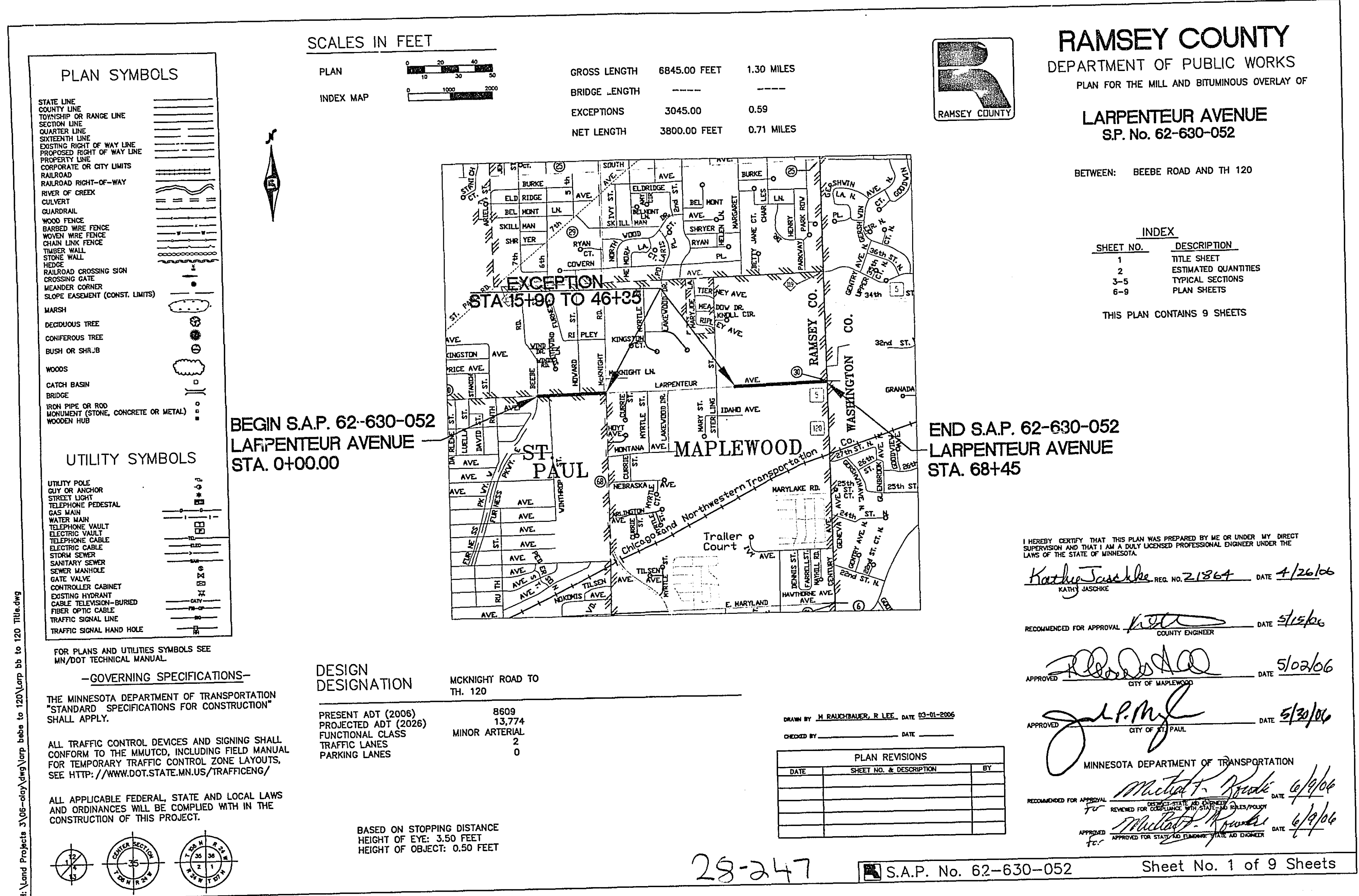

Design on Ispw1(H:\Land Projects\305-OLAY\dwg\LARP BEEBE 120 ESTIMATED QUANTITIES

STATEMENT OF ESTIMATED QUANTITIES			
Item Number	Item	Unit	Estimated Quantity 100% S.A.P. 62-630-52
2021.501	Mobilization	L.S.	1
2232.501	Mill Bituminous Surface (1 1/2")	S.Y.	16,703
2350.501	Type MVWE34035B (1 1/2") Wearing Course Mixture	Ton	1,614
2357.502	Bituminous Material for Tack Coat	Gal.	835
2504.602	Adjust Valve Box	Each	2
2506.522	Adjust Frame & Ring Casting	Each	10
2535.501	Bituminous Curb	L.F.	850
2563.601	Traffic Control	L.S.	1
2564.602	Pavement Message (Left or Right Arrow) - Poly Preform	Each	4
2564.603	24" Stop Line White - Poly Preform	L.F.	30
2564.603	12" Yellow Hashmark	L.F.	50
2564.603	12" Solid Line White (Survey Marker) - Epoxy	L.F.	20
2564.618	Zebra Crosswalk White - Poly Preform	S.F.	165
2565.603	NMC Loop Detector (6' X 6')	L.F.	478

MN/DOT STANDARD PLATES	
PLATE NO. 80001	DESCRIPTION STANDARD BARRICADES

BASIS FOR ESTIMATED QUANTITIES  
1. 115 LBS. / SQUARE YARDS / INCH OF BITUMINOUS  
2. .05 GALLONS OF BITUMINOUS TACK COAT /SQUARE YARD OF PAVEMENT / LIFTS

I HEREBY CERTIFY THAT THIS PLAN WAS PREPARED BY ME OR UNDER MY  
DIRECT SUPERVISION, AND THAT I AM A DULY LICENSED PROFESSIONAL  
ENGINEER UNDER THE LAWS OF THE STATE OF MINNESOTA

NAME Kathy Jaschke  
MN REG NO. 21864 DATE 4/26/06

28-247 LARPEN TEUR AVENUE BEEBE ROAD TO TH120  
ESTIMATED QUANTITIES  
S.A.P. 62-630-52 SHEET 2 of 9 SHEETS

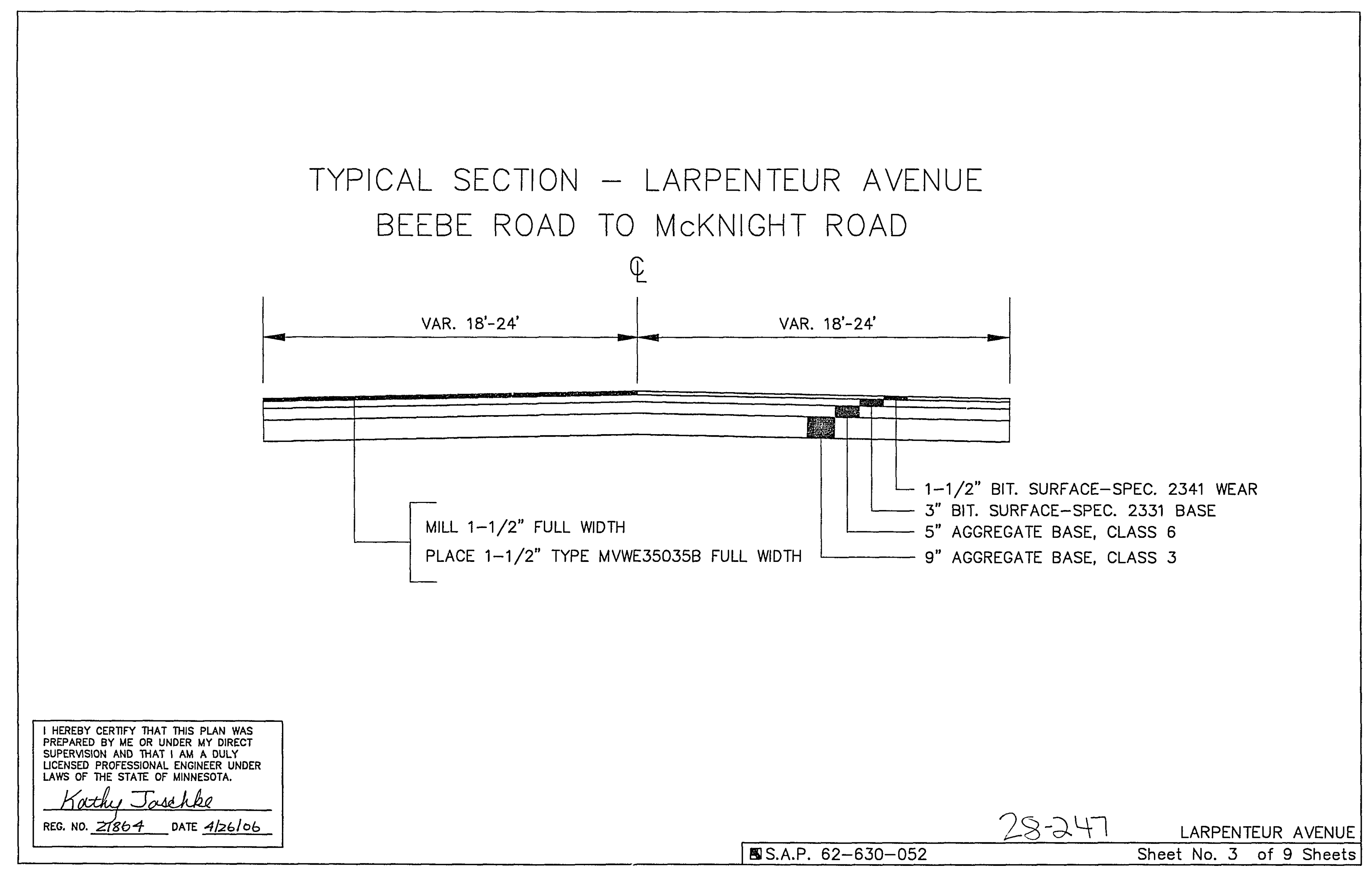

TYPICAL SECTION – LARPENTEUR AVENUE  
STA. 6+00 TO STA. 15+00

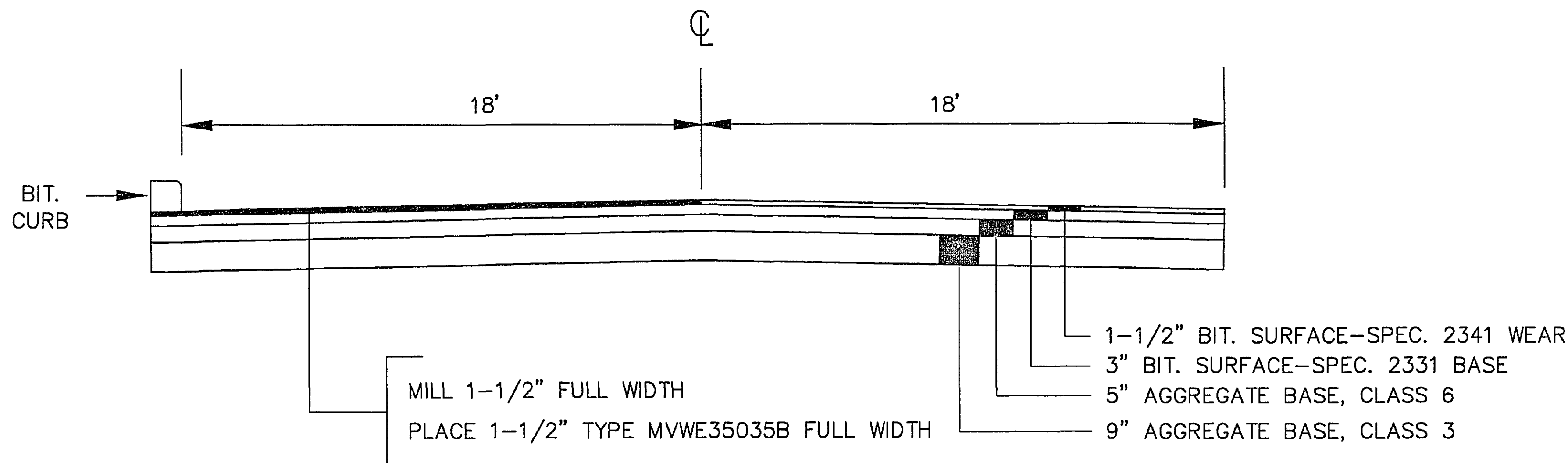

I HEREBY CERTIFY THAT THIS PLAN WAS  
PREPARED BY ME OR UNDER MY DIRECT  
SUPERVISION AND THAT I AM A DULY  
LICENSED PROFESSIONAL ENGINEER UNDER  
LAWS OF THE STATE OF MINNESOTA.

*Kathy Jaschke*

REG. NO. 21864 DATE 4/26/06

S.A.P. 62-630-052

28-247 LARPENTEUR AVENUE  
Sheet No. 4 of 9 Sheets

TYPICAL SECTION – LARPENTEUR AVENUE  
STA. 46+35 TO TH 120

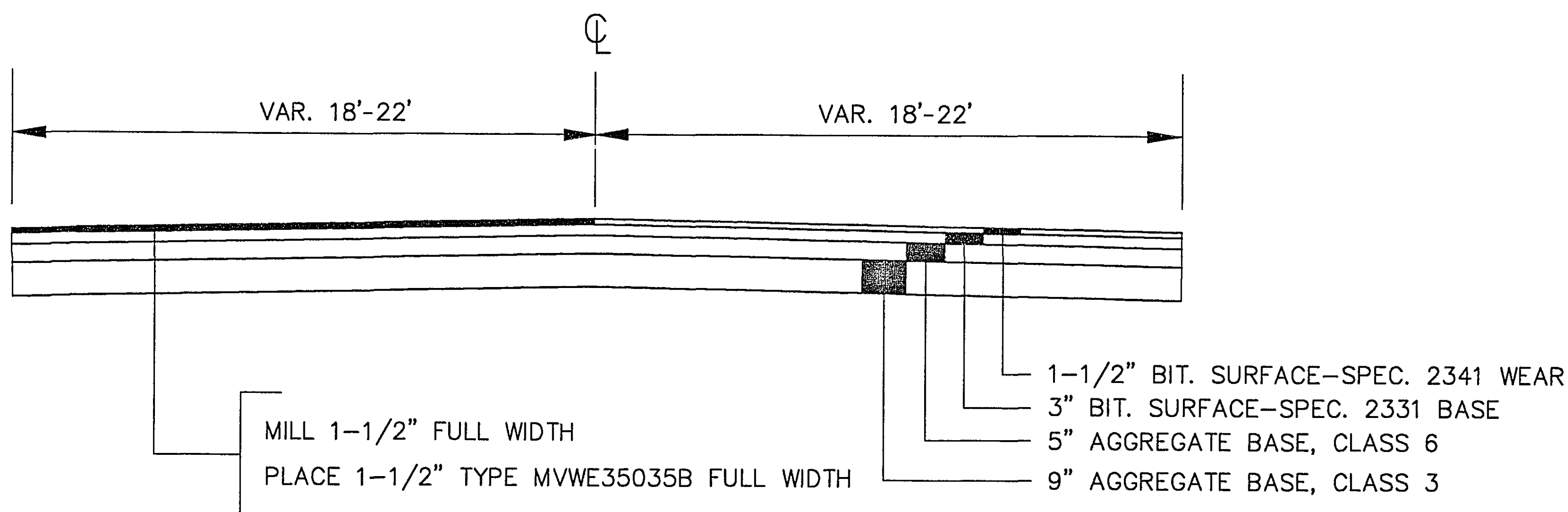

I HEREBY CERTIFY THAT THIS PLAN WAS  
PREPARED BY ME OR UNDER MY DIRECT  
SUPERVISION AND THAT I AM A DULY  
LICENSED PROFESSIONAL ENGINEER UNDER  
LAWS OF THE STATE OF MINNESOTA.

*Kathy Jaschke*

REG. NO. 21864 DATE 4/26/06

S.A.P. 62-630-052

28-247 LARPENTEUR AVENUE  
Sheet No. 5 of 9 Sheets



