

OFFICE OF COUNTY ENGINEER
 RAMSEY COUNTY
 SITE PLAN FOR
 MIDWAY ICE ARENA

SCALE: 1" = 100'
 B.M. ELEV. 100.00
 TOP M.H. N.E. COR. BLDG. SITE

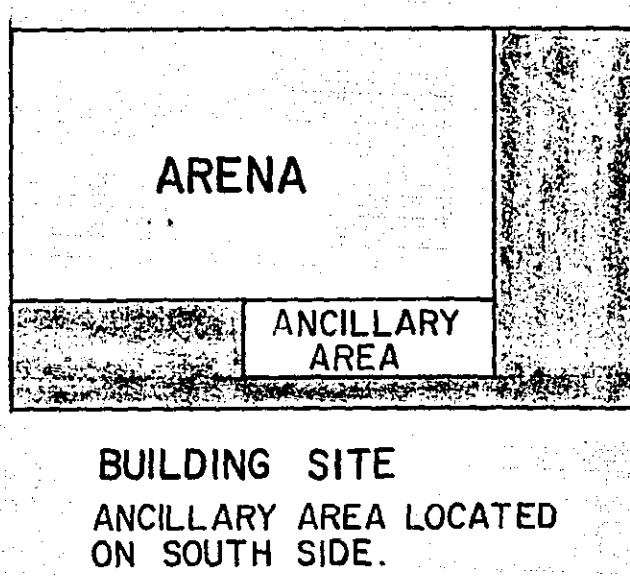
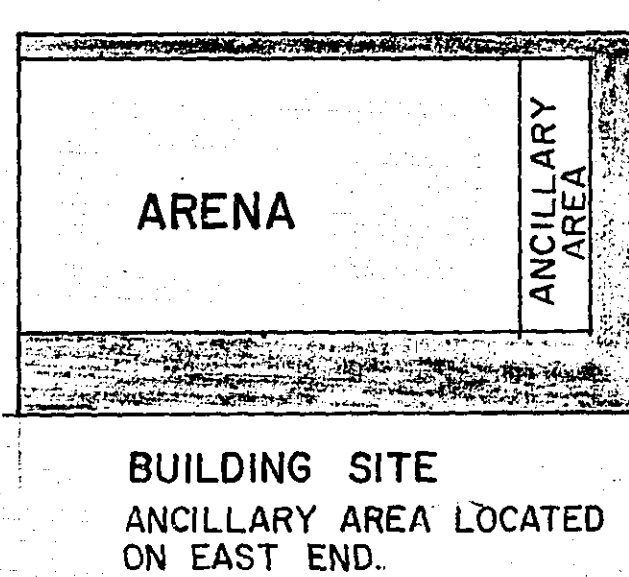
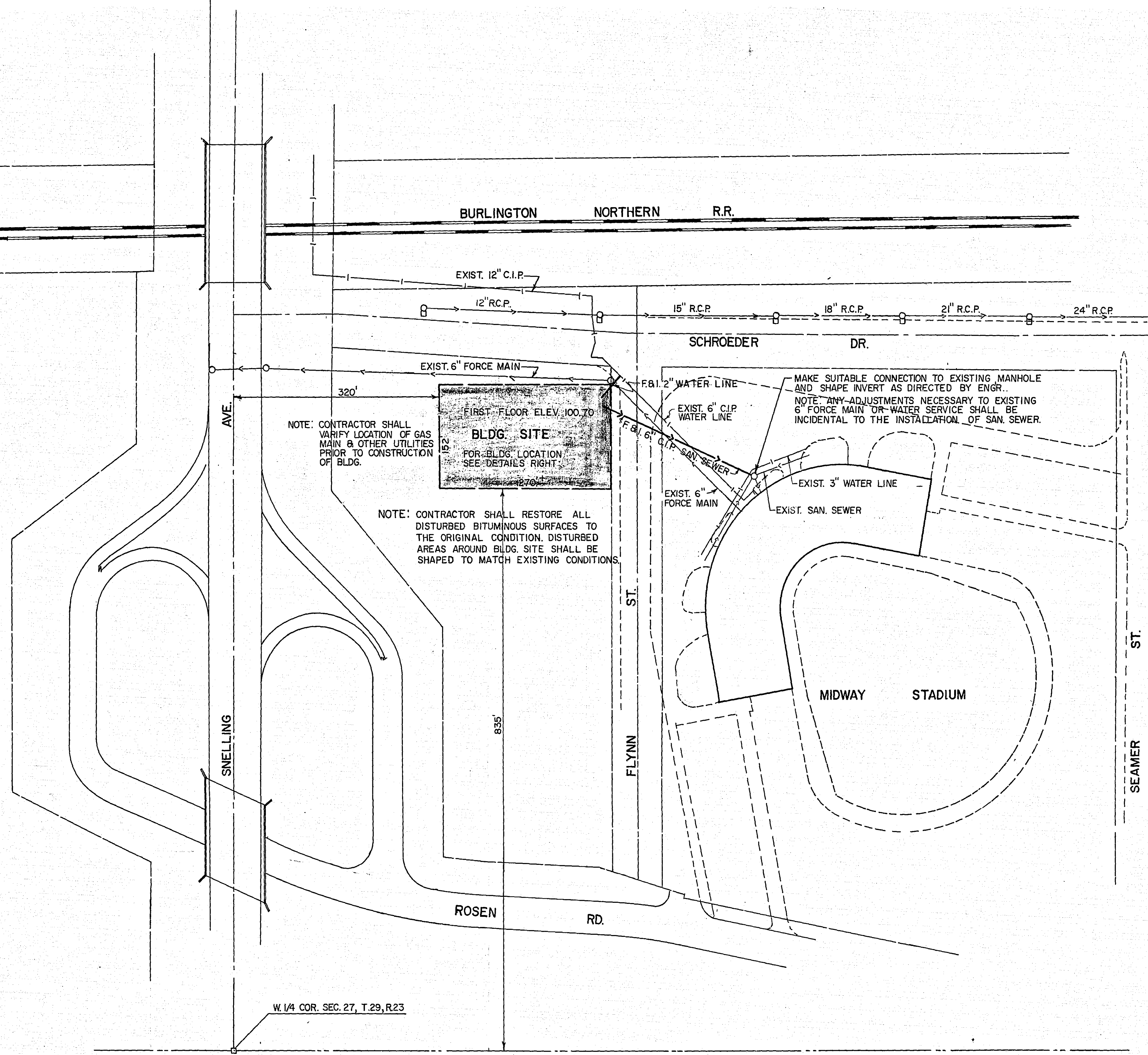

hereby certify that this plan, specification, or report was prepared by me or under my direct supervision and that I am a duly Registered Professional Engineer under the laws of the State of Minnesota.
Donald E. Welton
 Date 9-28-70 Reg. No. 7177

APPROVED [Signature] DATE 10/19/70
 CHAIRMAN OF THE RAMSEY COUNTY BOARD
 APPROVED [Signature] DATE 9/24/70
 RAMSEY COUNTY RECREATION FACILITIES BUILDING COMMISSION