

721

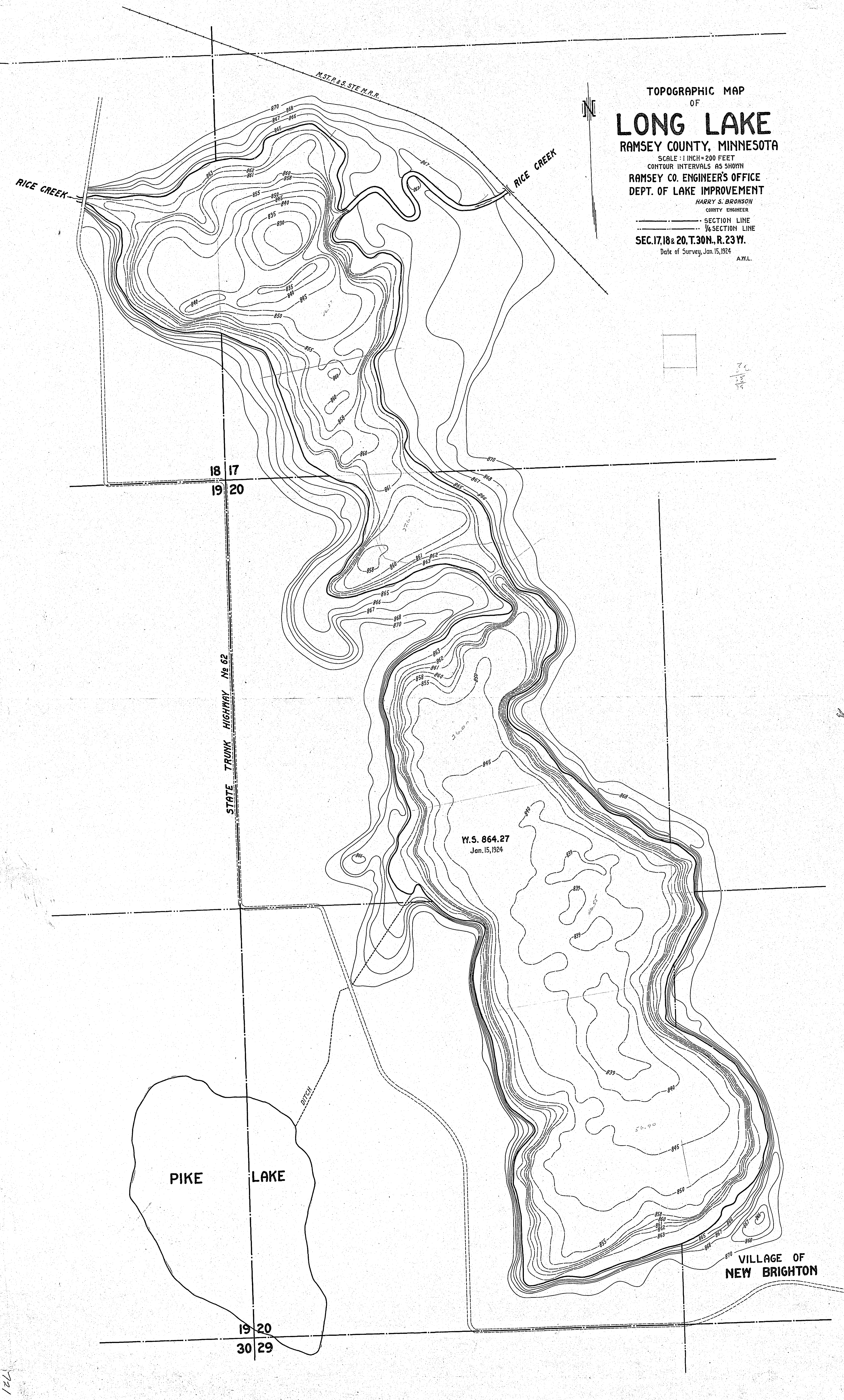

TOPOGRAPHIC MAP
OF
LONG LAKE
RAMSEY COUNTY, MINNESOTA
SCALE: 1 INCH = 200 FEET
CONTOUR INTERVALS AS SHOWN
RAMSEY CO. ENGINEER'S OFFICE
DEPT. OF LAKE IMPROVEMENT
HARRY S. BRONSON
COUNTY ENGINEER
SECTION LINE
1/4 SECTION LINE
SEC. 17, 18 & 20, T. 30N., R. 23W.
Date of Survey, Jan. 15, 1924
A.W.L.

18 17
19 20

STATE TRUNK HIGHWAY No. 62

W.S. 864.27
Jan. 15, 1924

PIKE LAKE

19 20
30 29

VILLAGE OF
NEW BRIGHTON

36
35
38

721

721

721