

NOTE: CONTRACTOR SHALL VERIFY ALL LOCATIONS OF EXISTING UTILITIES PRIOR TO CONSTRUCTION.

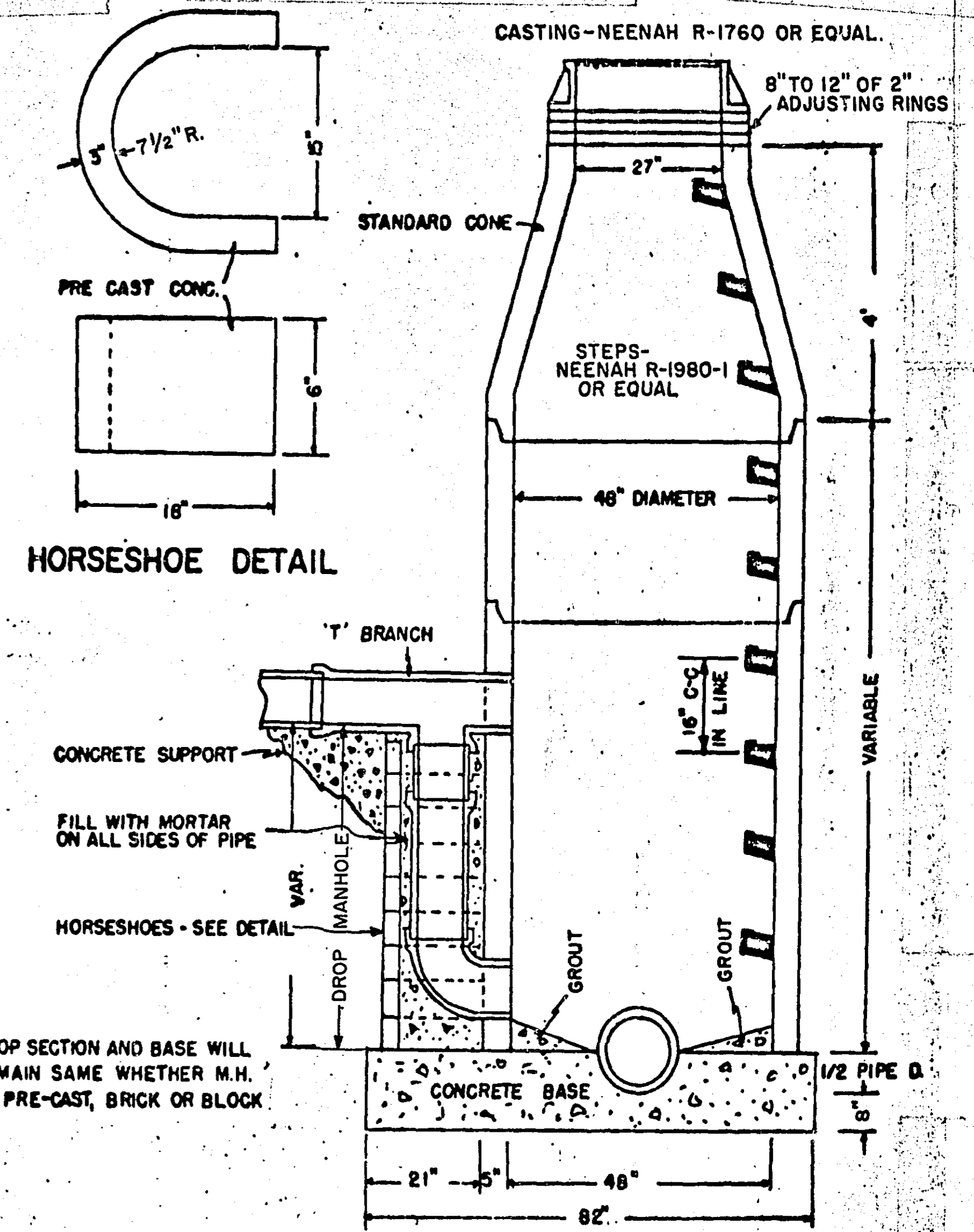
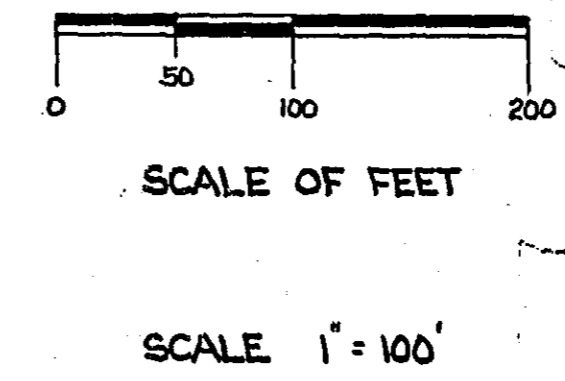

STANDARD PRECAST CONCRETE MANHOLE WITH DROP SECTION ADDED

EXISTING
WHITE BEAR AVE. SANITARY SEWER

SCALE VERT. 1" = 10'
HORIZ. 1" = 100'

BM. 97350
TOP HYD. AT
RAMSEY COUNTY HOME

BM. 94747
TOP HYD. N.W. COR.
FLANDRAU & WHITE BEAR AVE

PROPOSED SANITARY SEWER
FOR
RAMSEY COUNTY HOME

NOTE: CONTRACTOR SHALL RESHAPE
INVERTS OF EXISTING MH
#1 AND #4 TO PROVIDE
SMOOTH FLOWAGE

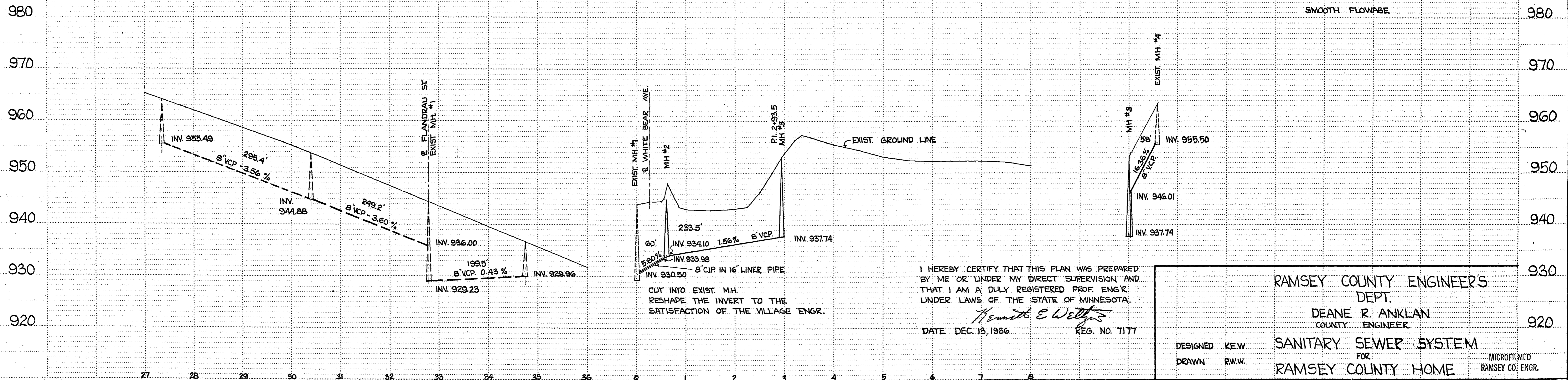

I HEREBY CERTIFY THAT THIS PLAN WAS PREPARED BY ME OR UNDER MY DIRECT SUPERVISION AND THAT I AM A DULY REGISTERED PROF. ENGR. UNDER LAWS OF THE STATE OF MINNESOTA.
Kenneth E. Wetters
DATE DEC. 13, 1966 REG. NO. 7177

DESIGNED	KE.W.	RAMSEY COUNTY ENGINEER'S DEPT. DEANE R. ANKLAN COUNTY ENGINEER SANITARY SEWER SYSTEM FOR RAMSEY COUNTY HOME	MICROFILMED RAMSEY CO. ENGR.
DRAWN	R.W.W.		