



PLANT MATERIAL LIST		
SYMBOL	ITEM	QUANTITY
	SMOOTH SUMAC	120
	GREEN ASH	55
(1)	PLANTING SOIL	515 CU. FT.
(2)	MULCH MATERIAL	683 CU. FT.

(1) FERTILIZER SHALL BE 12-12-12
 (2) MULCH IS WOOD CHIPS (4" DEPTH)



SCALE 1" = 30'

ENT. TO DETENTION HOME

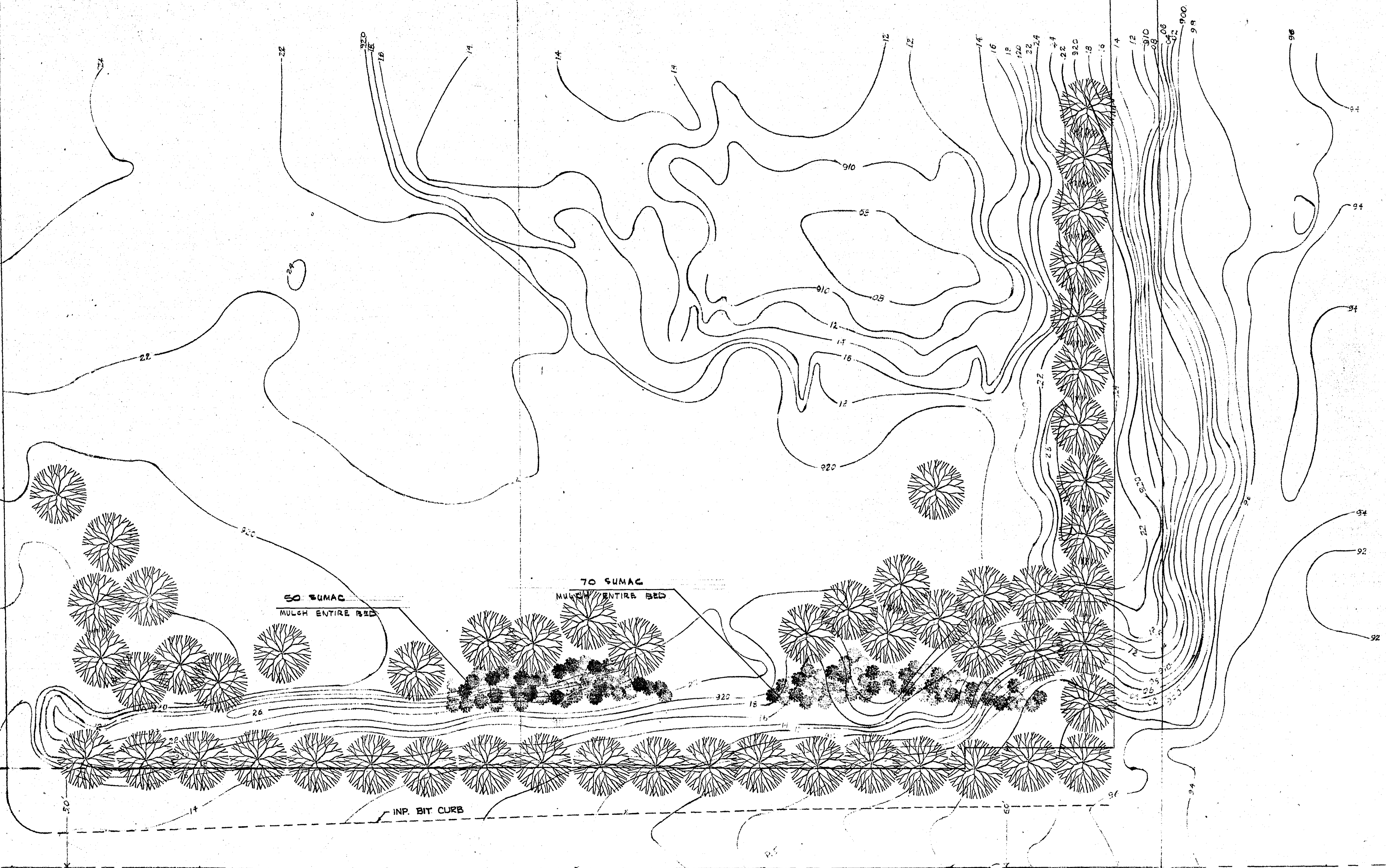

Δ 44°28'17"
 T 148.97'
 R 3819.83

LARPEUR AVE.

Δ 2°02' 57"
 T 204.90'
 R 11459.19

MICROFILMED
 MICROFILMED
 RAMSEY CO. ENGR.

6864

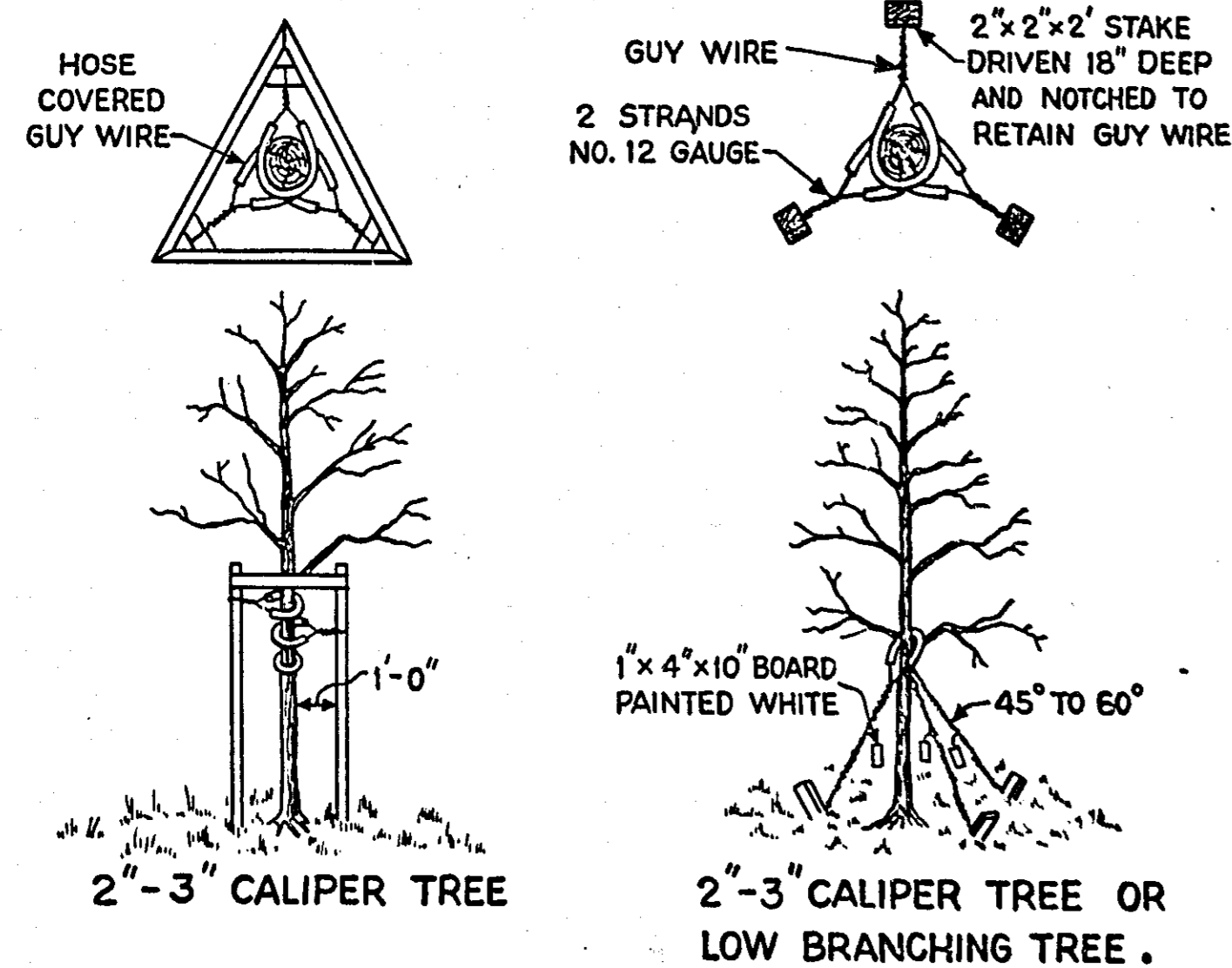
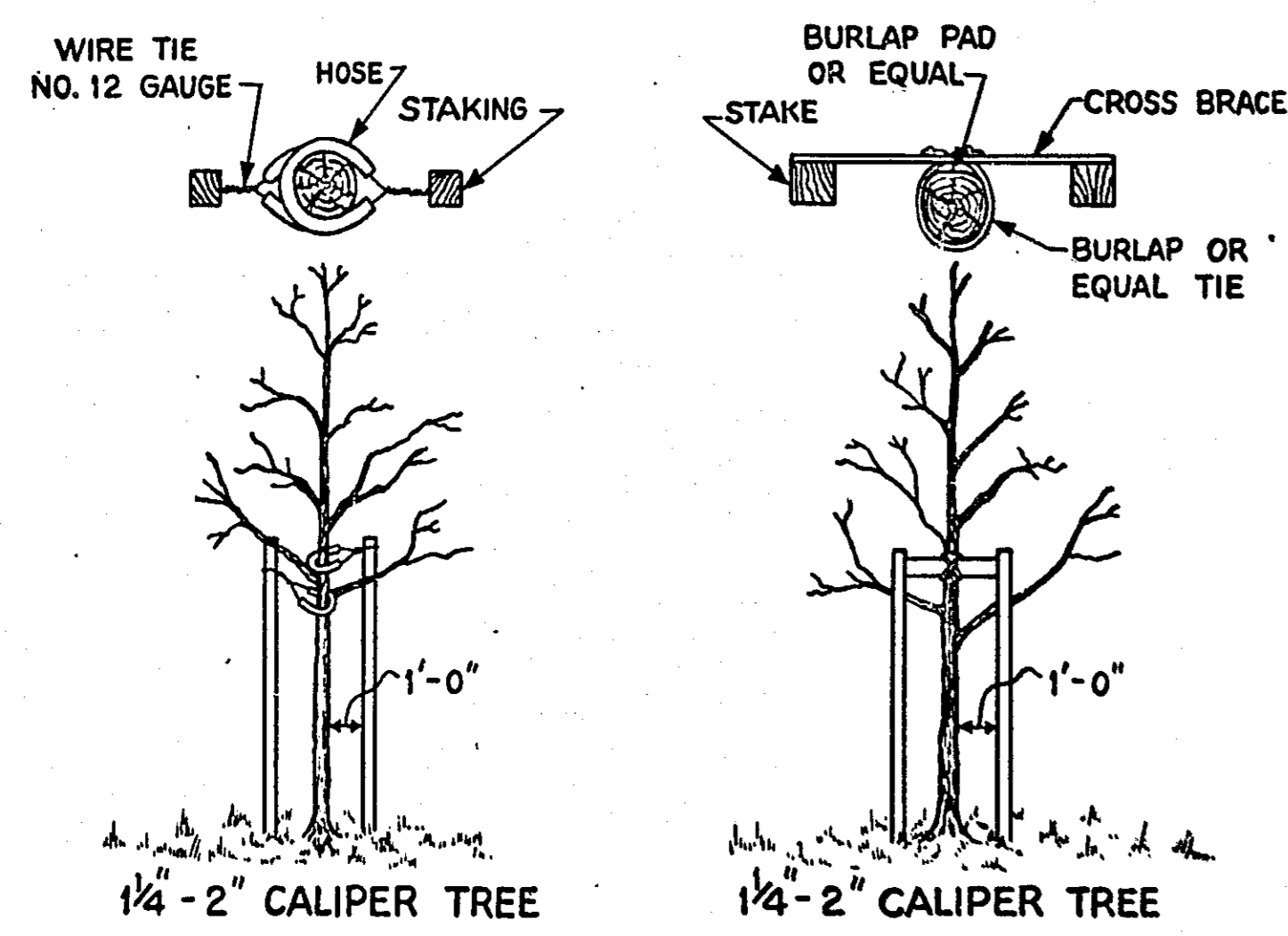

ALL STAKES ARE NOMINAL 2"x2" or 2 1/2" DIAMETER, 8' LONG WITH 2' IN THE GROUND. CROSS BRACES ARE NOMINAL 1"x3" MATERIAL.

STAKING AND GUYING METHODS

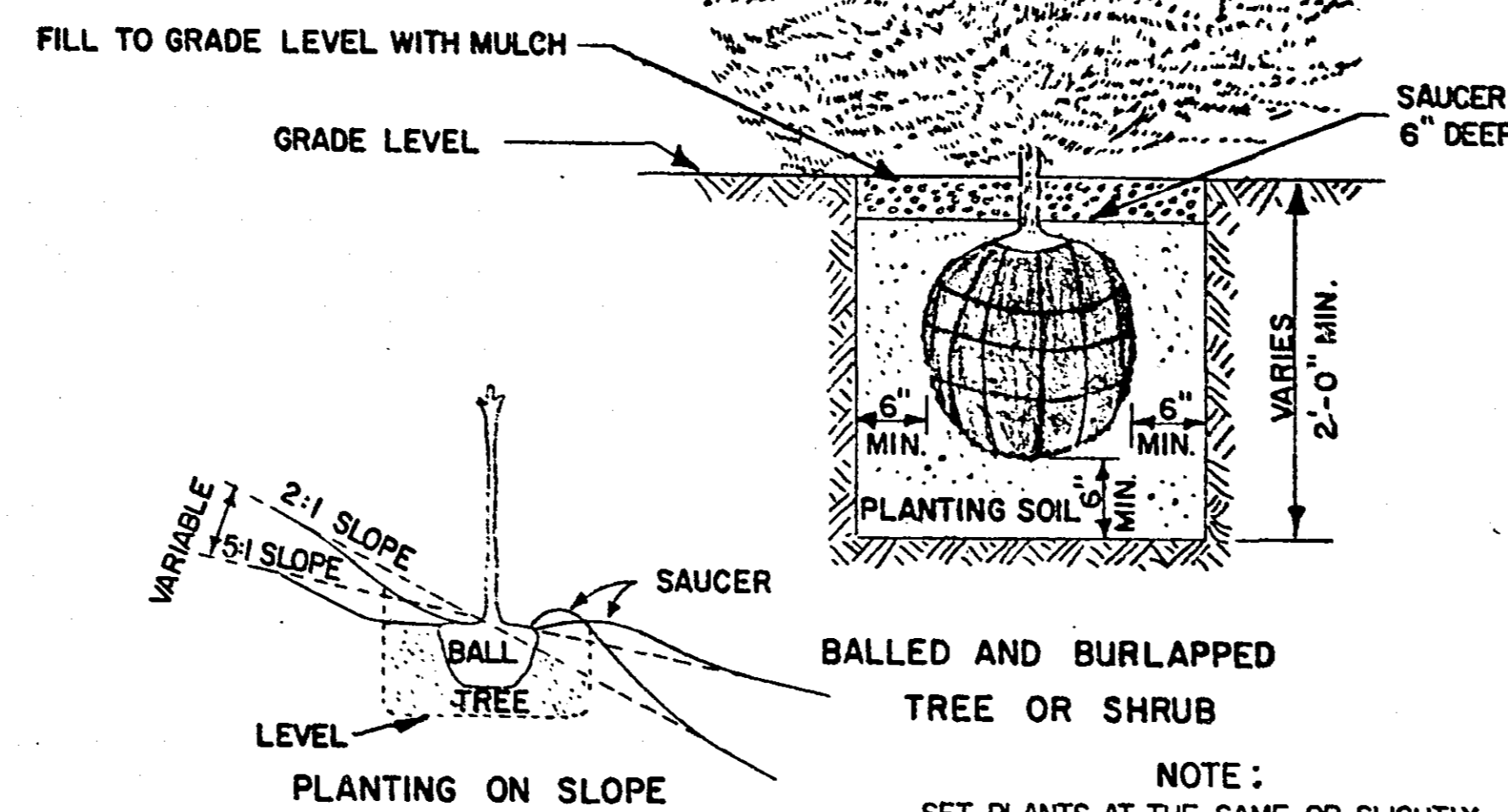
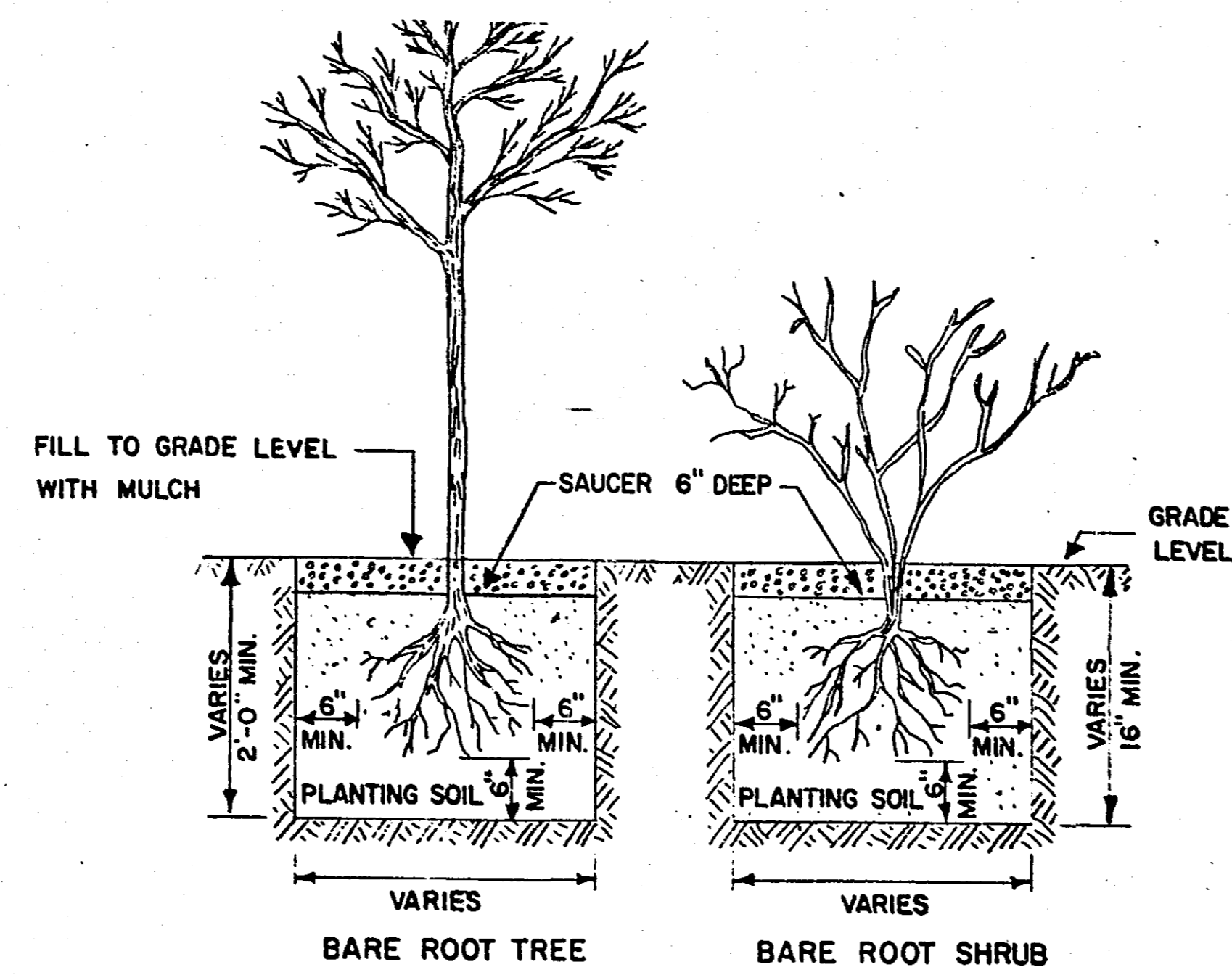

NOTE: SET PLANTS AT THE SAME OR SLIGHTLY LOWER DEPTH AS THEY GREW IN THE NURSERY OR FIELD. ALL PLANTS SHALL BE PLACED IN A PLUMB POSITION.

PLANTING METHODS

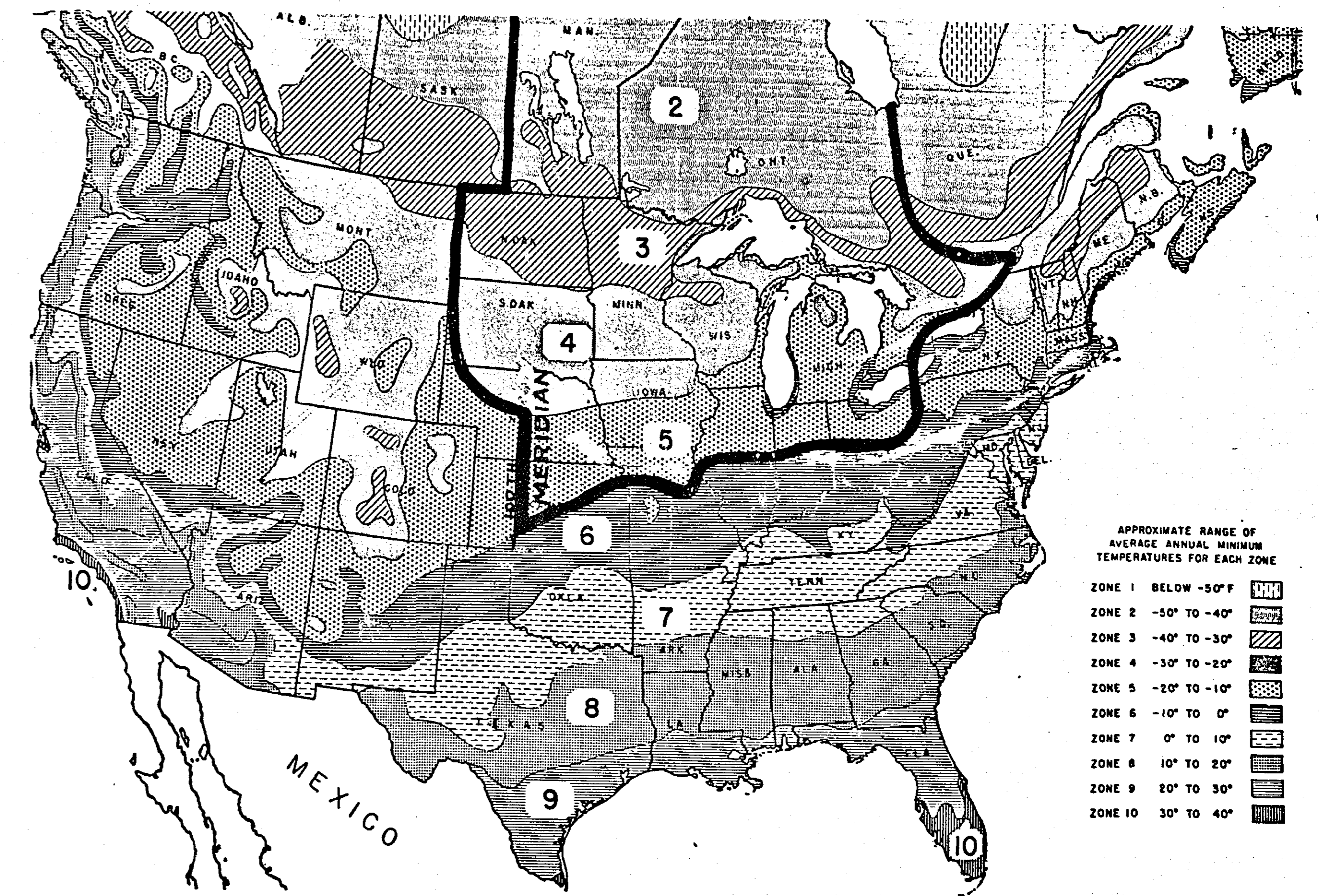

The Zones of Plant Hardiness—This is an adapted version of the color map on the reverse side. It may be useful for small-scale reproduction in books, magazines, and nursery catalogs. This map is not copyrighted, and permission for reproducing it is not required.

EN-69

MICROFILMED
RAMSEY CO. ENGR.

6864

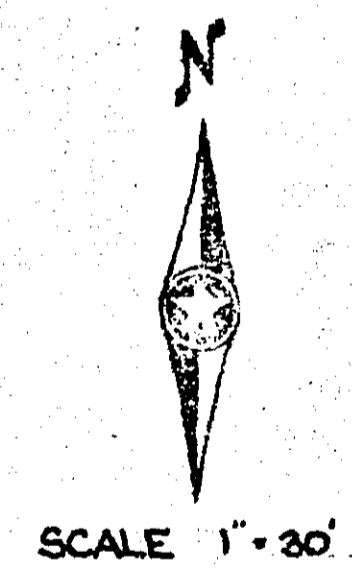

Δ 4°28'11" T 148.97 R 3019.83

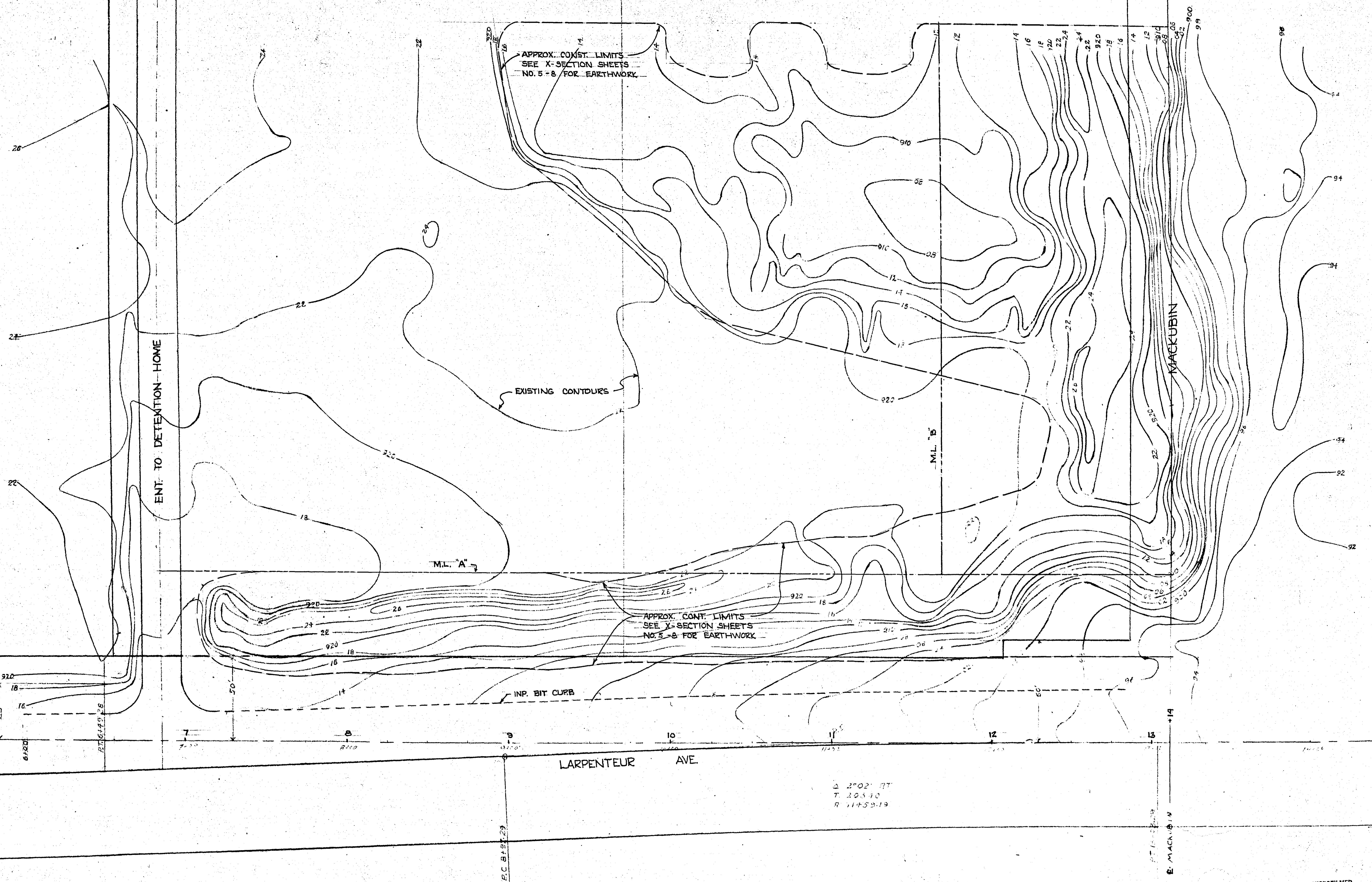

Δ 2°02' 37" T 20510 R 1153.19

MICROFILMED
RAMSEY CO. ENGR.

6864