

44+75 RT. & LT. 23.75' CONST. C.B. LP4-H  
 LT. 22.5' TO RT. 22.5' F&I 18"X43' R.C.P., CLASS 2  
 RT. 25' TO 55' RT. F&I 24"X20' R.C.P., CLASS 2

51+47 1/2 INP 12"X 32' C.M.P.-REMOVE  
 F&I 15"X 80' C.M.P.

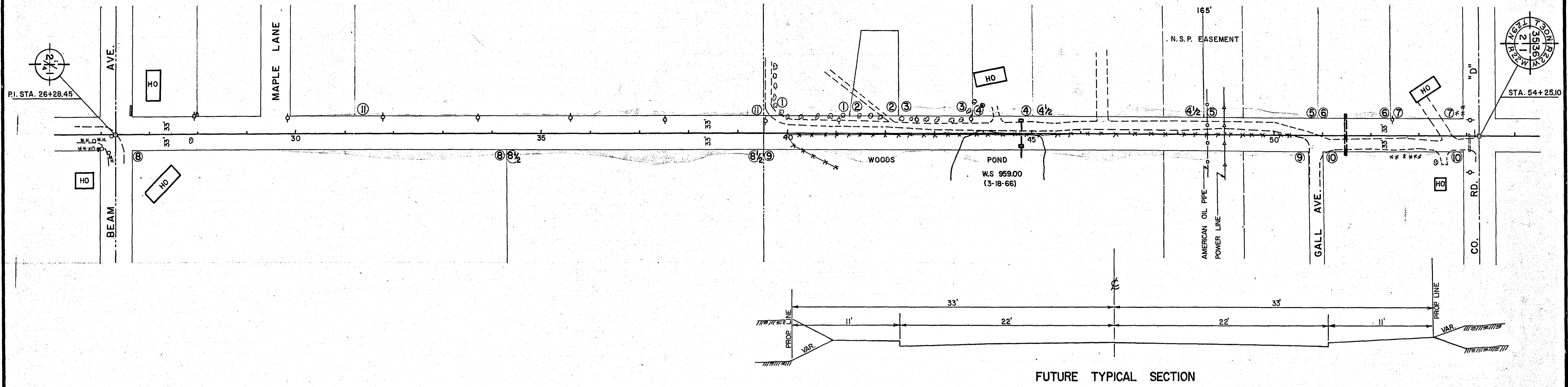

B.M. ELEV. 996.28  
 TOP HYD. S.E. COR.  
 BEAM AVE. & MCKNIGHT RD.

B.M. ELEV. 963.21  
 NAIL IN P.P. AT STA. 39+86  
 LEFT 26'

B.M. ELEV. 979.00  
 TOP CTR. MONUMENT  
 MCKNIGHT RD. & CO. RD. "D"

OFFICE OF COUNTY ENGINEER  
 RAMSEY COUNTY  
 CONSTRUCTION PLAN FOR GRADING  
 MCKNIGHT ROAD  
 BETWEEN BEAM AVE. & CO. ROAD D.  
 COUNTY PROJECT NUMBER 66-68  
 DEANE R. ANKLAN RAMSEY COUNTY ENGINEER

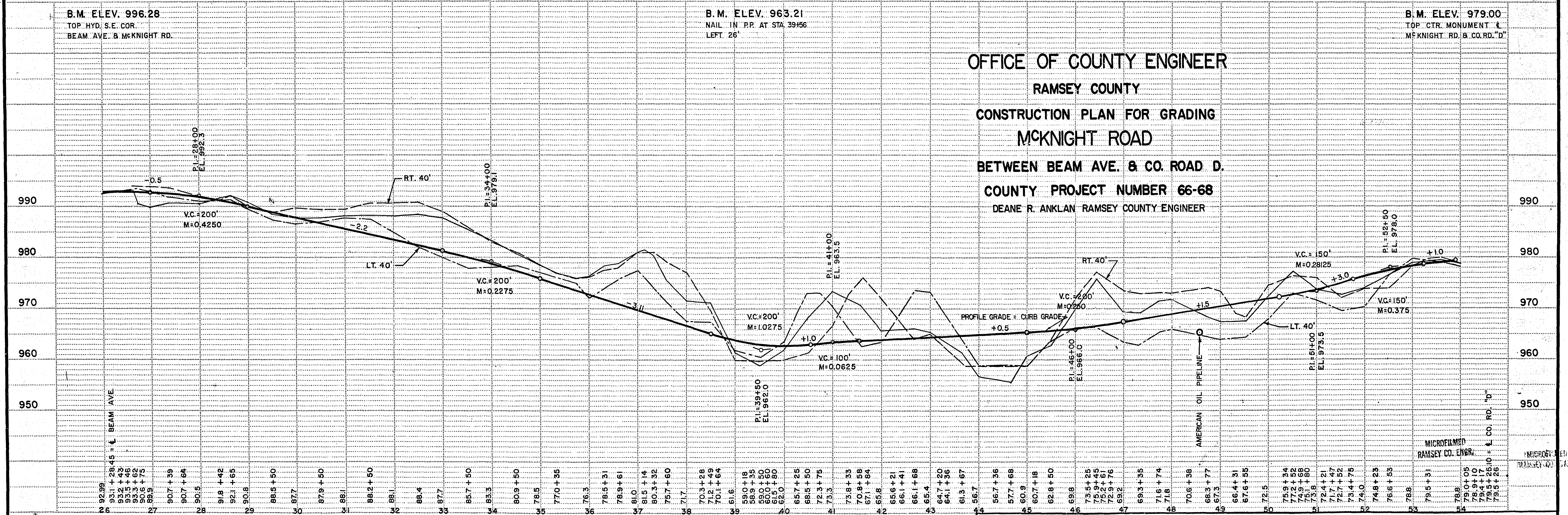

COUNTY PROJ. NO. 66-68

Sheet No. 1 of 7 Sheets

ROOSTER & CO. 102 - ST. PAUL - MINNEAPOLIS, MINNESOTA

MICROFILMED  
 RAMSEY CO. ENGR.

6861