

# City Of St. Paul

Department of Public Works

MILTON ROSEN - Commissioner

## CONSTRUCTION PLAN FOR GRADING & PAVING

ON  
PARKWAY DRIVE - Payne Ave. To T.H. No. 61

MUNICIPAL STATE AID PROJ. NO. 64-178-01 (Payne To Larpenteur)

CITY CONTRACT 63-P285  
COUNTY PROJECT 63-141

CITY GROSS LENGTH	2124.10	FEET	0.402	MILES
COUNTY GROSS LENGTH	1234.90	FEET	0.234	MILES
BRIDGES-LENGTH	—	FEET	—	MILES
EXCEPTIONS-LENGTH	—	FEET	—	MILES
TOTAL LENGTH	3359.00	FEET	0.636	MILES

Traffic Count 4485 V.P.D.  
20 Yr. Proj. 8200

### SPECIFICATIONS

The Minnesota Highway Department "Specifications For Highway Construction" dated May 1, 1959, shall govern, as amended by the Special Provisions. All applicable Federal, State and Local laws shall be complied with in the construction of this Project.

Approved	.....	19
	Chief Engineer	
Approved	.....	19
	Street & Highway Engineering Coordinator	
Approved	.....	19
	Design Engineer	
Approved	.....	19
	County Engineer	
Approved	.....	19
	District State-Aid Engineer - M.H.D.	
Approved	.....	19
	State-Aid Engineer - M.H.D.	
Recommended For Approval	.....	19

I hereby certify that this plan was prepared by me or under my direct supervision and that I am a duly Registered Professional Engineer under the laws of the State of Minnesota.

Date ..... Reg. No. ....

Date ..... Reg. No. ....

6839

County Proj. No. 63-141  
M.S.A. Proj. 64-178-01

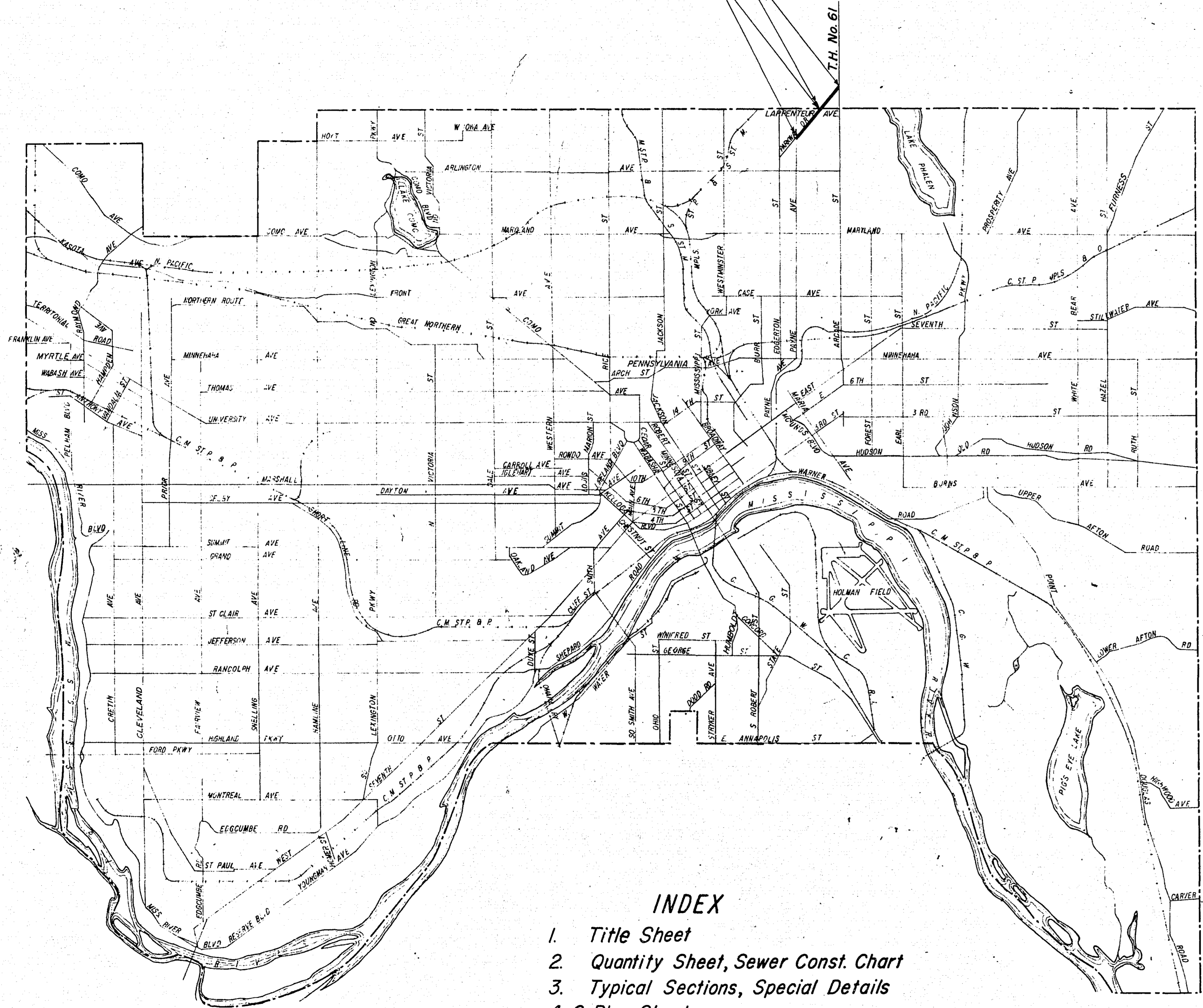

### INDEX

1. Title Sheet
2. Quantity Sheet, Sewer Const. Chart
3. Typical Sections, Special Details
- 4-6. Plan Sheets
- 7-11. Cross Sections

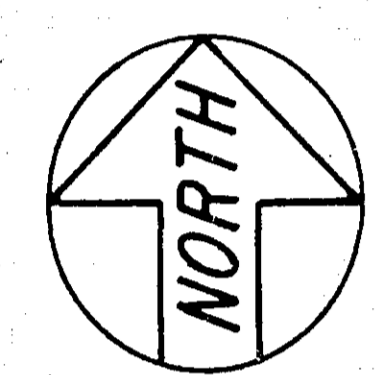

Layout Scale: 1" = 3,000'

GRADING & PAVING  
PARKWAY DRIVE  
Payne Ave. To T.H. No. 61  
Sheet 1 of 11 Sheets  
Plan. Dr. R. No. 920

STATEMENT OF ESTIMATED QUANTITIES					
ITEM NO.	ITEM	UNIT	TOTAL EST. QUAN.		
			N.S.	COUNTY	TOTAL
1	CLEAR	TREE	32	15	47
2	GRUB	TREE	33	15	48
3	REMOVE CONCRETE PAVEMENT	SQ. YD.	5,874	2,677	8,551
4	REMOVE CONCRETE BASE INCLUDING SURFACING	SQ. YD.	14		14
5	REMOVE ASPHALT SURFACING	SQ. YD.	59		59
6	REMOVE CONCRETE WALK	SQ. YD.	295		295
7	REMOVE CONCRETE DRIVEWAY	SQ. YD.	120	68	188
8	REMOVE CURB	LIN. FT.	269	132	401
9	REMOVE CATCH BASIN	STRUCTURE	4	4	8
10	COMMON EXCAVATION	CU. YD.	2,717	2,624	5,341
11	SUBCUT EXCAVATION	CU. YD.	767		767
12	SUBGRADE PREPARATION	SQ. YD.	10,515	6,569	17,084
13	TRAVEL BASE IN PLACE (CLASS 5)	CU. YD.	1,220	1,201	3,121
14	TOPSOIL, 4 INCHES THICK	SQ. YD.	3,410	3,660	7,070
15	SODDING	SQ. YD.	3,410	3,660	7,070
16	FURNISH AND INSTALL CASTINGS, A AND B	ASSEMBLY	7	1	8
17	ADJUST MANHOLE FRAME AND RING CASTING	STRUCTURE	16	5	21
18	CONSTRUCT CATCH BASIN, TYPE A	STRUCTURE	17	2	19
19	CONSTRUCT CATCH BASIN, TYPE B	STRUCTURE	4		4
20	CONSTRUCT MANHOLE	STRUCTURE	5		5
21	FURNISH AND INSTALL 12 INCH R.C. SEWER PIPE, CLASS 2	LIN. FT.	846	58	904
22	FURNISH AND INSTALL 15 INCH R.C. SEWER PIPE, CLASS 2	LIN. FT.	320	43	363
23	FURNISH AND INSTALL 18 INCH R.C. SEWER PIPE, CLASS 2	LIN. FT.	532		532
24	CONSTRUCT 7 INCH CONCRETE BASE	SQ. YD.	85		85
25	CONSTRUCT 8 INCH ONE COURSE CONCRETE PAVEMENT	SQ. YD.	10,084	5,860	15,944
26	CONSTRUCT CONCRETE DRIVEWAY, 6 INCHES THICK	SQ. YD.	111	122	233
27	CONSTRUCT CONCRETE DRIVEWAY AND ALLEY, 7 INCHES THICK	SQ. YD.	144	137	281
28	CONSTRUCT MONOLITHIC CONCRETE WALK, 4 INCHES THICK	SQ. FT.	2,532		2,532
29	CONSTRUCT CONCRETE CURB, TYPE 1	LIN. FT.	3,240	1,738	4,978
30	CONSTRUCT CONCRETE CURB, TYPE 2	LIN. FT.	185		185
31	CONSTRUCT CONCRETE CURB, TYPE 6	LIN. FT.	211	288	499
32	CONSTRUCT CONCRETE PROTECTIVE NOSE	EACH		4	4
33	CONSTRUCT ASPHALTIC CONCRETE WEARING COURSE, TYPE B	TON	95	42	137
34	CONSTRUCT ASPHALTIC CONCRETE BINDER COURSE, TYPE E	TON	9	48	57
35	BITUMINOUS MATERIAL FOR TACK COAT	GALLON	10	10	20
36	BITUMINOUS MATERIAL FOR SEAL COAT	GALLON	16	90	106
37	SEAL COAT AGGREGATE	TON	1	4	5
38	ADJUST WATER GATE VALVE HOUSING	ASSEMBLY	8	1	9
39	TRAFFIC SIGNAL CONDUIT INSTALLED	LIN. FT.	90		90
40	CONSTRUCT 6 INCH SEWER SERVICE	EACH	1		1
41	FURNISH AND INSTALL TYPE A FULL BOX	STRUCTURE	2		2

GRADING & PAVING  
PARKWAY DRIVE  
Payne Ave. to I.H. No. 61  
Sheet 2 of 11 Sheets  
Rev. Dr. 12 No. 920

### SEWER CONSTRUCTION CHART

STRUC. NO.	APPROXIMATE LOCATION	REMARKS	CASTING ASSY. NUMBER	TOP OF STRUC. CASTING DEPTH	LIN. FT. SEWER PIPE		
					12"	15"	18"
1	0-05 - 20' LT.	REMOVE CATCH BASIN					
2	0-05 - 20' LT.	CONSTRUCT CATCH BASIN, TYPE A	801, 810, 821B	214.40	3'-2"	10	
3	0-35 - 16' RT.	REMOVE CATCH BASIN					
4	0-35 - 21' RT.	CONSTRUCT CATCH BASIN, TYPE A	801, 810, 821B	214.80	3'-2"	20	
5	02+27 - 21' RT.	CONSTRUCT CATCH BASIN, TYPE A	801, 810, 821B	205.38	3'-2"	50	
6	02+27 - 26' RT.	REMOVE CATCH BASIN					
7	02+54 - 19' LT.	ADJUST MANHOLE		205.02			
8	02+85 - 21' LT.	CONSTRUCT CATCH BASIN, TYPE A	801, 810, 821B	204.29	3'-2"	48	
9	02+79 - 27' RT.	ADJUST MANHOLE		204.22			
10	03+13 - 45' RT.	REMOVE CATCH BASIN					
11	03+18 - 50' RT.	CONSTRUCT CATCH BASIN, TYPE A	801, 810, 821B	203.35	3'-2"	16	
12	04+44 - 19' RT.	ADJUST MANHOLE		203.43			
13	05+55 - 19' RT.	ADJUST MANHOLE		203.01			
14	05+55 - 19' LT.	ADJUST MANHOLE		202.86			
15	05+88 - 19' RT.	ADJUST MANHOLE		202.77			
16	06+16 - 21' LT.	CONSTRUCT CATCH BASIN, TYPE A	801, 810, 821B	202.52	3'-2"	32	
17	06+28 - 50' LT.	CONSTRUCT CATCH BASIN, TYPE B	801, 810, 821B	203.75	5'-1"	46	
18	06+32 - 20' LT.	ADJUST MANHOLE		202.50			
19	06+42 - 52' LT.	ADJUST MANHOLE		203.75			
20	06+72 - 40' LT.	CONSTRUCT CATCH BASIN, TYPE B	801, 810, 821B	202.50	6.1'	44	
21	06+61 - 21' RT.	CONSTRUCT CATCH BASIN, TYPE A	801, 810, 821B	202.14	3'-2"	36	
22	06+90 - C. L.	CONSTRUCT MANHOLE	CITY A AND B	202.49	7.8'	320	
23	07+03 - 20' RT.	ADJUST MANHOLE		201.87			
24	07+72 - 19' LT.	ADJUST MANHOLE		201.63			
25	09+65 - 21' RT.	CONSTRUCT CATCH BASIN, TYPE B	801, 810, 821B	199.97	5'-1"	50	
26	09+77 - 53' RT.	CONSTRUCT CATCH BASIN, TYPE A	801, 810, 821B	199.25	3'-2"	32	
27	10+10 - C. L.	CONSTRUCT MANHOLE	CITY A AND B	199.57	8.0'	108	
28	10+42 - 21' LT.	CONSTRUCT CATCH BASIN, TYPE A	801, 810, 821B	198.20	3'-2"	38	
29	10+56 - 50' LT.	CONSTRUCT CATCH BASIN, TYPE A	801, 810, 821B	198.30	3'-2"	50	
30	10+93 - 26' LT.	ADJUST MANHOLE		196.70			
31	11+00 - 38' LT.	CONSTRUCT CATCH BASIN, TYPE A	801, 810, 821B	196.50	3'-8"	44	
32	11+17 - C. L.	CONSTRUCT MANHOLE	CITY A AND B	196.26	8.0'	192	
33	12+95 - 21' RT.	CONSTRUCT CATCH BASIN, TYPE A	801, 810, 821B	191.62	3'-2"	24	
34	13+10 - C. L.	CONSTRUCT MANHOLE	CITY A AND B	191.79	7.0'	202	
35	14+90 - 21' LT.	CONSTRUCT CATCH BASIN, TYPE A	801, 810, 821B	187.32	3'-2"	24	
36	15+04 - 52' LT.	CONSTRUCT CATCH BASIN, TYPE A	801, 810, 821B	188.10	3'-2"	54	
37	15+48 - 25' LT.	ADJUST MANHOLE		186.32			
38	15+56 - 38' LT.	CONSTRUCT CATCH BASIN, TYPE B	801, 810, 821B	186.40	5.1'	38	
39	15+90 - 19' LT.	ADJUST MANHOLE		185.93			
40	16+05 - 21' RT.	CONSTRUCT CATCH BASIN, TYPE A	801, 810, 821B	185.83	3'-2"	30	
41	16+33 - 25' RT.	ADJUST MANHOLE		186.31			
42	19+35 - 21' LT.	CONSTRUCT CATCH BASIN, TYPE A	801, 810, 821B	184.28	3'-2"	96	
43	19+42 - 25' LT.	ADJUST MANHOLE		184.80			
44	19+87 - 19' LT.	ADJUST MANHOLE		183.90			
45	20+30 - 21' RT.	CONSTRUCT CATCH BASIN, TYPE A	801, 810, 821B	183.59	3'-2"	12	
46	20+90 - 14' LT.	ADJUST MANHOLE		182.97			
47	23+72 - 15' LT.	ADJUST MANHOLE		178.98			
48	24+60 - 21' LT.	CONSTRUCT CATCH BASIN, TYPE A	801, 810, 821B	178.22	3'-2"	14	
49	24+54 - 9' LT.	REMOVE CATCH BASIN					
50	24+54 - 8' RT.	REMOVE CATCH BASIN					
51	24+50 - 21' RT.	CONSTRUCT CATCH BASIN, TYPE A	801, 810, 821B	178.23	2'-9"	44	
52	26+58 - 15' LT.	ADJUST MANHOLE		179.80			
53	29+40 - 15' LT.	ADJUST MANHOLE		185.21		*48	
54	30+36 - 9' LT.	REMOVE CATCH BASIN					
55	31+50 - 15' LT.	ADJUST MANHOLE					
56	31+86 - 12' LT.	REMOVE CATCH BASIN					
27A	10+37 - 37' RT.	CONSTRUCT CATCH BASIN, TYPE A	801, 810, 821B	198.20	3'-2"	47	
34A	15+12 - C. L.	CONSTRUCT MANHOLE	CITY A AND B	187.36	5.74'	80	

STANDARD DETAIL PLATES		
ST. PAUL DRG. NO.	M.H.D. DRG. NO.	STANDARD DETAIL
	4126B	CATCH BASIN FRAME CASTING (NO. 801)
	4147B	GRATE CASTING FOR CATCH BASIN (NO. 810)
	4161C	CURB BOX CASTING FOR CATCH BASIN (NO. 821B)
2000		CATCH BASIN, TYPE A
2001		CATCH BASIN, TYPE B
2200		CATCH BASIN INSTALLATION DETAILS
19860		MANHOLE AND CATCH BASIN CASTING DETAILS
2213		MANHOLE DETAILS, PRECAST CONCRETE
1386		MANHOLE DETAILS, CONCRETE BLOCKS
17898		MANHOLE DETAILS, STANDARD
2299		MANHOLE STEPS, 12 INCH SIZE CAST IRON STANDARD
1038		MANHOLE STEPS, CAST IRON STANDARD
1100		PAVEMENT JOINTS
3000A		CONCRETE CURB
1201		CONCRETE DRIVEWAY, TYPE 2
756B		CONCRETE DRIVEWAY
565		TYPE A FULL BOX

NOTE: ST. PAUL STANDARD DRAWINGS ARE BOUND WITH THE SPECIAL PROVISIONS.  
MINNESOTA HIGHWAY DEPARTMENT STANDARD PLATES ARE INCLUDED BY REFERENCE (HIGHWAY DEPARTMENT MANUAL NO. 5-296).

ELEVATIONS OF MANHOLES ARE AT THE TOP OF CASTING AND ELEVATIONS OF CATCH BASINS ARE AT THE GUTTER LINE.  
STRUCTURE DEPTHS ARE APPROXIMATE.

\* THIS PIPE IS FOR CROSS PIPE AT STA. 28+35.  
SEE PLAN SHEET N. O.

QUANTITIES, SEWER CONST. CHART,  
& STANDARD DETAIL CHART  
PARKWAY DRIVE  
Payne Ave. to I.H. No. 61  
April 1963

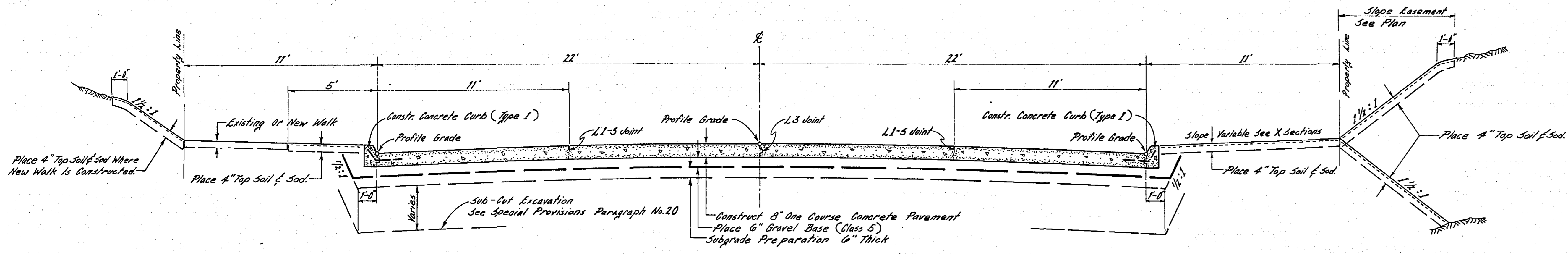

TYPICAL SECTION  
PARKWAY DRIVE  
Payne Ave. To T. H. No. 61

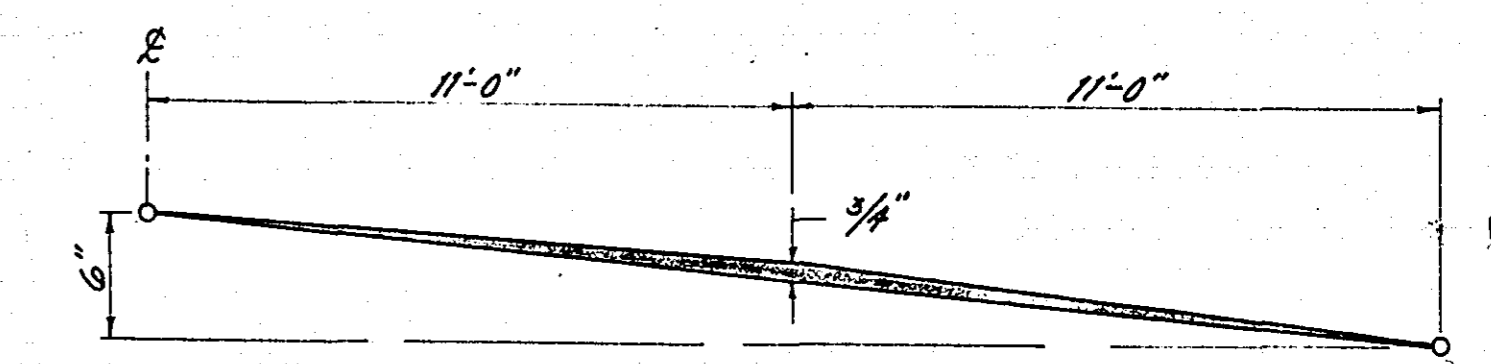

CROWN DETAIL  
PARKWAY DRIVE

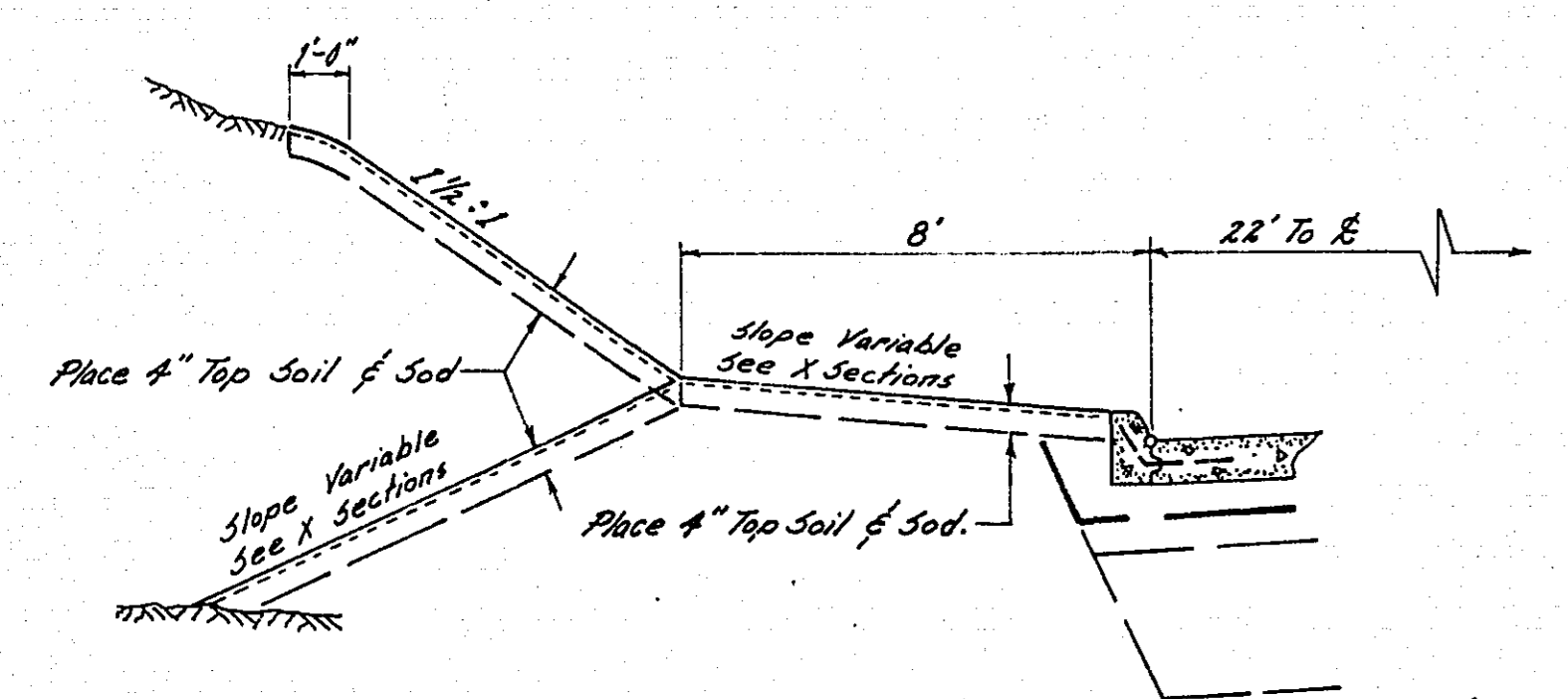

Sub-Section Left Side  
Larpenteur Ave. To T. H. No. 61

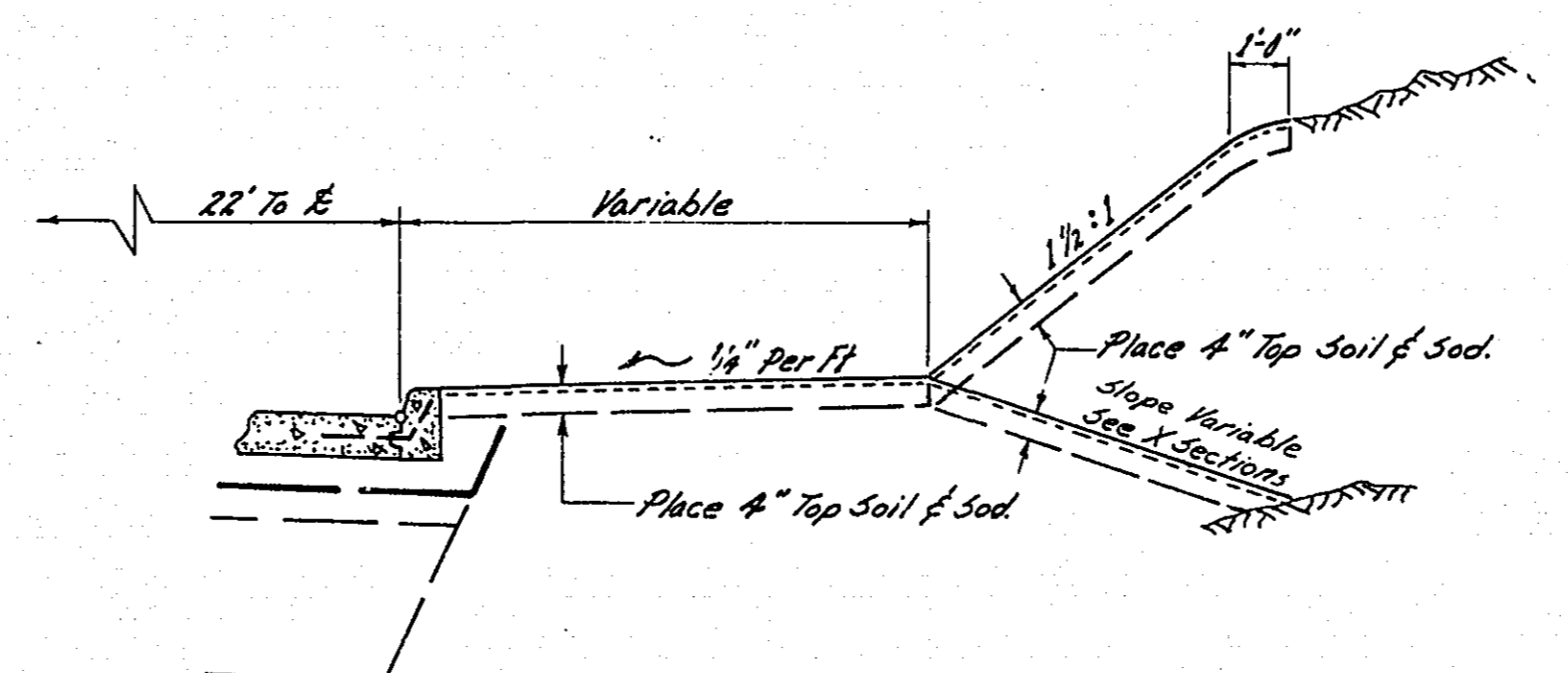

Sub-Section Right Side  
Larpenteur Ave. To T. H. No. 61

NOTE: All Dimensions & Slopes Shown  
Are Approximate. Thicknesses  
Shown Are For The Purpose Of  
Establishing Planned Line & Grade.

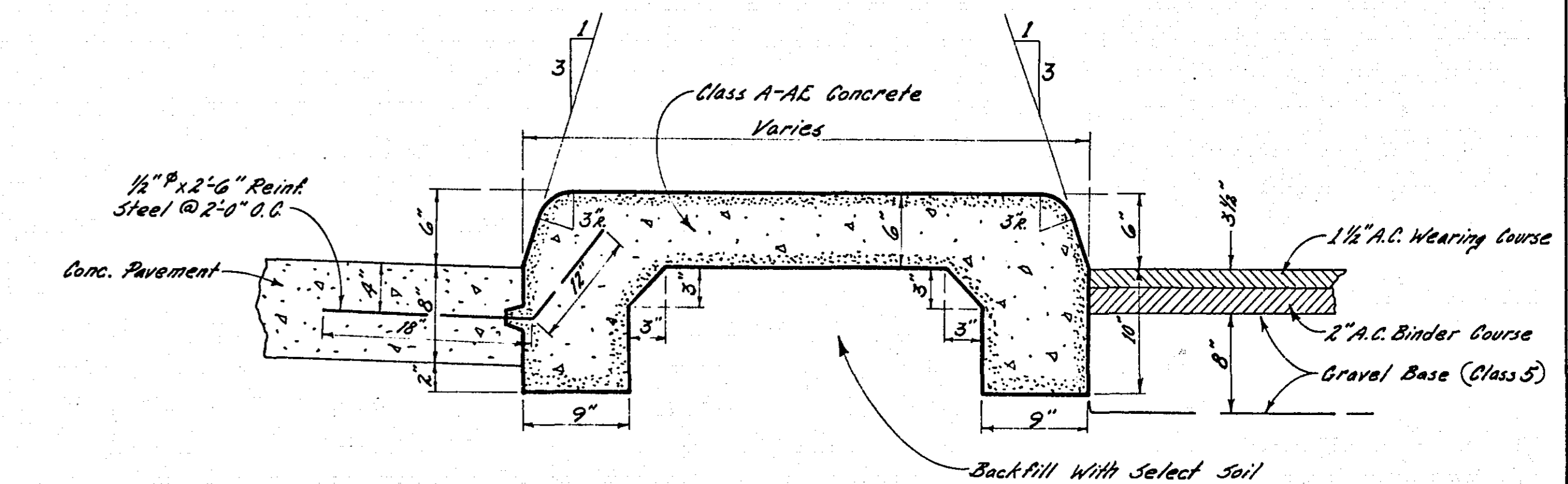

CONCRETE PROTECTIVE NOSE

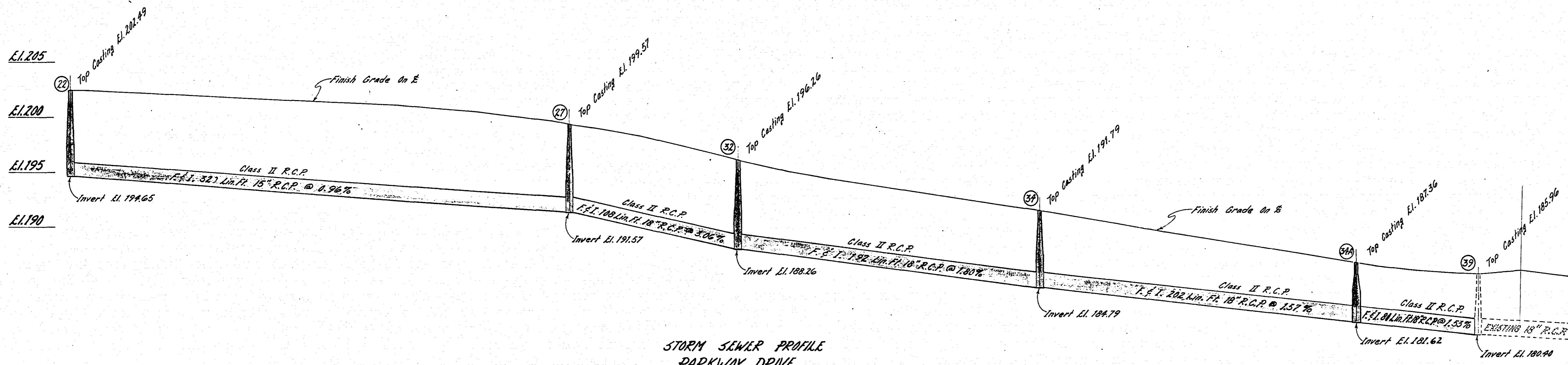

STORM SEWER PROFILE  
PARKWAY DRIVE  
Sta. 6+90 To Sta. 15+90  
Scale: 1" = 40' Horiz.  
1" = 6' Vert.

E.I. 190  
 E.I. 185  
 E.I. 180  
 E.I. 175

GRADING & PAVING  
 PARKWAY DRIVE  
 Payne Ave. To T. H. No. 61  
 Sheet 3 of 11 Sheets  
 Plan. Dr. 12 No. 920

TYPICAL SECTIONS  
 & SPECIAL DETAILS  
 PARKWAY DRIVE  
 Payne Ave. To T. H. No. 61  
 April 1963

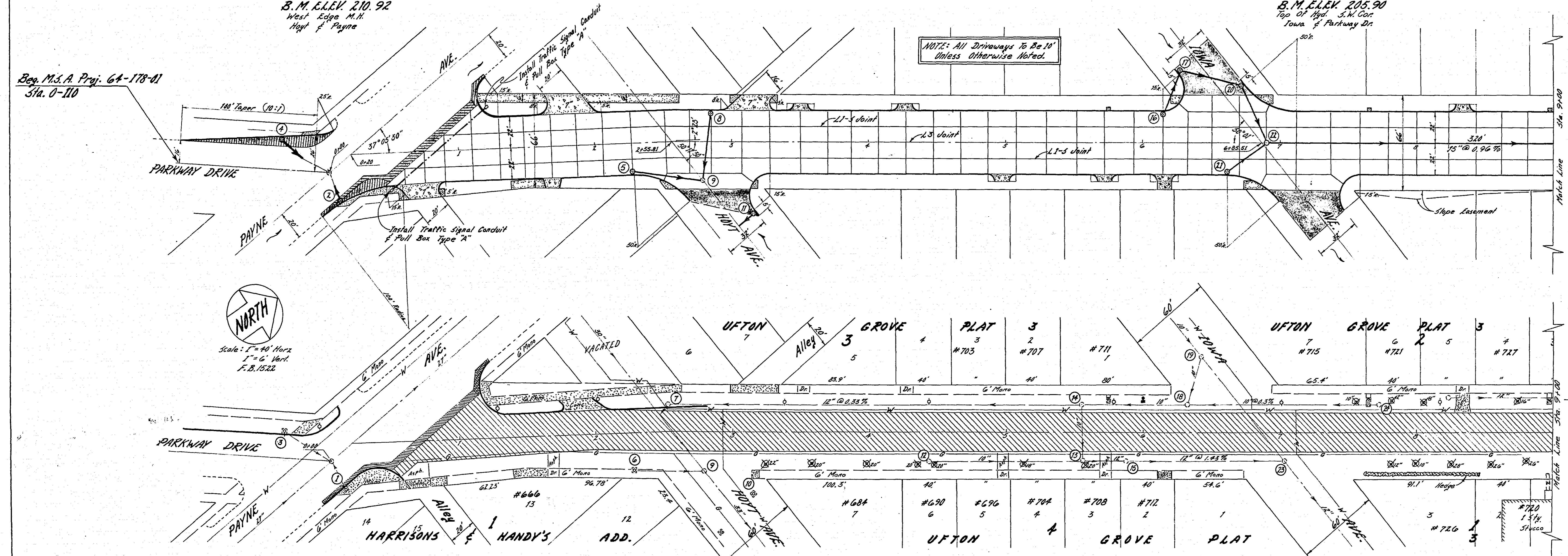
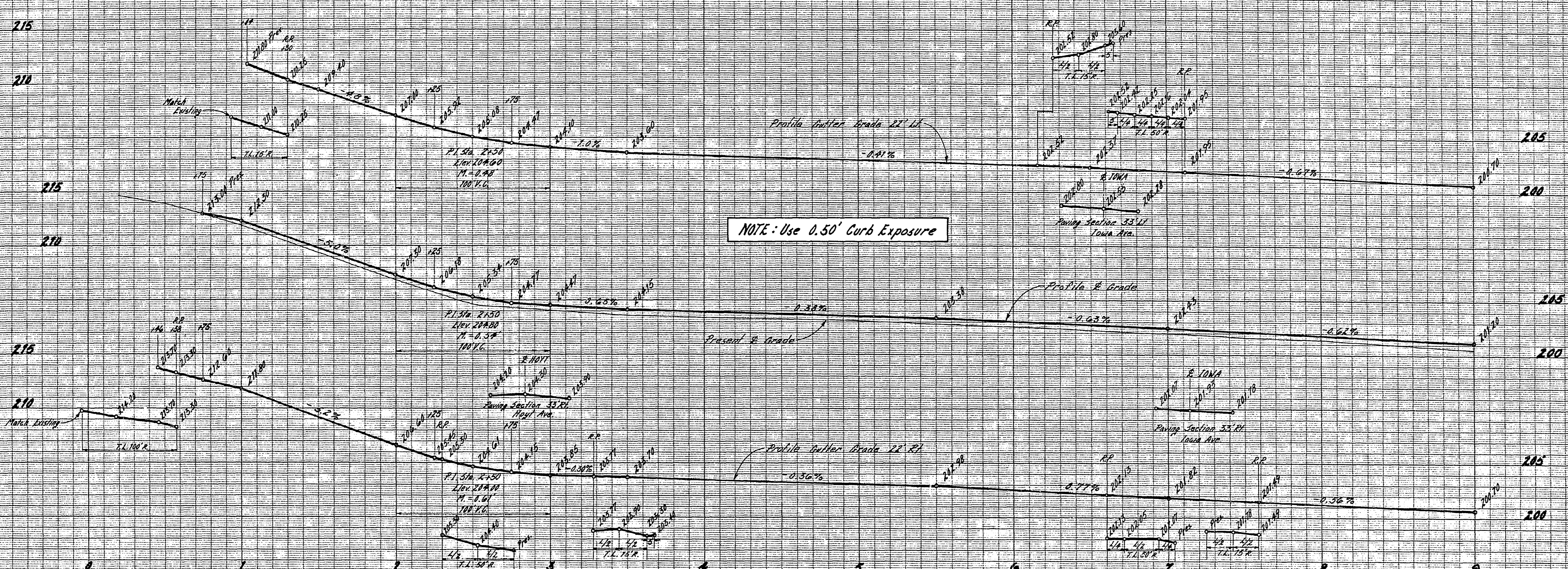

- CONSTRUCTION PLAN**  
Conventional Signs
- Construct 1 1/2" A.C. Wearing Course And Variable Thickness A.C. Binder Course Over 7" Concrete Base.
  - Construct 1" A.C. Wearing Course And Variable Thickness A.C. Binder Course Over 6" Concrete Base.
  - Construct 2" Thick A.C. Wearing Course.
  - Construct Mono-Conc. Drives, Alleys, & Crosswalks.
  - Construct 4" Mono-Conc. Walk.
  - Construct Conc. Curb (Type I)
  - Construct Catch Basin (No. Refers To Sewer Chart)
  - Construct Manhole (No. Refers To Sewer Chart)
  - Construct Sewer.
  - Construct Concrete Protective Nose

- REMOVAL PLAN**  
Conventional Signs
- Remove Concrete Pavement
  - Remove Asph. Surfacing (Over Existing Base)
  - Remove Asph. Surfacing & Existing Base.
  - Remove Concrete Walks, Driveways, Crosswalks, & Steps.
  - Remove Curb.
  - Remove Tree Or Stump (No. Denotes Size)
  - Existing Sewer & Manhole (No. Refers To Sewer Chart)
  - Existing Catch Basin (No. Refers To Sewer Chart)
  - Existing Hydrant (To Be Relocated By Others)
  - Existing Water Main.
  - Existing Gas Main.
  - Existing Telephone Conduit.
  - Existing Utility Pole (To Be Relocated By Others)
  - Existing Fence.
  - Existing Curb.
  - Existing Traffic Signal.

GRADING & PAVING  
PARKWAY DRIVE  
Payne Ave. To I.H. No. 61  
Sheet 4 of 11 Sheets  
Plan No. 920

CONSTRUCTION & REMOVAL PLAN  
PARKWAY DRIVE  
Payne Ave. To I.H. No. 61  
Payne Ave. To Sta. 9+00  
April 1963

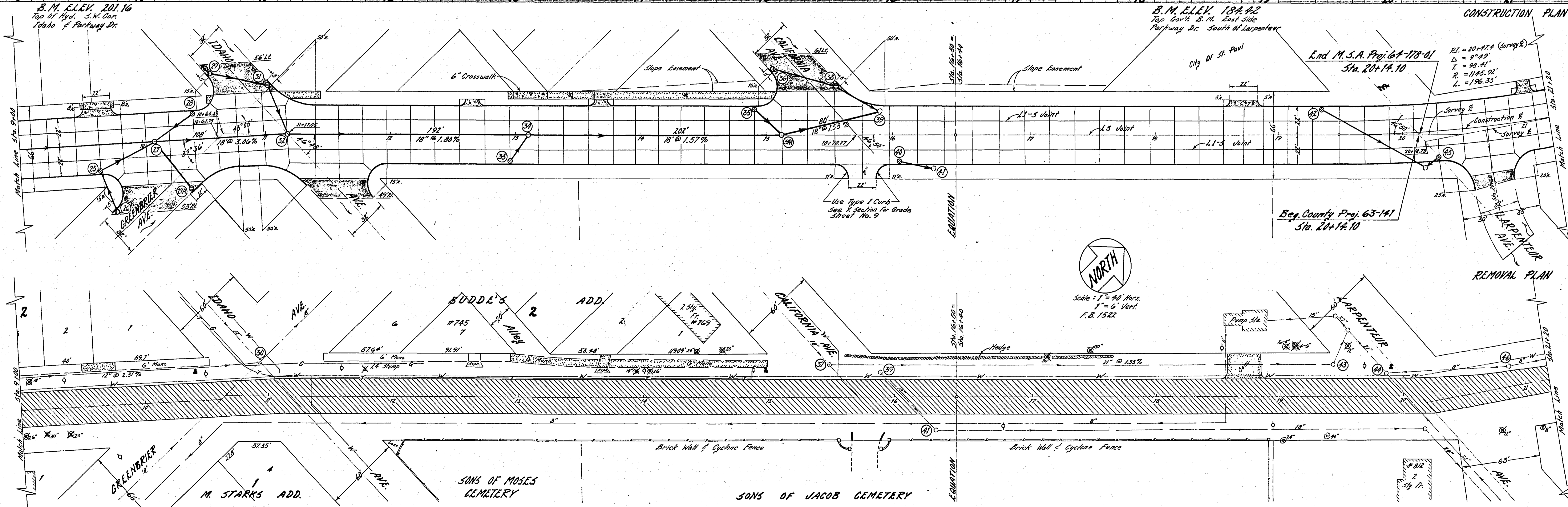
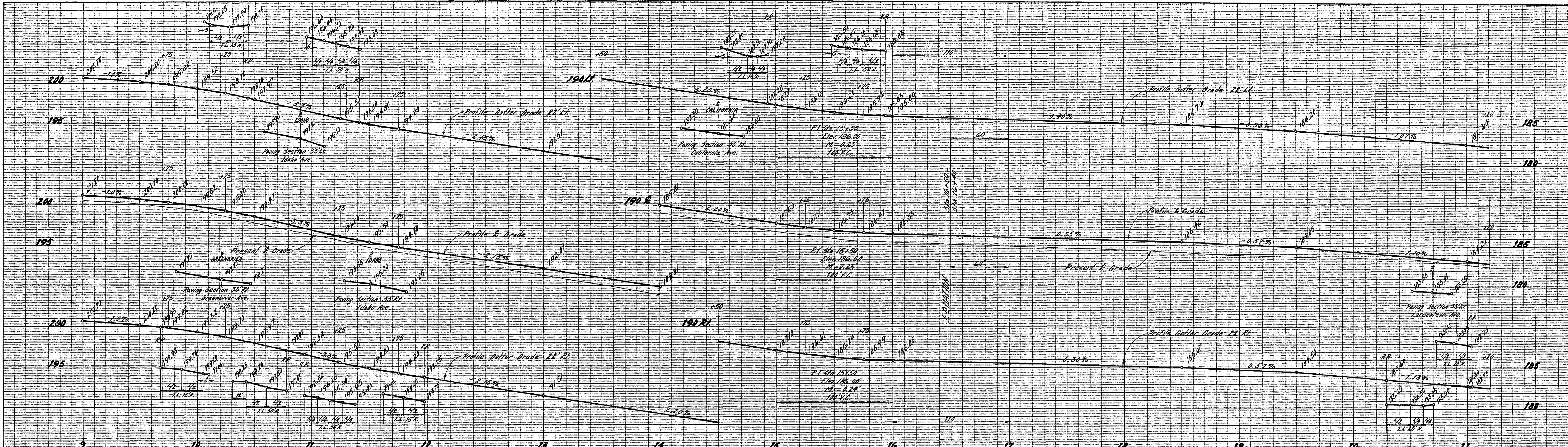

GRADING & PAVING  
 PARKWAY DRIVE  
 Payne Ave. to T.H. No. 61  
 Sheet 5 of 11 Sheets  
 Plan. Dr. 12 No. 520

CONSTRUCTION & REMOVAL PLAN  
 PARKWAY DRIVE  
 Payne Ave. to T.H. No. 61  
 Sta. 9+00 to Sta. 21+00  
 April 1963

NOTE: Use 0.50' Curb Exposure

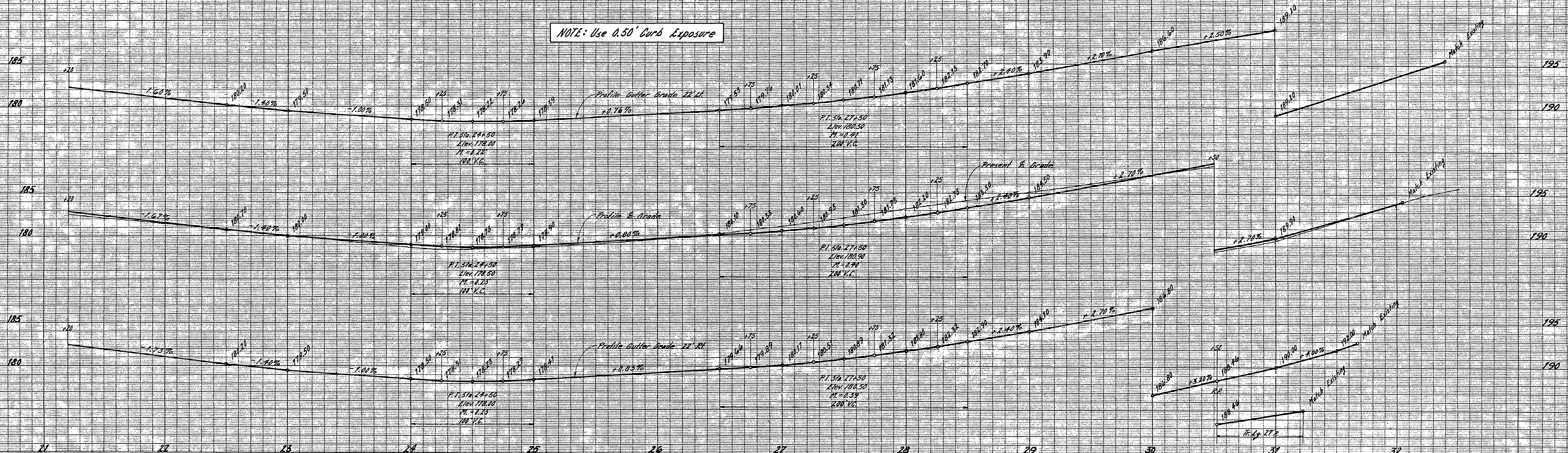

B. M. ELEV. 184.42  
700 Cor. N. B. M. East Side  
Parkway Dr. South of L'Assommoir

NOTE: All Driveways To Be 10' Unless Otherwise Noted.

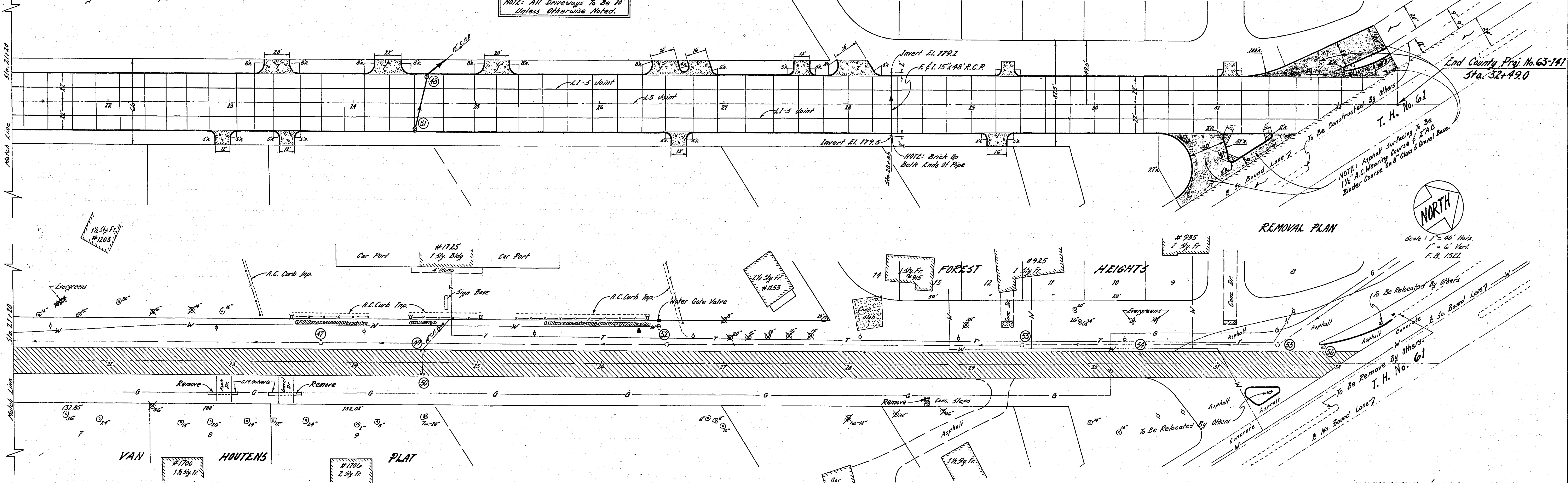

REMOVAL PLAN

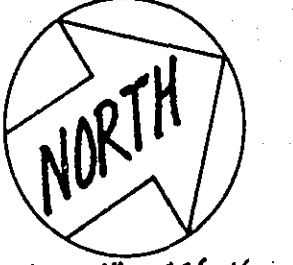

Scale: 1" = 40' Horiz.  
1" = 6' Vert.  
F.S. 1522

GRADING & PAVING  
PARKWAY DRIVE  
Payne Ave. To T.H. No. 61  
Sheet 6 of 11 Sheets  
Plan. Dr. 12 No. 920

CONSTRUCTION & REMOVAL PLAN  
PARKWAY DRIVE  
Payne Ave. To T.H. No. 61  
Sta. 21+20 To T.H. No. 61  
April 1963

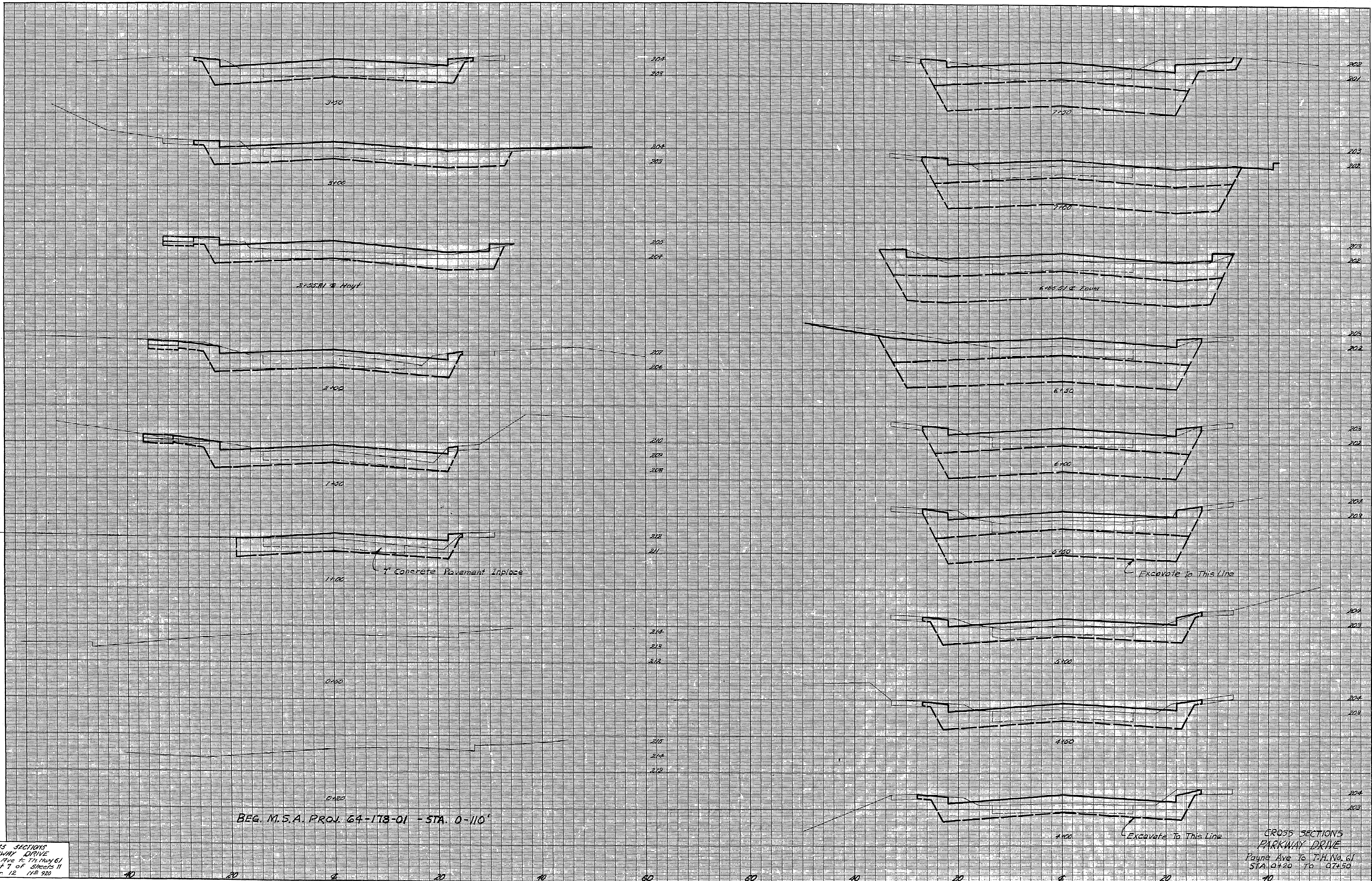

BEG. M.S.A. PROJ. 64-178-01 - STA. 0-110'

Excavate to This Line

Excavate to This Line

CROSS SECTIONS  
 PARKWAY DRIVE  
 Payne Ave to T.H. No. 61  
 STA. 0+20 TO 0+50

CROSS SECTIONS  
 PARKWAY DRIVE  
 Payne Ave to T.H. No. 61  
 Sheet 7 of Sheets 11  
 Pav. Dr. 12 118 920

CROSS SECTIONS  
 PARKWAY DRIVE  
 Payne Ave to 7th Street  
 Sheet 8 of 11 Sheets  
 Proj. No. 12 112-920

40 20 0 20 40

196  
195  
194  
196  
195  
198  
197  
200  
199  
198  
201  
200  
201  
202  
201  
202  
203  
202  
201

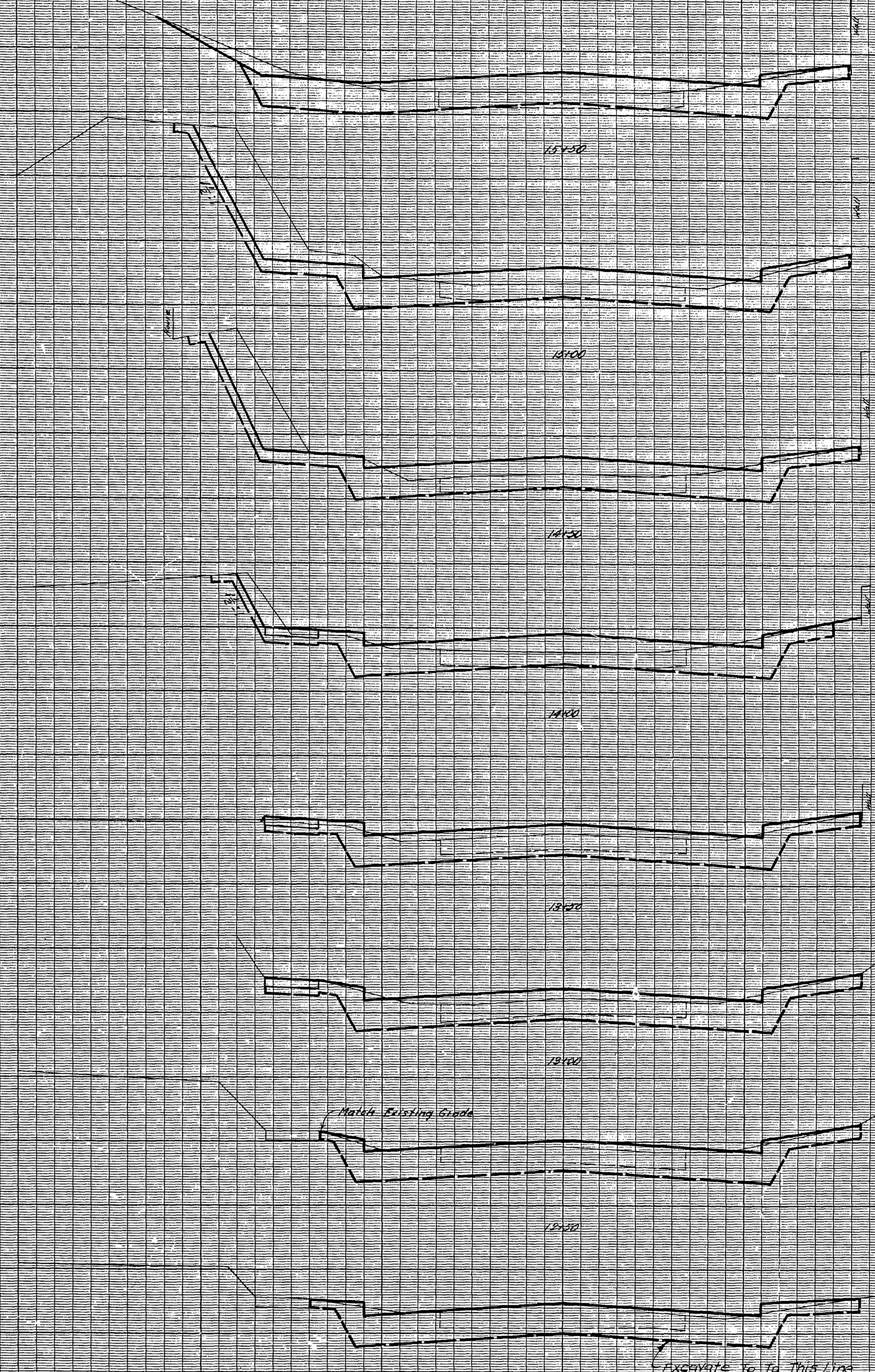
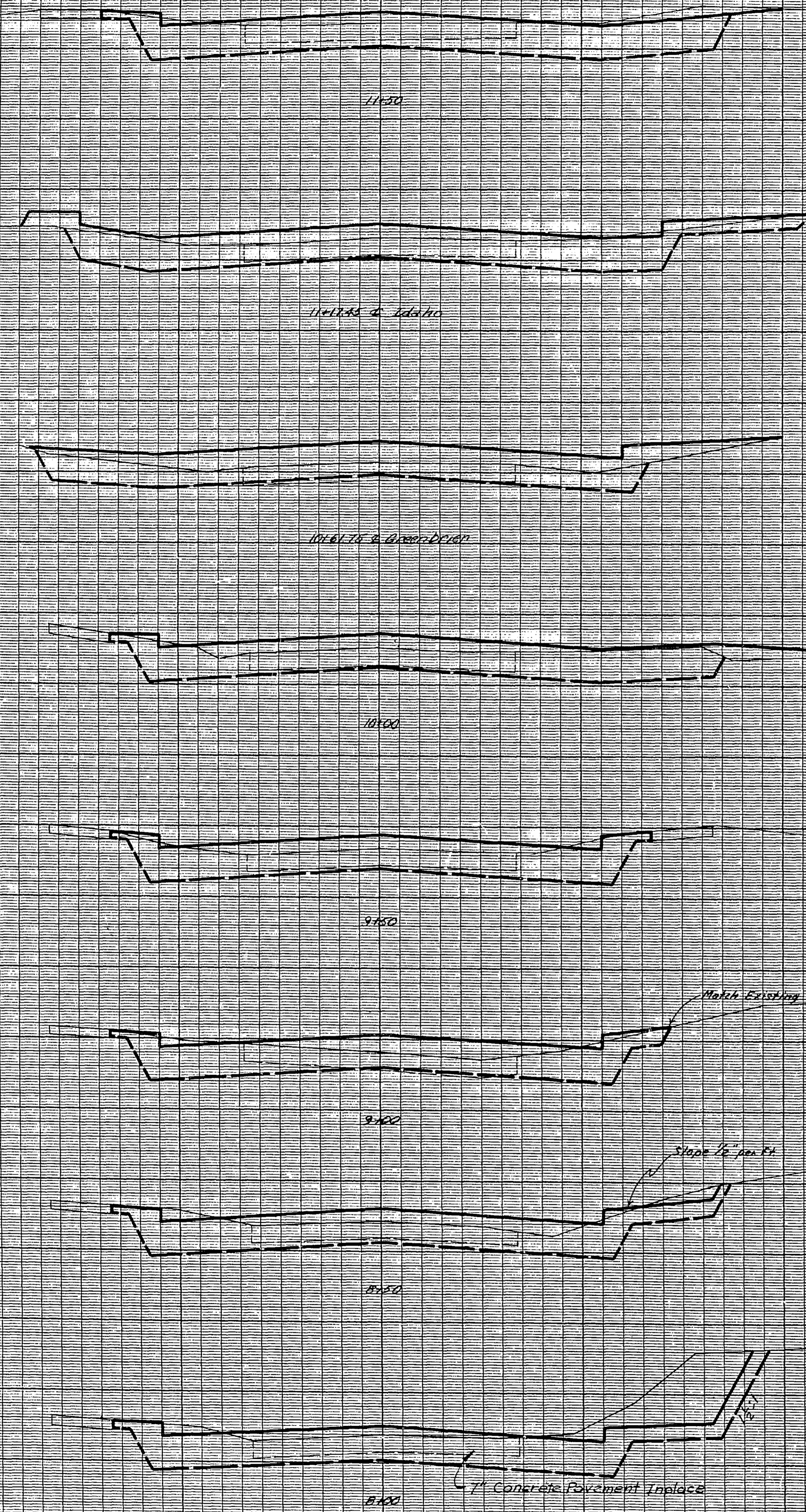

CROSS SECTIONS  
 PARKWAY DRIVE  
 Payne Ave to T.H. No. 61  
 STA 8+00 TO 15+30



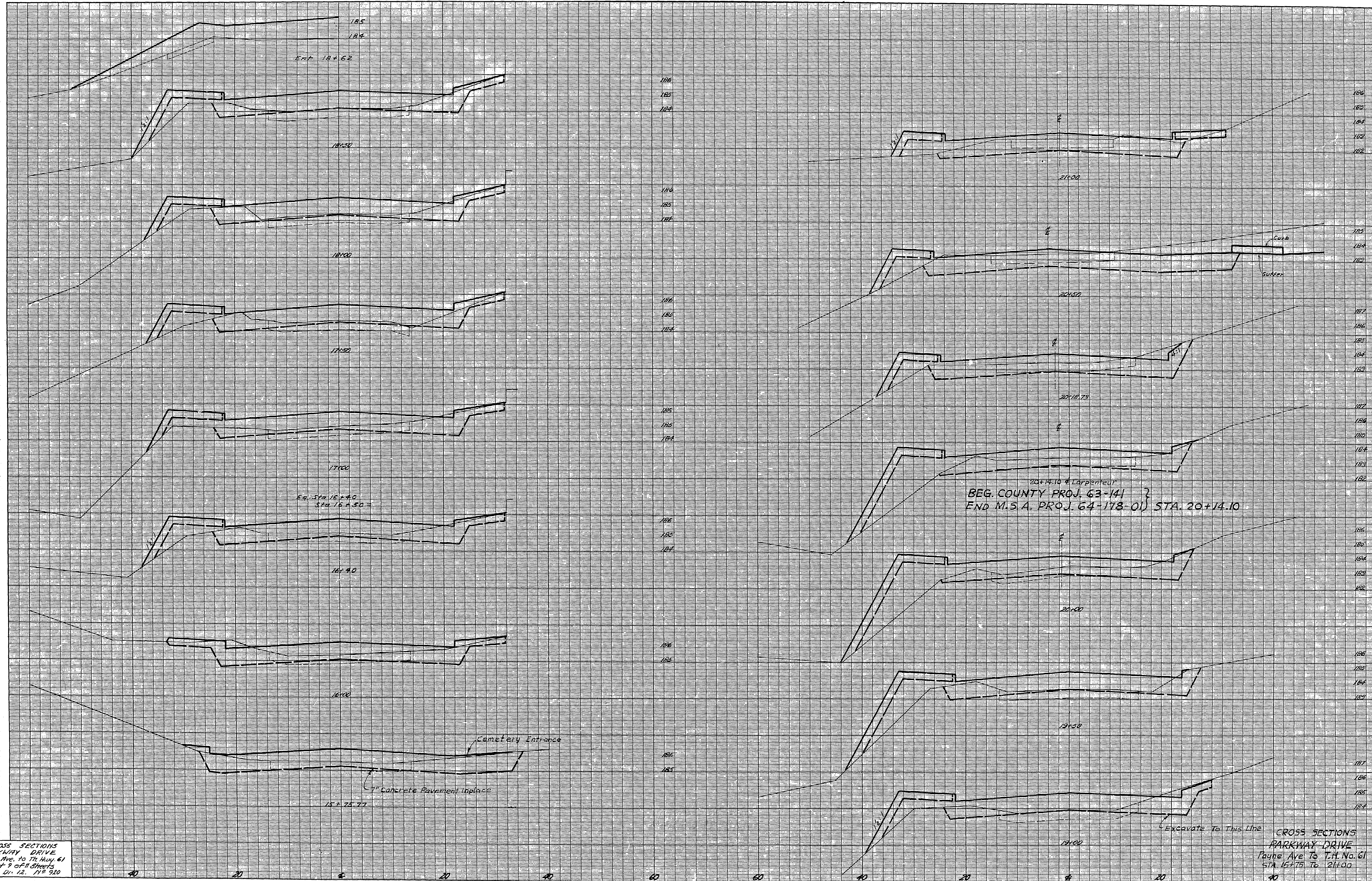

CROSS SECTIONS  
 PARKWAY DRIVE  
 Payne Ave. to T.H. No. 61  
 Sheet 9 of 11 Sheets  
 Rev. 12. 11' 910

CROSS SECTIONS  
 PARKWAY DRIVE  
 Payne Ave. to T.H. No. 61  
 STA 15+75 TO 21+00

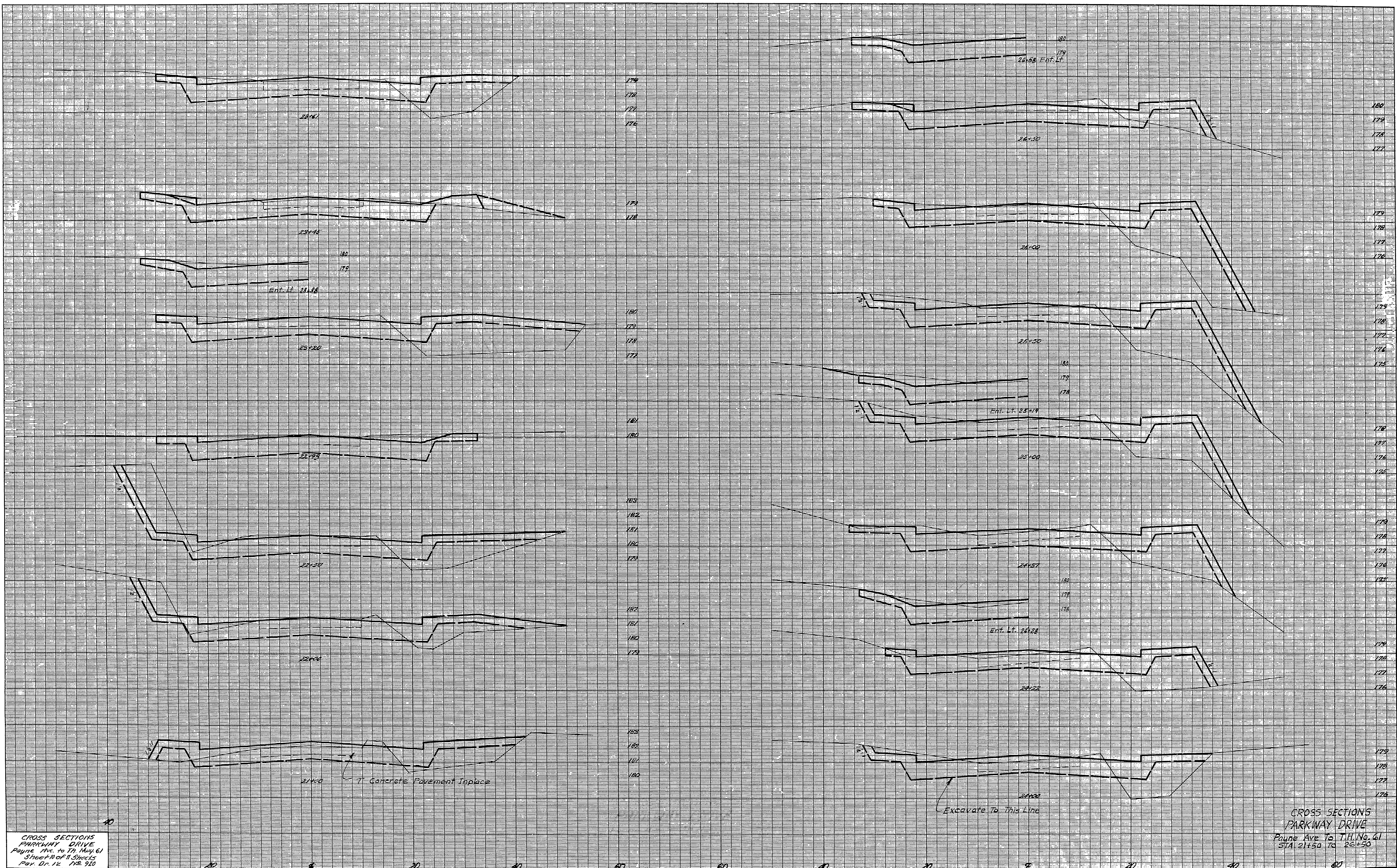

CROSS SECTIONS  
 PARKWAY DRIVE  
 Payne Ave. to T.H. No. 61  
 Sheet 10 of 11 Sheets  
 Pav. Dr. 12 No. 920

CROSS SECTIONS  
 PARKWAY DRIVE  
 Payne Ave. to T.H. No. 61  
 STA. 21+30 TO 26+50

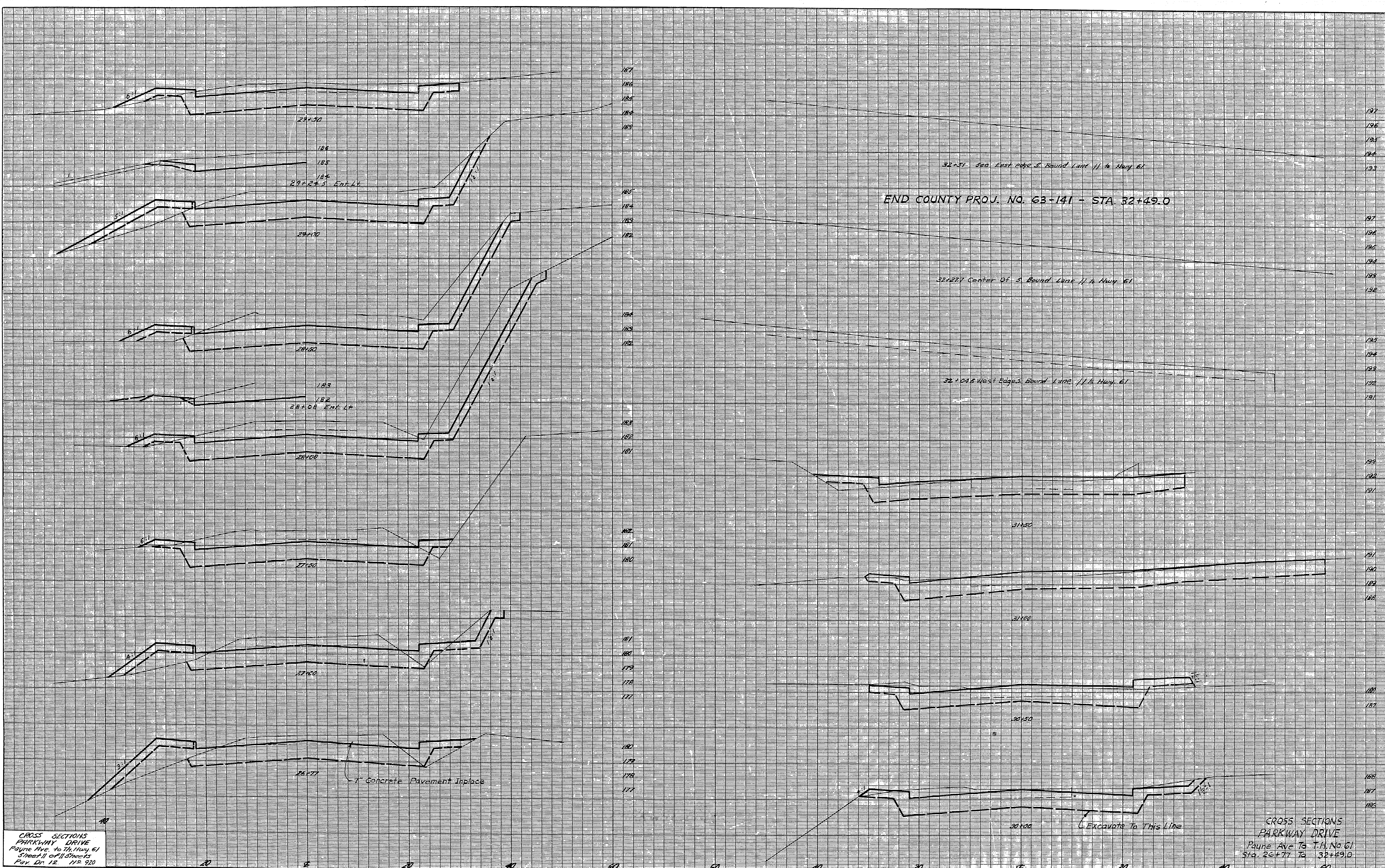

CROSS SECTIONS  
 PARKWAY DRIVE  
 Payne Ave. to T.H. No. 61  
 Sheet II of II Sheets  
 Proj. No. 12 118 920

CROSS SECTIONS  
 PARKWAY DRIVE  
 Payne Ave. to T.H. No. 61  
 Sta. 26+77 to 32+49.0