

**CONVENTIONAL SIGNS**

STATE LINE	=====	TIMBER	.....
COUNTY LINE	=====	BRUSH	.....
TOWNSHIP OR RANGE LINE	=====	ORCHARD	.....
SECTION LINE	=====	ROCK LEDGE	.....
QUARTER LINE	=====	SAND	.....
SIXTEENTH LINE	=====	EDGE OF CUT	.....
RIGHT-OF-WAY LINE	=====	TOE OF EMBANKMENT	.....
PROPERTY LINE (Except Land Lines)	=====	CATCH BASIN	.....
VACATED PLATTED PROPERTY	=====	MANHOLE	.....
CORPORATE OR CITY LIMITS	=====	FIRE HYDRANT	.....
TRUNK HIGHWAY CENTER LINE	=====	ARC LAMP	.....
RETAINING WALL	=====	OTHER LAMPS (State Kind)	.....
STEAM RAILROAD	=====	RAILROAD CROSSING SIGN	.....
ELECTRIC RAILROAD	=====	RAILROAD CROSSING BELL	.....
RAILROAD RIGHT-OF-WAY LINE	=====	ELECTRIC WARNING SIGN	.....
CREEK	=====	CROSSING GATE	.....
RAPIDS OR WATERFALL	=====	CATTLE GUARD	.....
DRY RUN	=====	OVERHEAD (Highway Over)	.....
DRAINAGE DITCH	=====	UNDERPASS (Highway Under)	.....
HIGH TENSION LINE	=====	ABUTMENT, WALL & PIER	.....
POWER POLE LINE	=====	BRIDGE	.....
TELEPHONE OR TELEGRAPH LINE	=====	BUILDING (One Story Frame)	.....
CULVERT	=====	F-FRAME C-CONCRETE	.....
DROP INLET	=====	S-STONE T-TILE	.....
GUARD RAIL	=====	B-BRICK ST-STUCCO	.....
WIRE FENCE	=====	IRON PIPE	.....
RAILROAD SNOW FENCE	=====	STONE MONUMENT	.....
BOARD OR HIGHWAY SNOW FENCE	=====	WOOD STAKE OR HUB	.....
STONE WALL OR FENCE	=====	MEANDER CORNER	.....
HEDGE	=====		
WATER PIPE	=====		
SEWER PIPE	=====		
DRAIN TILE	=====		
GRAVEL PIT	=====		
SAND PIT	=====		
CLAY PIT	=====		
ROCK QUARRY	=====		
SPRINGS	=====		
MARSH	=====		
TRUNK HIGHWAY R/W	=====		
RAILROAD R/W	=====		
PRESENT ROAD R/W	=====		

**OFFICE OF COUNTY SURVEYOR**

**RAMSEY COUNTY  
BITUMINOUS SURFACING  
COUNTY ROAD - "B"**

From S.T.H. No. 61 To White Bear Ave.

GROSS LENGTH 8299 FEET 1.57 MILES  
LENGTH OF EXCEPTIONS FEET MILES  
NET LENGTH 8299 FEET 1.57 MILES

PLAN, 1 Inch = 100 Feet  
PROFILE, Horiz. 1 Inch = 100 Feet, Vert. 1 Inch = 10 Feet  
WORKING PLANS Horiz. 1 Inch = 100 Feet, Vert. 1 Inch = 10 Feet  
Cross-Sections, 1 Inch = Feet

LAYOUT  
SCALE, 1 Inch = 2640 Feet

**INDEX**

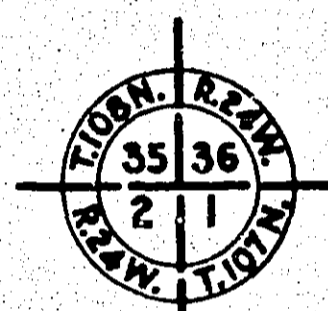
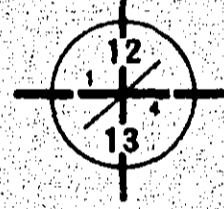
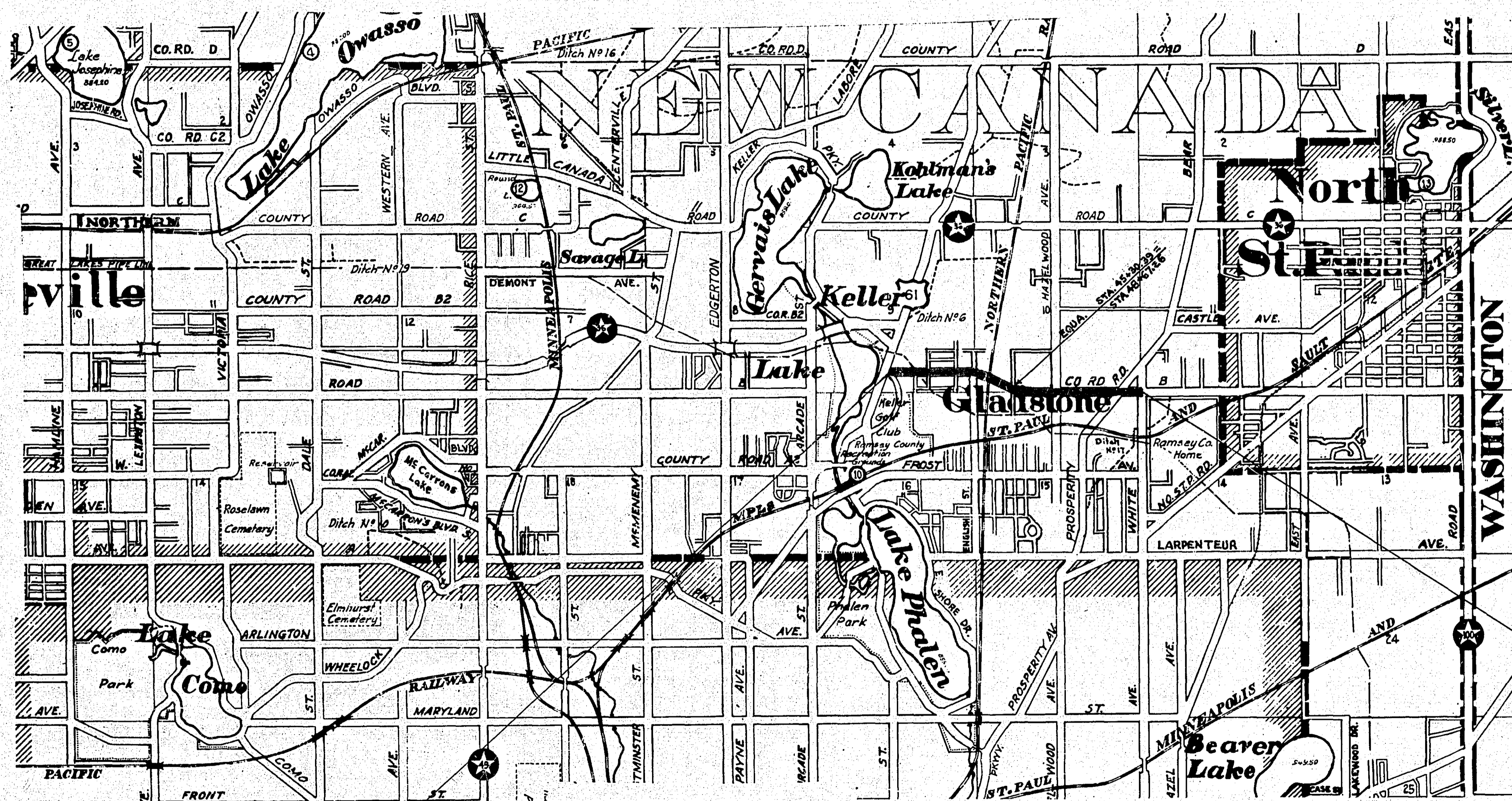

NOTE: SECTION NUMBERS READ FROM THE SOUTH



END OF PROJ.  
STA. 86+85

BEG. PROJ.  
STA. 0+50

APPROVED *Harry J. Brown* 1952  
COUNTY SURVEYOR

APPROVED *7/21 1952* *James J. Brown*  
CHAIRMAN, RAMSEY COUNTY BOARD

RECOMMENDED FOR APPROVAL *G. J. McArthur*  
DISTRICT ENGINEER

RECOMMENDED FOR APPROVAL *J. M. Brown* 8/25/52  
ENGINEER OF COUNTY DIVISION

APPROVED *8/25 1952* *F. J. Hadman*  
ENGINEER OF PLANS & SURVEYS

I HEREBY CERTIFY THAT THIS PLAN WAS PREPARED BY ME OR UNDER MY DIRECT SUPERVISION AND THAT I AM A DULY REGISTERED PROFESSIONAL ENGINEER UNDER THE LAWS OF THE STATE OF MINNESOTA.

DATE \_\_\_\_\_ REG. NO. \_\_\_\_\_

PLAN  
 NOTE BOOK: ALIGNED TO CORNER  
 DATE: 10/1/20  
 BY: [Signature]

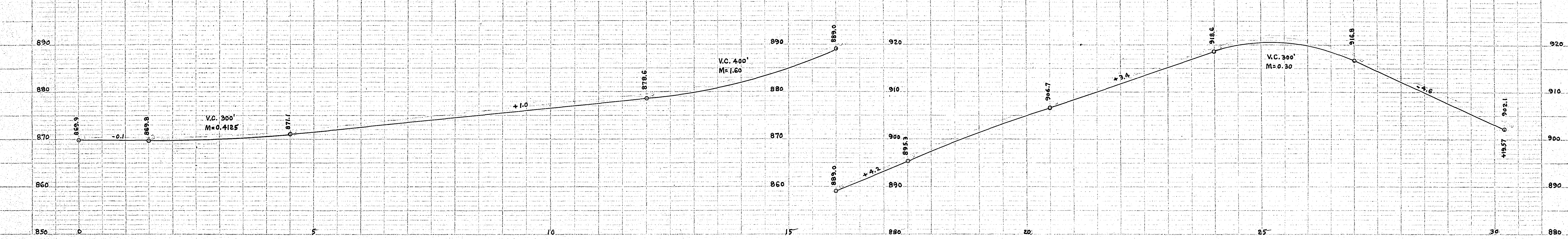
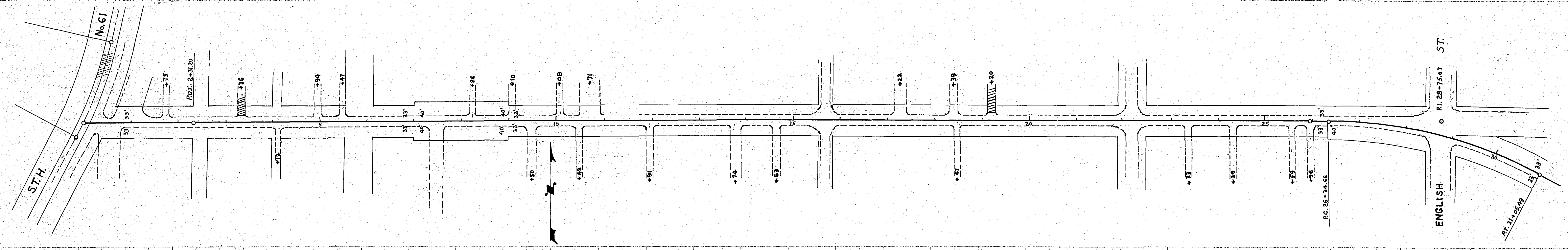

PROFILE  
 NOTE BOOK: ALIGNED TO CORNER  
 DATE: 10/1/20  
 BY: [Signature]

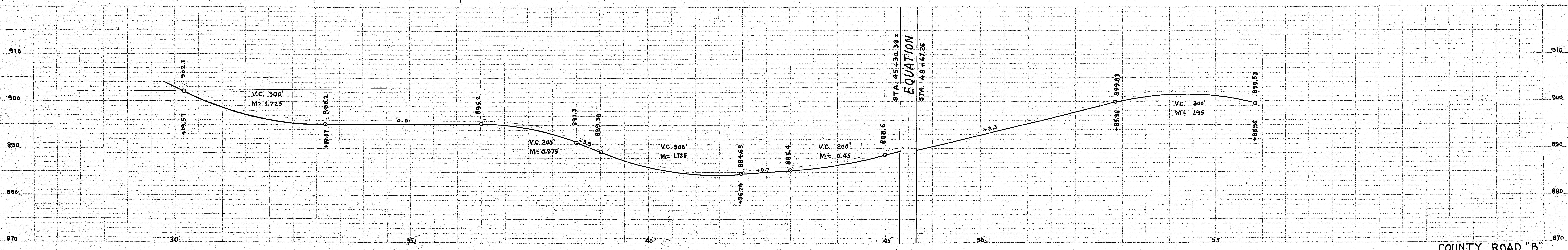
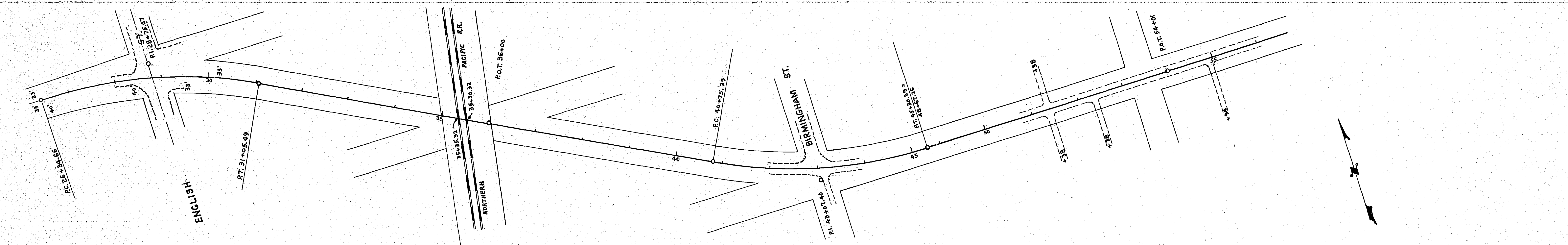

PLAN	REVISIONS
NO.	DATE
1	
2	
3	
4	
5	
6	
7	
8	
9	
10	
11	
12	
13	
14	
15	
16	
17	
18	
19	
20	
21	
22	
23	
24	
25	
26	
27	
28	
29	
30	

PROFILE	REVISIONS
NO.	DATE
1	
2	
3	
4	
5	
6	
7	
8	
9	
10	
11	
12	
13	
14	
15	
16	
17	
18	
19	
20	
21	
22	
23	
24	
25	
26	
27	
28	
29	
30	

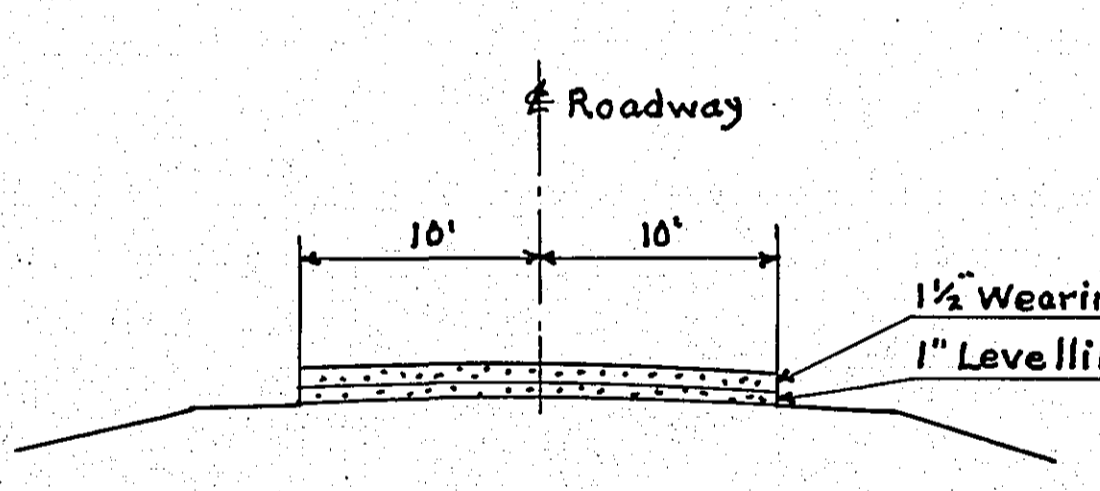
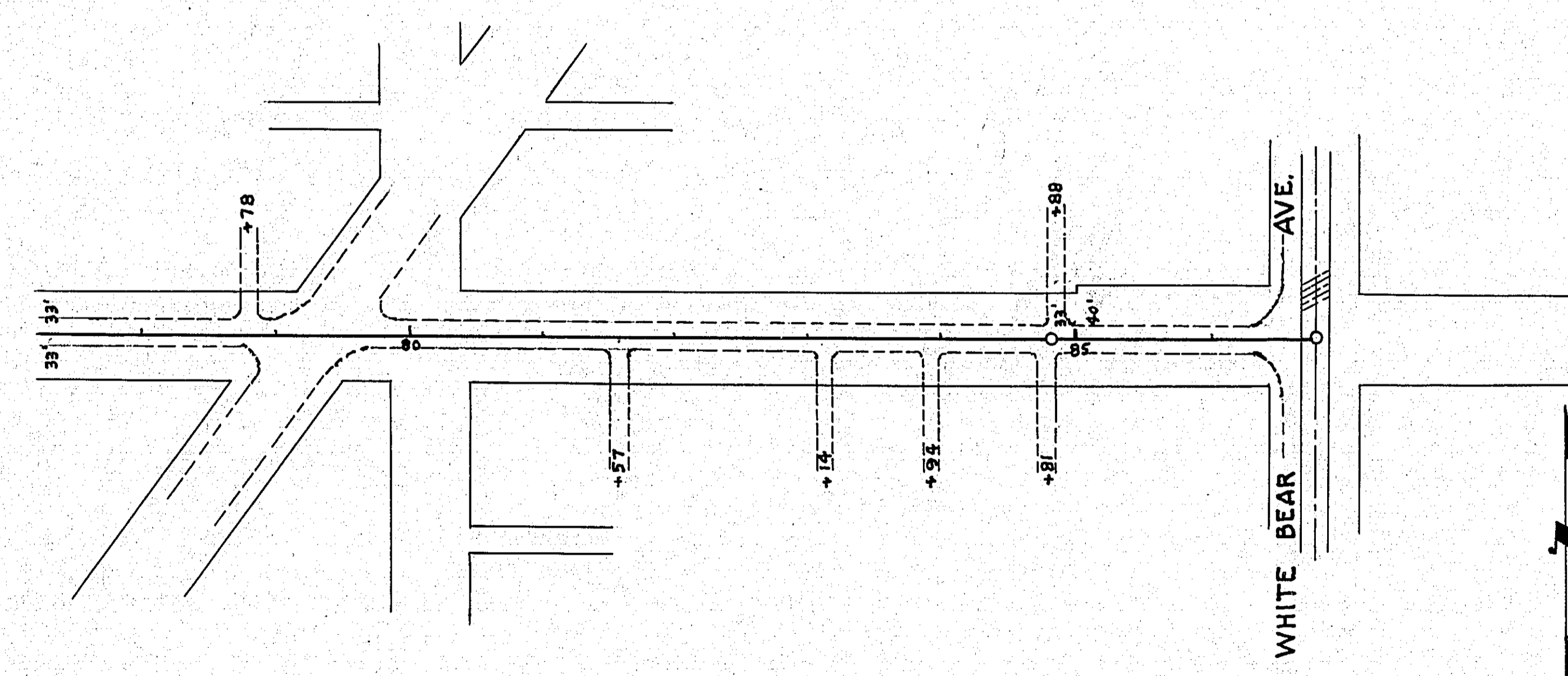
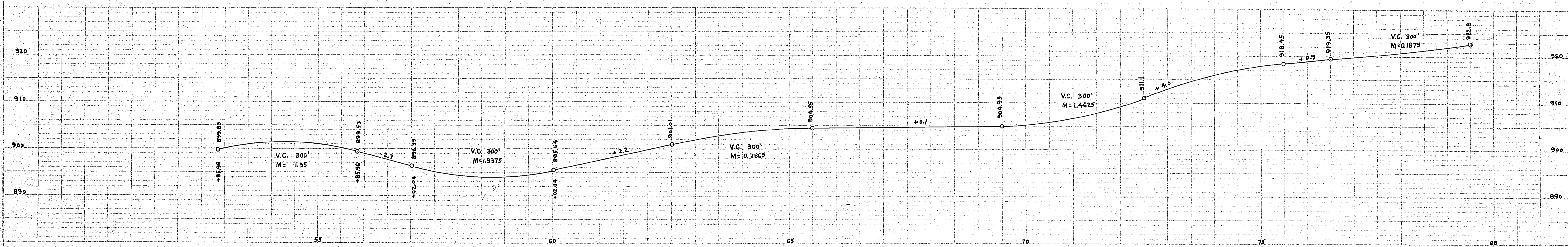
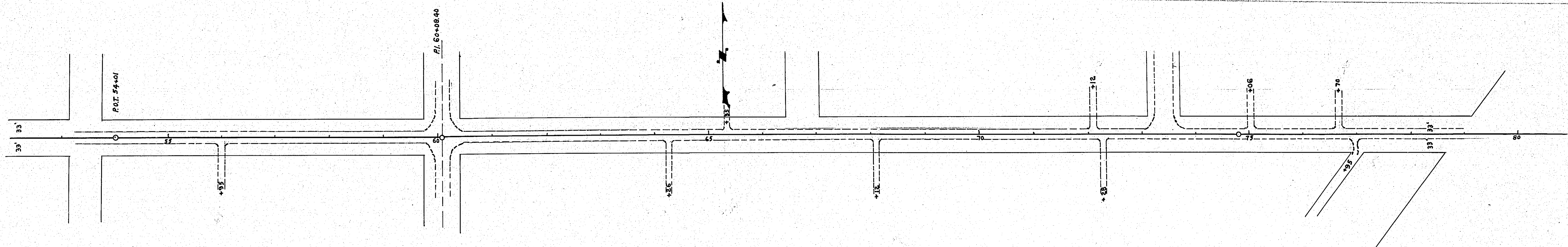

TYPICAL SURFACING SECTION

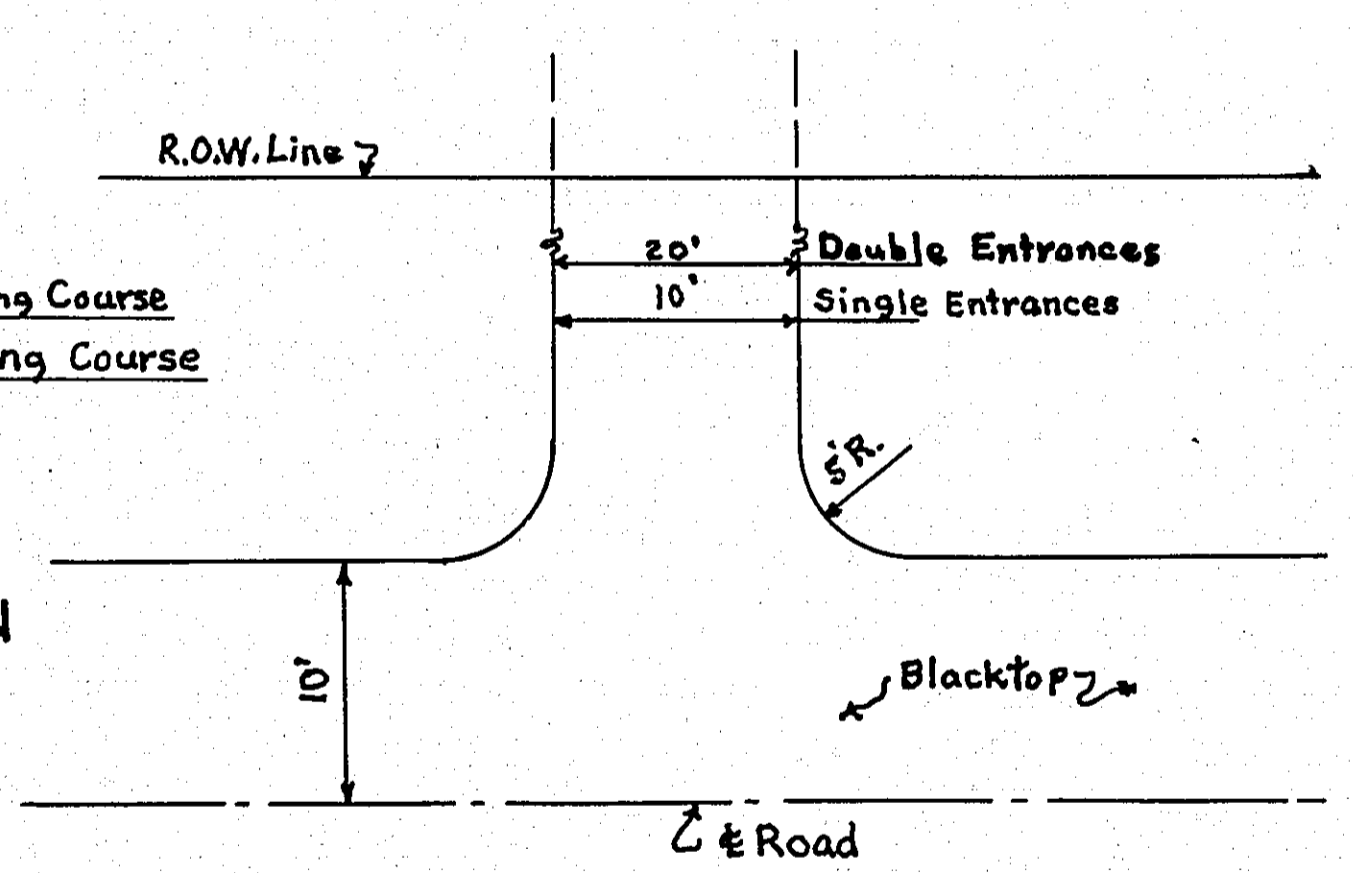

TYPICAL ENTRANCE PLAN

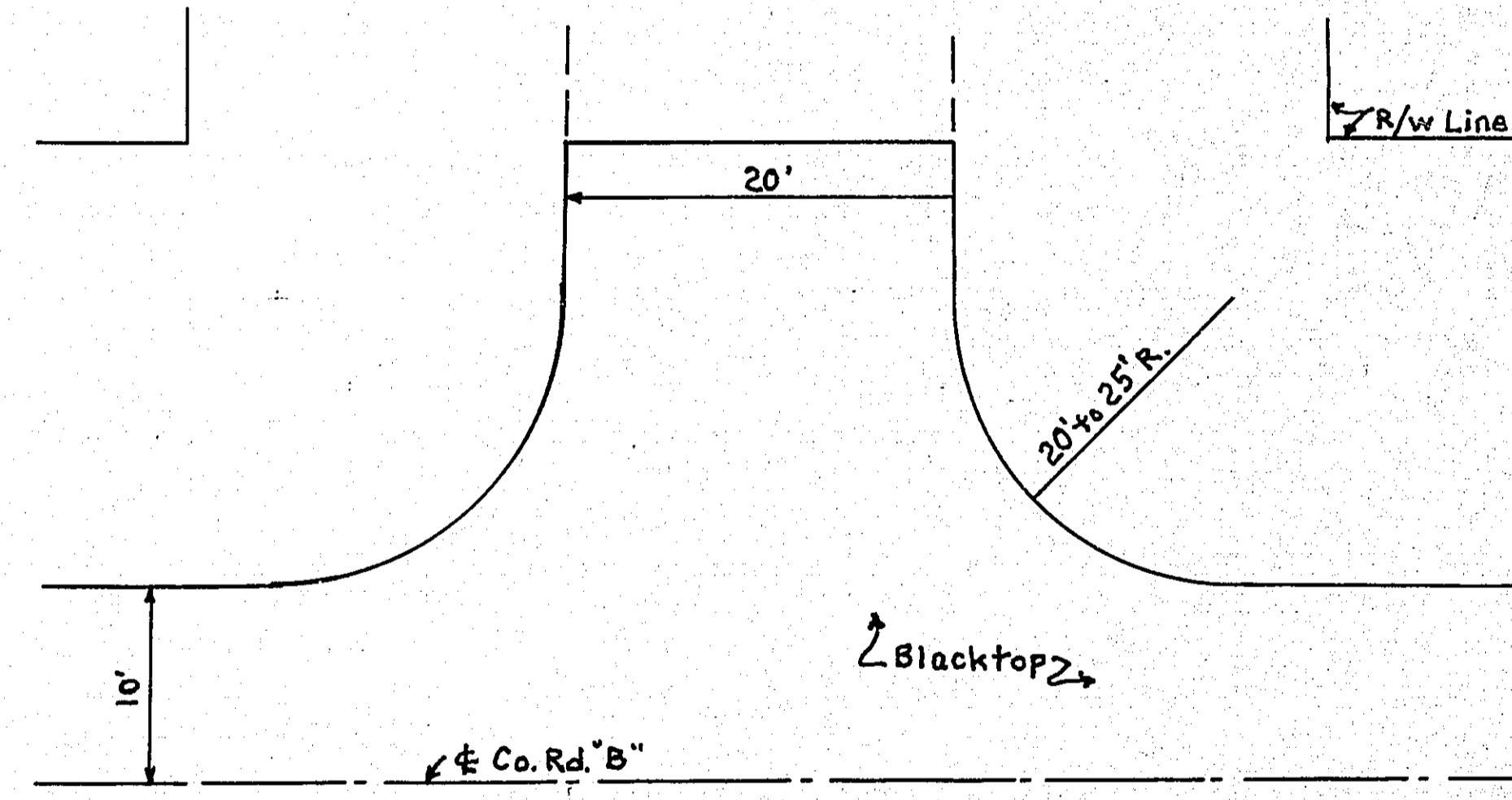

TYPICAL STREET INTERSECTION

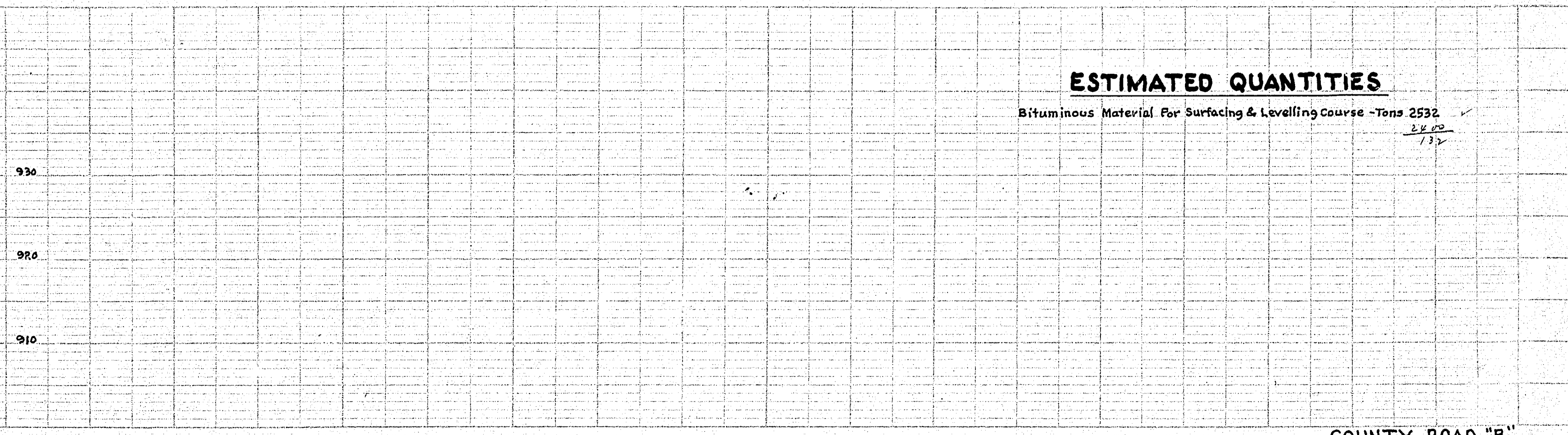
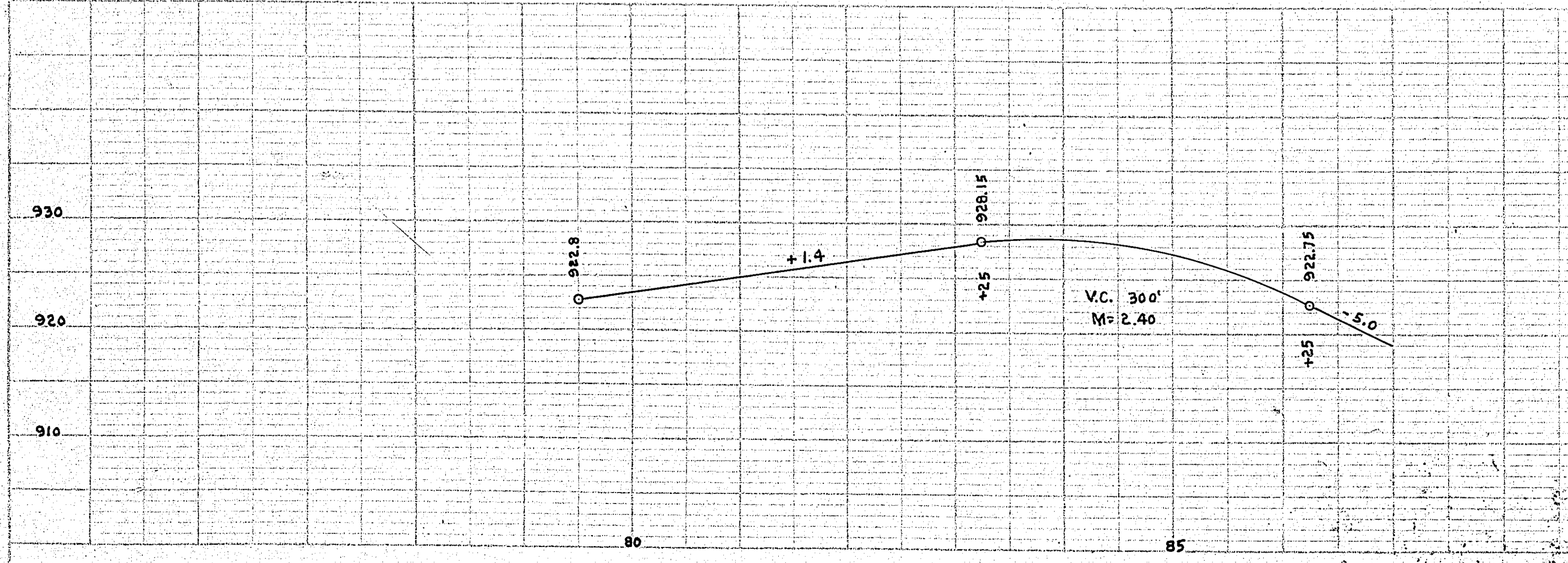

PLATE 2 - PLAN & PROFILE OF ROADWAY

**CONVENTIONAL SIGNS**

STATE LINE	.....	TIMBER	
COUNTY LINE	.....	BRUSH	
TOWNSHIP OR RANGE LINE	.....	ORCHARD	
SECTION LINE	.....	ROCK LEDGE	
QUARTER LINE	.....	SAND	
SIXTEENTH LINE	.....	EDGE OF CUT	
RIGHT-OF-WAY LINE	.....	TOE OF EMBANKMENT	
PROPERTY LINE (Except Land Lines)	.....	CATCH BASIN	
VACATED, PLATTED PROPERTY	.....	MANHOLE	
CORPORATE OR CITY LIMITS	.....	FIRE HYDRANT	
TRUNK HIGHWAY CENTER LINE	.....	ARC LAMP	
RETAINING WALL		OTHER LAMPS (State Kind)	
STEAM RAILROAD		RAILROAD CROSSING SIGN	
ELECTRIC RAILROAD		RAILROAD CROSSING BELL	
RAILROAD RIGHT-OF-WAY LINE	.....	ELECTRIC WARNING SIGN	
CREEK		CROSSING GATE	
RAPIDS OR WATERFALL		CATTLE GUARD	
DRY RUN		OVERHEAD (Highway Over)	
DRAINAGE DITCH		UNDERPASS (Highway Under)	
HIGH TENSION LINE		ABUTMENT, WALL & PIER	
POWER POLE LINE		BRIDGE	
TELEPHONE OR TELEGRAPH LINE		BUILDING (One Story Frame)	
CULVERT		F-FRAME	
DROP INLET		C-CONCRETE	
GUARD RAIL		S-STONE	
WIRE FENCE		T-TILE	
RAILROAD SNOW FENCE		B-BRICK	
BOARD OR HIGHWAY SNOW FENCE		ST-STUCCO	
STONE WALL OR FENCE		IRON PIPE	
HEDGE		STONE MONUMENT	
WATER PIPE		WOOD STAKE OR HUB	
SEWER PIPE		MEANDER CORNER	
DRAIN TILE			
GRAVEL PIT			
SAND PIT			
CLAY PIT			
ROCK QUARRY			
SPRINGS			
MARSH			
TRUNK HIGHWAY R/W			
RAILROAD R/W			
PRESENT ROAD R/W			

**OFFICE OF COUNTY SURVEYOR**

**RAMSEY COUNTY  
BITUMINOUS SURFACING  
FAIRVIEW AVENUE**

From Roselawn Ave. To Co. Rd. "B"

GROSS LENGTH 2600 FEET 0.49 MILES  
LENGTH OF EXCEPTIONS FEET MILES  
NET LENGTH 2600 FEET 0.49 MILES

PLAN, 1 Inch = 100 Feet  
PROFILE, Horz. 1 Inch = 100 Feet. Vert. 1 Inch = 10 Feet  
WORKING PLANS { Horz. 1 Inch = 100 Feet  
Vert. 1 Inch = 10 Feet  
Cross-Sections, 1 Inch = Feet

LAYOUT  
SCALE, 1 Inch = 2640 Feet

**INDEX**

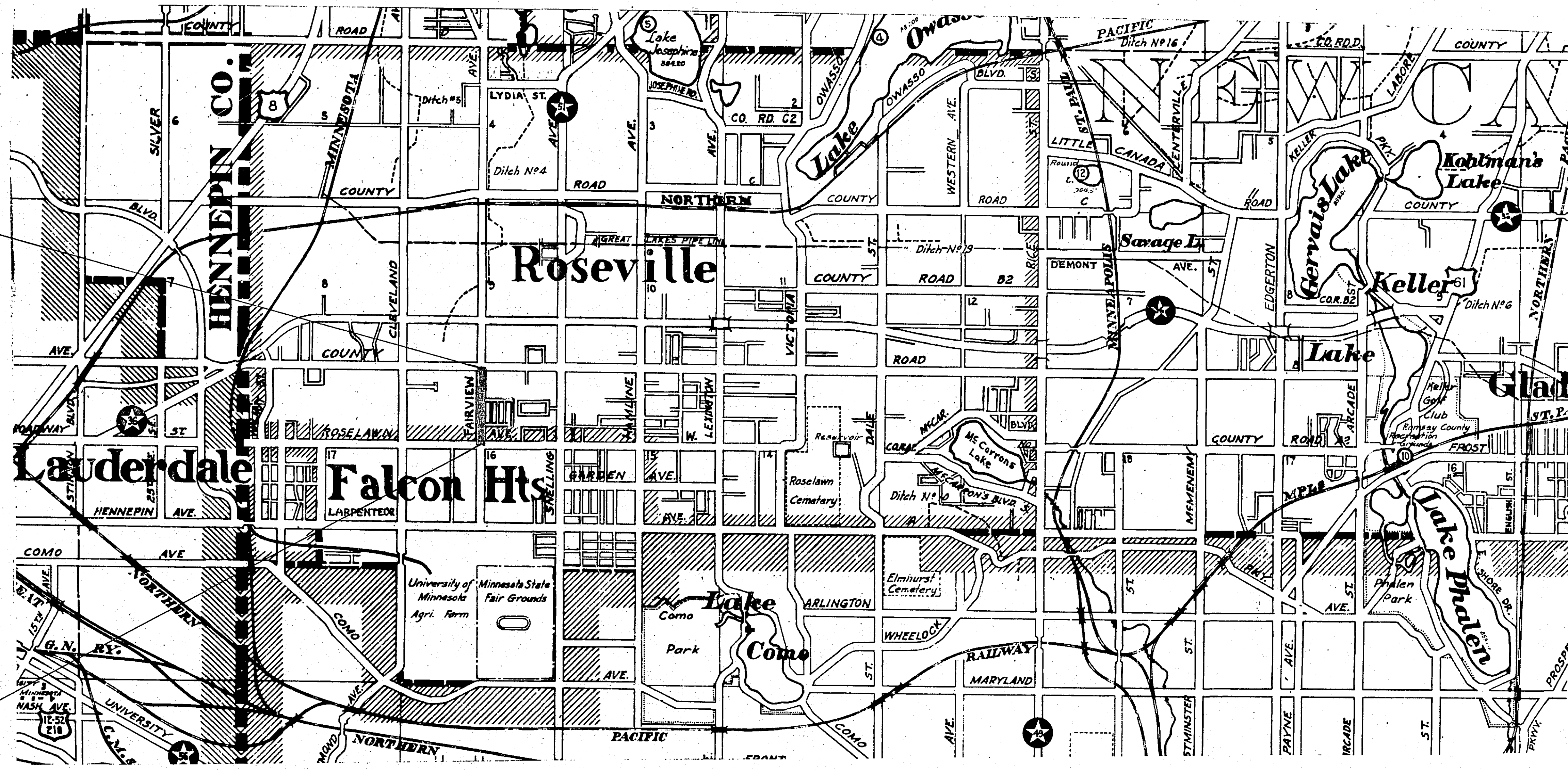

END OF PROJ.  
STA. 26+10

BEG. PROJ.  
STA. 0+10

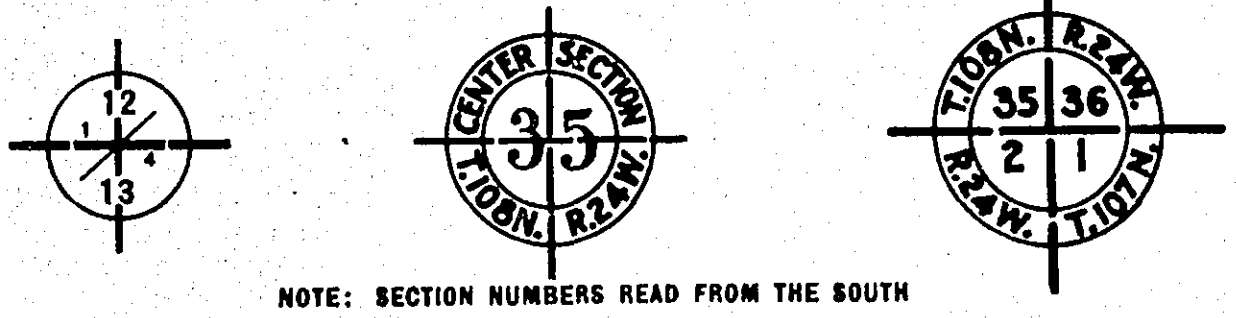

APPROVED *David S. Bernson* 1952  
COUNTY SURVEYOR

APPROVED 7/21/52 *Thomas A. Johnson*  
CHAIRMAN, RAMSEY COUNTY BOARD

RECOMMENDED FOR APPROVAL *E. J. McCreary*  
DISTRICT ENGINEER

RECOMMENDED FOR APPROVAL *S. M. ...* 8-25/52  
ENGINEER OF COUNTY DIVISION

APPROVED 8/25/52 *...*  
ENGINEER OF PLANS & SURVEYS

I HEREBY CERTIFY THAT THIS PLAN WAS PREPARED BY ME OR UNDER MY DIRECT SUPERVISION AND THAT I AM A DULY REGISTERED PROFESSIONAL ENGINEER UNDER THE LAWS OF THE STATE OF MINNESOTA.

DATE..... REG. NO.....

DATE	
BY	
PROJECT	
PLANNED	
NOTED	
NOTE BOOK ALIGNED CHECKED	
NO. OF WAY CHECKED	
NO.	

DATE	
BY	
PROJECT	
PLANNED	
NOTED	
NOTE BOOK GRADES CHECKED	
NO. OF WAY CHECKED	
NO.	

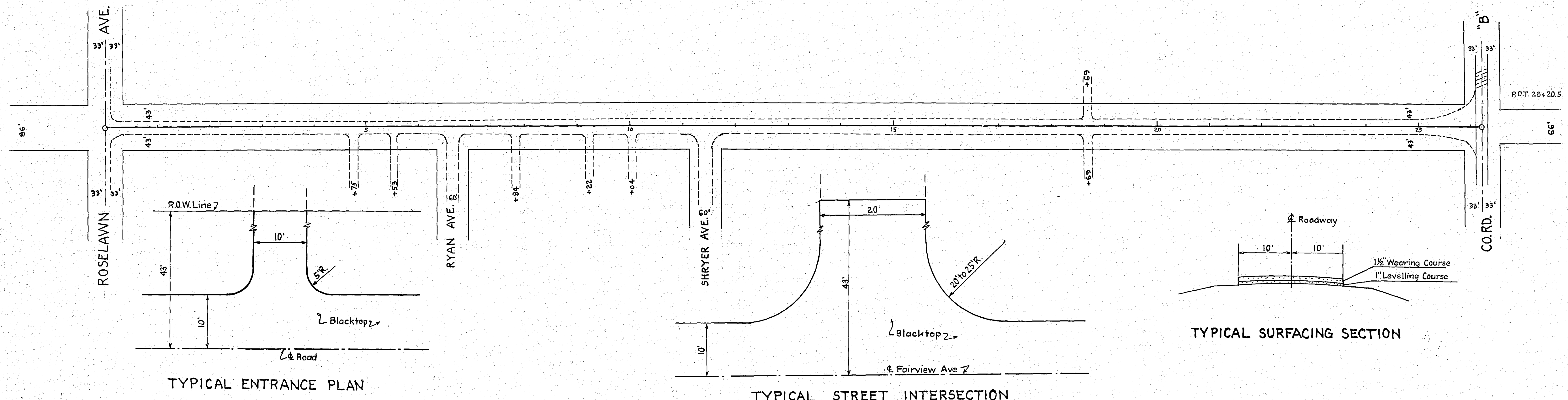
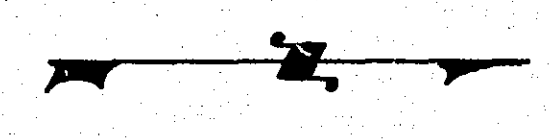

Top Conc. Ptg. End of P.C.  
S.E. Cor. Fairview Ave. & Roselawn Ave.  
Elev. 979.24

Top Mant.  
Fairview Ave. & Co. Rd. "B"  
Elev. 973.51

**ESTIMATED QUANTITIES**  
Bituminous Material For Surfacing & Levelling Course - Tons 713

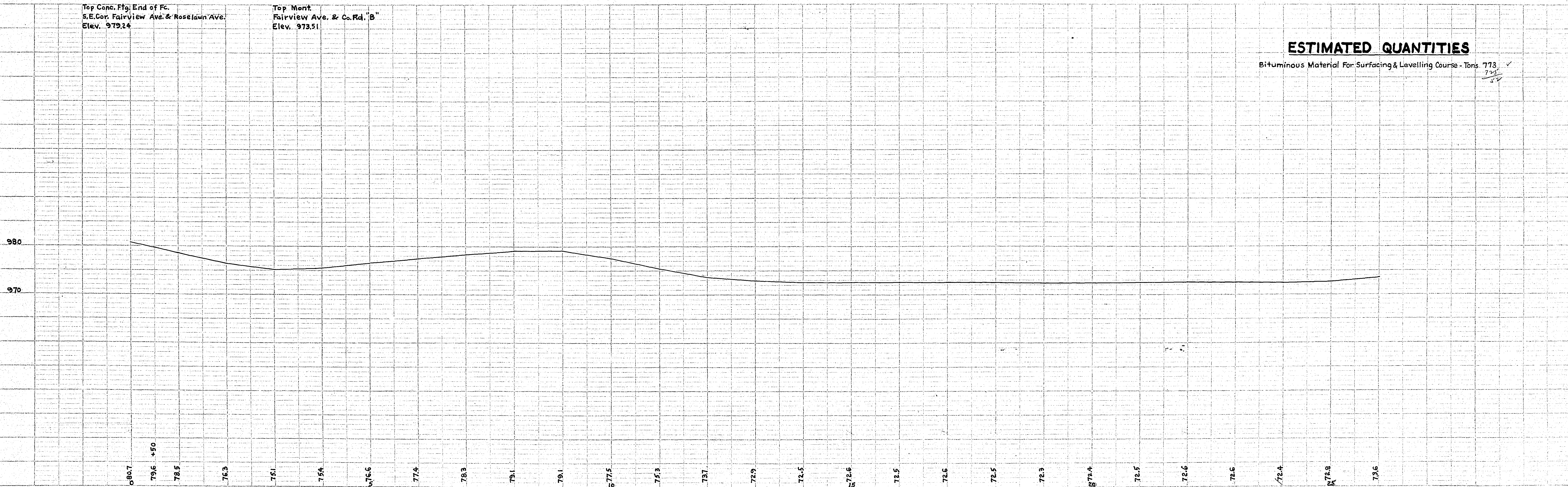

PLATE 1 - PROFILE - STANDARD  
REVISIONS: 1 - 11/15/50

**CONVENTIONAL SIGNS**

STATE LINE	TIMBER
COUNTY LINE	BRUSH
TOWNSHIP OR RANGE LINE	ORCHARD
SECTION LINE	ROCK LEDGE
QUARTER LINE	SAND
SIXTEENTH LINE	EDGE OF CUT
RIGHT-OF-WAY LINE	TOE OF EMBANKMENT
PROPERTY LINE (Except Land Lines)	CATCH BASIN
VACATED PLATTED PROPERTY	MANHOLE
CORPORATE OR CITY LIMITS	FIRE HYDRANT
TRUNK HIGHWAY CENTER LINE	ARC LAMP
RETAINING WALL	OTHER LAMPS (State Kind)
STEAM RAILROAD	RAILROAD CROSSING SIGN
ELECTRIC RAILROAD	RAILROAD CROSSING BELL
RAILROAD RIGHT-OF-WAY LINE	ELECTRIC WARNING SIGN
CREEK	CROSSING GATE
RAPIDS OR WATERFALL	CATTLE GUARD
DRY RUN	OVERHEAD (Highway Over)
DRAINAGE DITCH	UNDERPASS (Highway Under)
HIGH TENSION LINE	ABUTMENT, WALL & PIER
POWER POLE LINE	BRIDGE
TELEPHONE OR TELEGRAPH LINE	BUILDING (One Story Frame)
CULVERT	F-FRAME C-CONCRETE
DROP INLET	S-STONE T-TILE
GUARD RAIL	B-BRICK ST-STUCCO
WIRE FENCE	IRON PIPE
RAILROAD SNOW FENCE	STONE MONUMENT
BOARD OR HIGHWAY SNOW FENCE	WOOD STAKE OR NUB
STONE WALL OR FENCE	MEANDER CORNER
HEDGE	
WATER PIPE	
SEWER PIPE	
DRAIN TILE	
GRAVEL PIT	
SAND PIT	
CLAY PIT	
ROCK QUARRY	
SPRINGS	
MARSH	
TRUNK HIGHWAY R/W	
RAILROAD R/W	
PRESENT ROAD R/W	

**OFFICE OF COUNTY SURVEYOR**

**RAMSEY COUNTY  
BITUMINOUS SURFACING  
OWASSO BLVD. SOUTH**

From Dale Street To Western Ave.

GROSS LENGTH 4090 FEET 0.77 MILES  
LENGTH OF EXCEPTIONS FEET MILES  
NET LENGTH 4090 FEET 0.77 MILES

PLAN, 1 Inch = 100 Feet  
PROFILE, Horz. 1 Inch = 100 Feet, Vert. 1 Inch = 10 Feet  
SCALES WORKING PLANS { Horz. 1 Inch = 100 Feet  
Vert. 1 Inch = 10 Feet  
Cross-Sections, 1 Inch = Feet

LAYOUT  
SCALE, 1 Inch = 2640 Feet

**INDEX**

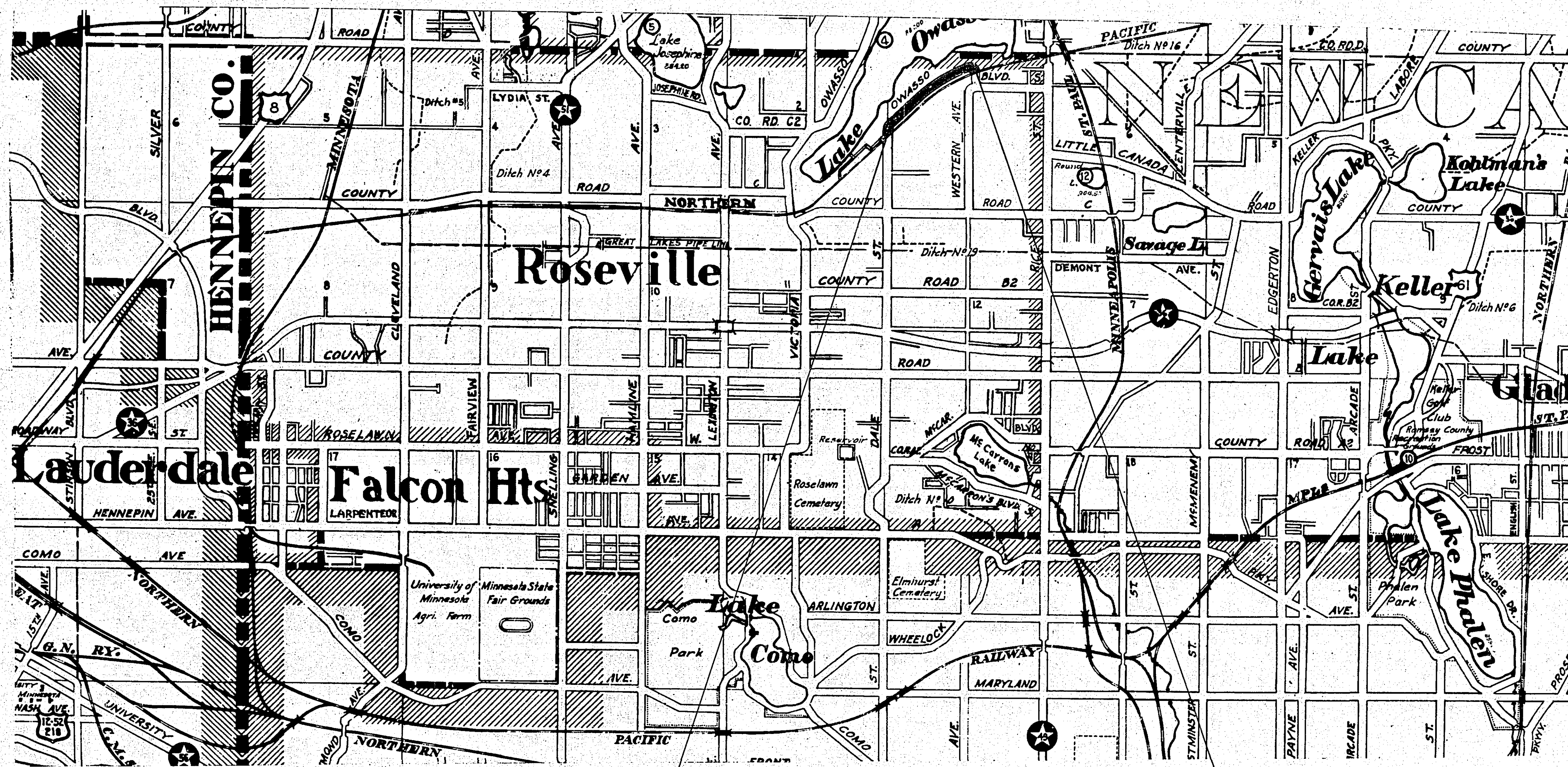

**END OF PROJ.**  
STA. 40+90

**BEG. PROJ.**  
STA. 0+00

APPROVED *Barrett S. Brown* COUNTY SURVEYOR 1952  
APPROVED *7/21 1952 Tony Selman* CHAIRMAN, RAMSEY COUNTY BOARD  
RECOMMENDED FOR APPROVAL *E. J. McCubrey* DISTRICT ENGINEER  
RECOMMENDED FOR APPROVAL *J. M. Egan* ENGINEER OF COUNTY DIVISION  
APPROVED *8/25 1952* ENGINEER OF PLANS & SURVEYS

I HEREBY CERTIFY THAT THIS PLAN WAS PREPARED BY ME OR UNDER MY DIRECT SUPERVISION AND THAT I AM A DULY REGISTERED PROFESSIONAL ENGINEER UNDER THE LAWS OF THE STATE OF MINNESOTA.

DATE \_\_\_\_\_ REG. NO. \_\_\_\_\_

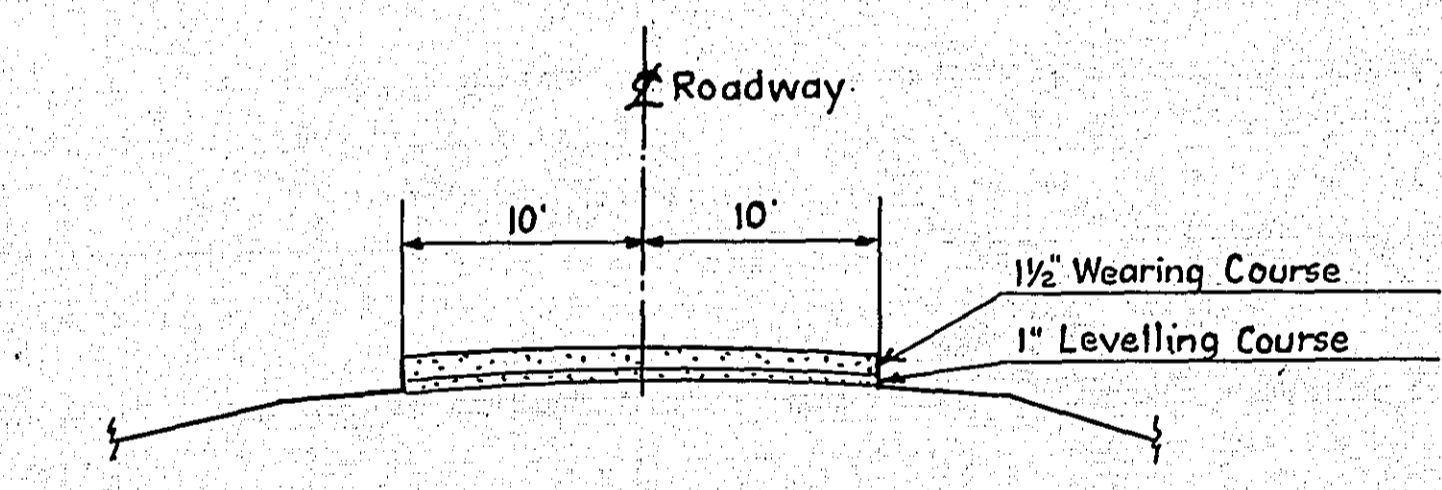
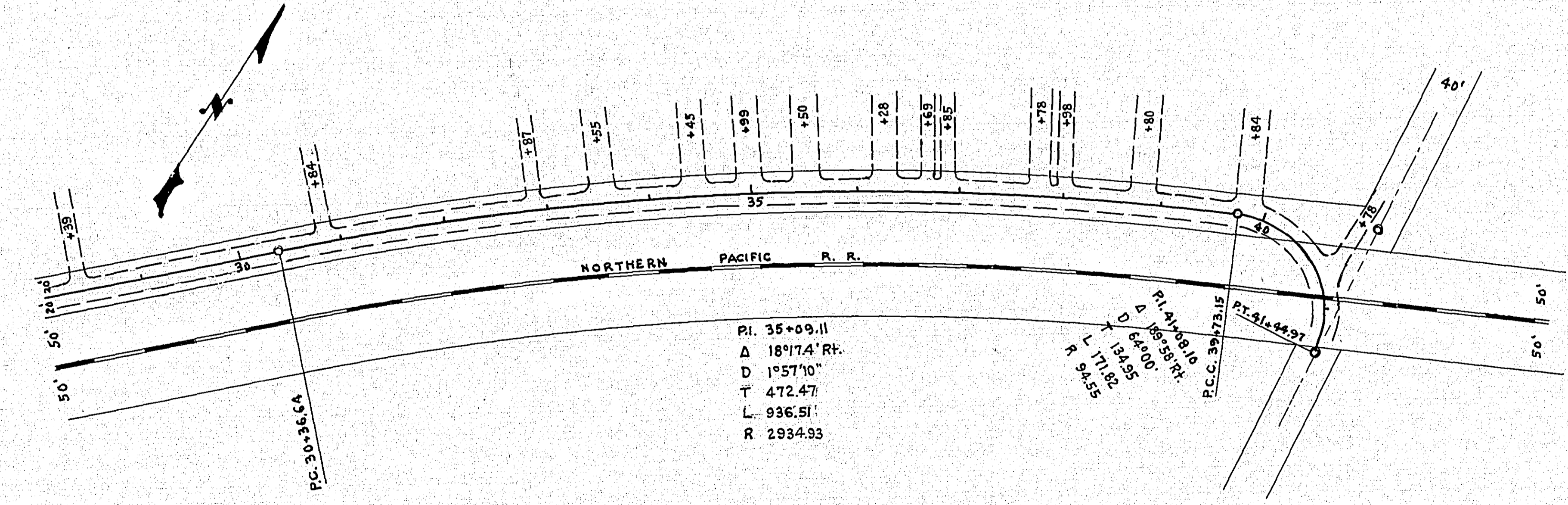
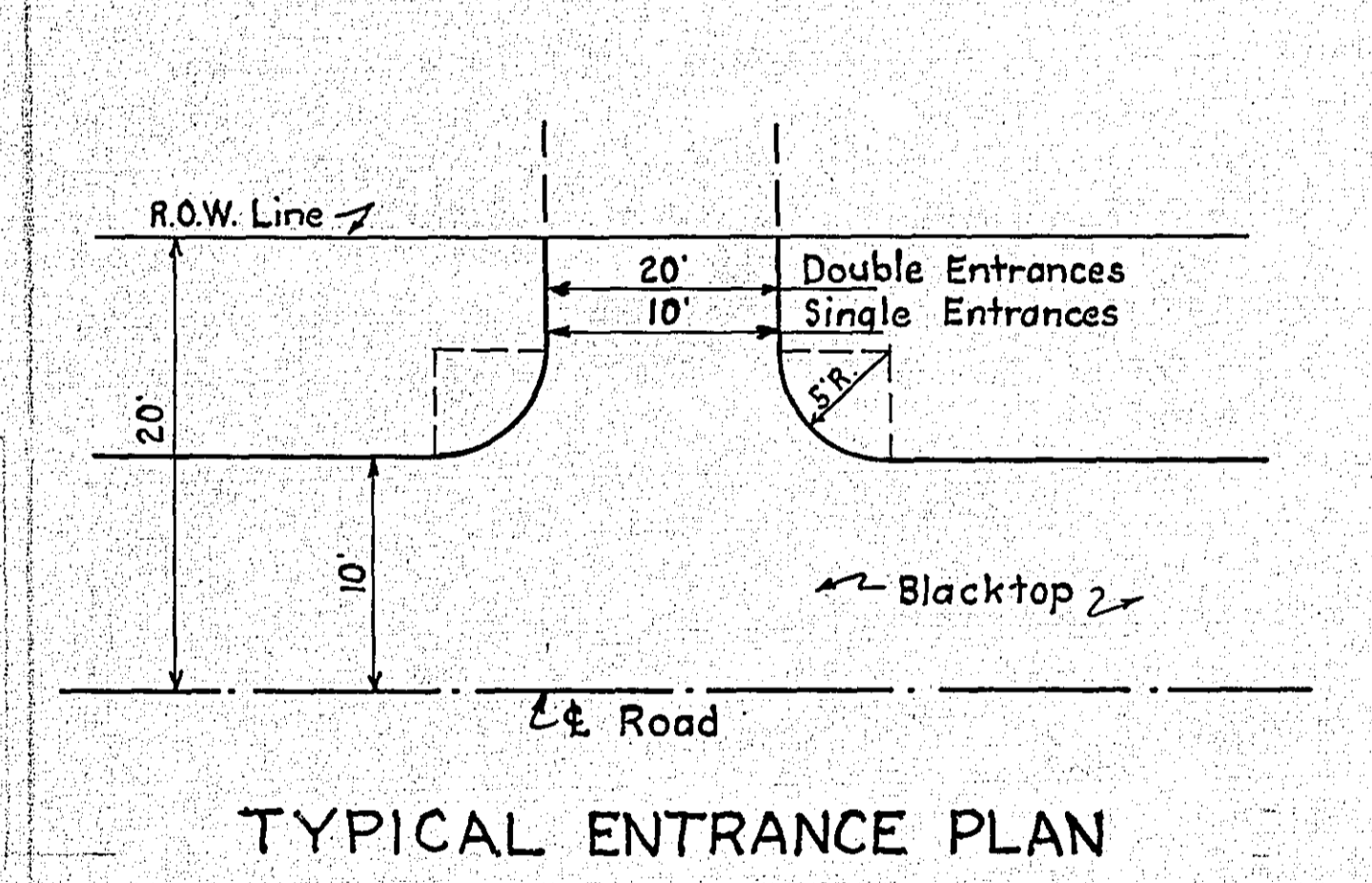
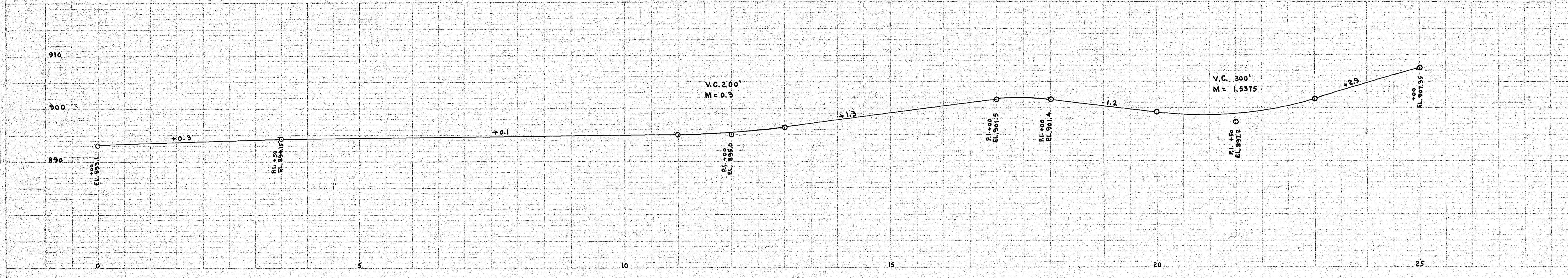
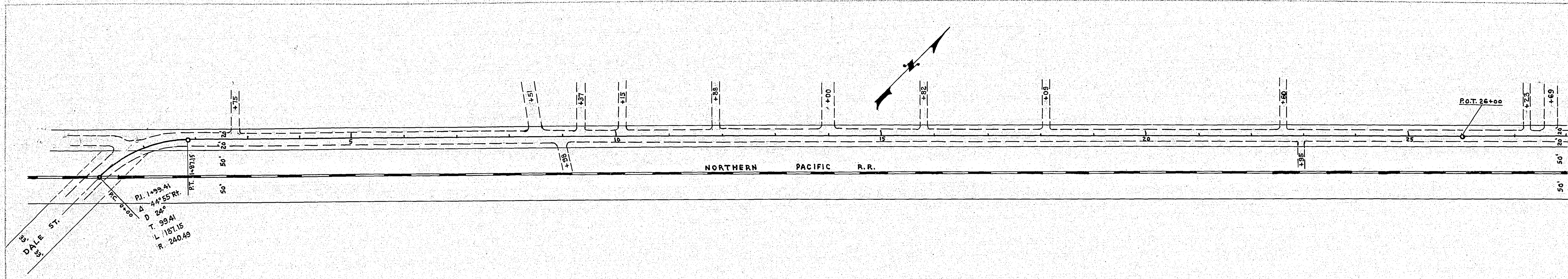

TYPICAL SURFACING SECTION

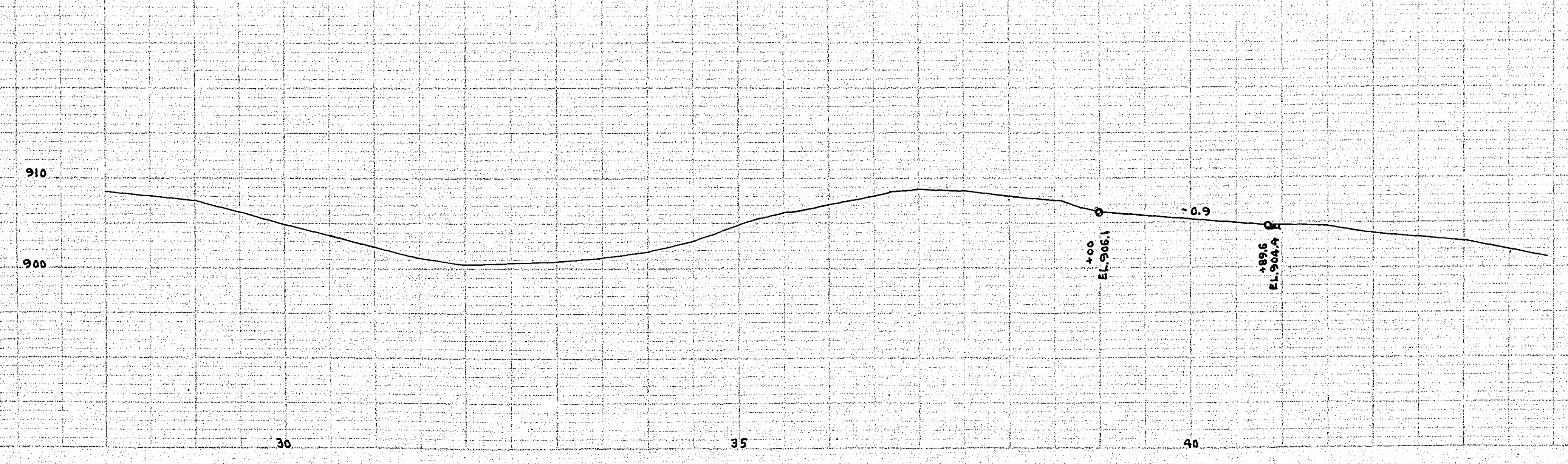

**ESTIMATED QUANTITIES**  
 Bituminous Material For Surfacing & Levelling Course, Tons - 1173  
 1120  
 43