

PLAN	DATE
REVISED	
NOTED	
NOTED	
NOTED	
NOTED	
NOTED	
NOTED	
NOTED	
NOTED	

PROFILE	DATE
REVISED	
NOTED	
NOTED	
NOTED	
NOTED	
NOTED	
NOTED	
NOTED	
NOTED	

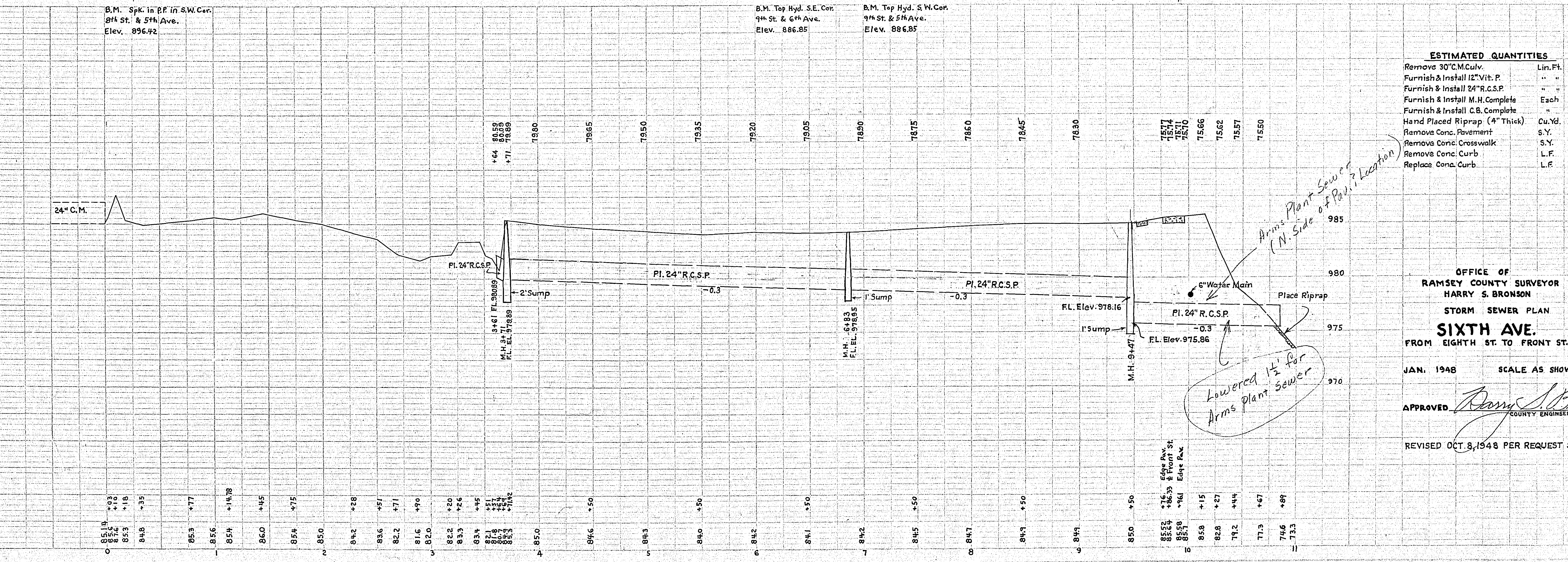
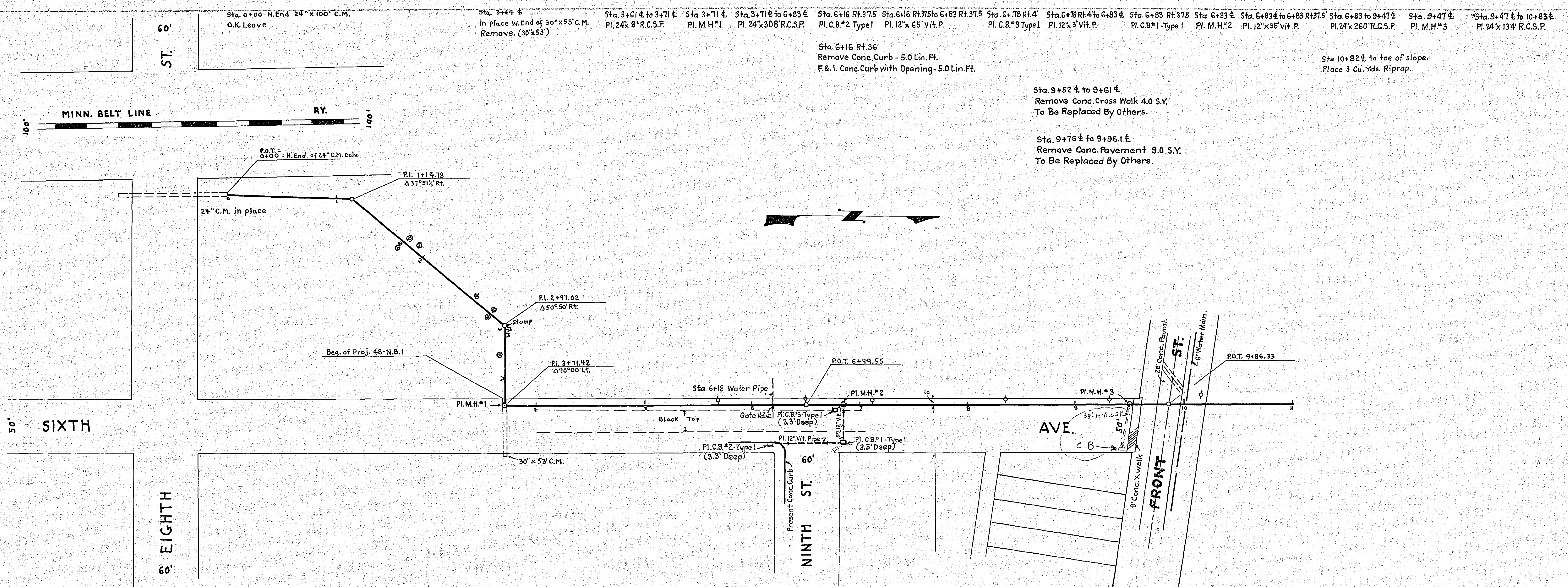

**ESTIMATED QUANTITIES**

Remove 30" C.M. Culv.	Lin. Ft.	53
Furnish & Install 12" Vit. P.	" "	103
Furnish & Install 24" R.C.S.P.	" "	110
Furnish & Install M.H. Complete	Each	3
Furnish & Install C.B. Complete	" "	3
Hand Placed Riprap (4" Thick)	Cu. Yd.	3
Remove Conc. Pavement	S.Y.	9
Remove Conc. Crosswalk	S.Y.	4
Remove Conc. Curb	L.F.	5
Replace Conc. Curb	L.F.	5

OFFICE OF  
 RAMSEY COUNTY SURVEYOR  
 HARRY S. BRONSON  
 STORM SEWER PLAN  
**SIXTH AVE.**  
 FROM EIGHTH ST. TO FRONT ST.  
 JAN. 1948 SCALE AS SHOWN  
 APPROVED *Harry S. Bronson*  
 COUNTY ENGINEER  
 REVISED OCT. 3, 1948 PER REQUEST SEPT. 23, 1948